

RTE	SECTION	COUNTY	TOTAL SHEETS	SHEET NO.
338	114R-1	WILL	355	100
STA. 3040+50		TO STA. 3069+50		
FED. ROAD DIST. NO. 7		ILLINOIS FED. AID PROJECT		

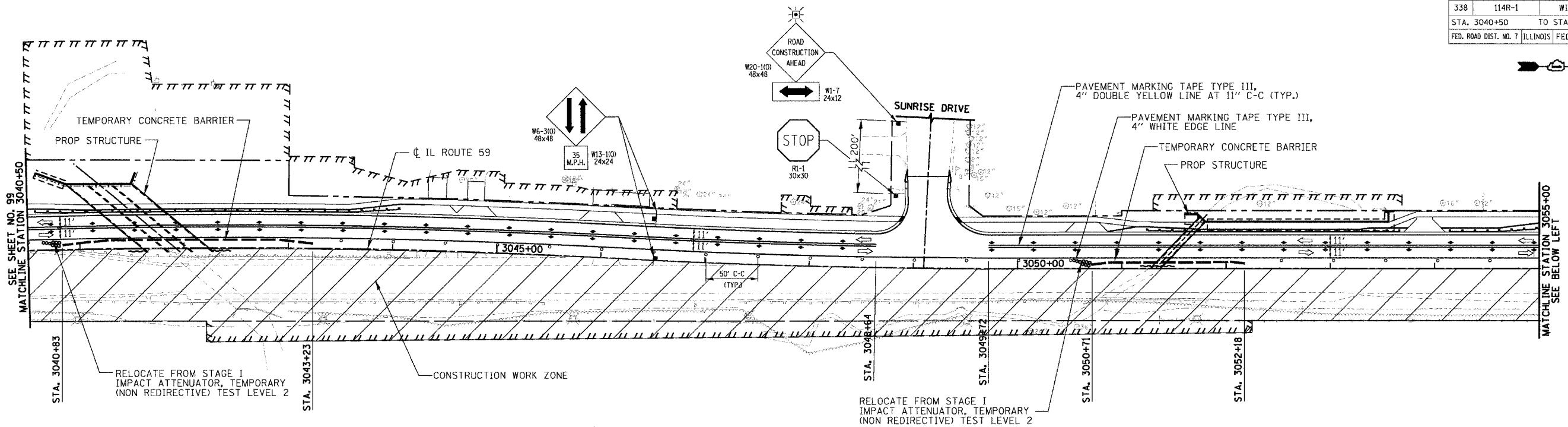

**STAGE II CONSTRUCTION
TRAFFIC CONTROL AND PROTECTION**

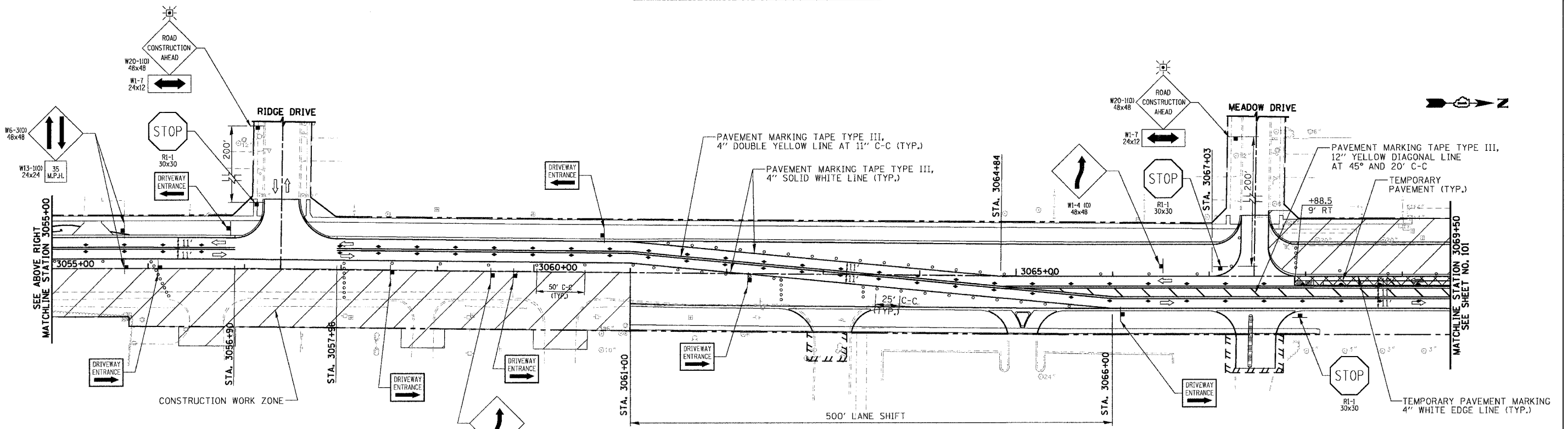

**STAGE II CONSTRUCTION
TRAFFIC CONTROL AND PROTECTION**

FOR LEGEND
SEE SHEET NO. 81

PLAN	DATE
NO.	
BY	
DATE	
REVISIONS	
NO.	
DATE	
BY	
DATE	

PROFILE	DATE
NO.	
BY	
DATE	
REVISIONS	
NO.	
DATE	
BY	
DATE	

REVISIONS	
NAME	DATE

**ILLINOIS DEPARTMENT OF TRANSPORTATION
SUGGESTED CONSTRUCTION PROCEDURE
AND MAINTENANCE OF TRAFFIC STAGE II
ILLINOIS ROUTE 59**

STATION 3040+50 TO STATION 3069+50

DATE: 3/18/08
DRAWN BY: NM, RM
CHECKED BY: AS

SCALE IN FEET