

RTE	SECTION	COUNTY	TOTAL SHEETS	SHEET NO.
338	114R-1	WILL	355	96
STA. 467+25 TO STA. 496+25 (CATON FARM ROAD)				
STA. 3185+55 TO STA. 3191+10 (IL-59)				
FED. ROAD DIST. NO. 7 ILLINOIS FED. AID PROJECT				

PLAN	SURVEYED	DATE
	PLOTTED	
	CHECKED	
	BY	
	NO. OF WAYS CHECKED	
	DATE FILE NAME	

PROFILE	SURVEYED	DATE
	PLOTTED	
	CHECKED	
	BY	
	NO. OF WAYS CHECKED	
	DATE FILE NAME	

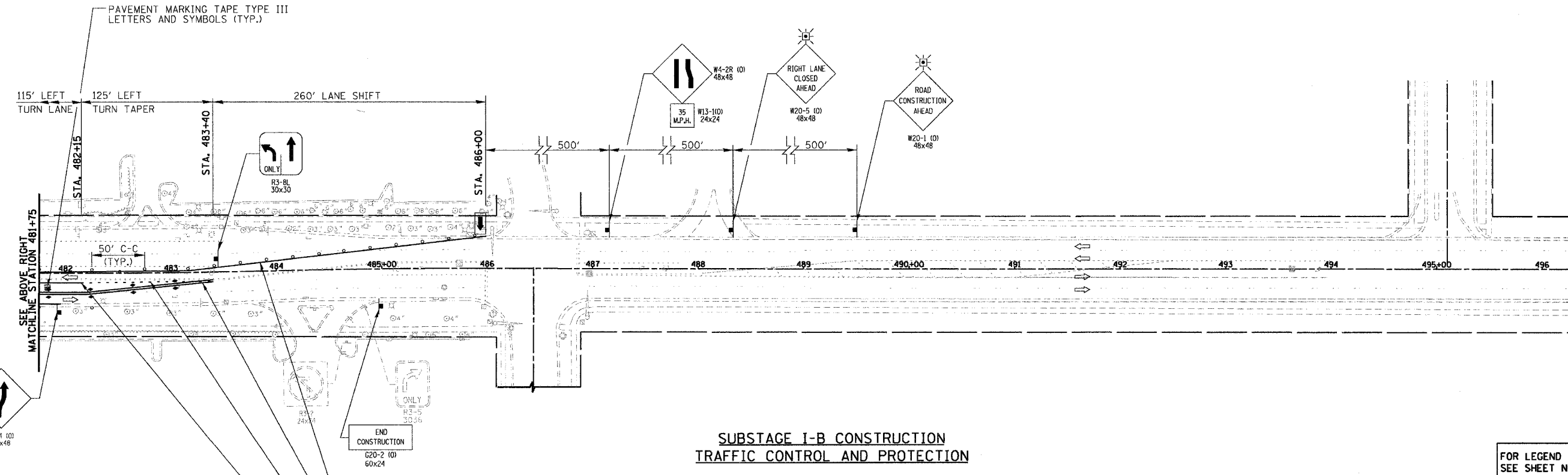
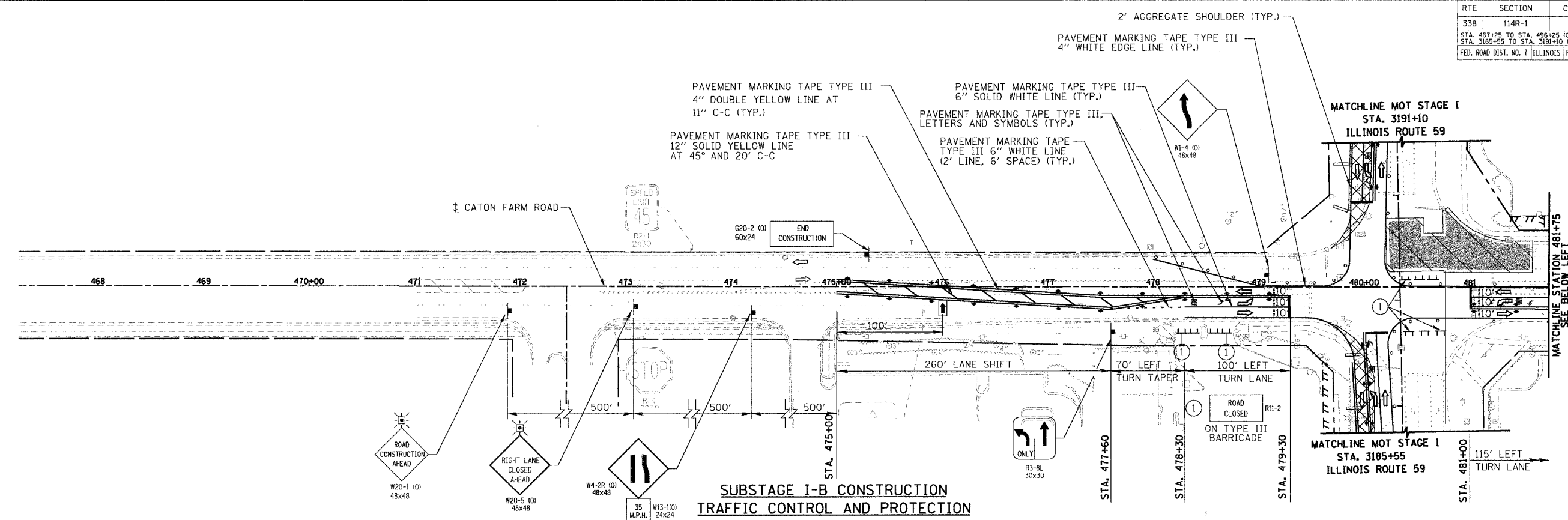

**SUBSTAGE I-B CONSTRUCTION TRAFFIC CONTROL AND PROTECTION**

FOR LEGEND SEE SHEET NO. 81

REVISIONS	
NAME	DATE

ILLINOIS DEPARTMENT OF TRANSPORTATION  
**SUGGESTED CONSTRUCTION PROCEDURE AND MAINTENANCE OF TRAFFIC STAGE I**  
 CATON FARM ROAD SUBSTAGE 1-B

DATE: 3/18/08  
 DRAWN BY: NM, RM  
 CHECKED BY: AS

SCALE IN FEET: 0 50 50