

RTE	SECTION	COUNTY	TOTAL SHEETS	SHEET NO.
338	114R-1	WILL	355	92

STA. 88+00 TO STA. 112+00 (THEODORE ST.)
 STA. 3132+00 TO STA. 3136+50 (IL-59)
 FED. ROAD DIST. NO. 7 ILLINOIS FED. AID PROJECT

PLAN	DATE	BY
SURVEYED		
PLANNED		
CHECKED		
IN CHARGE		
NOTE BOOK NO.		
DATE FILED		

PROFILE	DATE	BY
SURVEYED		
PLANNED		
CHECKED		
IN CHARGE		
NOTE BOOK NO.		
DATE FILED		

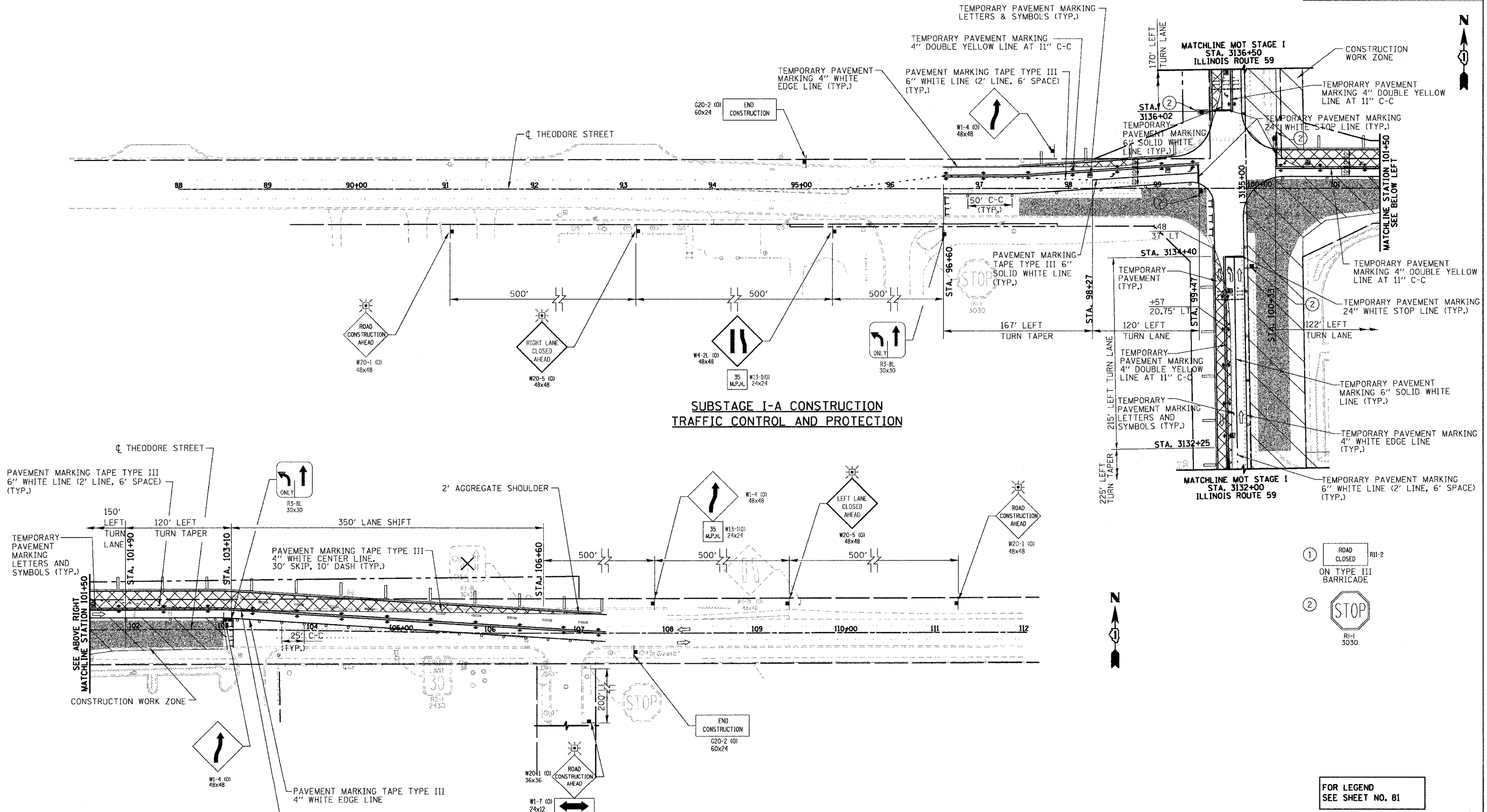

**SUBSTAGE I-A CONSTRUCTION
TRAFFIC CONTROL AND PROTECTION**

**SUBSTAGE I-A CONSTRUCTION
TRAFFIC CONTROL AND PROTECTION**

NOTE
 ON TEMPORARY PAVEMENT, TEMPORARY PAVEMENT MARKING SHOULD BE USED.
 ALL OTHER PLACES USE PAVEMENT MARKING TAPE TYPE II

- ① ROAD CLOSED
ON TYPE III BARRICADE
- ② STOP

FOR LEGEND
SEE SHEET NO. 81

REVISIONS	
NAME	DATE

ILLINOIS DEPARTMENT OF TRANSPORTATION
**SUGGESTED CONSTRUCTION PROCEDURE
 AND MAINTENANCE OF TRAFFIC STAGE I**
 THEODORE STREET SUBSTAGE I-A

DATE: 3/18/08
 DRAWN BY: NM, RM
 CHECKED BY: AS

SCALE IN FEET: 0 50