

RTE	SECTION	COUNTY	TOTAL SHEETS	SHEET NO.
338	114R-1	WILL	355	88
STA. 3182+00 TO STA. 3193+25 (IL ROUTE 59)				
STA. 479+00 TO STA. 481+75 (CATON FARM ROAD)				
FED. ROAD DIST. NO. 7 ILLINOIS FED. AID PROJECT				

PLAN	DATE
BY	
DESIGNED	
CHECKED	
ALIGNED	
GRADES	
NOTES	
NO.	

PROFILE	DATE
BY	
DESIGNED	
CHECKED	
ALIGNED	
GRADES	
NOTES	
NO.	

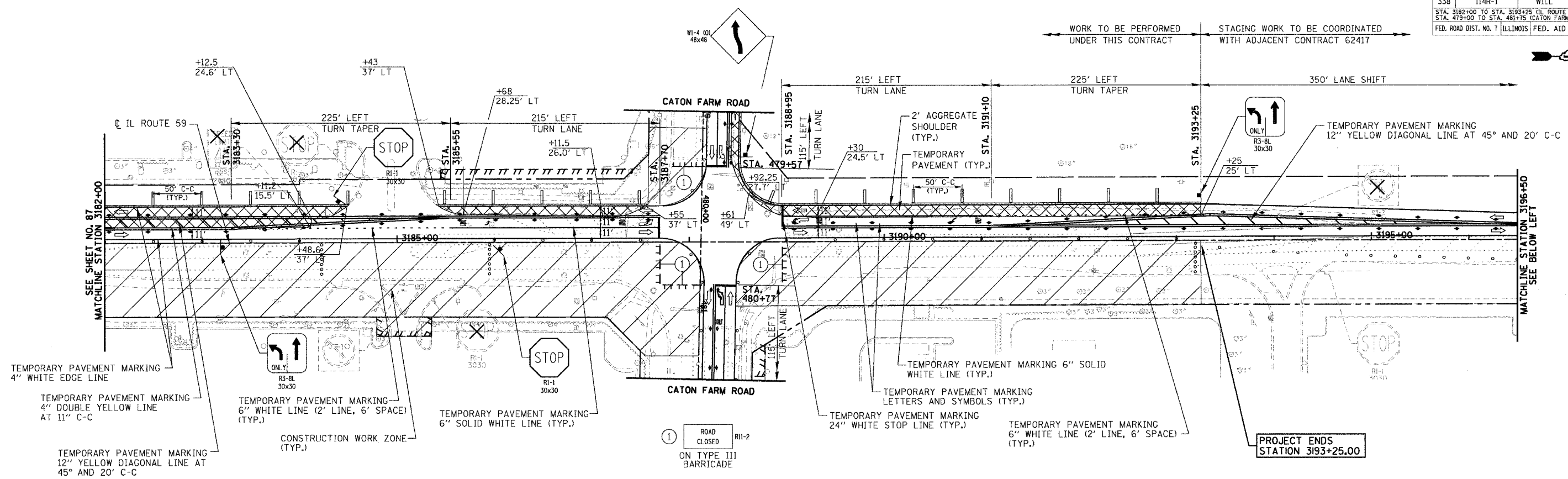

STAGE I CONSTRUCTION TRAFFIC CONTROL AND PROTECTION

NOTES:

- FOR THE INTERSECTION CONSTRUCTION PROCEDURE AND MAINTENANCE OF TRAFFIC STAGING OF IL-59 AND CATON FARM ROAD SEE SUB STAGING SHEETS.
- COORDINATION IS REQUIRED WITH ADJACENT CONTRACT (62417) FOR COMPATIBILITY OF ROADWAY STAGING ALONG IL ROUTE 59 NORTH OF CATON FARM ROAD @ STATION 3193+24.87 AT ALL TIMES. THE ENGINEER FOR THE ADJACENT CONTRACT (62417) WILL BE NOTIFIED A MINIMUM OF 2 WEEKS IN ADVANCE OF ANY POTENTIAL STAGE CONFIGURATION CHANGES SOUTH OF CATON FARM ROAD WHICH MAY AFFECT THE STAGING NORTH OF CATON FARM ROAD.

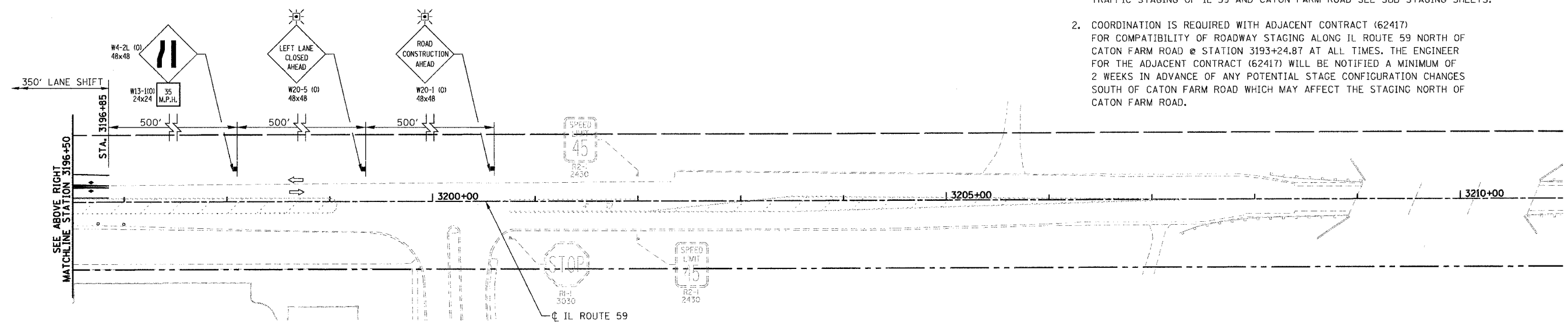

STAGE I CONSTRUCTION TRAFFIC CONTROL AND PROTECTION

FOR LEGEND SEE SHEET NO. 81

REVISIONS	
NAME	DATE

ILLINOIS DEPARTMENT OF TRANSPORTATION
SUGGESTED CONSTRUCTION PROCEDURE AND MAINTENANCE OF TRAFFIC STAGE I

ILLINOIS ROUTE 59
 STATION 3182+00 TO STATION 3193+25
 CATON FARM ROAD
 STATION 479+00 TO STATION 481+75

DATE: 3/18/08
 DRAWN BY: NM, RM
 CHECKED BY: AS

SCALE IN FEET