

RTE	SECTION	COUNTY	TOTAL SHEETS	SHEET NO.
338	114R-1	WILL	355	86
STA. 3127+00 TO STA. 3153+00 (IL ROUTE 59)				
STA. 98+50 TO STA. 101+50 (THEODORE STREET)				
FED. ROAD DIST. NO. 7 ILLINOIS FED. AID PROJECT				

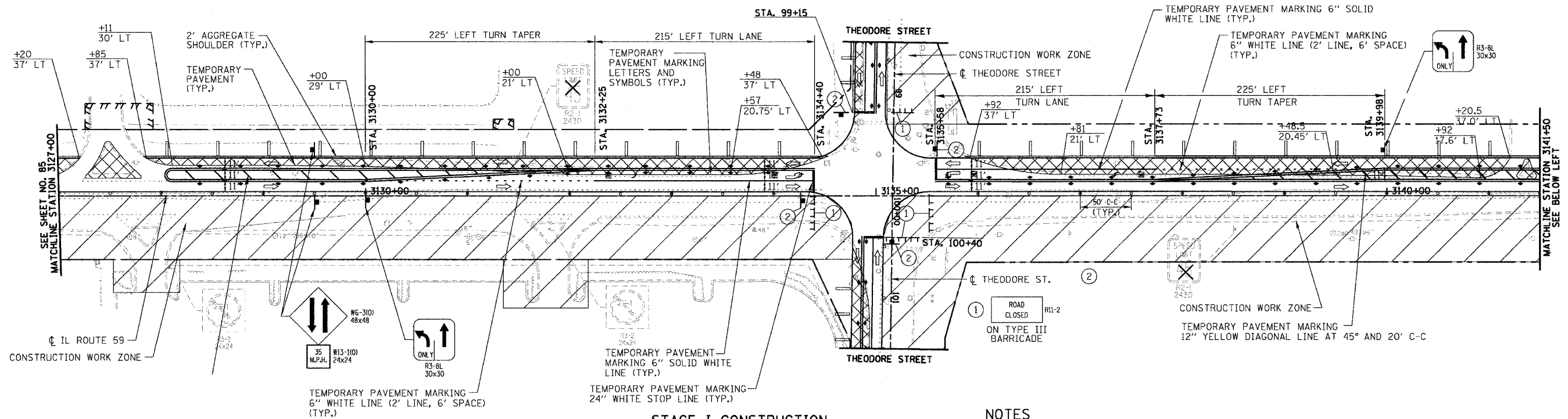

PLAN	SUBMITTED	DATE
	REVISED	
	BY	
	DATE	
	NO. OF SHEETS	
	NO. OF SHEETS CHECKED	
	BY	
	DATE	
	NO. OF SHEETS CHECKED	
	BY	
	DATE	



**STAGE I CONSTRUCTION
TRAFFIC CONTROL AND PROTECTION**

NOTES

- FOR THE INTERSECTION CONSTRUCTION PROCEDURE AND MAINTENANCE OF TRAFFIC STAGING OF IL-59 AND THEODORE STREET SEE SUB STAGING SHEETS.

PROFILE	SUBMITTED	DATE
	REVISED	
	BY	
	DATE	
	NO. OF SHEETS	
	NO. OF SHEETS CHECKED	
	BY	
	DATE	
	NO. OF SHEETS CHECKED	
	BY	
	DATE	

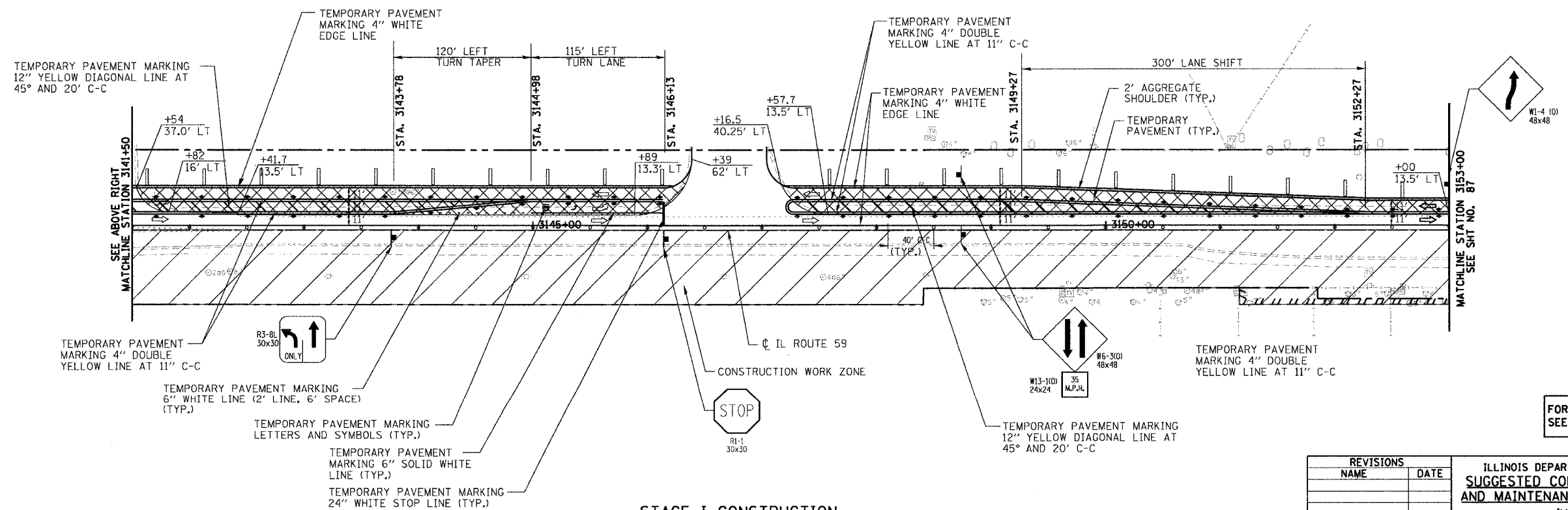

**STAGE I CONSTRUCTION
TRAFFIC CONTROL AND PROTECTION**

FOR LEGEND
SEE SHEET NO. 81

REVISIONS	
NAME	DATE

ILLINOIS DEPARTMENT OF TRANSPORTATION
**SUGGESTED CONSTRUCTION PROCEDURE
AND MAINTENANCE OF TRAFFIC STAGE I**

ILLINOIS ROUTE 59
STATION 3127+00 TO STATION 3153+00
THEODORE STREET
STATION 98+50 TO STATION 101+50

DATE 3/18/08
DRAWN BY: NM, RM
CHECKED BY: AS

SCALE IN FEET