

F.A.P. RTE.	SECTION	COUNTY	TOTAL SHEETS	SHEET NO.
338	114R-1	WILL	355	77
STA. 3098+00		TO STA. 3112+50		
FED. ROAD DIST. NO. 1 ILLINOIS FED. AID PROJECT				

PLAN	DATE
REVISED	
NOTED	
BY	
DATE	

PROFILE	DATE
REVISED	
NOTED	
BY	
DATE	

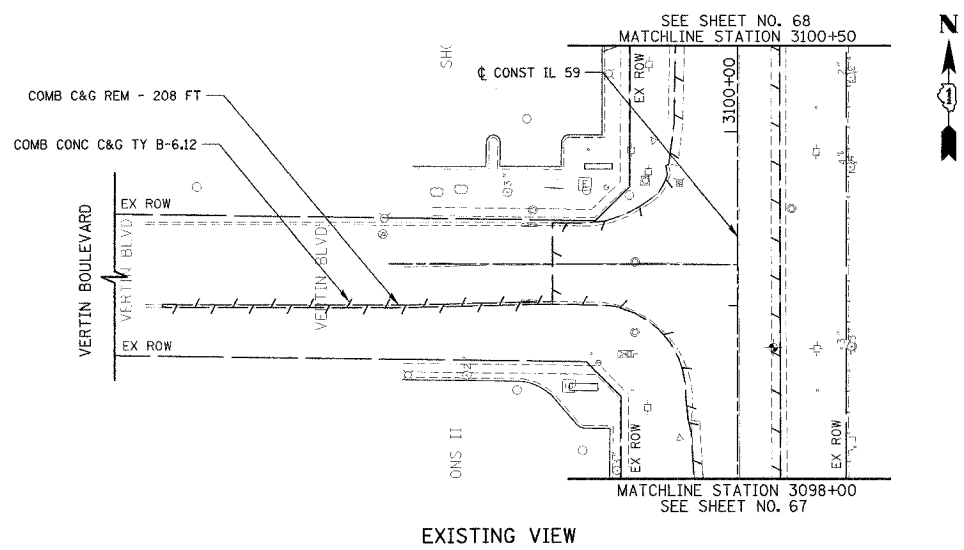

EXISTING VIEW

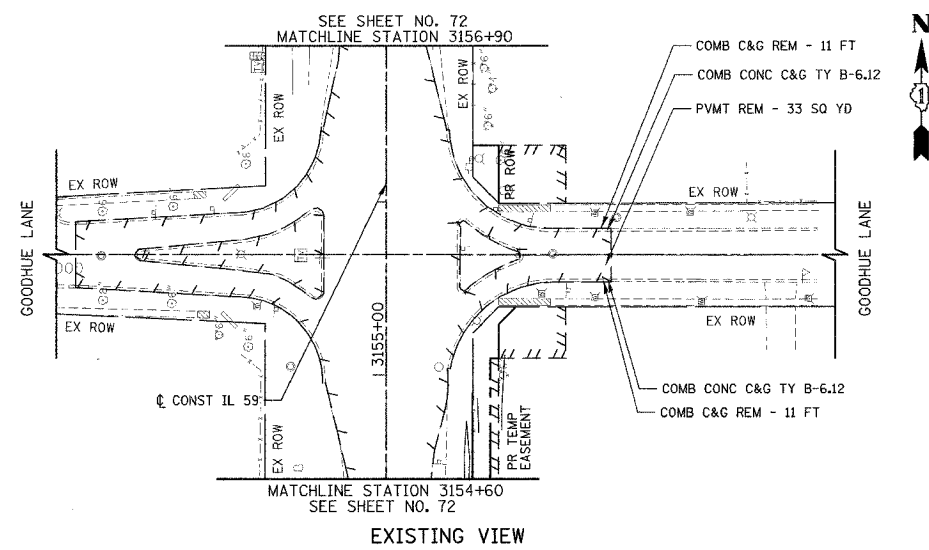

EXISTING VIEW

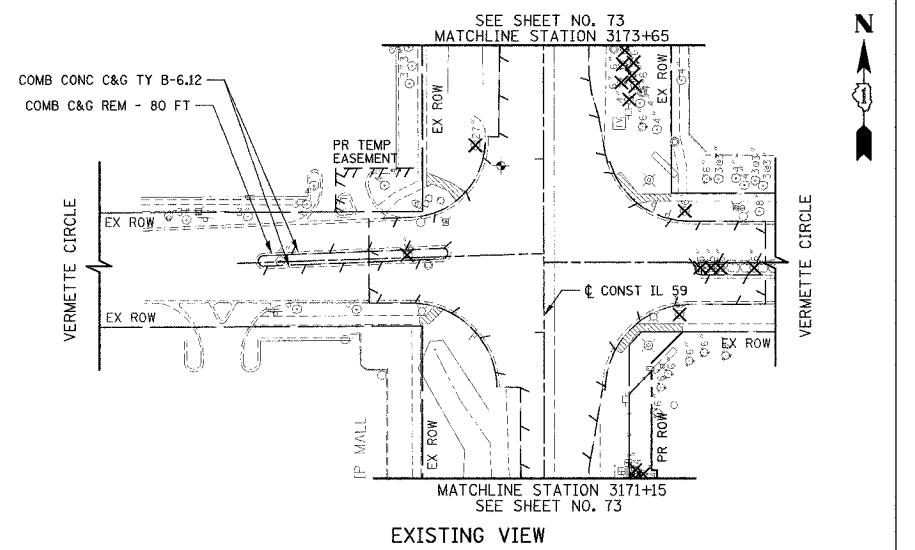

EXISTING VIEW

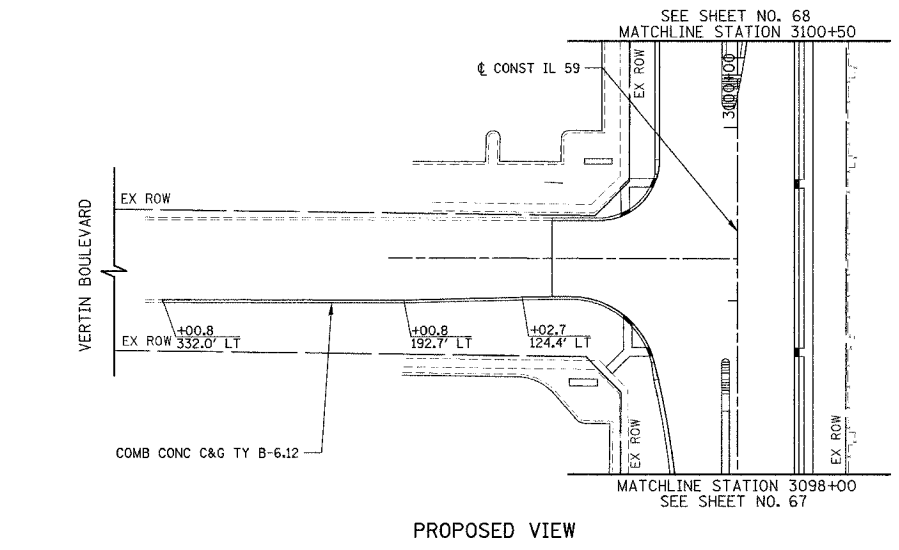

PROPOSED VIEW

VERTIN BOULEVARD

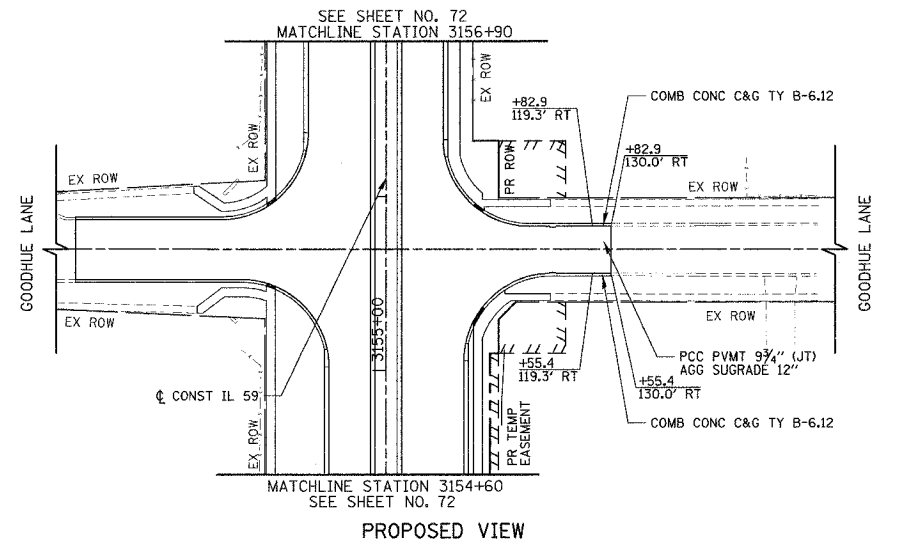

PROPOSED VIEW

GOODHUE LANE

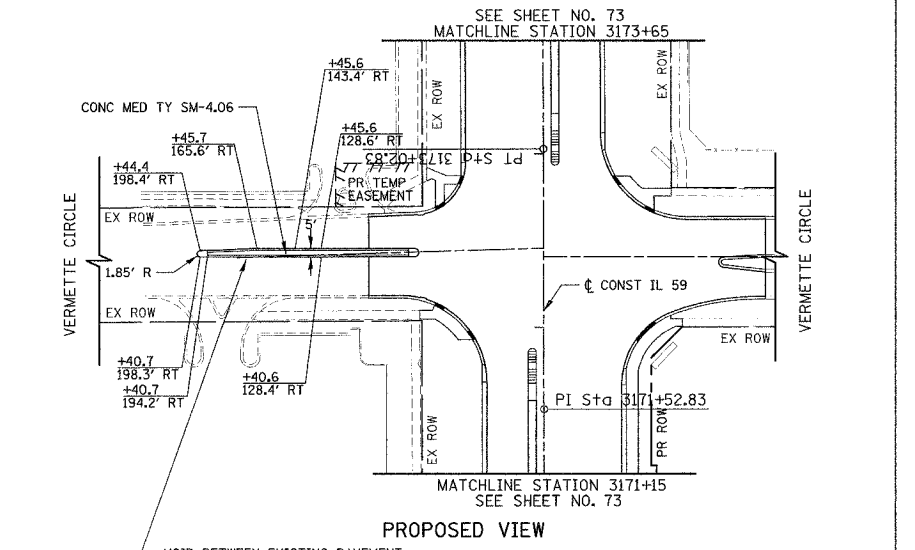

PROPOSED VIEW

VERMETTE CIRCLE

NOTE:
THE QUANTITIES AS SHOWN INDICATE THE REMOVAL AMOUNTS THAT LIE OUTSIDE OF THE LIMITS SHOWN ON THE MAINLINE PLAN AND PROFILE SHEETS.

VOID BETWEEN EXISTING PAVEMENT AND PROPOSED MEDIAN SHALL BE FILLED WITH CONCRETE (INCLUDED IN THE COST OF CONC MED TY SM-4.06)

REVISIONS	
NAME	DATE

ILLINOIS DEPARTMENT OF TRANSPORTATION

PLAN DETAILS

CROSS STREET DETAILS
VERTIN BLVD, GOODHUE LANE, AND VERMETTE CIR

SCALE IN FEET

DATE 3/18/08
DRAWN BY MJG
CHECKED BY VJD