

MATCH LINE STA. 58+00

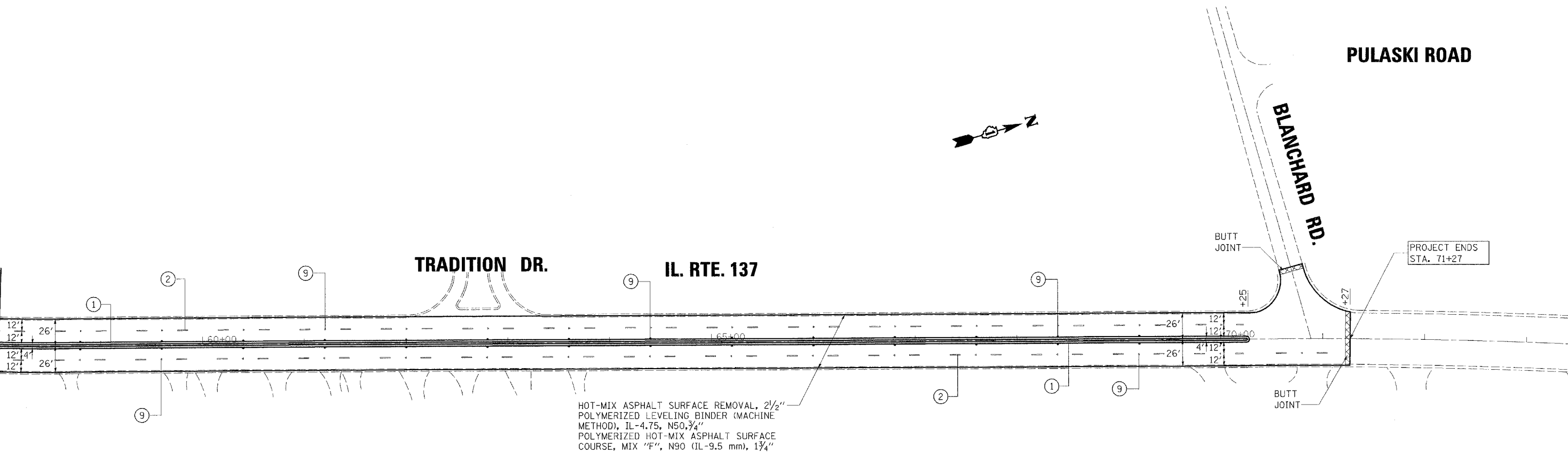

HOT-MIX ASPHALT SURFACE REMOVAL, 2 1/2"
 POLYMERIZED LEVELING BINDER (MACHINE METHOD), IL-4.75, N50, 3/4"
 POLYMERIZED HOT-MIX ASPHALT SURFACE COURSE, MIX "F", N90 (IL-9.5 mm), 1 3/4"

- THERMOPLASTIC PAVEMENT MARKING LEGEND**
- ① 4" DOUBLE SOLID YELLOW LINE (11' C-C)
 - ② 4" WHITE LANE LINE (10' LINE, 30' SPACE)
 - ③ 6" SOLID WHITE LINE
 - ④ 6" WHITE TURN LANE LINE (2' LINE, 6' SPACE)
 - ⑤ 12" SOLID YELLOW DIAGONAL LINES
 - ⑥ 24" SOLID WHITE STOP BAR
 - ⑦ LETTERS AND SYMBOLS
 - ⑧ 12" WHITE CROSSWALK LINES
 - ⑨ RAISED REFLECTIVE PAVEMENT MARKERS
 - ◁ ONE-WAY CRYSTAL
 - ◀ ONE-WAY AMBER
 - ◆ TWO-WAY AMBER
 - ⑩ 6" SOLID WHITE TURN LANE LINE
 - ⑪ 4" SINGLE SOLID YELLOW LINE

5/22/2008
 K:\11225586\civil1\Sheets\11225586-PL\11225586.dgn
 User Name: jmartin
 Model: Default



200 West Front Street
 Wheaton, IL 60187

DESIGNED -	REVISED -
DRAWN -	REVISED -
CHECKED -	REVISED -
DATE 5/23/08	REVISED -

**STATE OF ILLINOIS
 DEPARTMENT OF TRANSPORTATION**

**IL ROUTE 137 (GREENWOOD AVE. - BLANCHARD RD.)
 EXISTING & PROPOSED ROADWAY PLAN**

SCALE: 1"=50' SHEET NO. 3 OF 3 SHEETS STA. 58+00 TO STA. 73+00

F.A.P. RTE.	SECTION	COUNTY	TOTAL SHEETS	SHEET NO.
352	(E, M, D) RS-6	LAKE	21	8
CONTRACT NO. 60E56				
FED. ROAD DIST. NO. 1 ILLINOIS FED. AID PROJECT				