

F.A.P. RTE.	SECTION	COUNTY	TOTAL SHEETS	SHEET NO
353	(12&13)	WILL	199	72
STA.	TO STA.			
FED. ROAD DIST. NO.	ILLINOIS	FED. AID PROJECT		

POINT	STATION	OFFSET	ELEVATION
1	309+92.43	9.00' RT	727.60
2	309+92.431	15.00' RT	727.60

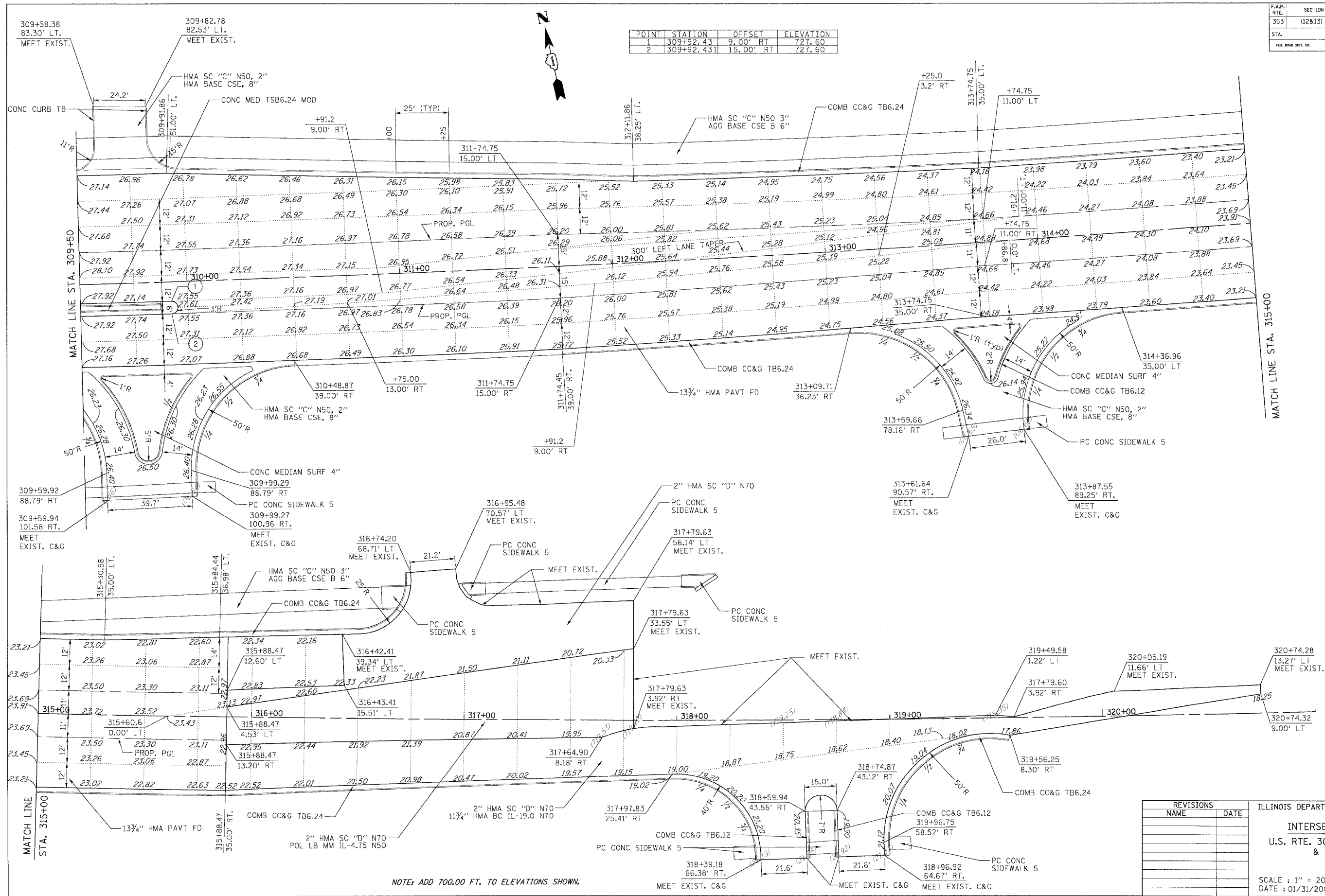

NOTE: ADD 700.00 FT. TO ELEVATIONS SHOWN.

REVISIONS	
NAME	DATE

ILLINOIS DEPARTMENT OF TRANSPORTATION
INTERSECTION DETAILS
 U.S. RTE. 30 (LINCOLN HIGHWAY)
 & WOLF ROAD
 SCALE : 1" = 20'
 DATE : 01/31/2008
 DRAWN BY : BEC
 CHECKED BY : G.B.