

F.A.P. RTE.	SECTION	COUNTY	TOTAL SHEETS	SHEET NO.
353	12R - 4	WILL	199	62
STA.	TO STA.			
FED. ROAD DIST. NO.	ELLIPSE	FED. AID PROJECT		

PROP. CURVE PWOLF1  
 PI STA. = 298+48.80  
 $\Delta = 18^\circ 49' 05''$  (LT)  
 $D = 1^\circ 23' 56''$   
 $R = 4,096.06'$   
 $T = 678.76'$   
 $L = 1,345.29'$   
 $E = 55.86'$   
 P.C. STA. = 291+70.04  
 P.T. STA. = 305+15.33

PROP. CURVE CLUS30-5  
 PI STA. = 315+74.10  
 $\Delta = 11^\circ 50' 47''$  (LT)  
 $D = 0^\circ 32' 44''$   
 $R = 10,500.00'$   
 $T = 1,089.38'$   
 $L = 2,170.98'$   
 $E = 56.36'$   
 P.C. STA. = 304+84.72  
 P.T. STA. = 326+55.71

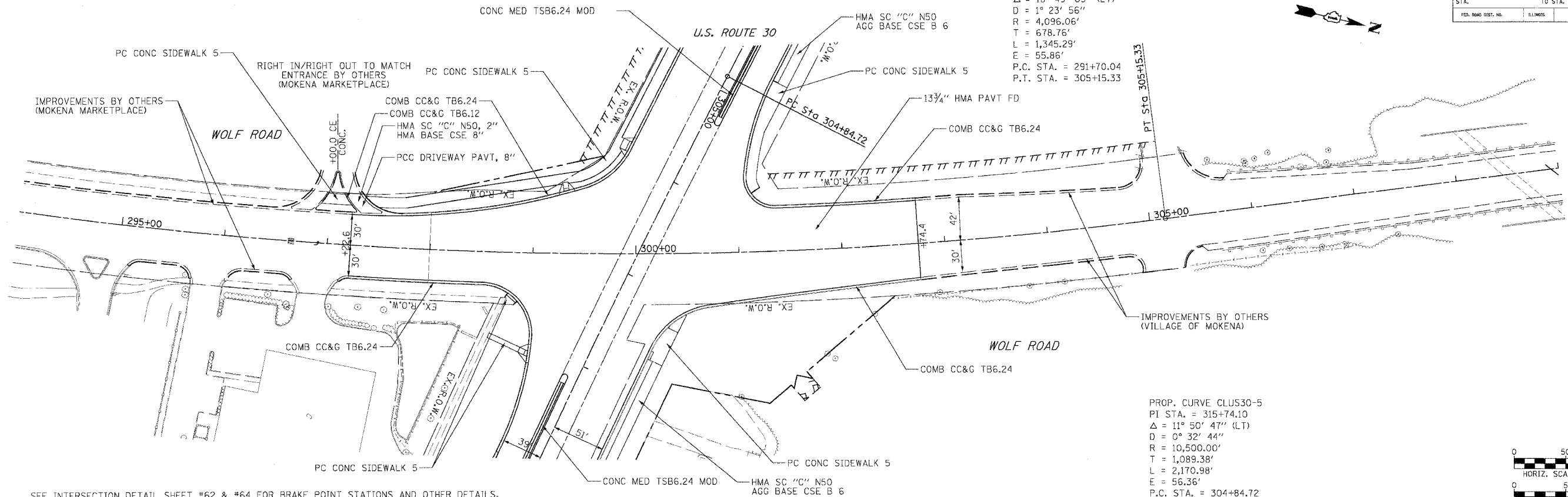

SEE INTERSECTION DETAIL SHEET #62 & #64 FOR BRAKE POINT STATIONS AND OTHER DETAILS.

