

F.A.P. RTE.	SECTION	COUNTY	TOTAL SHEETS	SHEET NO.
353	12R - 4	WILL	199	40
STA.		TO STA.		
FED. ROAD DIST. NO.		ILLINOIS		FED. AID PROJECT

STAGE 1 GENERAL NOTES

STAGE 1 CONSTRUCTION

U.S. ROUTE 30

CONSTRUCT CURB AND CUTTER ALONG OUTSIDE EASTBOUND LANES OF US ROUTE 30 FROM STA. 510+45.5 TO INTERSECTION WITH WOLF RD.

CONSTRUCT EASTBOUND LANES OF US ROUTE 30 MINUS THE SURFACE COURSE

CONSTRUCT NORTHBOUND LANES OF WOLF RD. MINUS THE SURFACE COURSE.

CONSTRUCT SIDEWALK ALONG THE EASTBOUND LANES OF US ROUTE 30 FROM STA. 515+00 TO THE INTERSECTION WITH WOLF RD.

CONSTRUCT TEMPORARY PAVEMENT AT THE FOLLOWING LOCATIONS:
 STA. 509+31.6 TO STA. 509+95.5
 STA. 525+87.0 TO STA. 535+77.5

CONSTRUCT STORM SEWER LATERALS ALONG THE EASTBOUND LANES OF US RTE 30

CONSTRUCT FINAL LANDSCAPING ALONG THE OUTSIDE OF EASTBOUND LANES FROM STA. 511+00 TO STA. 524+00.

STAGE 1 GENERAL NOTES

1. ALL TEMPORARY PAVEMENT MARKINGS PLACED IN STAGE 1 SHALL BE EPOXY UNLESS NOTED OTHERWISE ON THE PLANS.
2. THE CONTRACTOR SHALL PROVIDE AND MAINTAIN ACCESS TO ALL PUBLIC AND PRIVATE ENTRANCES AND TO ALL SIDEROADS THAT ARE NOT CLOSED.
3. BOTH PROPOSED CENTERLINE AND STAGE 1 CENTERLINE ARE SHOWN. THE MATCH LINES ARE TO THE PROPOSED CENTERLINE. STATIONING AND OFFSETS ARE TO THE STAGE 1 CENTERLINE UNLESS NOTED OTHERWISE.

STAGE 1 TRAFFIC

1. US 30 - SHIFT TRAFFIC TO EXISTING PAVEMENT AND TEMPORARY PAVEMENT CONSTRUCTED IN PRE-STAGE 1 AS SHOWN IN THE PLANS AND MAINTAIN ONE LANE IN EACH DIRECTION AT ALL TIMES.
2. WOLF RD. - SHIFT TRAFFIC TO EXISTING PAVEMENT AND TEMPORARY PAVEMENT CONSTRUCTED IN PRE-STAGE 1 AS SHOWN IN THE PLANS AND MAINTAIN ONE LANE IN EACH DIRECTION AT ALL TIMES.

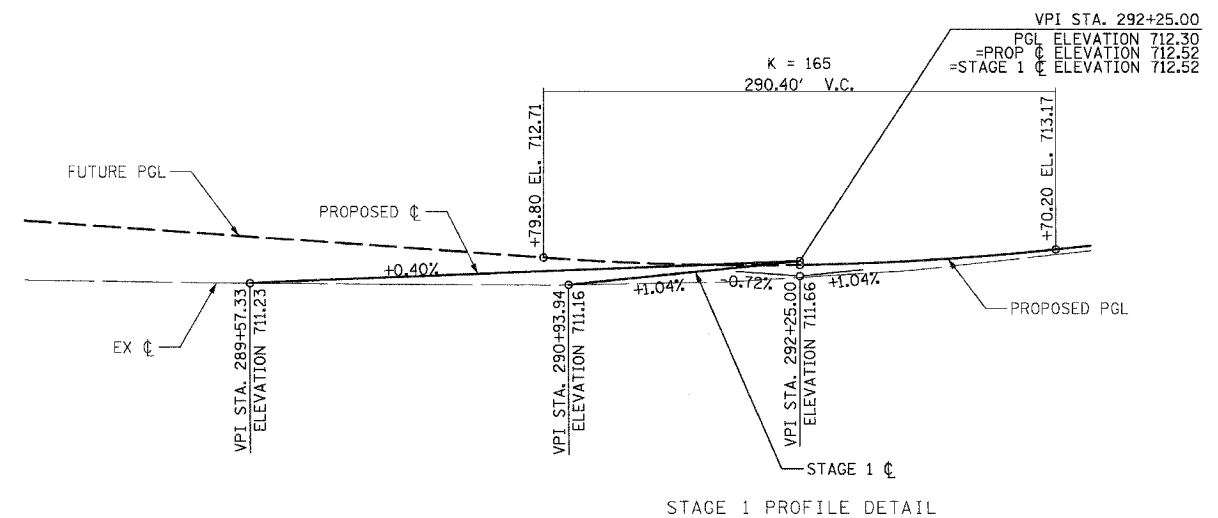

REVISIONS		ILLINOIS DEPARTMENT OF TRANSPORTATION MAINTENANCE OF TRAFFIC STAGE 1 U.S. RTE. 30 (LINCOLN HIGHWAY)
NAME	DATE	
		SCALE : 1" = 50' DATE : 03/21/2008 DRAWN BY : BEC CHECKED BY :