

07-31-2020 LETTING ITEM 069

INDEX OF SHEETS	
1.	COVER SHEET, LOCATION MAP, SCHEDULE OF QUANTITIES
2.	TYPICAL AND PROPOSED CROSS-SECTION
3.	SIDE ROAD, PRIVATE ENTRANCE, MAILBOX DETAILS, PATCHING SCHEDULE AND GENERAL NOTES

STANDARDS
 000001-07
 701006-05
 701306-04
 701901-08

STATE OF ILLINOIS
 DEPARTMENT OF TRANSPORTATION
 DIVISION OF HIGHWAYS
 PLANS FOR PROPOSED
 SURFACE TRANSPORTATION PROJECT
 CH 8 - SHAWNEE LANE (BLUFORD ROAD)

ROUTE	SECTION	COUNTY	TOT. SHTS.	SHEET
CH 8	18-00218-00-RS	JEFFERSON	3	1

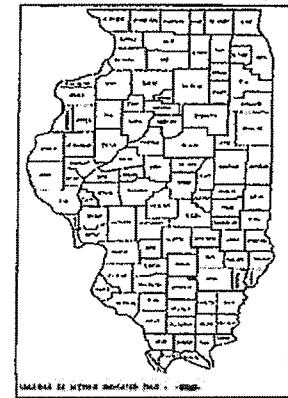

SECTION 18-00218-00-RS
 JEFFERSON COUNTY
 Q18V(821)
 C-99-026-19
 CONTRACT # 99653
 R4E

SUMMARY OF QUANTITIES			
	PAY ITEM	UNIT OF MEASURE	QUANTITY
40200800	AGGREGATE SURFACE COURSE, TYPE B	TON	50
40600290	BITUMINOUS MATERIALS (TACK COAT)	POUND	7350
40602965	HOT-MIX ASPHALT BINDER COURSE, IL-9.5 FG, N50	TON	1350
40604050	HOT-MIX ASPHALT SURFACE COURSE, IL-9.5 MIX "C", N50	TON	1750
44000157	HOT-MIX ASPHALT SURFACE REMOVAL, 2"	SQ YD	550
48102100	AGGREGATE WEDGE SHOULDERS, TYPE B	TON	400
67100100	MOBILIZATION	LSUM	1
70100460	TRAFFIC CONTROL AND PROTECTION, STANDARD 701306	LSUM	1
70300100	SHORT-TERM PAVEMENT MARKING	FOOT	2600
70300150	SHORT-TERM PAVEMENT MARKING REMOVAL	SQ FT	450
78000200	THERMOPLASTIC PAVEMENT MARKING - LINE 4"	FOOT	19183

Δ SPECIALTY ITEMS

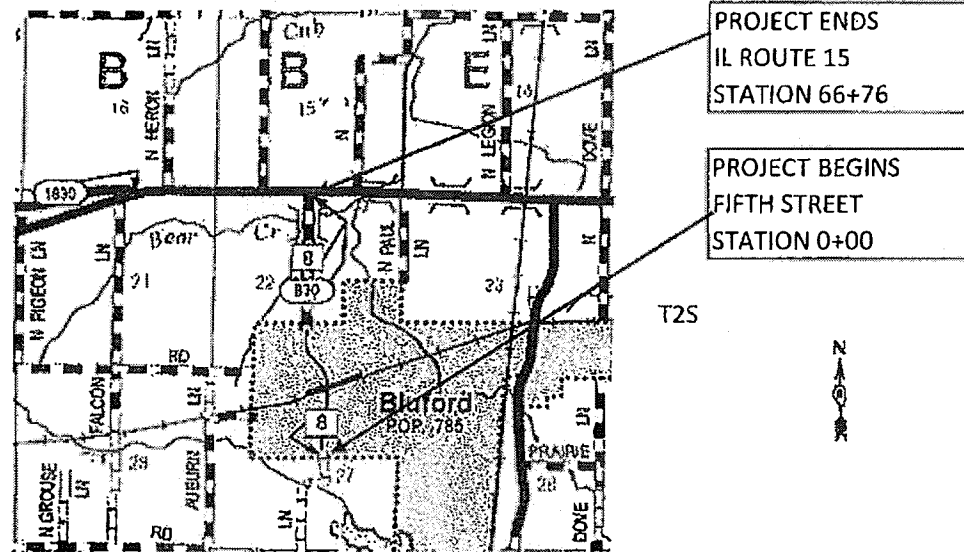

SCALE: 1 MILE

FUNCTIONAL CLASSIFICATION: LOCAL ROAD
 DESIGN SPEED = 55MPH
 TOTAL SECTION LENGTH = 6,676' = 1.264 MILES



APPROVED 5-14, 2020
 COUNTY ENGINEER
 JEFFERSON COUNTY HIGHWAY DEPARTMENT
 750 OLD FAIRFIELD ROAD
 MT. VERNON, IL 62864
 PH: (618) 244-8031
 LICENCE EXP. 11-30-2021

APPROVED MAY 28, 2020
 DISTRICT 9 ENGINEER OF LOCAL ROADS AND STREETS

RELEASING FOR BID BASED OF LIMITED REVIEW
MAY 28, 2020
 Keith Roberts
 KEITH ROBERTS, P.E.
 ACTING DEPUTY DIRECTOR OF HIGHWAYS
 REGION 5 ENGINEER
 STATE OF ILLINOIS
 DEPARTMENT OF TRANSPORTATION

PRINTED BY THE AUTHORITY OF
 THE STATE OF ILLINOIS

ROUTE	SECTION	COUNTY	TOT. SHTS.	SHEET
CH 8	18-00218-00-RS	JEFFERSON	3	2

CONTRACT 99653

TYPICAL #1 EXISTING CROSS-SECTION
0+00 to 66+76

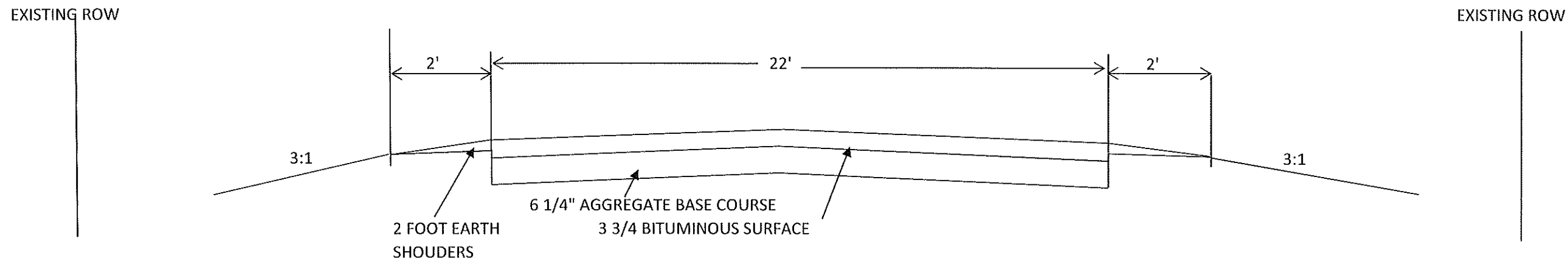

TYPICAL #2 PROPOSED CROSS-SECTION
0+00 TO 66+76

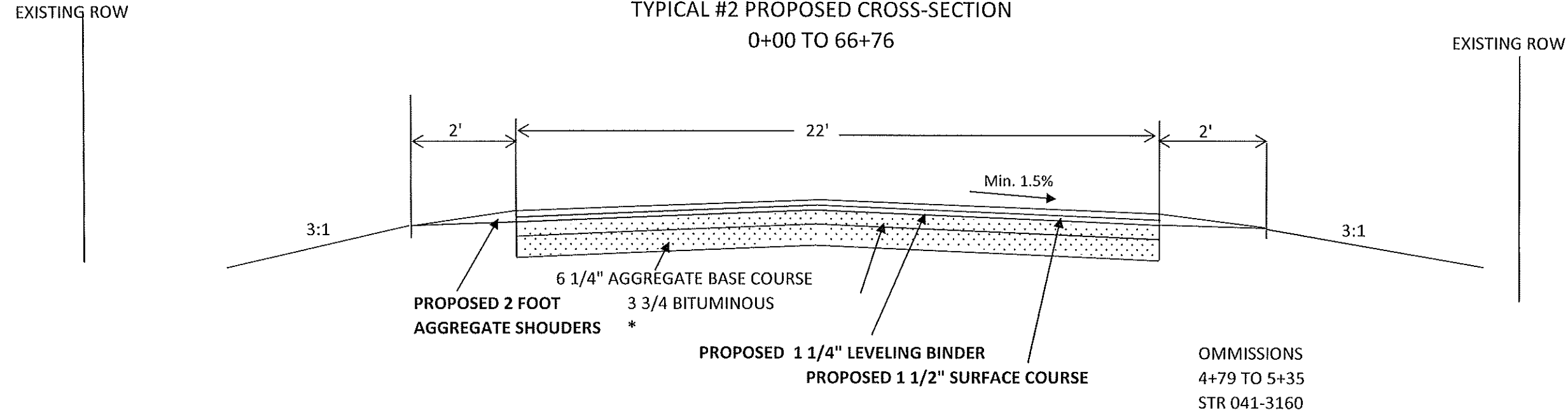

* Additional quantity included for drop-off

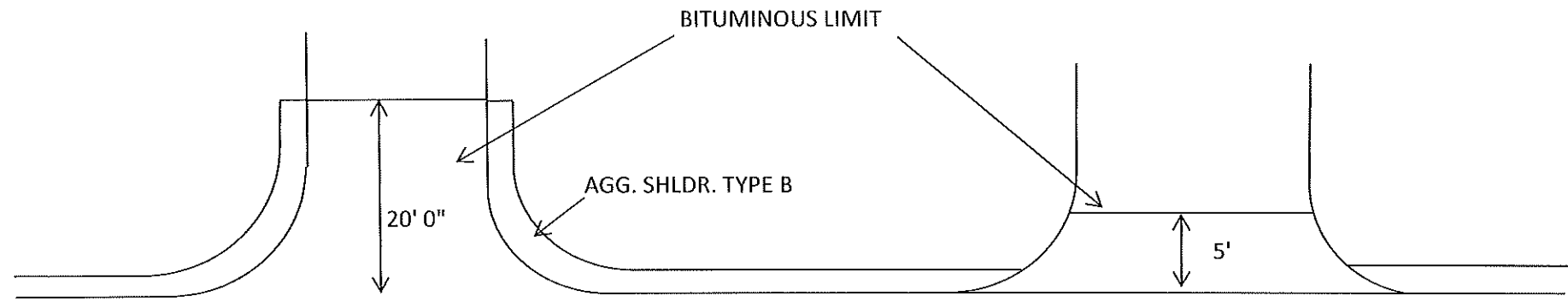

DETAIL OF SIDE ROAD INTERSECTION (9 EACH)
25 TONS HMA (EACH) INCLUDED IN PROPOSAL

DETAIL OF PRIVATE ENTRANCE (10 EACH)
5 TONS HMA (EACH) INCLUDED IN PROPOSAL

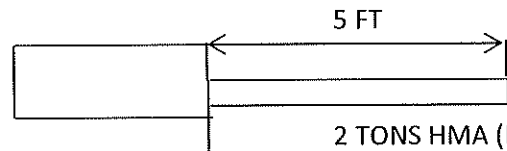
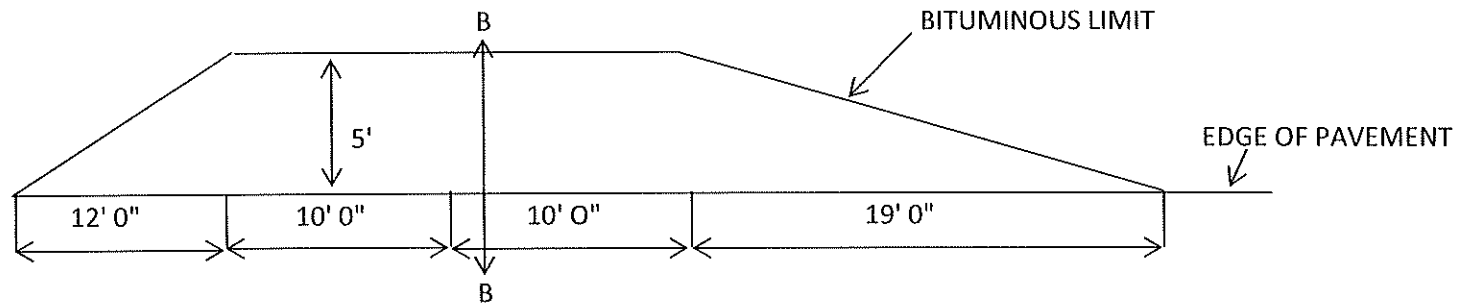

DETAIL OF MAILBOX TURNOUT

2 TONS HMA (EACH) INCLUDED IN PROPOSAL

ROUTE	SECTION	COUNTY	TOT. SHTS.	SHEET
CH 8	18-00218-00-RS	JEFFERSON	3	3

CONTRACT 99653

GENERAL NOTES

ALL CONSTRUCTION SHALL BE DONE IN ACCORDANCE WITH THE STATE OF ILLINOIS "STANDARD SPECIFICATIONS FOR ROAD AND BRIDGE CONSTRUCTION ADOPTED APRIL 1, 2016", "SUPPLEMENTAL SPECIFICATIONS AND RECURRING SPECIAL PROVISIONS ADOPTED APRIL 1, 2020", THESE PLANS AND THE SPECIAL PROVISIONS INCLUDED IN THE CONTRACT DOCUMENTS

THE LOCATION OF ALL UTILITIES SHALL BE DETERMINED BY THE CONTRACTOR

THE CONTRACTOR SHALL PROVIDE ACCESS TO ABUTTING PROPERTY AT ALL TIMES DURING THE CONSTRUCTION OF THE PROJECT

THE FOLLOWING RATES HAVE BEEN USED IN CALCULATING PLAN QUANTITIES

AGGREGATE SURFACE COURSE, TYPE B	2.00 TON/CU YD
HOT-MIX ASPHALT	115 LB/SY/IN
TACK COAT	0.05 LB / SF

STRUCTURAL DESIGN TRAFFIC		YEAR 2020	
PV = 748	SU = 76	MU = 26	
CLASSIFICATION: MAJOR COLLECTOR			
PERCENT OF STRUCTURAL DESIGN TRAFFIC IN DESIGN LANE			
P = 88	S = 9	M = 3	
TRAFFIC FACTOR		TF = 0.057	
PG GRADE	BINDER =	64-22	
	SURFACE =	64-22	
IBR = 3			

STRIPING SCHEDULE				
DIRECTION		BEG	END	TOTAL
NB	NPZ	0+00	20+00	2000
NB	NPZ	61+76	66+76	500
SB	NPZ	0+00	27+00	2700
	SKIP	20+00	66+76	1169
	EDGE	0+00	66+76	12814
			TOTAL	19183

HOT-MIX ASPHALT MIXTURE REQUIREMENTS	
MIXTURE TYPE	AIR VOIDS @ NDES
HOT-MIX ASPHALT SURFACE COURSE, MIX "C", N50 (IL 9.5 mm)	4% @ 70 GYR.
BINDER (MACHINE METHOD), N50 (IL 9.5 mm)	4% @ 70 GYR.
CLASS D PATCHES (HMA BINDER IL-19 mm)	4% @ 70 GYR.