

RTE.	SECTION	COUNTY	TOTAL SHEETS	SHEET NO.
FAU6711	19-00194-00-RS	TAZEWELL	13	1

INDEX OF SHEETS

1. COVER SHEET
2. SUMMARY OF QUANTITIES
3. PAVEMENT MARKING SCHEDULE
4. TYPICAL SECTIONS
- 5.-12. PLAN VIEWS
13. MISCELLANEOUS DETAILS
- 14.-18. DISTRICT STANDARDS

LIST OF STANDARDS

- 000001-08
- 001006
- 604001-05
- 701422-10
- 701431-13
- 701901-08

DISTRICT 4 STANDARDS

- 406101-D4
- 780001-D4

DRAWING SCALES

PLAN: 1" = 80'

FULL SIZE PLANS HAVE BEEN PREPARED USING STANDARD ENGINEERING SCALES. REDUCED SIZED PLANS WILL NOT CONFORM TO STANDARD SCALES. IN MAKING MEASUREMENTS ON REDUCED PLANS, THE ABOVE SCALES MAY BE USED.

J.U.L.I.E.
JOINT UTILITY LOCATION INFORMATION FOR EXCAVATION
1-800-892-0123
OR 811

CITY ENGINEER JOSIE ESKER, PE, SE (309) 478-5399



Josie A. Esker



CONTRACT NO. 89784

CATALOG NO. 036034-00

DEPARTMENT OF TRANSPORTATION
**PROPOSED
HIGHWAY PLANS**

SECTION 19-00194-00-RS
PROJECT 75IW(149)
MILL & OVERLAY
PARKWAY DR. FROM WILLOW TO LICK CREEK
CITY OF PEKIN
TAZEWELL COUNTY
JOB NO. C-94-061-20

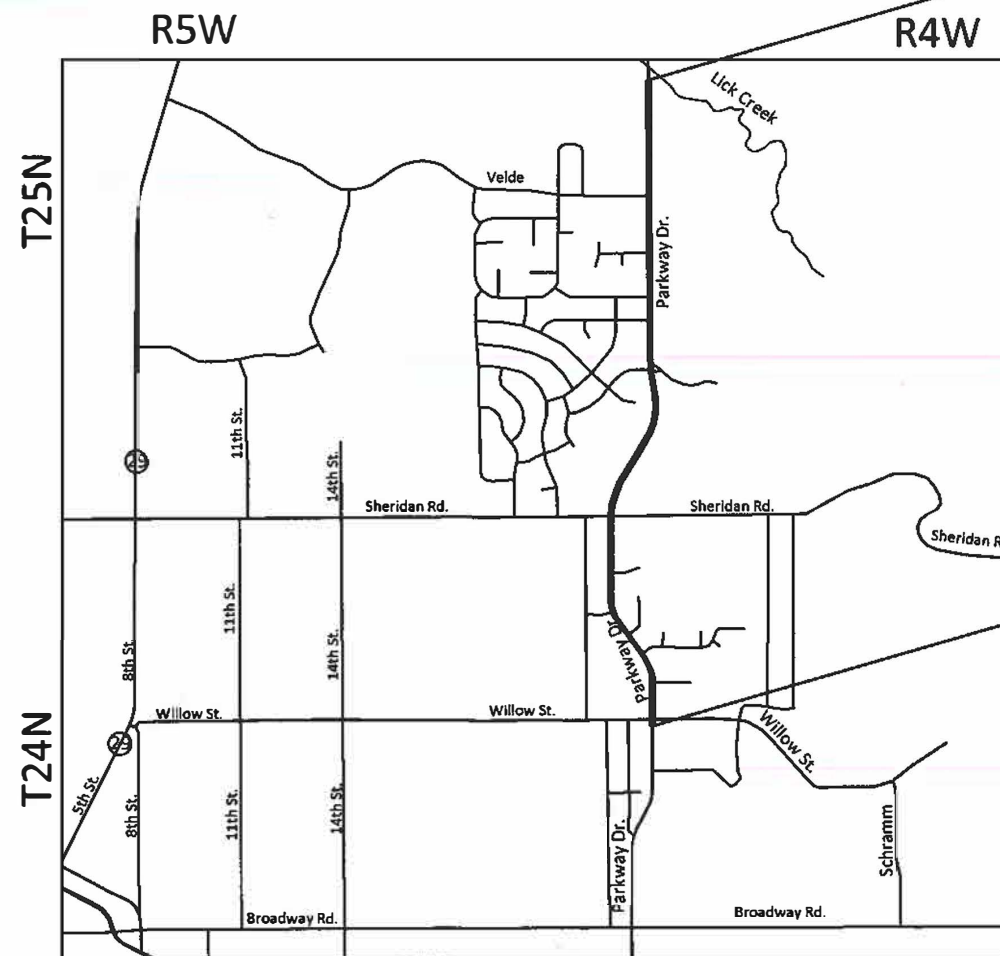

PROJECT ENDS
STA. 147+10.00

PROJECT STARTS
STA. 60+43.00

LOCATION MAP

0' 1500' 3000'

GROSS LENGTH = 8667 FT = 1.64 MILES
NET LENGTH = 8667 FT = 1.64 MILES

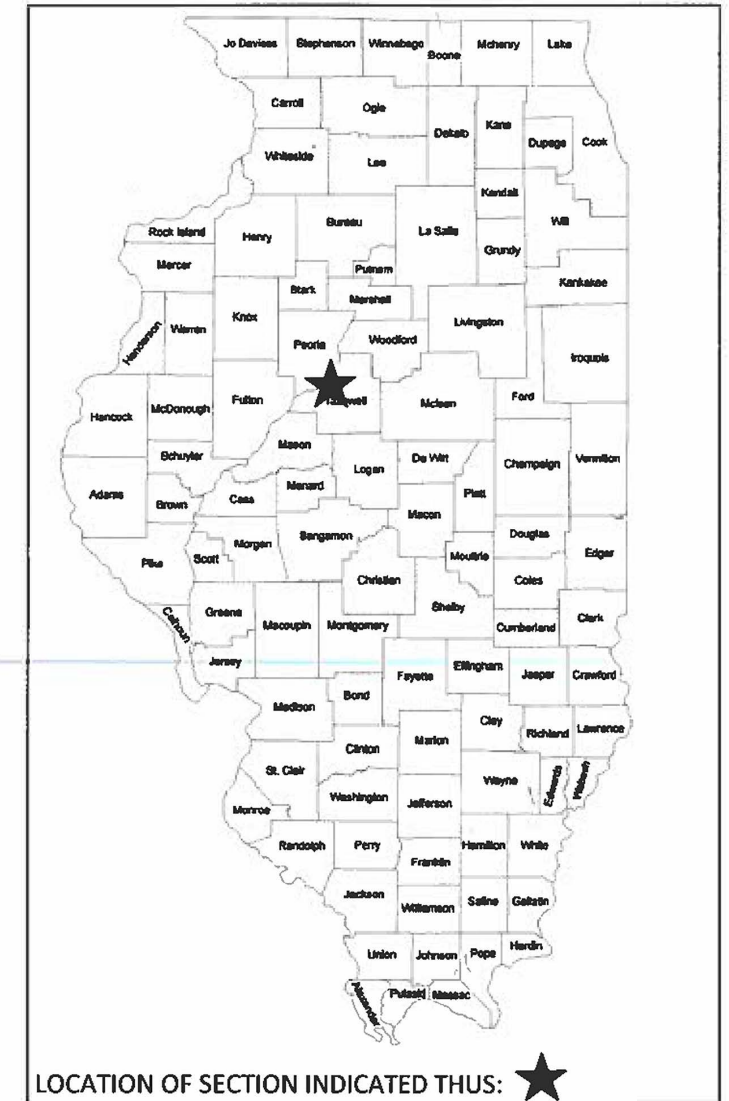

APPROVED MAY 11TH 20 21
Josie A. Esker
LOCAL AGENCY OFFICIAL

PASSED June 1 20 21
Tony Savin SA
DISTRICT FOUR ENGINEER
OF LOCAL ROADS & STREETS

Releasing For Bid Based on Limited Review
June 1 20 21
Paul A. ...
REGION THREE ENGINEER

STATE OF ILLINOIS
DEPARTMENT OF TRANSPORTATION

**PRINTED BY THE AUTHORITY
OF THE STATE OF ILLINOIS**

SUMMARY OF QUANTITIES

ITEM NUMBER	ITEM	UNIT	QUANTITY
40600295	P BIT MATLS TACK CT	POUND	31600
40603535	P HMA SC "D" N50	TON	5300
60255800	MAN ADJ NEW T1F CL	EACH	30
67100100	MOBILIZATION	L. SUM	1
△ 78004200	PREF PL PM TB INLAID LTR-SYM	SQ FT.	98
△ 78004210	PREF PL PM TB INLAID LINE 4	FOOT	20319
△ 78004240	PREF PL PM TB INLAID LINE 8	FOOT	658
△ 78004250	PREF PL PM TB INLAID LINE 12	FOOT	131
X4401198	HMA SURF REM VAR DP	SQ. YD.	45900
X7010216	TRAF CONT & PROT SPL	L. SUM	1

△ SPECIALTY ITEMS

GENERAL NOTES:

1. ADA RAMPS TO BE BROUGHT INTO COMPLIANCE UNDER SEPARATE CONTRACT. 20-00000-00-GM
2. BEFORE STARTING ANY EXCAVATION, THE CONTRACTOR SHALL CALL "JULIE" AT 1-800-892-0123 FOR FIELD LOCATIONS OF BURIED UTILITIES AND FACILITIES. (48 HOURS NOTIFICATION IS REQUIRED.)
3. POLYMERIZED BITUMINOUS MATERIALS (TACK COAT) RATE: 0.08 LB/FT

COMMITMENTS:

NONE.



DESIGNED - JAE	REVISED- 5/11/21
DRAWN - JAE	REVISED-
CHECKED - HMM	REVISED-
DATE - 3/12/2021	REVISED-

STATE OF ILLINOIS
DEPARTMENT OF TRANSPORTATION

SUMMARY OF QUANTITIES

RTE.	SECTION	COUNTY	TOTAL SHEETS	SHEET NO.
FAU 6711	19-00194-00-RS	TAZEWELL	18	2
Contract No. 89784				

PAVEMENT MARKING SCHEDULE

LOCATION	WHITE 4" SKIP DASH	SOLID WHITE 4" LINE	SOLID DOUBLE YELLOW LINE	SOLID WHITE 8" LINE	SOLID WHITE 12" STOP BAR	SOLID WHITE LETTERS & SYMBOLS
STA. 60+43 TO STA. 61+22		35 FEET	35 FEET	390 FEET	48 FEET	1 TURN ARROW 1 COMBO ARROW
STA. 61+22 TO STA. 87+35	1300 FEET		2613 FEET			
STA. 87+35 TO STA. 93+96	280 FEET			268 FEET	59 FEET	
STA. 131+65 LT					24 FEET	
STA. 132+00 TO STA. 133+20 LT		120 FEET				2 TURN ARROWS
STA. 93+96 TO STA. 147+10	2660 FEET		5314 FEET			
TOTALS	4240 FEET	155 FEET	7962*2 = 15924 FEET	658 FEET	131 FEET	98.8 SQ. FT.



DESIGNED - JAE	REVISED- 5/11/21
DRAWN - JAE	REVISED-
CHECKED - HMM	REVISED-
DATE - 3/12/2021	REVISED-

STATE OF ILLINOIS
DEPARTMENT OF TRANSPORTATION

PAVEMENT MARKING
SCHEDULE

RTE.	SECTION	COUNTY	TOTAL SHEETS	SHEET NO.
FAU 6711	19-00194-00-RS	TAZEWELL	18	3
Contract No. 89784				

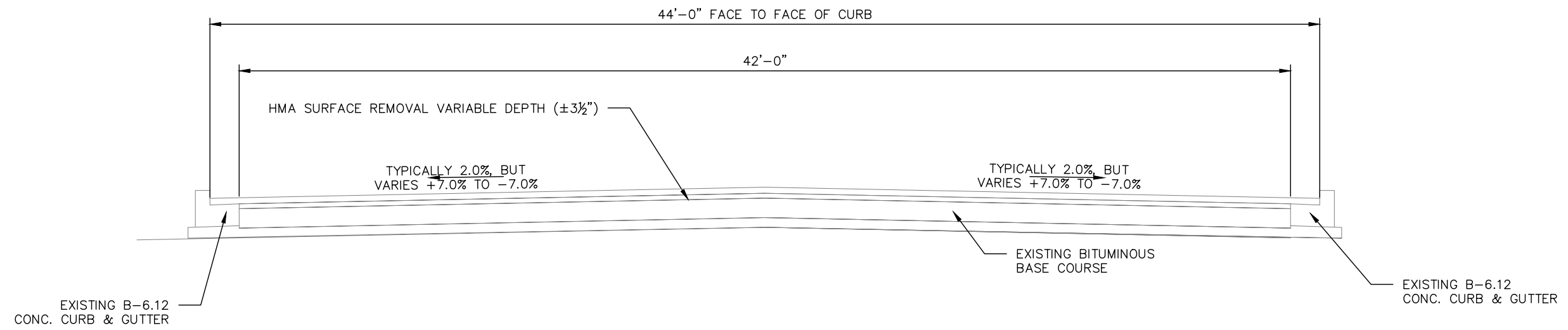

1
4 N.T.S. TYPICAL EXISTING SECTION - PARKWAY DR.

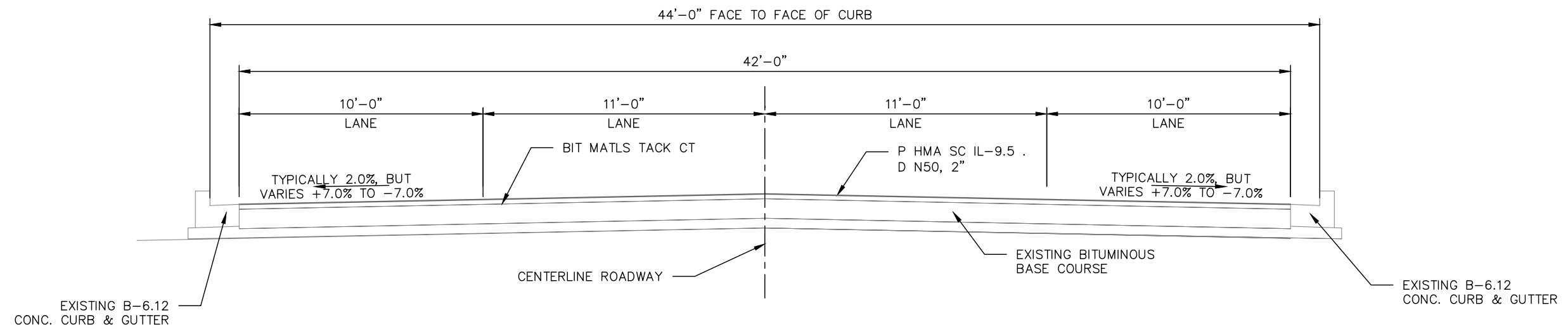

2
4 N.T.S. TYPICAL PROPOSED SECTION - PARKWAY DR.

HMA MIXTURE REQUIREMENTS:

LOCATION:	PARKWAY DRIVE
USE:	SURFACE
PG:	SBR 64-28
DESIGN AIR VOIDS:	4.0% @ N=50
MIXTURE COMPOSITION (MIXTURE GRADATION)	IL 9.5
FRICTION AGGREGATE:	MIXTURE D
MIXTURE WEIGHT:	112 LBS/IN/SQ YD
QUALITY MANAGEMENT PROGRAM:	QCQA
SUBLOT SIZE:	N.A

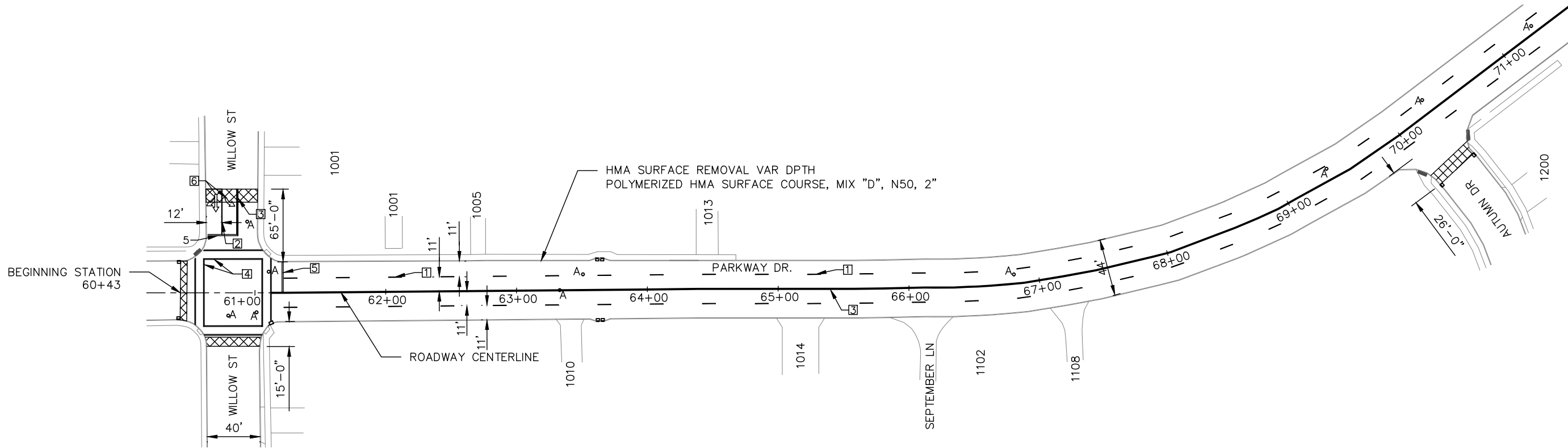
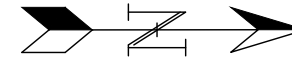

LEGEND

PAVEMENT BUTT JOINT PER DISTRICT 4 IDOT STANDARD 406101-D4 WITH TEMPORARY RAMP

MANHOLE TO BE ADJUSTED

LANE LINE SKIP DASH, WHITE 4"

LANE LINE SOLID, WHITE 4"

LANE LINE SOLID, DOUBLE YELLOW 4"

LANE LINE SOLID, WHITE 8"

LANE LINE SOLID, WHITE 12"

LETTERS & SYMBOLS (URBAN)

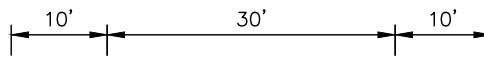

NOTES:

1. MANHOLES SHALL BE ADJUSTED AFTER PLACEMENT OF HMA SURFACE OVERLAY. SEE DETAIL.
2. ALL BARRICADES IN ROADWAY SHALL HAVE LIGHTS.



DESIGNED - JAE	REVISED- 5/11/21
DRAWN - JAE	REVISED-
CHECKED - HMM	REVISED-
DATE - 3/12/2021	REVISED-

STATE OF ILLINOIS
DEPARTMENT OF TRANSPORTATION

PLAN VIEW

RTE.	SECTION	COUNTY	TOTAL SHEETS	SHEET NO.
FAU 6711	19-00194-00-RS	TAZEWELL	18	5
Contract No. 89784				

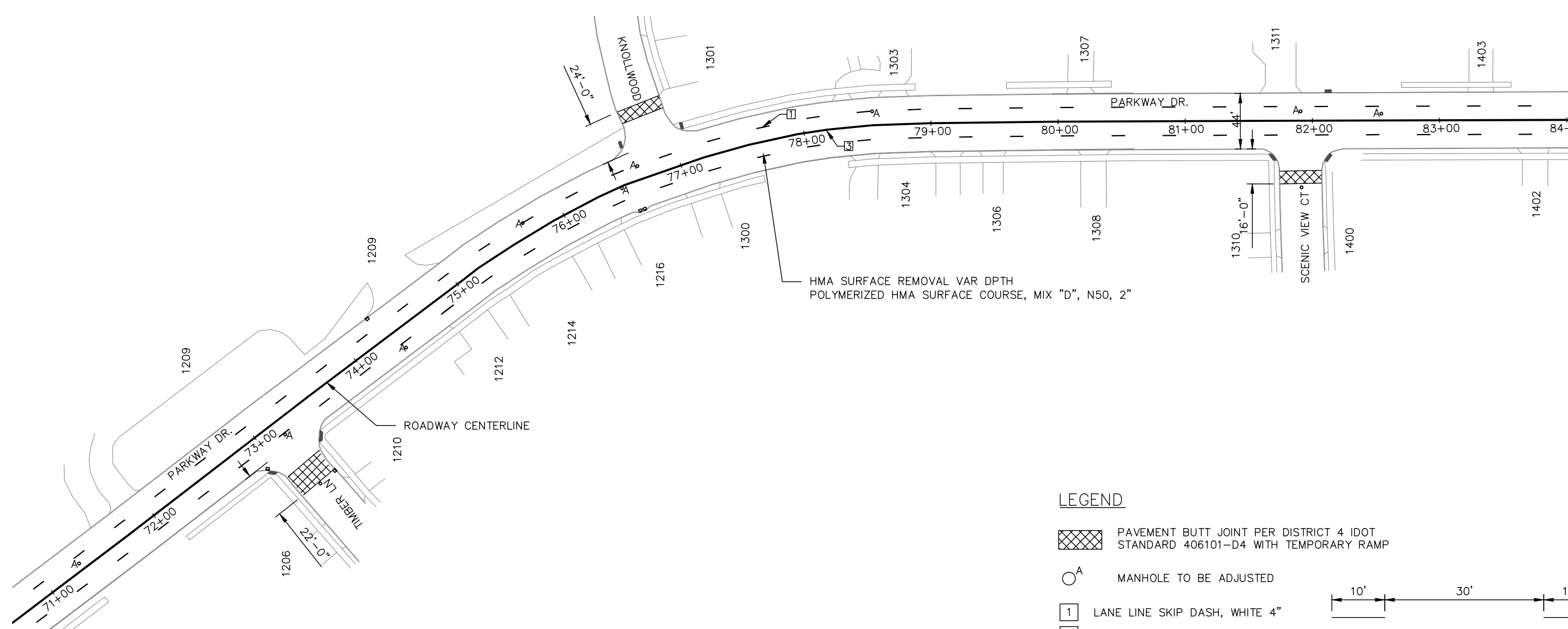
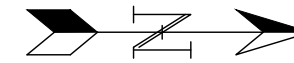

NOTES:

1. MANHOLES SHALL BE ADJUSTED AFTER PLACEMENT OF HMA SURFACE OVERLAY. SEE DETAIL.
2. ALL BARRICADES IN ROADWAY SHALL HAVE LIGHTS.

LEGEND

PAVEMENT BUTT JOINT PER DISTRICT 4 IDOT STANDARD 406101-D4 WITH TEMPORARY RAMP

MANHOLE TO BE ADJUSTED

- LANE LINE SKIP DASH, WHITE 4"
- LANE LINE SOLID, WHITE 4"
- LANE LINE SOLID, DOUBLE YELLOW 4"
- LANE LINE SOLID, WHITE 8"
- LANE LINE SOLID, WHITE 12"
- LETTERS & SYMBOLS (URBAN)

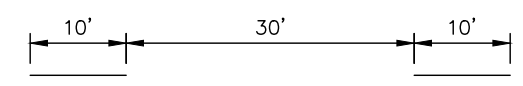

DESIGNED - JAE	REVISED- 5/11/21
DRAWN - JAE	REVISED-
CHECKED - HMM	REVISED-
DATE - 3/12/2021	REVISED-

STATE OF ILLINOIS
DEPARTMENT OF TRANSPORTATION

PLAN VIEW

RTE.	SECTION	COUNTY	TOTAL SHEETS	SHEET NO.
FAU 6711	19-00194-00-RS	TAZEWELL	18	6
Contract No. 89784				

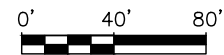
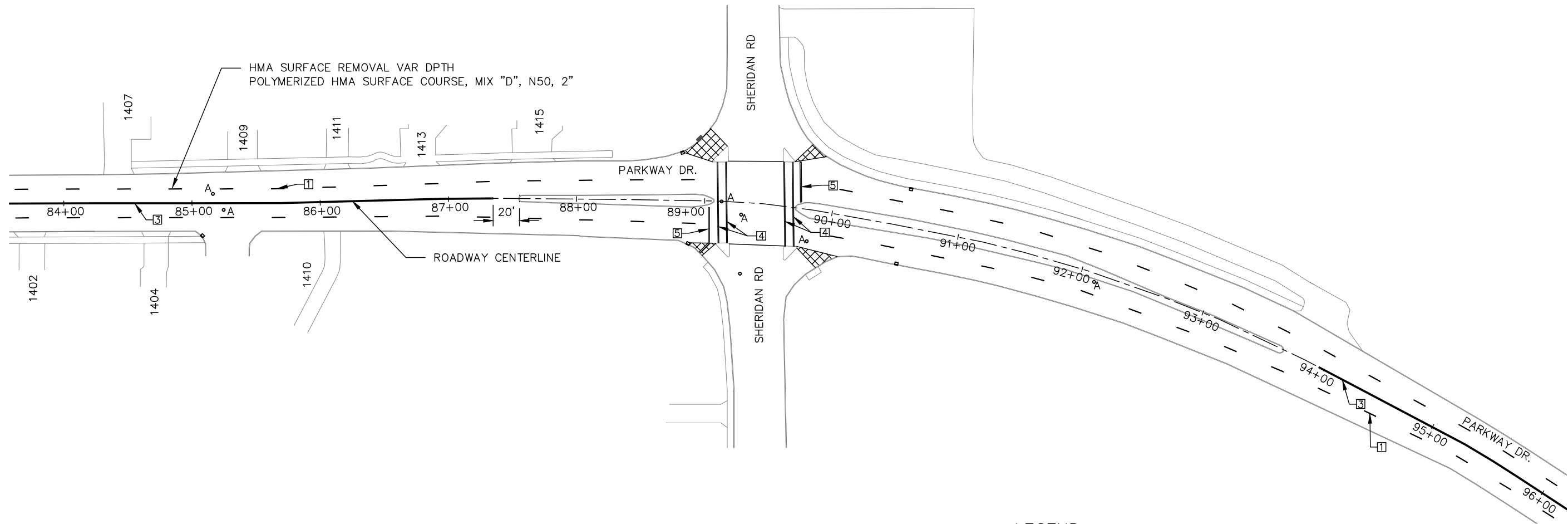
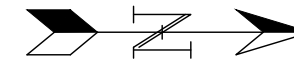

NOTES:

1. MANHOLES SHALL BE ADJUSTED AFTER PLACEMENT OF HMA SURFACE OVERLAY. SEE DETAIL.
2. ALL BARRICADES IN ROADWAY SHALL HAVE LIGHTS.

LEGEND

PAVEMENT BUTT JOINT PER DISTRICT 4 IDOT STANDARD 406101-D4 WITH TEMPORARY RAMP

MANHOLE TO BE ADJUSTED

- LANE LINE SKIP DASH, WHITE 4"
- LANE LINE SOLID, WHITE 4"
- LANE LINE SOLID, DOUBLE YELLOW 4"
- LANE LINE SOLID, WHITE 8"
- LANE LINE SOLID, WHITE 12"
- LETTERS & SYMBOLS (URBAN)

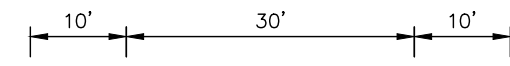

DESIGNED - JAE	REVISED- 5/11/21
DRAWN - JAE	REVISED-
CHECKED - HMM	REVISED-
DATE - 3/12/2021	REVISED-

STATE OF ILLINOIS
DEPARTMENT OF TRANSPORTATION

PLAN VIEW

RTE.	SECTION	COUNTY	TOTAL SHEETS	SHEET NO.
FAU 6711	19-00194-00-RS	TAZEWELL	18	7
Contract No. 89784				

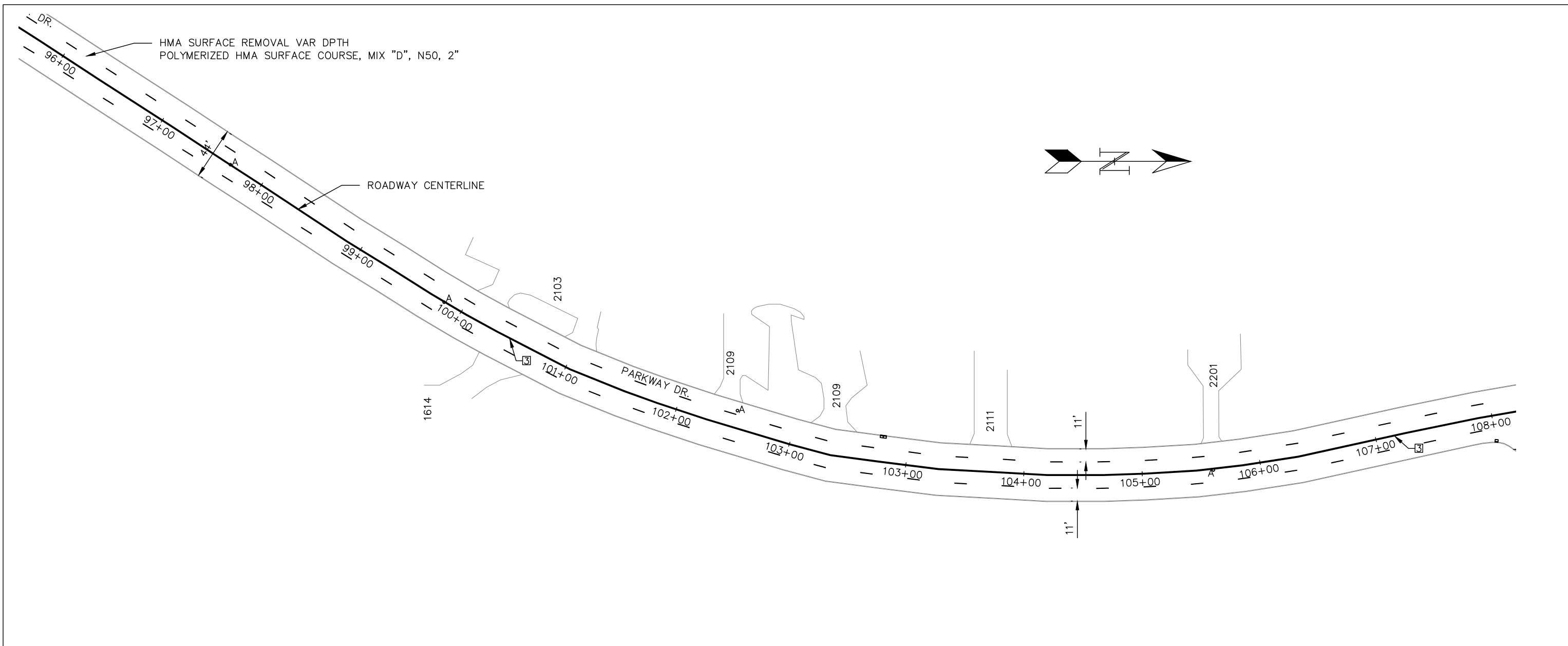

HMA SURFACE REMOVAL VAR DPTH
POLYMERIZED HMA SURFACE COURSE, MIX "D", N50, 2"

ROADWAY CENTERLINE

PARKWAY DR.

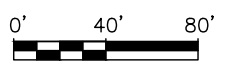
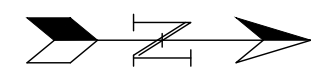

NOTES:

1. MANHOLES SHALL BE ADJUSTED AFTER PLACEMENT OF HMA SURFACE OVERLAY. SEE DETAIL.
2. ALL BARRICADES IN ROADWAY SHALL HAVE LIGHTS.

LEGEND

PAVEMENT BUTT JOINT PER DISTRICT 4 IDOT STANDARD 406101-D4 WITH TEMPORARY RAMP

MANHOLE TO BE ADJUSTED

LANE LINE SKIP DASH, WHITE 4"

LANE LINE SOLID, WHITE 4"

LANE LINE SOLID, DOUBLE YELLOW 4"

LANE LINE SOLID, WHITE 8"

LANE LINE SOLID, WHITE 12"

LETTERS & SYMBOLS (URBAN)

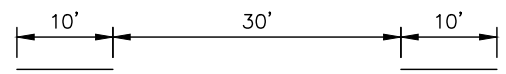

DESIGNED - JAE	REVISED- 5/11/21
DRAWN - JAE	REVISED-
CHECKED - HMM	REVISED-
DATE - 3/12/2021	REVISED-

STATE OF ILLINOIS
DEPARTMENT OF TRANSPORTATION

PLAN VIEW

RTE.	SECTION	COUNTY	TOTAL SHEETS	SHEET NO.
FAU 6711	19-00194-00-RS	TAZEWELL	18	8
Contract No. 89784				

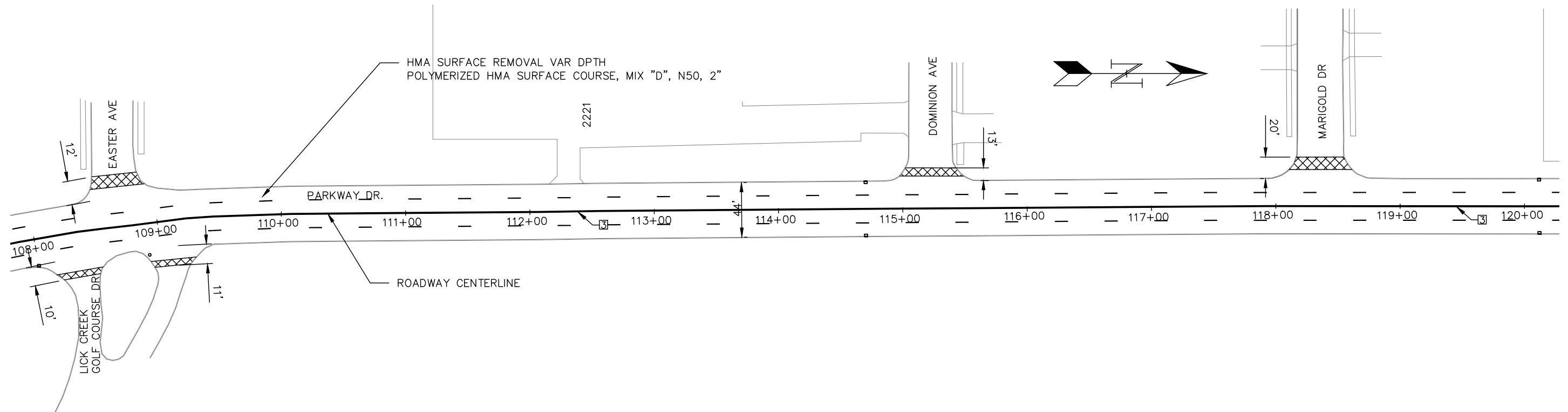

LEGEND

PAVEMENT BUTT JOINT PER DISTRICT 4 IDOT STANDARD 406101-D4 WITH TEMPORARY RAMP

MANHOLE TO BE ADJUSTED

- LANE LINE SKIP DASH, WHITE 4"
- LANE LINE SOLID, WHITE 4"
- LANE LINE SOLID, DOUBLE YELLOW 4"
- LANE LINE SOLID, WHITE 8"
- LANE LINE SOLID, WHITE 12"
- LETTERS & SYMBOLS (URBAN)

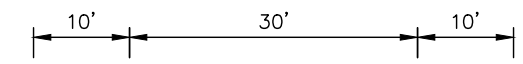

NOTES:

1. MANHOLES SHALL BE ADJUSTED AFTER PLACEMENT OF HMA SURFACE OVERLAY. SEE DETAIL.
2. ALL BARRICADES IN ROADWAY SHALL HAVE LIGHTS.

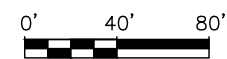

DESIGNED - JAE	REVISED- 5/11/21
DRAWN - JAE	REVISED-
CHECKED - HMM	REVISED-
DATE - 3/12/2021	REVISED-

STATE OF ILLINOIS
DEPARTMENT OF TRANSPORTATION

PLAN VIEW

RTE.	SECTION	COUNTY	TOTAL SHEETS	SHEET NO.
FAU 6711	19-00194-00-RS	TAZEWELL	18	9
Contract No. 89784				

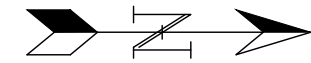
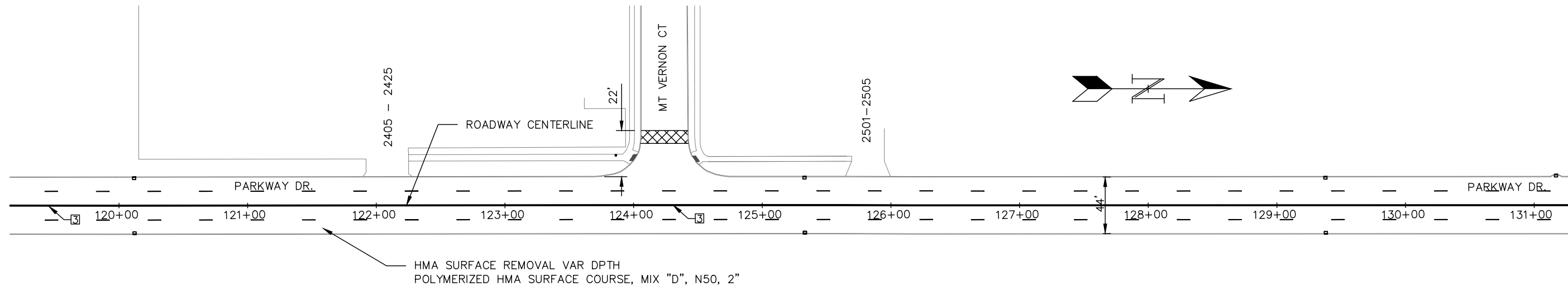

LEGEND

 PAVEMENT BUTT JOINT PER DISTRICT 4 IDOT STANDARD 406101-D4 WITH TEMPORARY RAMP

 MANHOLE TO BE ADJUSTED

 1 LANE LINE SKIP DASH, WHITE 4"

 2 LANE LINE SOLID, WHITE 4"

 3 LANE LINE SOLID, DOUBLE YELLOW 4"

 4 LANE LINE SOLID, WHITE 8"

 5 LANE LINE SOLID, WHITE 12"

 6 LETTERS & SYMBOLS (URBAN)

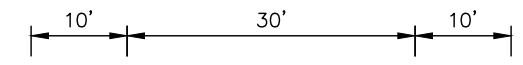

NOTES:

1. MANHOLES SHALL BE ADJUSTED AFTER PLACEMENT OF HMA SURFACE OVERLAY. SEE DETAIL.
2. ALL BARRICADES IN ROADWAY SHALL HAVE LIGHTS.

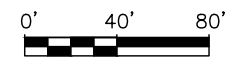

DESIGNED - JAE	REVISED- 5/11/21
DRAWN - JAE	REVISED-
CHECKED - HMM	REVISED-
DATE - 3/12/2021	REVISED-

STATE OF ILLINOIS
DEPARTMENT OF TRANSPORTATION

PLAN VIEW

RTE.	SECTION	COUNTY	TOTAL SHEETS	SHEET NO.
FAU 6711	19-00194-00-RS	TAZEWELL	18	10
Contract No. 89784				

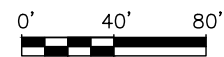
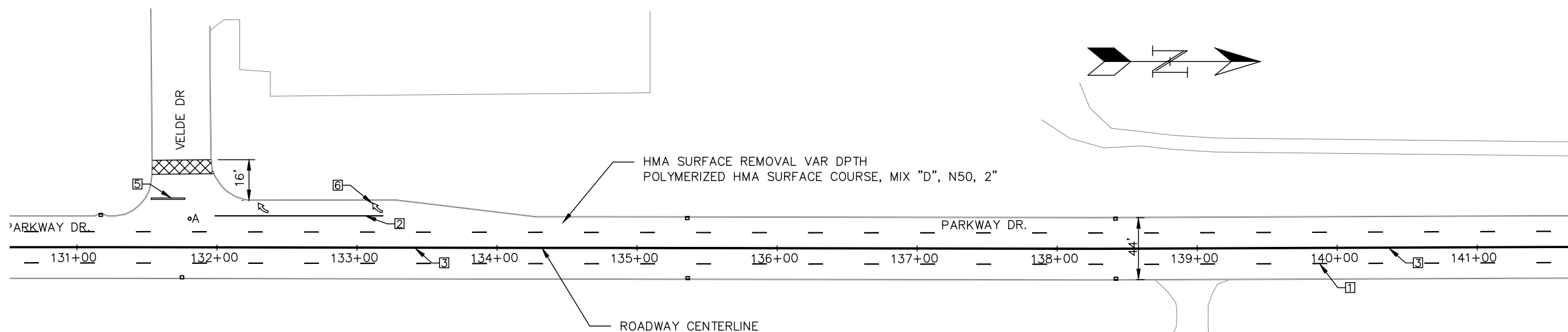

NOTES:

1. MANHOLES SHALL BE ADJUSTED AFTER PLACEMENT OF HMA SURFACE OVERLAY. SEE DETAIL.
2. ALL BARRICADES IN ROADWAY SHALL HAVE LIGHTS.

LEGEND

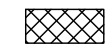
 PAVEMENT BUTT JOINT PER DISTRICT 4 IDOT STANDARD 406101-D4 WITH TEMPORARY RAMP

 MANHOLE TO BE ADJUSTED

 LANE LINE SKIP DASH, WHITE 4"

 LANE LINE SOLID, WHITE 4"

 LANE LINE SOLID, DOUBLE YELLOW 4"

 LANE LINE SOLID, WHITE 8"

 LANE LINE SOLID, WHITE 12"

 LETTERS & SYMBOLS (URBAN)

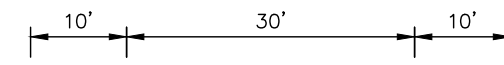

DESIGNED - JAE	REVISED- 5/11/21
DRAWN - JAE	REVISED-
CHECKED - HMM	REVISED-
DATE - 3/12/2021	REVISED-

STATE OF ILLINOIS
DEPARTMENT OF TRANSPORTATION

PLAN VIEW

RTE.	SECTION	COUNTY	TOTAL SHEETS	SHEET NO.
FAU 6711	19-00194-00-RS	TAZEWELL	18	11
Contract No. 89784				

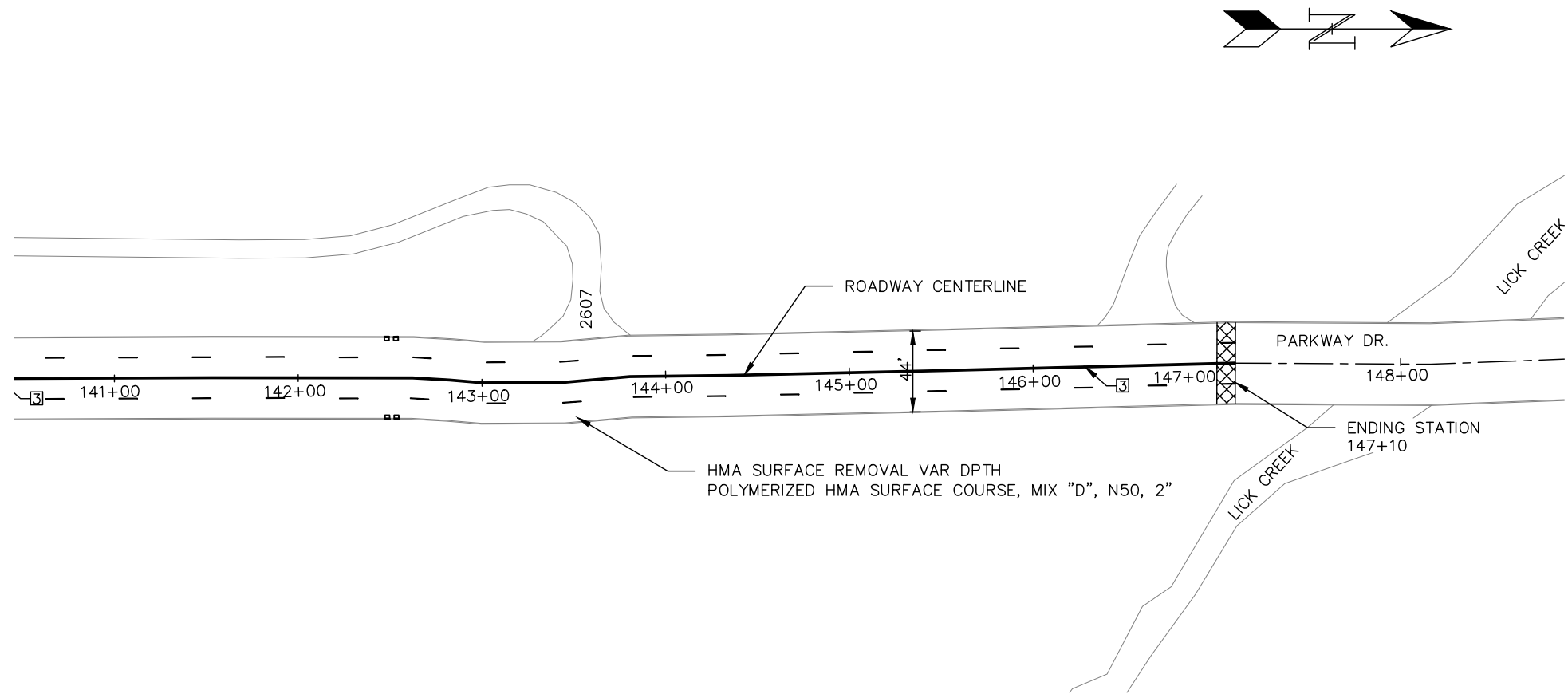

LEGEND

 PAVEMENT BUTT JOINT PER DISTRICT 4 IDOT STANDARD 406101-D4 WITH TEMPORARY RAMP

 MANHOLE TO BE ADJUSTED

 LANE LINE SKIP DASH, WHITE 4"

 LANE LINE SOLID, WHITE 4"

 LANE LINE SOLID, DOUBLE YELLOW 4"

 LANE LINE SOLID, WHITE 8"

 LANE LINE SOLID, WHITE 12"

 LETTERS & SYMBOLS (URBAN)

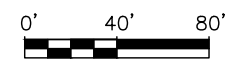
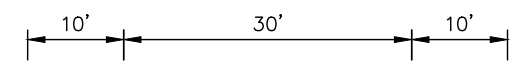

NOTES:

1. MANHOLES SHALL BE ADJUSTED AFTER PLACEMENT OF HMA SURFACE OVERLAY. SEE DETAIL.
2. ALL BARRICADES IN ROADWAY SHALL HAVE LIGHTS.



DESIGNED - JAE	REVISED- 5/11/21
DRAWN - JAE	REVISED-
CHECKED - HMM	REVISED-
DATE - 3/12/2021	REVISED-

STATE OF ILLINOIS
DEPARTMENT OF TRANSPORTATION

PLAN VIEW

RTE.	SECTION	COUNTY	TOTAL SHEETS	SHEET NO.
FAU 6711	19-00194-00-RS	TAZEWELL	18	12
Contract No. 89784				

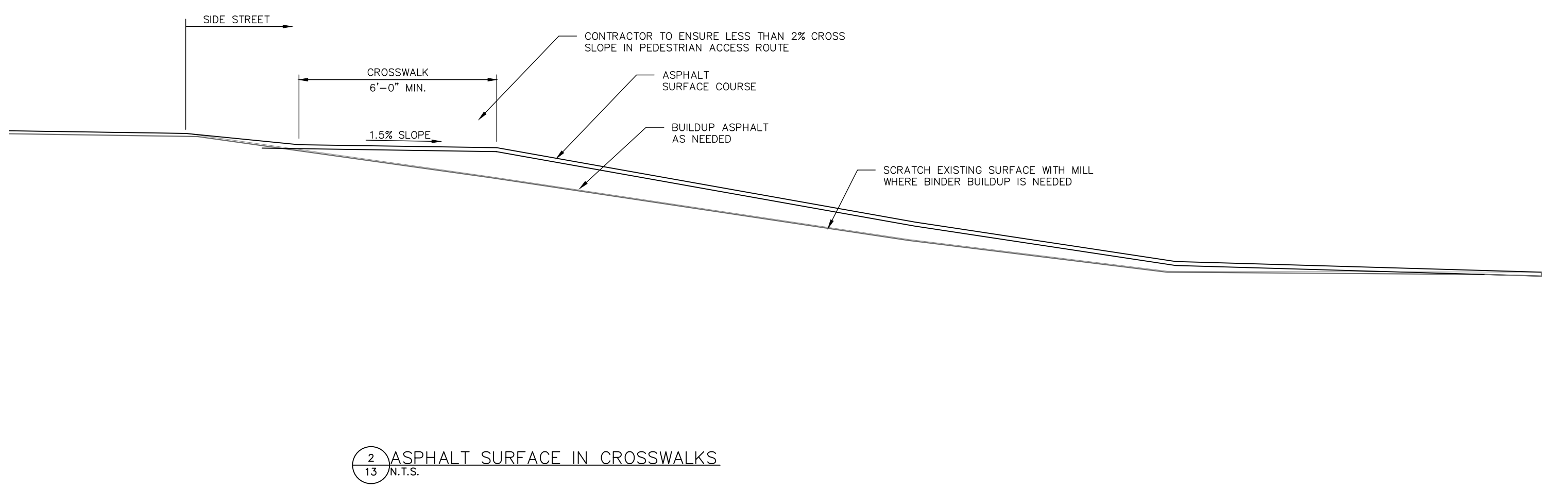
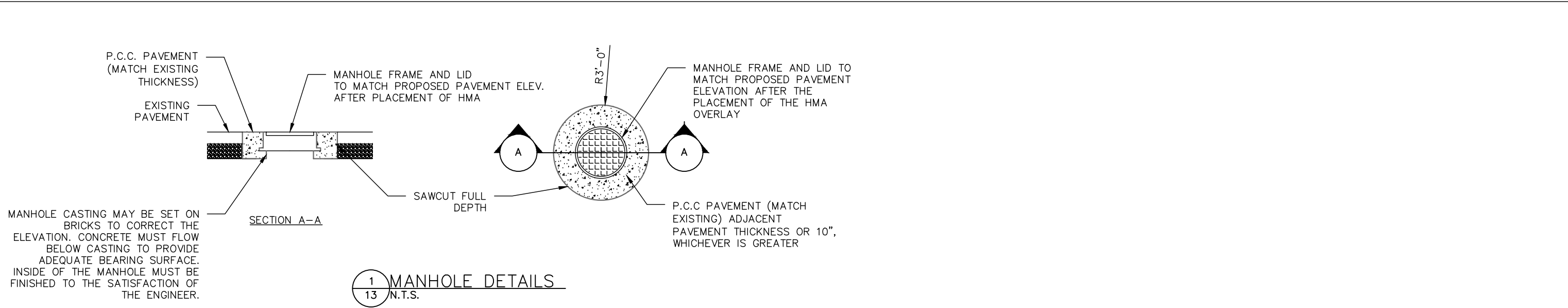

DESIGNED - JAE	REVISED- 5/11/21
DRAWN - JAE	REVISED-
CHECKED - HMM	REVISED-
DATE - 3/12/2021	REVISED-

STATE OF ILLINOIS
DEPARTMENT OF TRANSPORTATION

MISCELLANEOUS DETAILS

RTE.	SECTION	COUNTY	TOTAL SHEETS	SHEET NO.
FAU 6711	19-00194-00-RS	TAZEWELL	18	13
Contract No. 89784				

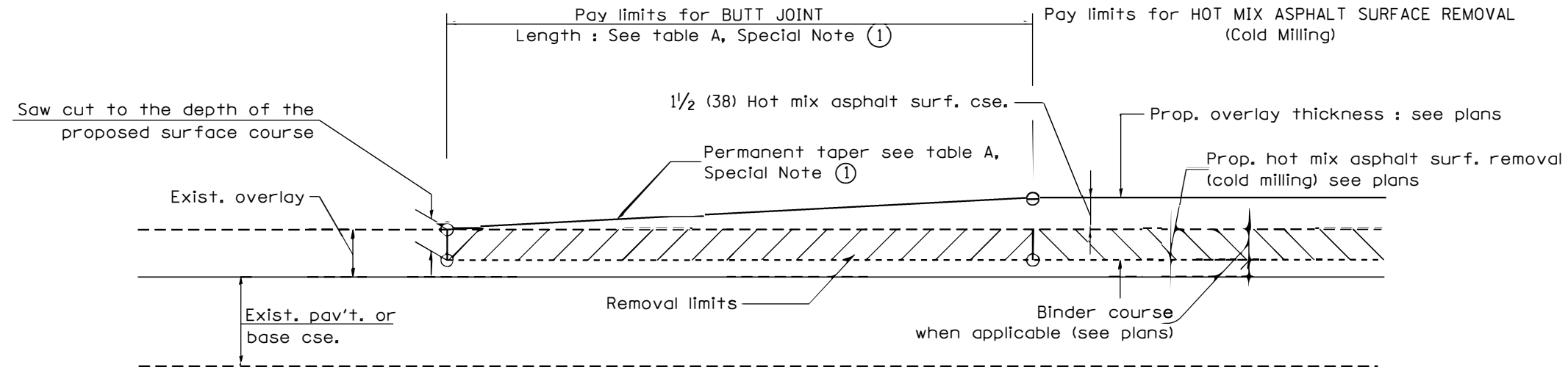

CASE 1 : WITH HOT MIX ASPHALT SURFACE REMOVAL (COLD MILLING)

**TABLE A
TAPER RATES**

SPECIAL NOTE NUMBER	ELEMENT	MAINLINE INTERSTATES & 4-LANE EXPRESSWAYS	ALL OTHERS
①	BUTT JOINT TAPER RATE	1:480	1:240
②	TEMPORARY RAMP TAPER RATE	1:80	1:40

GENERAL NOTES

1. The work shall be done in accordance with Article 406.08 and the Special Provision for Butt Joints.
2. The pavement surface to be removed may be either bituminous or P.C. concrete. The work shall be performed in accordance with Article 440.04 and the Special Provisions for Butt Joints.
3. The saw cut joints shall be primed just prior to the placing of bituminous material. The work will be in accordance with the applicable portions of Article 406.05.
4. The length of butt joint is based on the taper rate times change in cold milling depth within the butt joint pay limits, unless otherwise indicated.
5. Temporary ramps are paid for separately and not included in the cost of the butt joints.

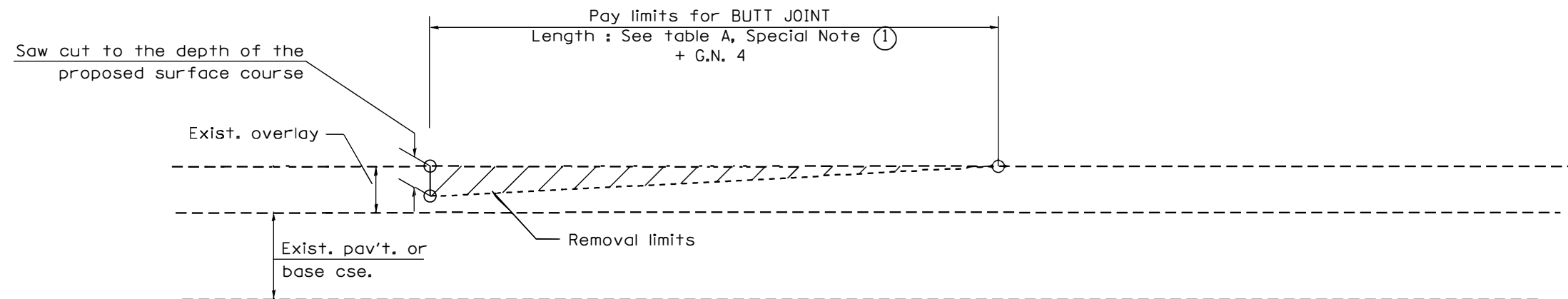

CASE 2 : NO HOT MIX ASPHALT SURFACE REMOVAL (COLD MILLING)

All dimensions are in inches (millimeters) unless otherwise noted.

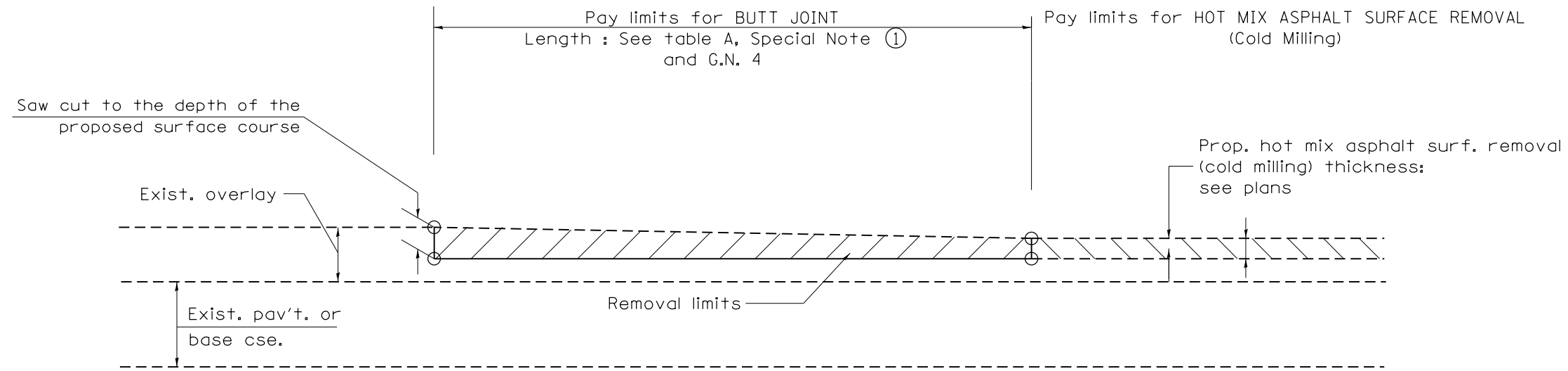

CASE 3 : HOT MIX ASPHALT SURFACE REMOVAL (COLD MILLING)
TIE-IN TO EXISTING BITUMINOUS TAPER

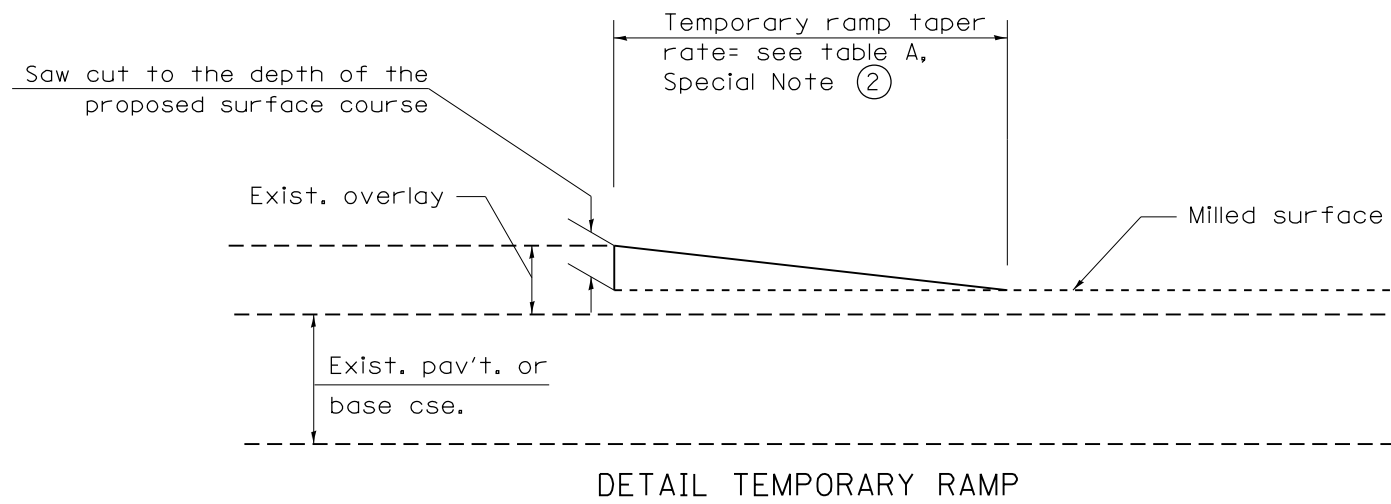

All dimensions are in inches (millimeters) unless otherwise noted.

				STATE OF ILLINOIS DEPARTMENT OF TRANSPORTATION		BUTT JOINTS		SHT. 2 OF 3 CADD STD. 406101-D4	
F.A.U. RTE.	SECTION	COUNTY	TOTAL SHEETS	SHEET NO.					
6711	19-00194-00-RS	TAZWELL	18	15					
FED. ROAD DIST. NO.			ILLINOIS FED. AID PROJECT		CONTRACT NO. 89784				

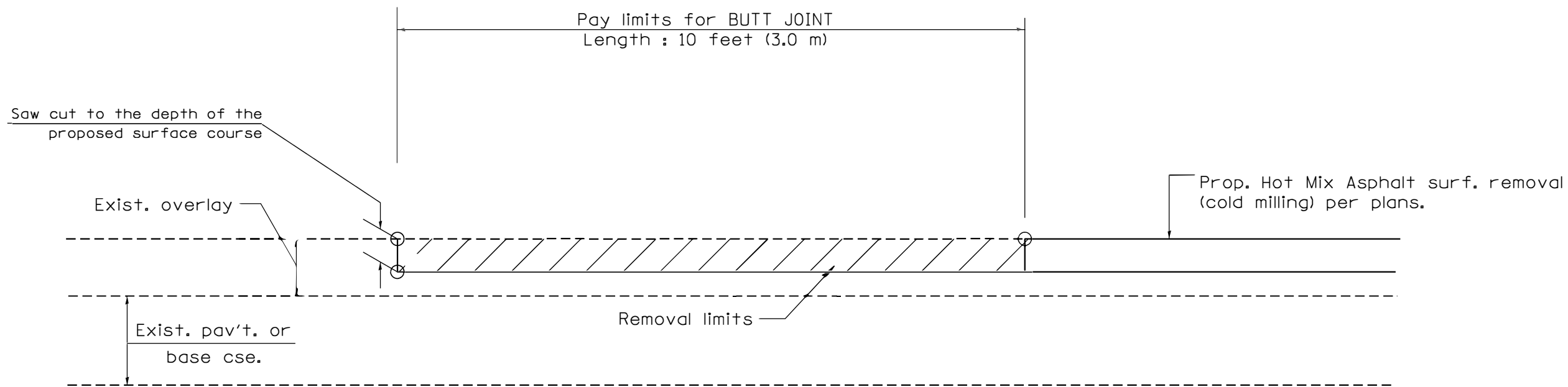

**CASE 4 : SINGLE LIFT OVERLAY WITH EQUIVALENT DEPTH
HOT MIX ASPHALT SURFACE REMOVAL (COLD MILLING)
TIE-IN TO EXISTING BITUMINOUS TAPER**

All dimensions are in inches (millimeters) unless otherwise noted.

				STATE OF ILLINOIS DEPARTMENT OF TRANSPORTATION		BUTT JOINTS		SHT. 3 OF 3 CADD STD. 406101-D4		<table border="1"> <tr> <th>F.A.U. RTE.</th> <th>SECTION</th> <th>COUNTY</th> <th>TOTAL SHEETS</th> <th>SHEET NO.</th> </tr> <tr> <td>6711</td> <td>19-00194-00-RS</td> <td>TAZWELL</td> <td>18</td> <td>16</td> </tr> </table>		F.A.U. RTE.	SECTION	COUNTY	TOTAL SHEETS	SHEET NO.	6711	19-00194-00-RS	TAZWELL	18	16
F.A.U. RTE.	SECTION	COUNTY	TOTAL SHEETS	SHEET NO.																	
6711	19-00194-00-RS	TAZWELL	18	16																	
						NOT TO SCALE				<table border="1"> <tr> <th>FED. ROAD DIST. NO.</th> <th>ILLINOIS FED. AID PROJECT</th> </tr> <tr> <td></td> <td></td> </tr> </table>		FED. ROAD DIST. NO.	ILLINOIS FED. AID PROJECT								
FED. ROAD DIST. NO.	ILLINOIS FED. AID PROJECT																				

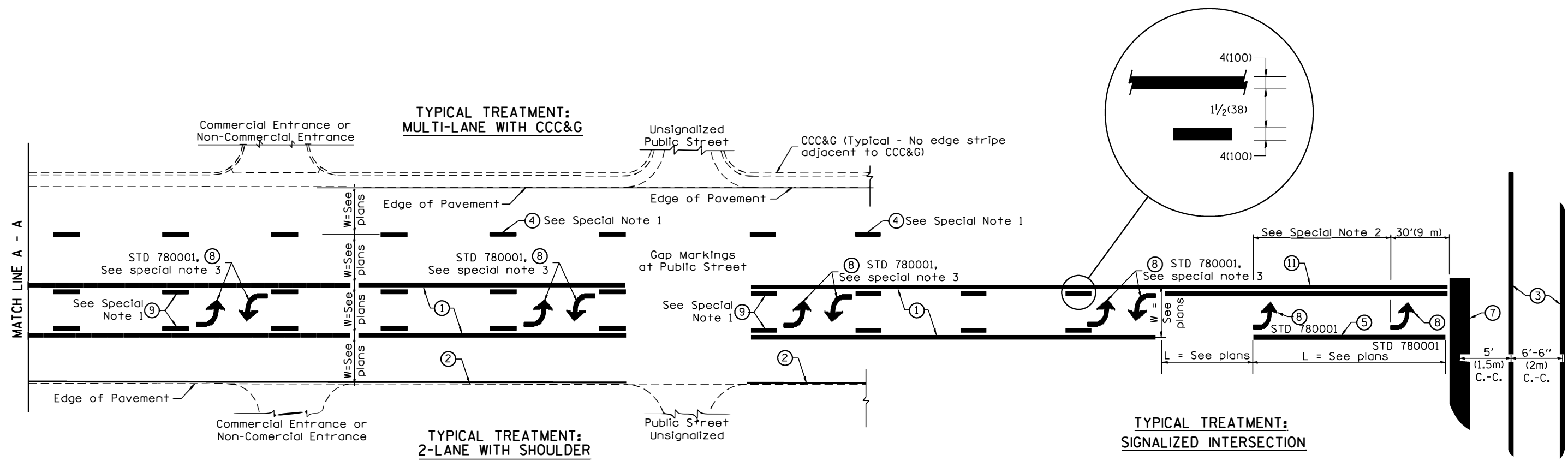

FLUSH PAVED MEDIAN: TWO-WAY LEFT TURN LANE WITH ONE-WAY LEFT TURN LANE AT SIGNALIZED INTERSECTION

TYPICAL PAVEMENT MARKING LEGEND
 (Note: This is a District Standard Legend. Some elements may not apply to specific project.)

- ① 4(100) Solid (Yellow)
- ② 4(100) Solid (White)
- ③ 2-6(150) Crosswalk @ 6'-6" (2m)min C.-C. (White)
2-8(200) Crosswalk @ 6'-6" (2m)min C.-C. (White) (When traffic signals are present.)
- ④ 6(150) Skip-Dash (White) (See Special Note 1)
- ⑤ 8(200) Solid (White)
- ⑥ 12(300) Diagonal (White) (Item ⑥ is shown on Std. 780001)
- ⑦ 24(600) Stop Bar (White)
- ⑧ Letters & Arrows (See Std. 780001 and Special Notes 2 & 3)
- ⑨ 4(100) Skip-Dash (Yellow) (See Special Note 1)
- ⑩ 12(300) Diagonal (Yellow) (See Table A) ⑩
- ⑪ 4(100) Double Solid (Yellow) ⑪

SPECIAL NOTES

1. Skip-Dash markings will be centered between both ends of city blocks and shall be placed in alignment transversely across the pavement.
2. The following shall apply to arrows located in one-way left turn lanes:
 - A. A minimum of two (2) arrows is required.
 - B. The maximum spacing between arrows is 80' (24 m).
 - C. Arrows shall be evenly spaced if three (3) or more are required.
3. The following shall apply to arrow pairs located in two-way left turn lanes:
 - A. A minimum of two (2) arrow pairs is required.
 - B. The maximum spacing between arrow pairs is 200' (61 m).
 - C. Arrow pairs shall be evenly spaced if three (3) or more are required.
 - D. The spacing between Bi Directional Left Turn Arrows is 33' (10 m).

GENERAL NOTES

1. Refer to State Standard 780001 for additional Pavement Markings including letters & arrows.
2. See Plans for Pavement Markings adjacent to curbed islands and medians, and through lane reductions.
3. Refer to Article 780.13 for letter, number and symbol areas (sq. ft.)
4. Areas are grooved 1" beyond each edge for the following symbols:
 - Through Arrow= 14.8 sq. ft.
 - Large Left or Right Arrow= 21.9 sq. ft.
 - 2 Arrow Combination Left (or Right) and Through= 34.9 sq. ft.
 - Wrong Way Arrow= 29.5 sq. ft.
 - Railroad Crossing Symbol= 69.8 sq. ft.
 (For further information, refer to BDE Special Provision: Grooving for Recessed Pavement Markings)

DESIGNER NOTES: 1. Include State Standard 780001 (Typical Pavement Markings)

01-01-97	RENUM. F-8.03, NEW REVISION BOX	T.P.	10-16-06	REVISED TO 2007 SPEC.		STATE OF ILLINOIS DEPARTMENT OF TRANSPORTATION	TYPICAL PAVEMENT MARKINGS	F.A.U. RTE.	SECTION	COUNTY	TOTAL SHEETS	SHEET NO.
02-07-97	ADD BI DIRECTIONAL DIMENSION	J.A.	2/29/16	ADDED GROOVING AREAS	R.D.			6711	19-00194-00-RS	TAZWELL	18	17
10-97	CORRECT BI DIRECTIONAL DIMENSION	J.A.	07-16-19	SPELLING CORRECTIONS	R.D.					CONTRACT NO. 89784		
08-02	ADD CROSSWALK DMNS. WITH T.S.	M.A.						FED. ROAD DIST. NO.		ILLINOIS FED. AID PROJECT		

NOT TO SCALE

SHT. 1 OF 2
CADD STD. 780001-D4

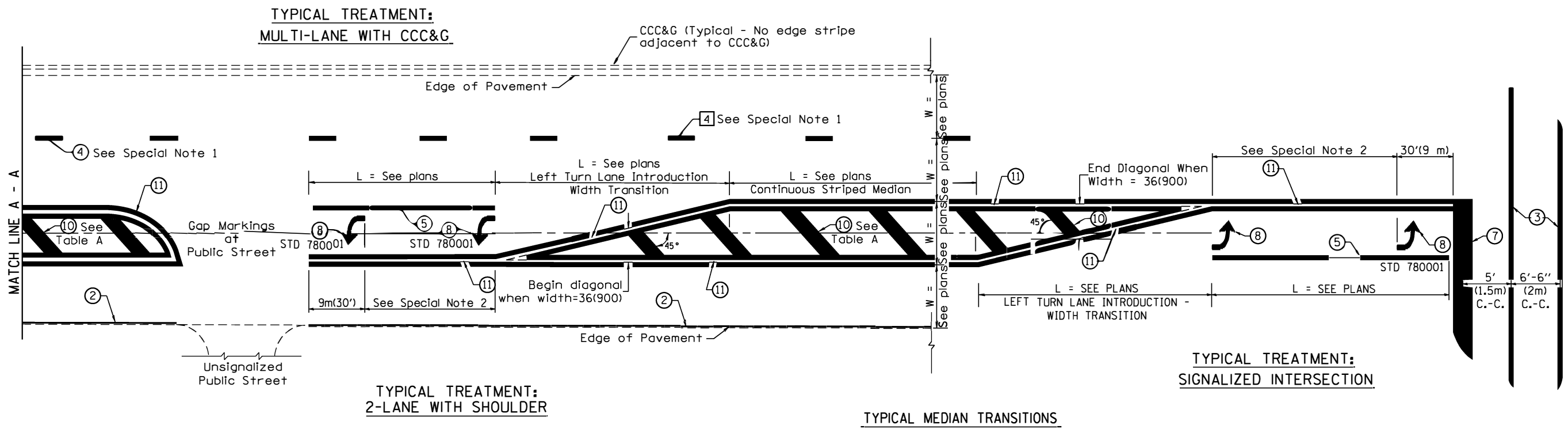

FLUSH PAVED MEDIAN: RESTRICTED LEFT TURN LANE

TABLE A
RECOMMENDED SPACING BETWEEN DIAGONAL LINES

SPEED LIMIT RANGE	INTERSECTION CHANNELIZATION (Includes Width Transitions for Median and Left Turn Lane Introductions)	
	CONTINUOUS	
Less Than 30 mph (50 km/h)	50' (15m)	15' (5m)
30 - 45 mph (50 - 70 km/h)	75' (23m)	20' (6m)
Over 45 mph (70 km/h)	150' (46m)	30' (9m)

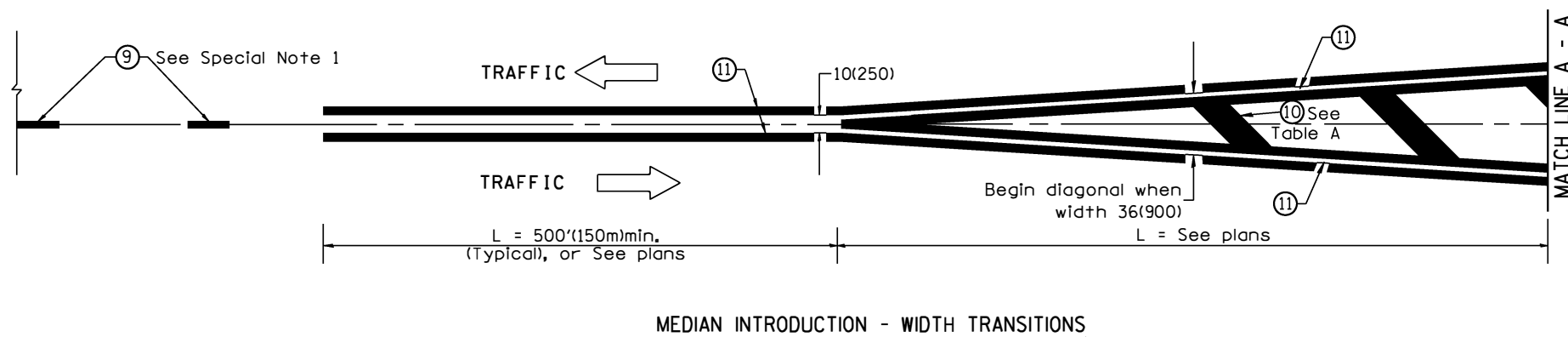

All dimensions are in inches (millimeters) unless otherwise noted.