

NOTES:
 EXISTING UTILITIES SHOWN ARE FOR LATERAL REFERENCE ONLY. THE CONTRACTOR IS RESPONSIBLE FOR IDENTIFYING ALL EXISTING SEWERS AND UTILITIES PRIOR TO CONSTRUCTION. THE CONTRACTOR SHALL REFER TO THE UTILITY LOCATION PLANS FOR ADDITIONAL UTILITY INFORMATION.

DATE	
BY	
FINAL SURVEY	
SURVEYED	
NOTE BOOK	
PLOTTED	
TEMPLATE	
AREAS	
CHECKED	
NO.	

DATE	
BY	
ORIGINAL SURVEY	
SURVEYED	
NOTE BOOK	
PLOTTED	
TEMPLATE	
AREAS	
CHECKED	
NO.	

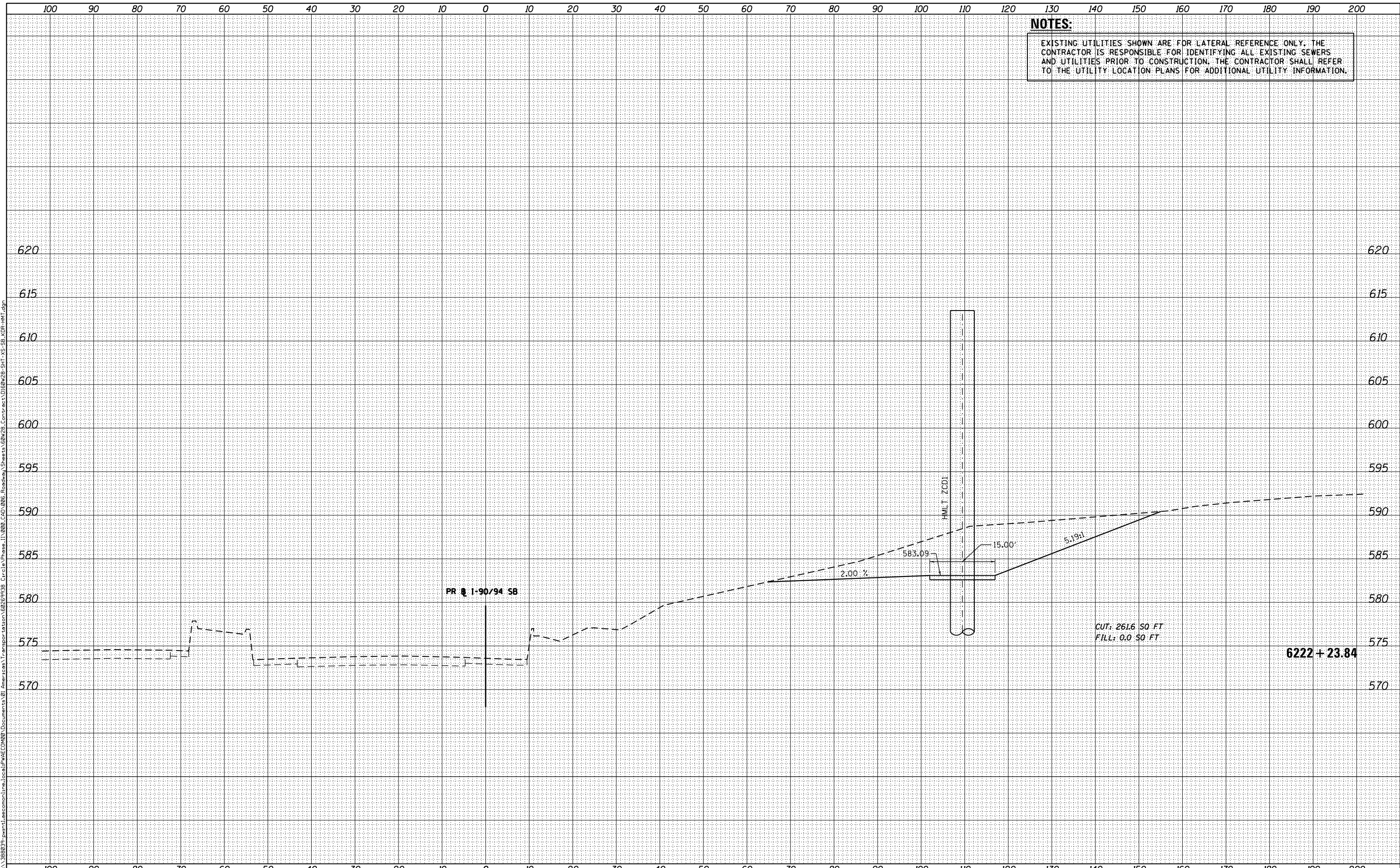

PR @ I-90/94 SB

H.M.L.T. ZCDI

CUT: 261.6 SQ. FT
 FILL: 0.0 SQ. FT

6222 + 23.84



D160W28-SHT-XS-SB_KDR-HMT.dgn
 USER NAME = maronik
 PLOT SCALE = 10.0000' / in.
 PLOT DATE = 4/25/2014

DESIGNED -	NWR / AJP	REVISED -	
DRAWN -	NWR / AJP	REVISED -	
CHECKED -	KAM	REVISED -	
DATE -	04/28/14	REVISED -	

STATE OF ILLINOIS
 DEPARTMENT OF TRANSPORTATION

CROSS SECTIONS
 SB I-90/94 HIGH MASS LIGHT TOWER

SCALE: 1:5V, 1:10H SHEET 1 OF 1 SHEETS STA. 6222+23.84 TO STA. 6222+23.84

F.A.I. RTE.	SECTION	COUNTY	TOTAL SHEETS	SHEET NO.
90/94/290	2013-010R	COOK	747	747
CONTRACT NO. 60W28				
ILLINOIS FED. AID PROJECT				

FILE PATH = p:\388037-p\m\asc\com\line\local\p\AECOM\Documents\01_Americas\Transportation\6222+23.84_Circle\Phase 1\1000_CDD\006_Roadway\Sheets\60W28_Contract\0160W28-SHT-XS-SB_KDR-HMT.dgn