

DATE	
BY	
FINAL SURVEY	
SURVEYED	
PLOTTED	
TEMPLATE	
AREAS	
CHECKED	
NO.	

DATE	
BY	
ORIGINAL SURVEY	
SURVEYED	
PLOTTED	
TEMPLATE	
AREAS	
CHECKED	
NO.	

FILE PATH = p:\388037-p\m\asc\monline\local\p\AEC\DWG\Documents\01_Americas\Transportation\60269938_Circle Phase II\000_CDD\006_Roadway\Sheets\60W28-SHT-XS-RAMP-CIR-SWT.dgn

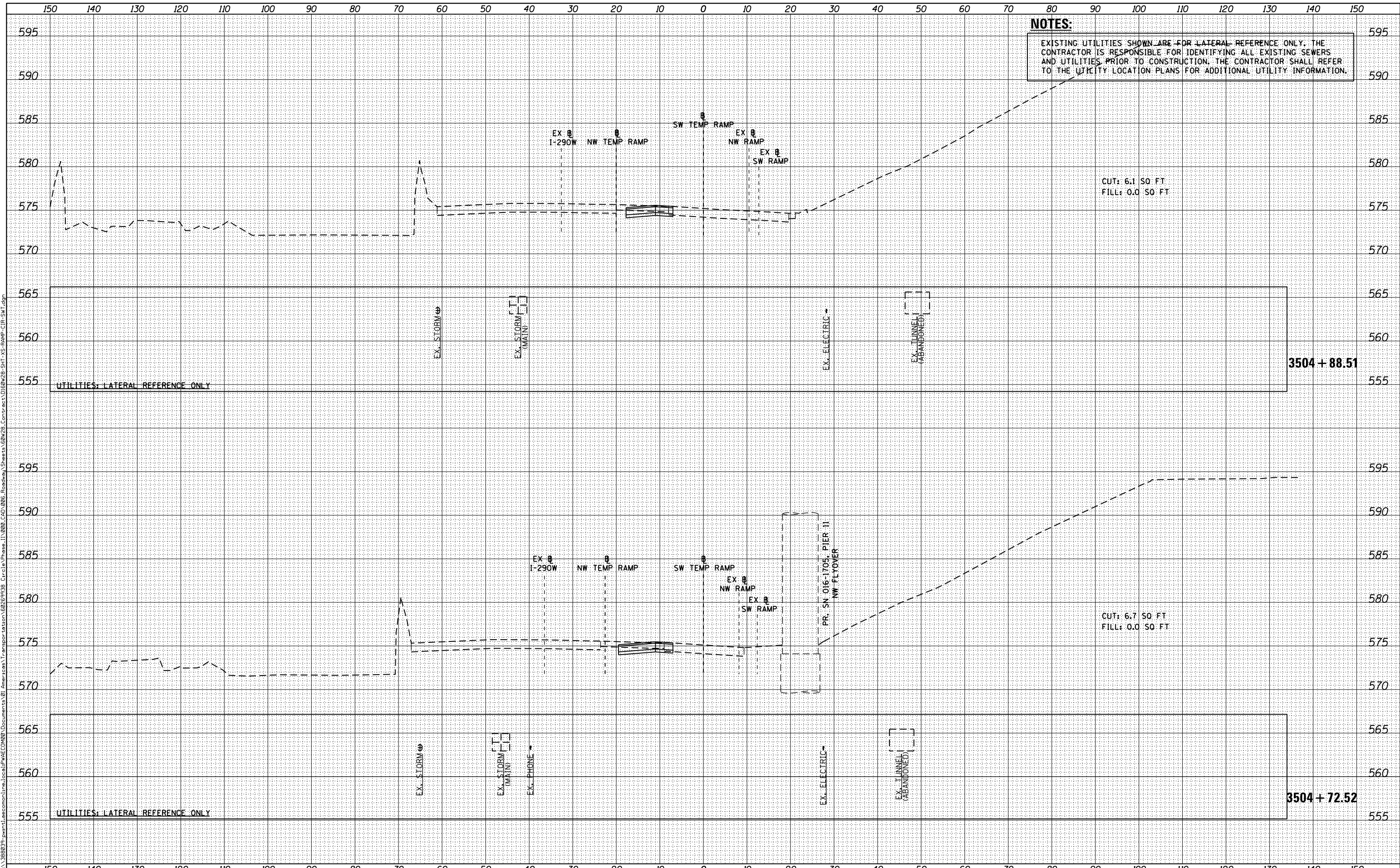

NOTES:
EXISTING UTILITIES SHOWN ARE FOR LATERAL REFERENCE ONLY. THE CONTRACTOR IS RESPONSIBLE FOR IDENTIFYING ALL EXISTING SEWERS AND UTILITIES PRIOR TO CONSTRUCTION. THE CONTRACTOR SHALL REFER TO THE UTILITY LOCATION PLANS FOR ADDITIONAL UTILITY INFORMATION.

CUT: 6.1 SO. FT
FILL: 0.0 SO. FT

3504 + 88.51

CUT: 6.7 SO. FT
FILL: 0.0 SO. FT

3504 + 72.52



D160W28-SHT-XS-RAMP-CIR-SWT.dgn
USER NAME = maronik
PLOT SCALE = 10.0000' / in.
PLOT DATE = 4/25/2014

DESIGNED - NWM / AJP
DRAWN - NWM / AJP
CHECKED - KAM
DATE - 04/28/14

REVISED -
REVISED -
REVISED -
REVISED -

STATE OF ILLINOIS
DEPARTMENT OF TRANSPORTATION

CROSS SECTIONS
RAMP SW (TEMP)

SCALE: 1:5V, 1:10H SHEET 11 OF 19 SHEETS STA. 3504+72.52 TO STA. 3504+88.51

F.A.I. RTE.	SECTION	COUNTY	TOTAL SHEETS	SHEET NO.
90/94/290	2013-010R	COOK	747	723
				CONTRACT NO. 60W28

ILLINOIS FED. AID PROJECT