

| | |
|---------------|--|
| DATE | |
| BY | |
| FINAL SURVEY | |
| SURVEYED | |
| PLOTTED | |
| TEMPLATE | |
| AREAS | |
| NOTED | |
| BOOK | |
| NO. | |
| AREAS CHECKED | |

| | |
|-----------------|--|
| DATE | |
| BY | |
| ORIGINAL SURVEY | |
| SURVEYED | |
| PLOTTED | |
| TEMPLATE | |
| AREAS | |
| NOTED | |
| BOOK | |
| NO. | |
| AREAS CHECKED | |

FILE PATH = p:\388039\pmt\asc\com\line\local\p\AEC\DWG\Documents\01\Americas\Transportation\60269938_Circle\Phase\1\000_CDD\006_Roadway\Sheets\60W28-SHT-XS-RAMP-NWT.dgn

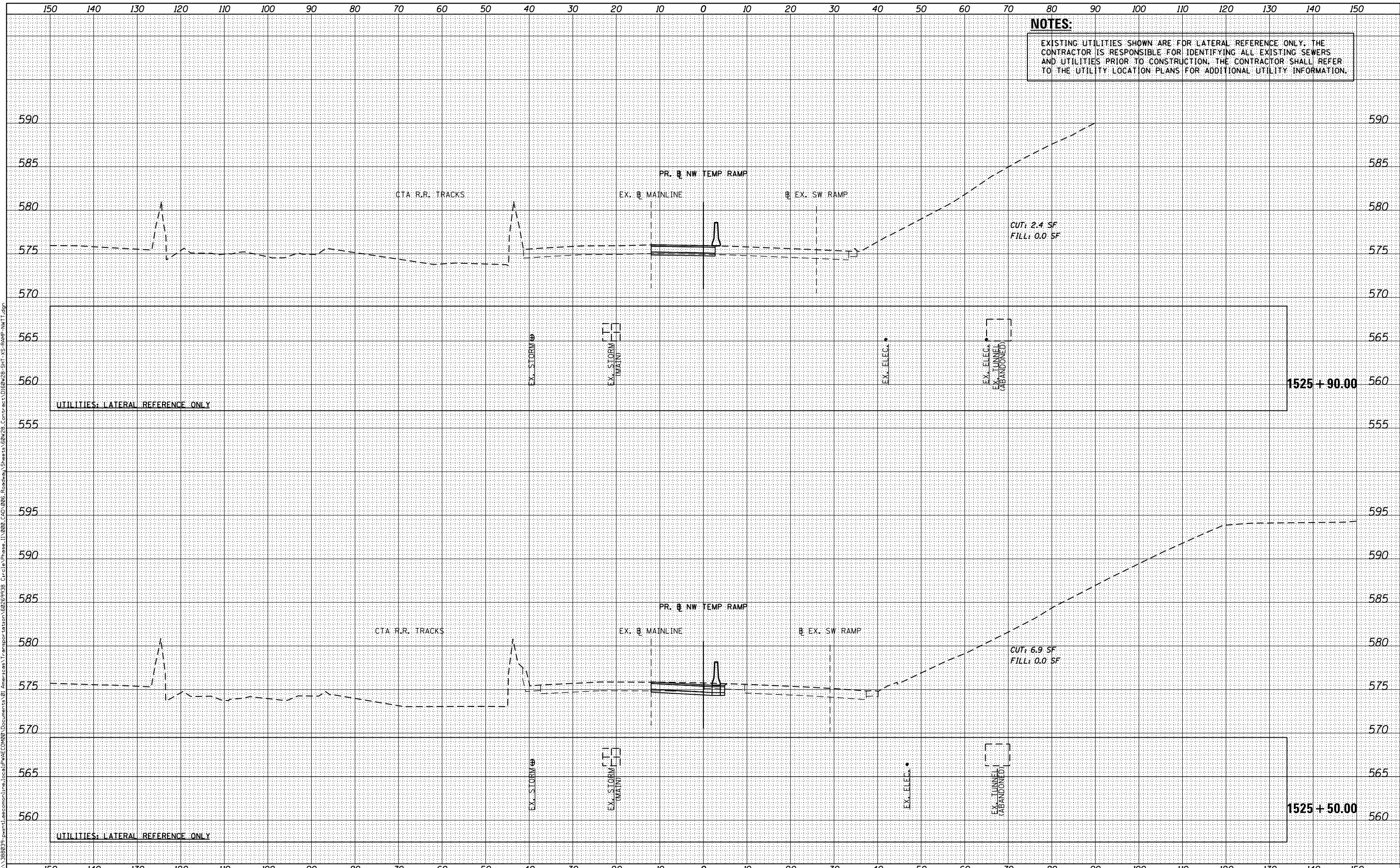

NOTES:
EXISTING UTILITIES SHOWN ARE FOR LATERAL REFERENCE ONLY. THE CONTRACTOR IS RESPONSIBLE FOR IDENTIFYING ALL EXISTING SEWERS AND UTILITIES PRIOR TO CONSTRUCTION. THE CONTRACTOR SHALL REFER TO THE UTILITY LOCATION PLANS FOR ADDITIONAL UTILITY INFORMATION.



D160W28-SHT-XS-RAMP-NWT.dgn
 USER NAME = maronik
 PLOT SCALE = 10.0000' / in.
 PLOT DATE = 4/25/2014

DESIGNED - NWR / AJP
 DRAWN - NWR / AJP
 CHECKED - KAM
 DATE - 04/28/14

REVISED -
 REVISED -
 REVISED -
 REVISED -

**STATE OF ILLINOIS
 DEPARTMENT OF TRANSPORTATION**

**CROSS SECTIONS
 RAMP NW (WB TEMP)**

SCALE: 1:5V, 1:10H SHEET 7 OF 8 SHEETS STA. 1525+50.00 TO STA. 1525+90.00

| F.A.I. RTE. | SECTION | COUNTY | TOTAL SHEETS | SHEET NO. |
|-------------|-----------|--------|--------------|--------------------|
| 90/94/290 | 2013-010R | COOK | 747 | 711 |
| | | | | CONTRACT NO. 60W28 |

ILLINOIS FED. AID PROJECT