

**NOTES:**  
 EXISTING UTILITIES SHOWN ARE FOR LATERAL REFERENCE ONLY. THE CONTRACTOR IS RESPONSIBLE FOR IDENTIFYING ALL EXISTING SEWERS AND UTILITIES PRIOR TO CONSTRUCTION. THE CONTRACTOR SHALL REFER TO THE UTILITY LOCATION PLANS FOR ADDITIONAL UTILITY INFORMATION.

DATE	
BY	
FINAL SURVEY	
SURVEYED	
NOTE BOOK	
PLOTTED	
TEMPLATE	
AREAS	
CHECKED	

DATE	
BY	
ORIGINAL SURVEY	
SURVEYED	
NOTE BOOK	
PLOTTED	
TEMPLATE	
AREAS	
CHECKED	

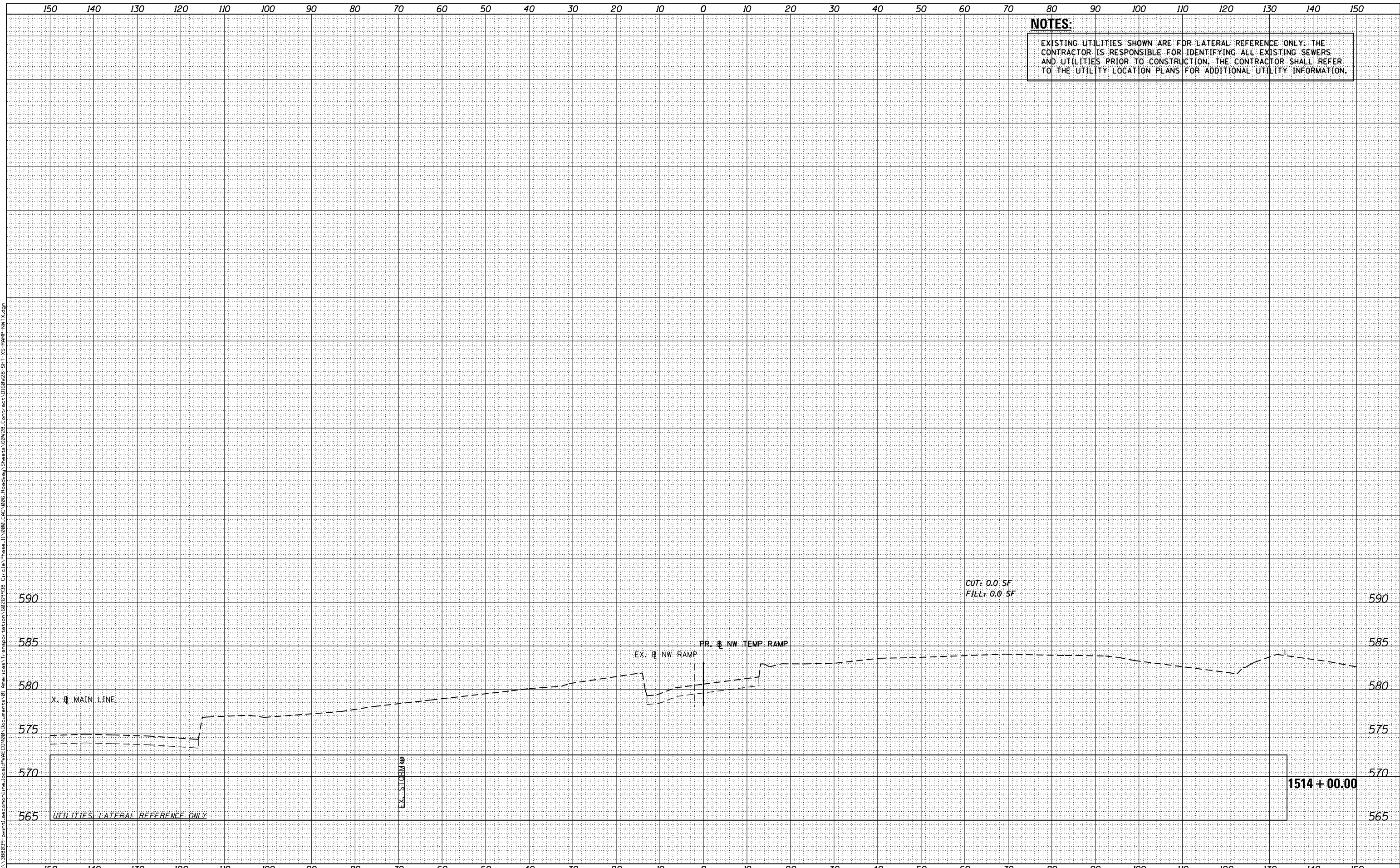

CUT: 0.0 SF  
 FILL: 0.0 SF



D160W28-SHT-XS-RAMP-NW.TX.dgn  
 USER NAME = maronik  
 PLOT SCALE = 10.0000' / in.  
 PLOT DATE = 4/25/2014

DESIGNED -	NWMP / AJP	REVISED -	
DRAWN -	NWMP / AJP	REVISED -	
CHECKED -	KMM	REVISED -	
DATE -	04/28/14	REVISED -	

**STATE OF ILLINOIS  
 DEPARTMENT OF TRANSPORTATION**

**CROSS SECTIONS  
 RAMP NW (NB TEMP)**

SCALE: 1:5V, 1:10H SHEET 8 OF 8 SHEETS STA. 1514+00.00 TO STA. 1514+00.00

F.A.I. RTE.	SECTION	COUNTY	TOTAL SHEETS	SHEET NO.
90/94/290	2013-010R	COOK	747	704
CONTRACT NO. 60W28				
ILLINOIS FED. AID PROJECT				