

NOTES:
 EXISTING UTILITIES SHOWN ARE FOR LATERAL REFERENCE ONLY. THE CONTRACTOR IS RESPONSIBLE FOR IDENTIFYING ALL EXISTING SEWERS AND UTILITIES PRIOR TO CONSTRUCTION. THE CONTRACTOR SHALL REFER TO THE UTILITY LOCATION PLANS FOR ADDITIONAL UTILITY INFORMATION.

DATE	
BY	
FINAL SURVEY	
PLOTTED	
NOTE BOOK	
AREAS CHECKED	
NO.	

DATE	
BY	
ORIGINAL SURVEY	
PLOTTED	
NOTE BOOK	
AREAS CHECKED	
NO.	

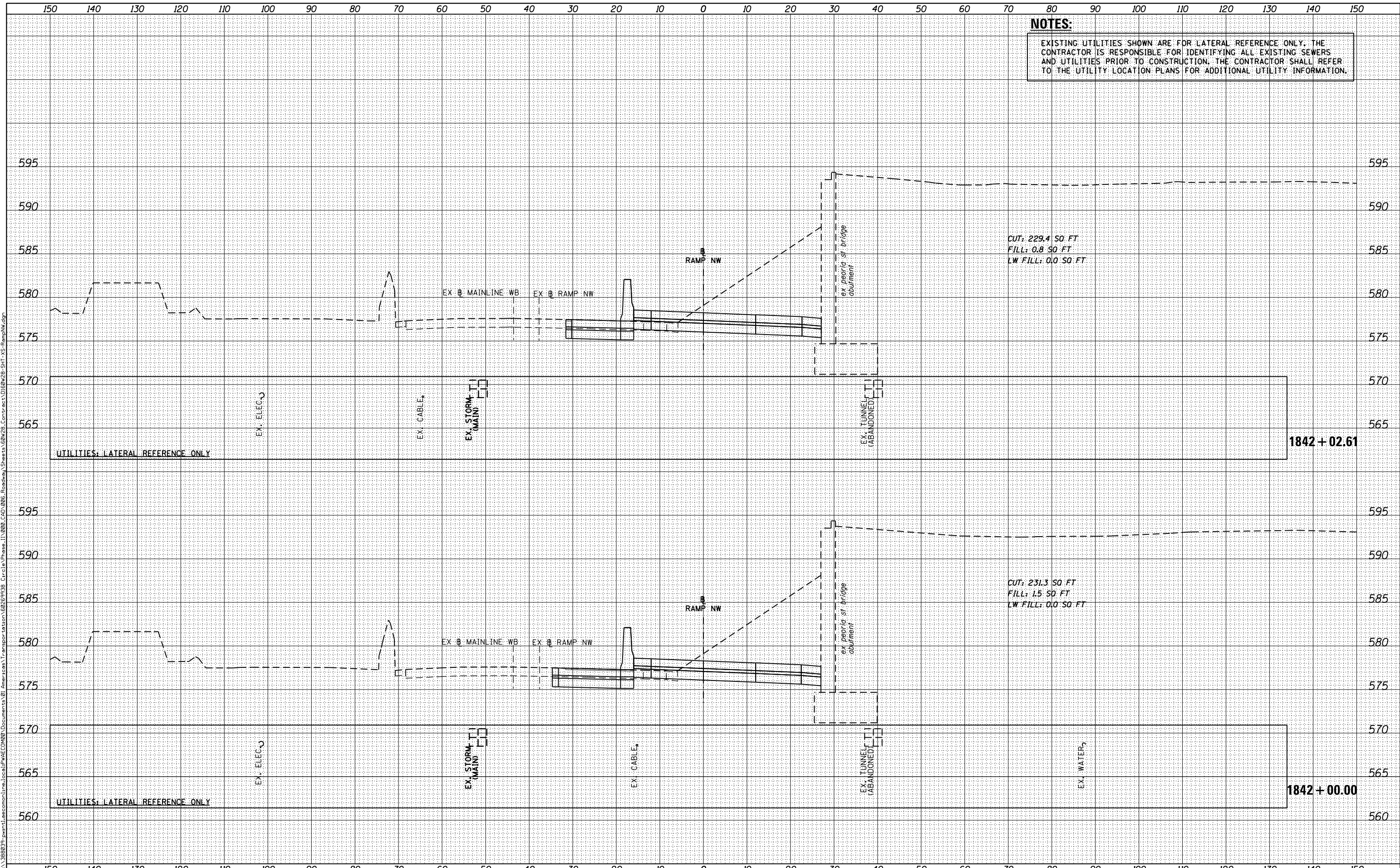

CUT: 229.4 SO FT
 FILL: 0.8 SO FT
 LW FILL: 0.0 SO FT

CUT: 231.3 SO FT
 FILL: 1.5 SO FT
 LW FILL: 0.0 SO FT

UTILITIES: LATERAL REFERENCE ONLY

UTILITIES: LATERAL REFERENCE ONLY

1842+02.61

1842+00.00



D160W28-SHT-XS-RampNW.dgn
 USER NAME = maronik
 PLOT SCALE = 10.0000' / in.
 PLOT DATE = 4/25/2014

DESIGNED - NMM / AJP
 DRAWN - NMM / AJP
 CHECKED - K&R
 DATE - 04/28/14

REVISED -
 REVISED -
 REVISED -
 REVISED -

STATE OF ILLINOIS
 DEPARTMENT OF TRANSPORTATION

CROSS SECTIONS
 RAMP NW

SCALE: 1:5V,1:10H SHEET 50 OF 51 SHEETS STA. 1842+00.00 TO STA. 1842+02.61

F.A.I. RTE.	SECTION	COUNTY	TOTAL SHEETS	SHEET NO.
90/94/290	2013-010R	COOK	747	695
				CONTRACT NO. 60W28

ILLINOIS FED. AID PROJECT

FILE PATH = p:\388037-pmt\ascomon\line\local\PM\EC\000\Documents\01_Americas\Transportation\60269938_Circle\Phase_1\1000_CAD\006_Roadway\Sheets\60W28-SHT-XS-RampNW.dgn