

DATE	
BY	
ORIGINAL SURVEY	
SURVEYED	
PLOTTED	
TEMPLATE	
AREAS	
CHECKED	
NO.	

DATE	
BY	
ORIGINAL SURVEY	
SURVEYED	
PLOTTED	
TEMPLATE	
AREAS	
CHECKED	
NO.	

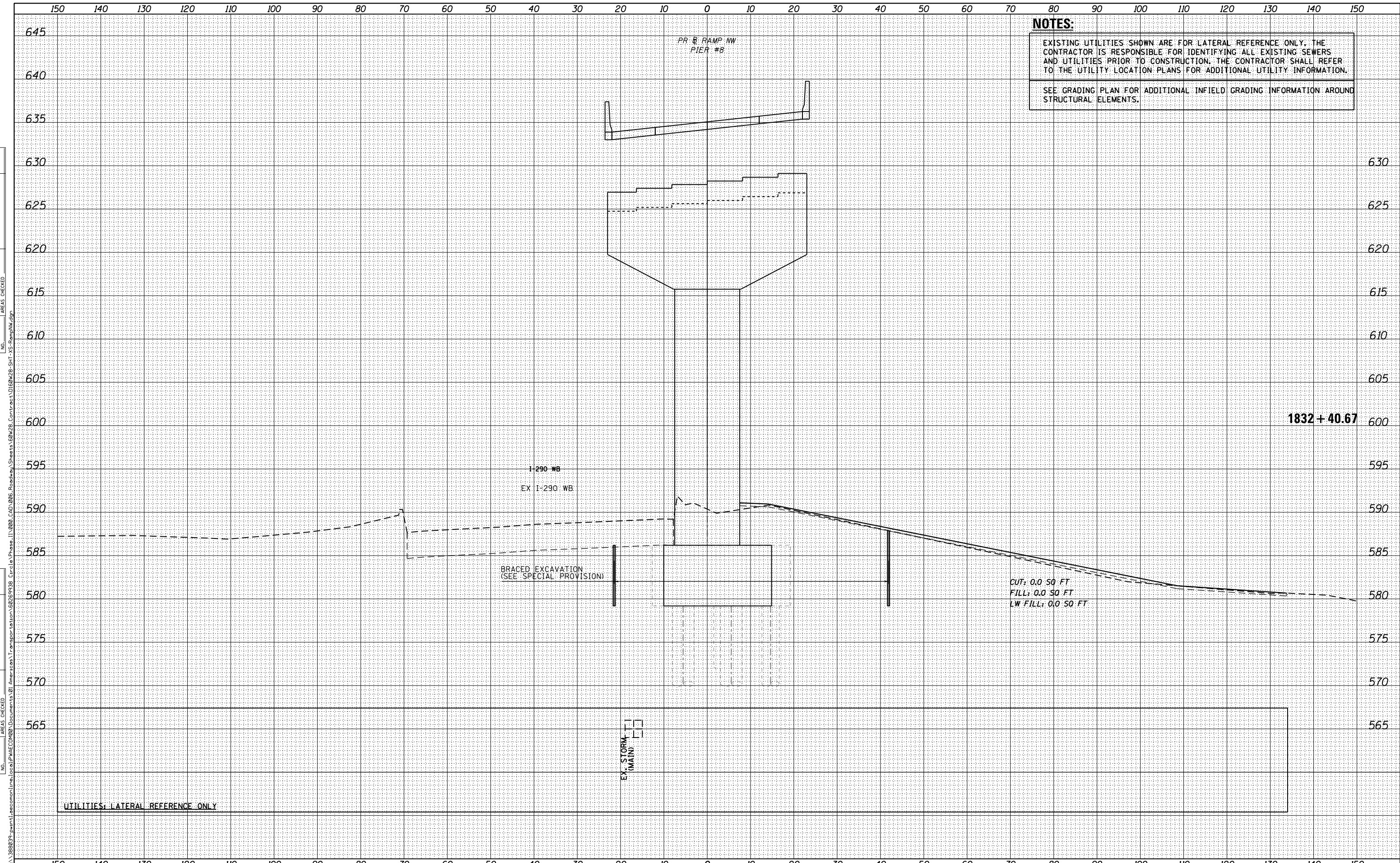

NOTES:
 EXISTING UTILITIES SHOWN ARE FOR LATERAL REFERENCE ONLY. THE CONTRACTOR IS RESPONSIBLE FOR IDENTIFYING ALL EXISTING SEWERS AND UTILITIES PRIOR TO CONSTRUCTION. THE CONTRACTOR SHALL REFER TO THE UTILITY LOCATION PLANS FOR ADDITIONAL UTILITY INFORMATION.
 SEE GRADING PLAN FOR ADDITIONAL INFIELD GRADING INFORMATION AROUND STRUCTURAL ELEMENTS.



D160W28-SHT-XS-RampNW.dgn
 USER NAME = maronik
 PLOT SCALE = 10.0000' / in.
 PLOT DATE = 4/25/2014

DESIGNED -	NMM / AJP	REVISED -	
DRAWN -	NMM / AJP	REVISED -	
CHECKED -	K&R	REVISED -	
DATE -	04/28/14	REVISED -	

**STATE OF ILLINOIS
 DEPARTMENT OF TRANSPORTATION**

**CROSS SECTIONS
 RAMP NW**

SCALE: 1:5V, 1:10H SHEET 31 OF 51 SHEETS STA. 1832+40.67 TO STA. 1832+40.67

F.A.I. RTE.	SECTION	COUNTY	TOTAL SHEETS	SHEET NO.
90/94/290	2013-010R	COOK	747	676
			CONTRACT NO. 60W28	
ILLINOIS FED. AID PROJECT				