

DATE	
BY	
FINAL SURVEY	SURVEYED
NOTE BOOK	PLOTTED
NO.	TEMPLATE
	AREAS
	CHECKED

DATE	
BY	
ORIGINAL SURVEY	SURVEYED
NOTE BOOK	PLOTTED
NO.	TEMPLATE
	AREAS
	CHECKED

FILE PATH = p:\388039\p\1\ascomon\line\local\p\AEC\DWG\Documents\01\_Americas\Transportation\62629938\_Circle Phase II\000\_CDD\_006\_Roadway\Sheets\60W28\_Contract\0160W28-SHT-XS-RampNW.dgn

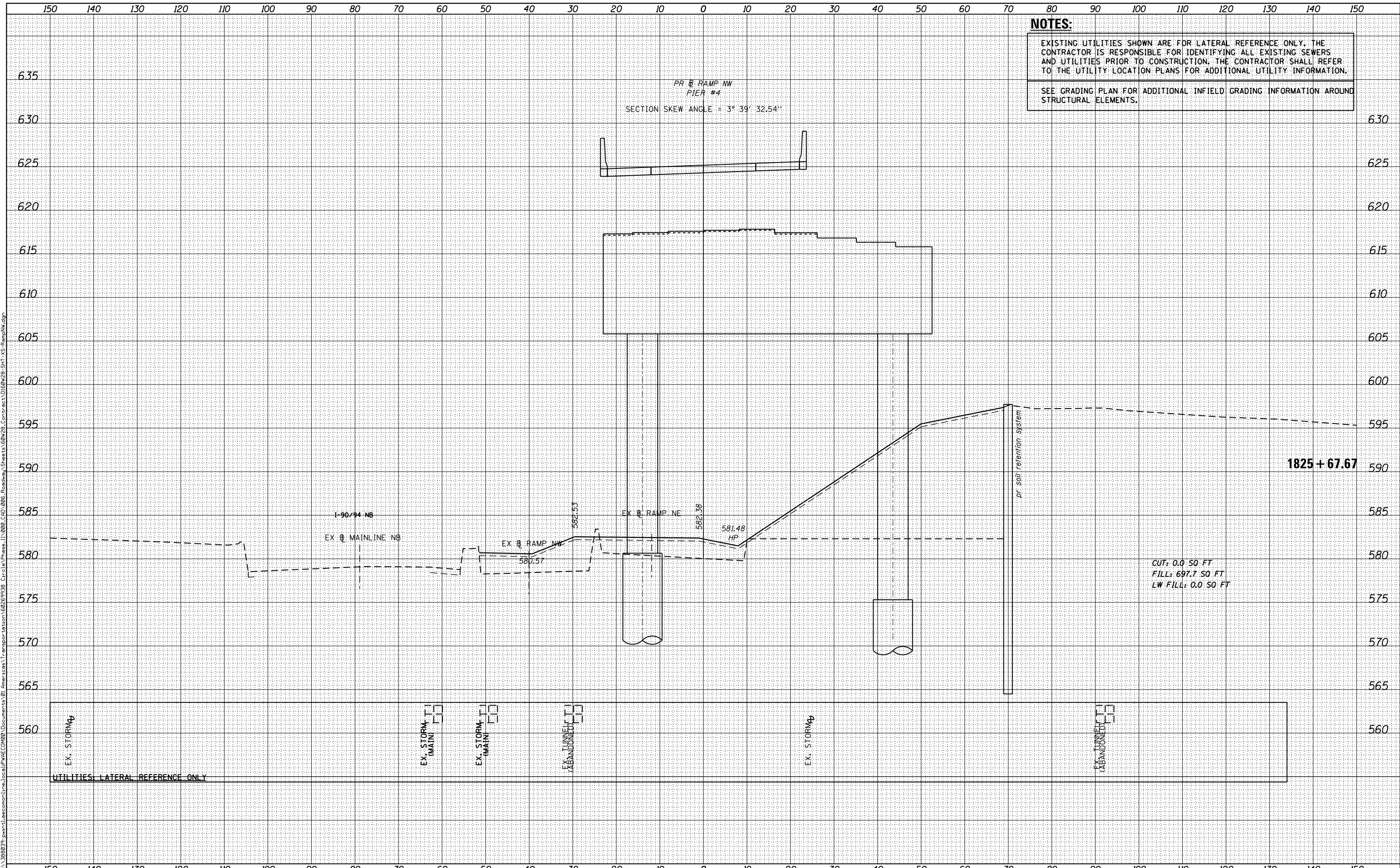

**NOTES:**  
 EXISTING UTILITIES SHOWN ARE FOR LATERAL REFERENCE ONLY. THE CONTRACTOR IS RESPONSIBLE FOR IDENTIFYING ALL EXISTING SEWERS AND UTILITIES PRIOR TO CONSTRUCTION. THE CONTRACTOR SHALL REFER TO THE UTILITY LOCATION PLANS FOR ADDITIONAL UTILITY INFORMATION.  
 SEE GRADING PLAN FOR ADDITIONAL INFIELD GRADING INFORMATION AROUND STRUCTURAL ELEMENTS.

CUT: 0.0 SO. FT  
 FILL: 697.7 SO. FT  
 LW FILL: 0.0 SO. FT



D160W28-SHT-XS-RampNW.dgn  
 USER NAME = maronik  
 PLOT SCALE = 10.0000' / in.  
 PLOT DATE = 4/25/2014

DESIGNED -	NMM / AJP	REVISED -	
DRAWN -	NMM / AJP	REVISED -	
CHECKED -	K&R	REVISED -	
DATE -	04/28/14	REVISED -	

STATE OF ILLINOIS  
 DEPARTMENT OF TRANSPORTATION

CROSS SECTIONS  
 RAMP NW

SCALE: 1:5V, 1:10H SHEET 27 OF 51 SHEETS STA. 1825+67.67 TO STA. 1825+67.67

F.A.I. RTE.	SECTION	COUNTY	TOTAL SHEETS	SHEET NO.
90/94/290	2013-010R	COOK	747	672
				CONTRACT NO. 60W28
ILLINOIS FED. AID PROJECT				