

DATE	
BY	
FINAL SURVEY	SURVEYED
NOTE BOOK	PLOTTED
NO.	TEMPLATE
	AREAS CHECKED

DATE	
BY	
ORIGINAL SURVEY	SURVEYED
NOTE BOOK	PLOTTED
NO.	TEMPLATE
	AREAS CHECKED

FILE PATH = p:\388039\p\m\asc\com\line\local\p\AEC\DWG\Documents\01_Americas\Transportation\60269938_Circle\Phase_1\1000_CDD_006_Roadway\Sheets\60W28-SHT-XS-RampNW.dgn

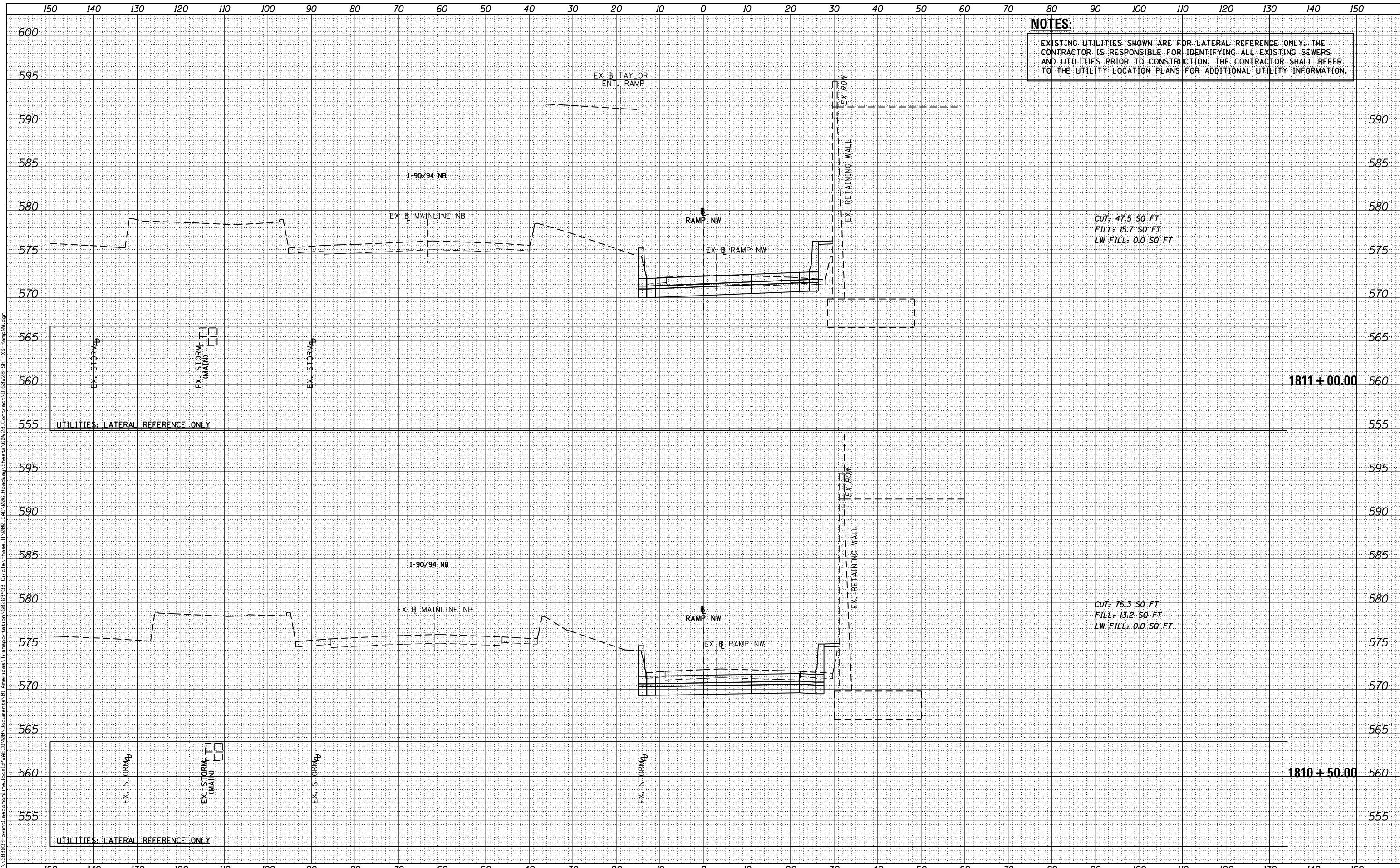

NOTES:
EXISTING UTILITIES SHOWN ARE FOR LATERAL REFERENCE ONLY. THE CONTRACTOR IS RESPONSIBLE FOR IDENTIFYING ALL EXISTING SEWERS AND UTILITIES PRIOR TO CONSTRUCTION. THE CONTRACTOR SHALL REFER TO THE UTILITY LOCATION PLANS FOR ADDITIONAL UTILITY INFORMATION.



D160W28-SHT-XS-RampNW.dgn
USER NAME = maronik
PLOT SCALE = 10.0000' / in.
PLOT DATE = 4/25/2014

DESIGNED - NMM / AJP
DRAWN - NMM / AJP
CHECKED - K&R
DATE - 04/28/14

REVISED -
REVISED -
REVISED -
REVISED -

STATE OF ILLINOIS
DEPARTMENT OF TRANSPORTATION

CROSS SECTIONS
RAMP NW

SCALE: 1:5V,1:10H SHEET 10 OF 51 SHEETS STA. 1810+50.00 TO STA. 1811+00.00

F.A.I. RTE.	SECTION	COUNTY	TOTAL SHEETS	SHEET NO.
90/94/290	2013-010R	COOK	747	655
CONTRACT NO. 60W28				

ILLINOIS FED. AID PROJECT