

**ROUTE MARKERS**

FOR U.S. ROUTES  
M1-40-2424

FOR ILLINOIS ROUTES  
M1-50-2424

R.R. UNMARKED ROUTES  
SPECIAL 24" x 18" VARIABLE  
4" BLACK LETTERS ON WHITE  
REFLECTIVE BACKGROUND

**ARROWS SIGNS**

M5-1L-2115

M5-1R-2115

M6-1-2115

M6-1-2115

M6-3-2115

**CARDINAL DIRECTION & DETOUR SIGNS**

NORTH M3-1-2412

EAST M3-2-2412

SOUTH M3-3-2412

WEST M3-4-2412

DETOUR M4-8-2412

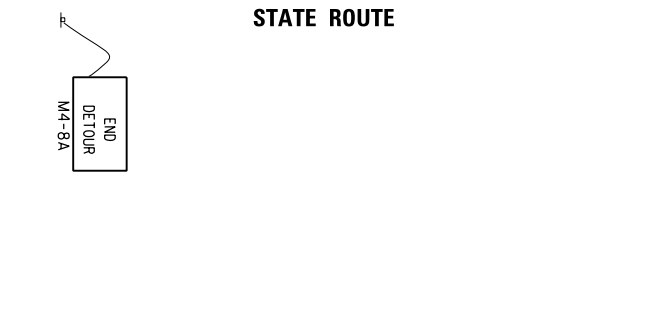
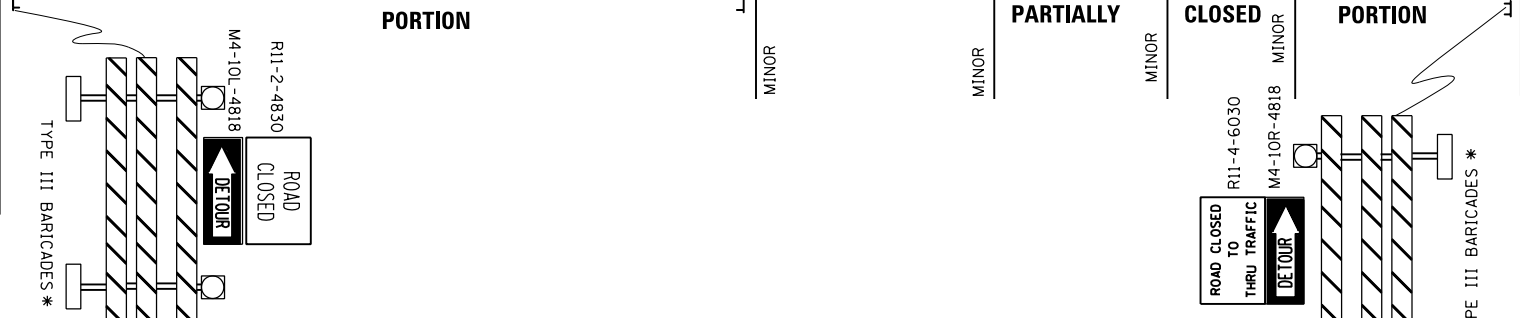
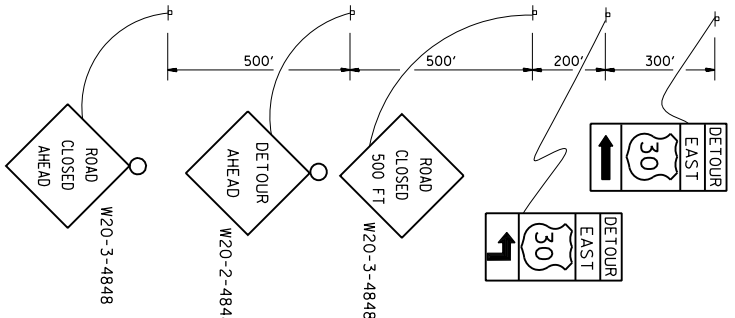

\* IF A TYPE III BARRICADE WITH AN ATTACHED SIGN PANEL WHICH MEETS NCHRP 350 REQUIREMENTS IS NOT AVAILABLE, THE SIGNS SHALL BE MOUNTED, ABOVE THE BARRICADES, ON SEPARATE SIGNS SUPPORTS THAT MEET NCHRP 350 REQUIREMENTS.

FILE PATH = C:\Project\state\14-0323 - W28 Final PDFs\0160W28-SHT-D1-Detail-TC-21.dgn



D160W28-SHT-D1-Detail-TC-21.dgn  
USER NAME = auyeurgh  
PLOT SCALE = 50.0000' / in.  
PLOT DATE = 3/24/2014

DESIGNED -  
DRAWN -  
CHECKED -  
DATE -  
REVISED -10-18-02  
REVISED -R, BORO 09-14-09  
REVISED -  
REVISED -

**STATE OF ILLINOIS  
DEPARTMENT OF TRANSPORTATION**

**DETOUR SIGNING  
FOR CLOSING STATE HIGHWAYS**

SCALE: SHEET 33 OF 40 SHEETS STA. TO STA.

F.A.I. R.T.E. 90/94/290	SECTION 2013-010R	COUNTY COOK	TOTAL SHEETS 747	SHEET NO. 617
<b>TC-21</b>			<b>CONTRACT NO. 60W28</b>	
ILLINOIS FED. AID PROJECT				