

# FOR INFORMATION ONLY

ROUTE NO.	SECTION	COUNTY	TOWNSHIP	RANGE
F.A.I. 94	0101-6-1P	COOK	113	100
FED. ROAD BY No. 4		ILLINOIS PROJECT I-94-3(1)-21		

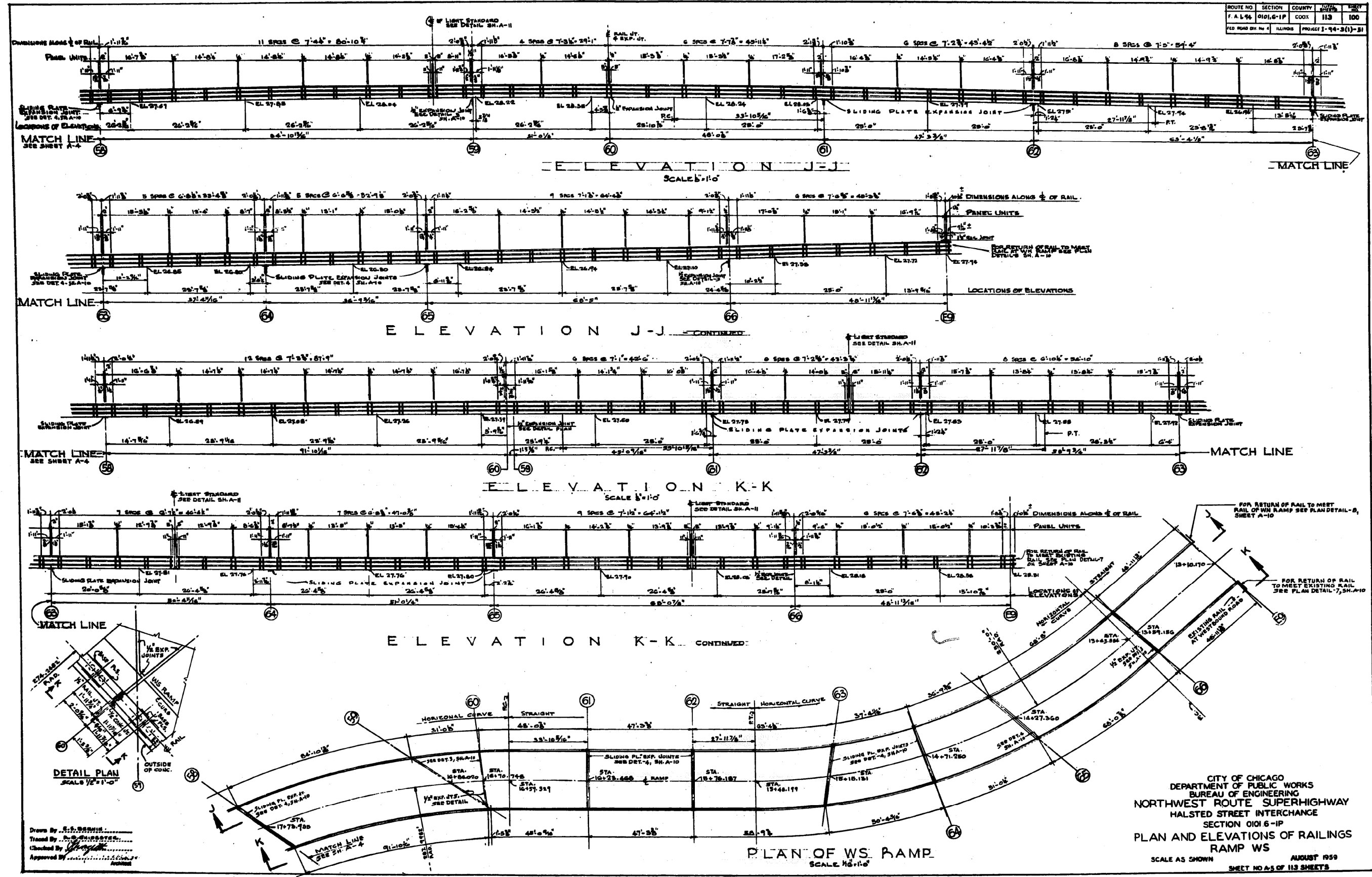

Drawn By: S.S. BROWN  
 Traced By: S.S. BROWN  
 Checked By: S.S. BROWN  
 Approved By: S.S. BROWN

CITY OF CHICAGO  
 DEPARTMENT OF PUBLIC WORKS  
 BUREAU OF ENGINEERING  
 NORTHWEST ROUTE SUPERHIGHWAY  
 HALSTED STREET INTERCHANGE  
 SECTION 0101-6-1P  
**PLAN AND ELEVATIONS OF RAILINGS  
 RAMP WS**  
 SCALE AS SHOWN  
 AUGUST 1959  
 SHEET NO. 45 OF 113 SHEETS

FILE PATH = C:\Projects\14-0425 - 60W28-Structure\14-0425-sht-AS-BUILT-41.dgn



D160W28-sht-AS-BUILT-41.dgn  
 USER NAME = auyeyungh  
 PLOT SCALE = 1:8000 / 1" = 80'  
 PLOT DATE = 4/25/2014

DESIGNED -	REVISED -
DRAWN -	REVISED -
CHECKED -	REVISED -
DATE - 04/28/14	REVISED -

STATE OF ILLINOIS  
 DEPARTMENT OF TRANSPORTATION

EXISTING AS-BUILTS  
 SN 016-2449 & SN 016-2451

SCALE: NTS SHEET 41 OF 48 SHEETS STA. TO STA.

F.A.I. RTE.	SECTION	COUNTY	TOTAL SHEETS	SHEET NO.
90/94/290	2013-010R	COOK	747	511
CONTRACT NO. 60W28				
ILLINOIS FED. AID PROJECT				