

GIRDER ELEVATION - UNIT IV

(Connection and Splice R's not shown for clarity)

Girder	AA	BB	CC	DD	EE	FF
1, 2, 3	1 1/2"x20"	1 1/2"x20"	2 1/2"x26"	2 1/2"x28"	1 1/2"x20"	1 1/2"x20"
4, 5, 6	1"x18"	1"x20"	2"x22"	2"x24"	1"x18"	1"x20"

GIRDER DIMENSIONS - UNIT IV

(All Dimensions in Feet)

Girder	Radius	L*	S1	S2	A	B	C	D	E	C1	C2	C3
1	560.417	392.406	196.203	196.202	133.935	62.269	62.268	133.934	8'-2"	134 Spa at 12"	107 Spa at 14"	134 Spa at 12"
2	552.250	386.643	193.321	193.322	131.960	61.361	61.362	131.960	8'-0"	99 Spa at 16"	93 Spa at 16"	99 Spa at 16"
3	544.083	380.881	190.440	190.440	129.987	60.453	60.453	129.987	7'-11"	98 Spa at 16"	91 Spa at 16"	98 Spa at 16"
4	535.917	375.119	187.560	187.559	128.013	59.547	59.546	128.013	7'-9"	97 Spa at 16"	90 Spa at 16"	97 Spa at 16"
5	527.750	369.357	184.678	184.679	126.040	58.639	58.639	126.040	7'-8"	101 Spa at 15"	88 Spa at 16"	101 Spa at 15"
6	519.583	363.594	181.797	181.797	124.065	57.732	57.731	124.065	7'-7"	94 Spa at 16"	77 Spa at 18"	94 Spa at 16"

* Girder Length "L" excludes girder ends beyond first & last bearings.

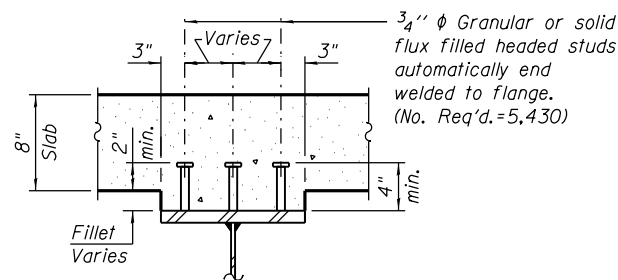

SECTION A-A

NOTES:

1. See Sheet S-87 for girder framing plan.
2. See Sheet S-89 for camber & top of web elevations.
3. See Sheet S-90 for moment tables & reaction tables.
4. See Sheet S-99 for girder bolted field splice details.
5. See Sheets S-100 thru S-102 for girder cross frame details.
6. All structural steel shall be AASHTO M270 Grade 50.
7. Load carrying components designated "NTR" shall conform to the Impact Testing Requirement, Zone 2.

0161705-60W28-5088-GirderElev.dgn



USER NAME = floresg	DESIGNED - DD	REVISED
	CHECKED - ATB	REVISED
PLOT SCALE = N.T.S.	DRAWN - MRK	REVISED
PLOT DATE = 5/7/2014	CHECKED - DD	REVISED

**STATE OF ILLINOIS
DEPARTMENT OF TRANSPORTATION**

**GIRDER ELEVATIONS - UNIT IV
STRUCTURE NO. 016-1705**

SHEET NO. S-88 OF S-165 SHEETS

F.A.I. RTE.	SECTION	COUNTY	TOTAL SHEETS	SHEET NO.
90/94/290	2013-010R	COOK	747	404
CONTRACT NO.			60W28	
ILLINOIS FED. AID PROJECT				