

**INSIDE ELEVATION OF LEFT PARAPET - UNIT V**

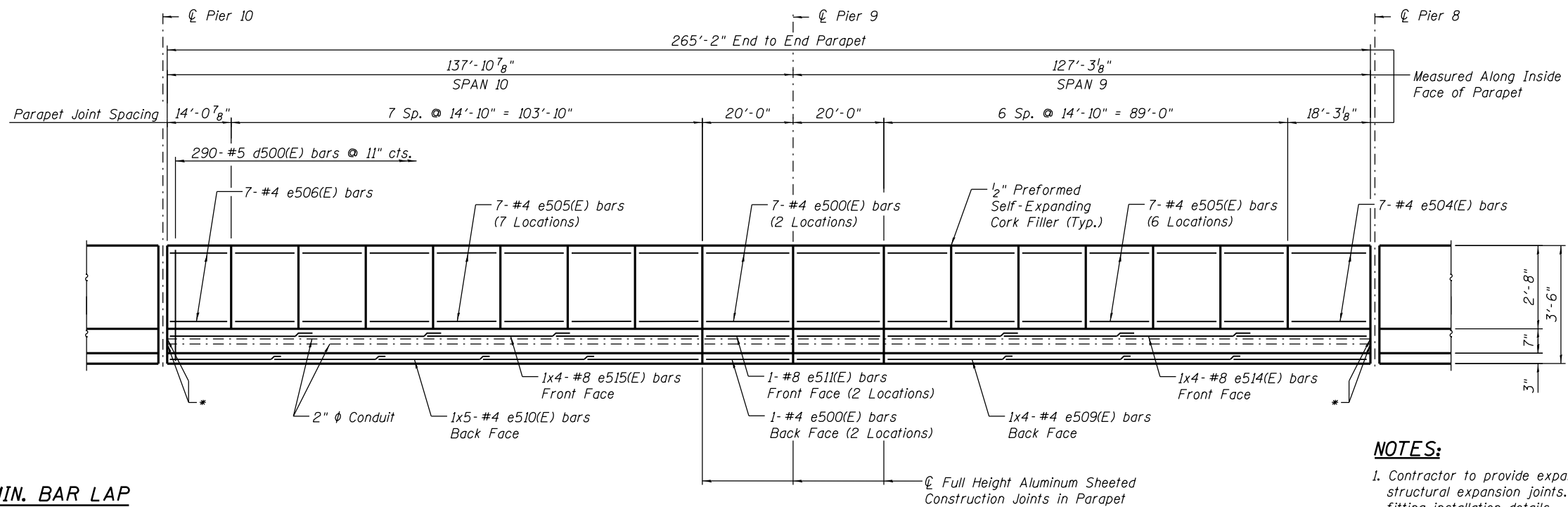

**INSIDE ELEVATION OF RIGHT PARAPET - UNIT V**

**MIN. BAR LAP**  
(Parapet)  
#4 bar = 2'-0"  
#8 bar = 5'-2"

**NOTES:**

1. Contractor to provide expansion/deflection conduit fittings at all structural expansion joints. See electrical plans for expansion/deflection fitting installation details.
2. Bars indicated Locations: 1x4- #8 etc., indicates one line of bars with 4 lengths per line.
3. For parapet details see Sheet S-58.
4. For electrical junction box locations and conduit stub out details see electrical plans.

0161705-60W28-5049-Parapet.dgn



USER NAME = floresg	DESIGNED - JRE	REVISED
	CHECKED - KMS	REVISED
PLOT SCALE = N.T.S.	DRAWN - TNP	REVISED
PLOT DATE = 5/7/2014	CHECKED - EJO	REVISED

**STATE OF ILLINOIS  
DEPARTMENT OF TRANSPORTATION**

**PARAPET ELEVATIONS - UNIT V  
STRUCTURE NO. 016-1705**

SHEET NO. S-49 OF S-165 SHEETS

F.A.I. RTE.	SECTION	COUNTY	TOTAL SHEETS	SHEET NO.
90/94/290	2013-010R	COOK	747	365
CONTRACT NO.			60W28	
ILLINOIS FED. AID PROJECT				