

INSIDE ELEVATION OF LEFT PARAPET - UNIT III

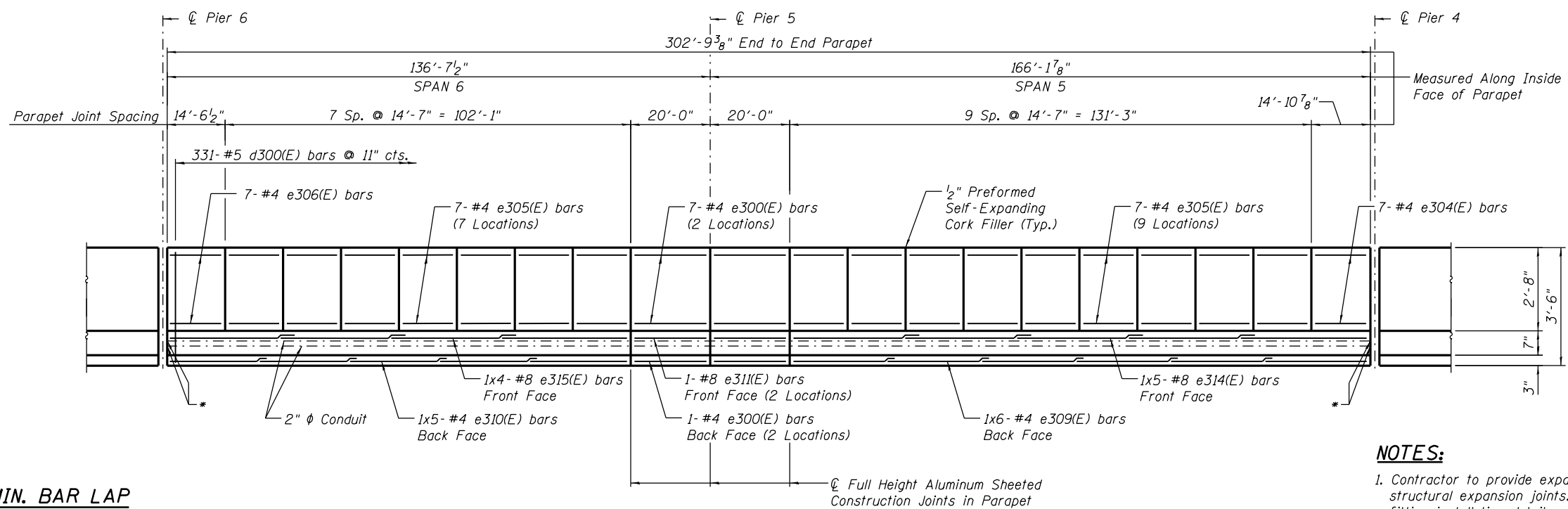

INSIDE ELEVATION OF RIGHT PARAPET - UNIT III

MIN. BAR LAP
(Parapet)
#4 bar = 2'-0"
#8 bar = 5'-2"

* Place conduit expansion/deflection fitting at all expansion joints.

NOTES:

1. Contractor to provide expansion/deflection conduit fittings at all structural expansion joints. See electrical plans for expansion/deflection fitting installation details.
2. Bars indicated Locations: 1x4-#8 etc., indicates one line of bars with 4 lengths per line.
3. For parapet details see Sheet S-58.
4. For electrical junction box locations and conduit stub out details see electrical plans.

0161705-60W28-5047-Parapet.dgn



USER NAME = floresg	DESIGNED - JRE	REVISED
	CHECKED - KMS	REVISED
PLOT SCALE = N.T.S.	DRAWN - TNP	REVISED
PLOT DATE = 5/7/2014	CHECKED - EJO	REVISED

**STATE OF ILLINOIS
DEPARTMENT OF TRANSPORTATION**

**PARAPET ELEVATIONS - UNIT III
STRUCTURE NO. 016-1705**

SHEET NO. S-47 OF S-165 SHEETS

F.A.I. RTE.	SECTION	COUNTY	TOTAL SHEETS	SHEET NO.
90/94/290	2013-010R	COOK	747	363
CONTRACT NO.			60W28	
ILLINOIS FED. AID PROJECT				