

To determine "t": After all structural steel has been erected, elevations of the top flanges of the girders shall be taken at intervals shown below. These elevations subtracted from the "Theoretical Grade Elevations Adjusted for Dead Load Deflection" shown on Sheets S-22 and S-23, minus slab thickness, equals the fillet heights "t" above top flange of girders.

FILLET HEIGHTS

Girder No.	DEAD LOAD DEFLECTIONS									
	Span 7					Span 8				
	A1	A2	A3	A4	A5	B1	B2	B3	B4	B5
1	3"	3 1/8"	1 1/8"	49'-0 5/8"	196'-2 3/8"	1 1/8"	3 1/8"	3"	49'-0 5/8"	196'-2 3/8"
2	2 7/8"	3"	1 1/8"	48'-4"	193'-3 7/8"	1 1/8"	3"	2 7/8"	48'-4"	193'-3 7/8"
3	2 3/4"	2 7/8"	1 1/8"	47'-7 3/8"	190'-5 1/4"	1 1/8"	2 7/8"	2 3/4"	47'-7 3/8"	190'-5 1/4"
4	2 5/8"	2 3/4"	1 1/8"	46'-10 5/8"	187'-6 3/4"	1 1/8"	2 7/8"	2 5/8"	46'-10 5/8"	187'-6 3/4"
5	2 5/8"	2 3/4"	1 1/8"	46'-2"	184'-8 1/8"	1 1/8"	2 3/4"	2 5/8"	46'-2"	184'-8 1/8"
6	2 1/2"	2 3/4"	1 1/8"	45'-5 3/8"	181'-9 5/8"	1 1/8"	2 3/4"	2 1/2"	45'-5 3/8"	181'-9 5/8"

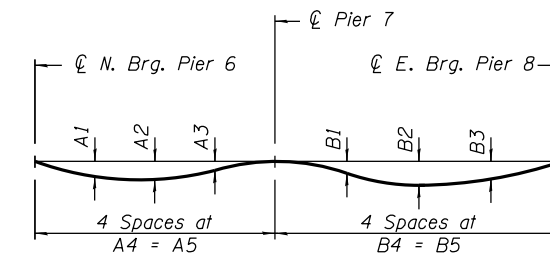

DEAD LOAD DEFLECTION DIAGRAM

(Includes weight of concrete only.)

Notes:
The above deflections are not to be used in the field if the engineer is working from the grade elevations adjusted for dead load deflections as shown on Sheets S-22 and S-23.

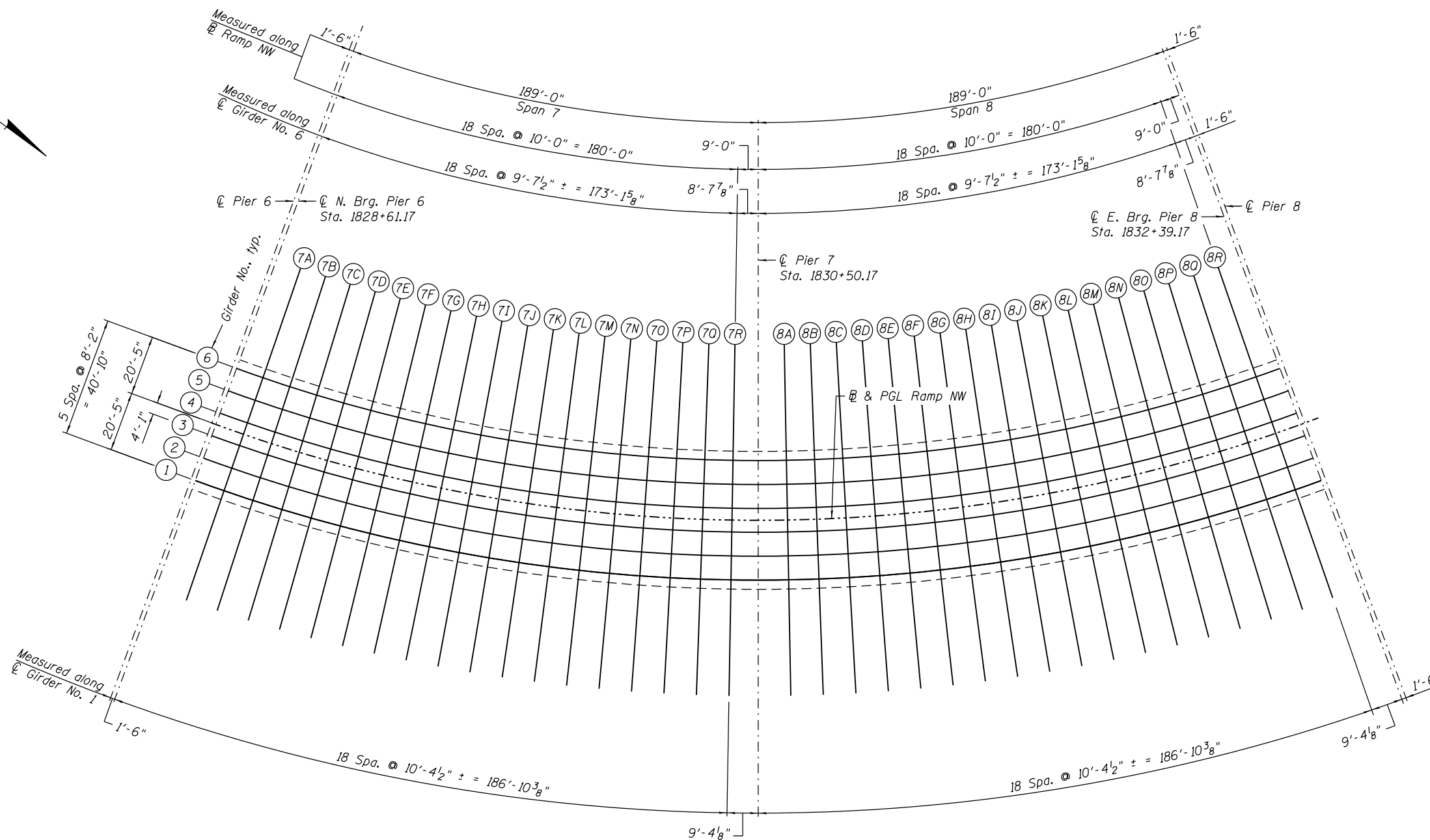
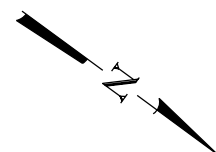

PLAN

0161705-60W28-5021-TopSlab.dgn



USER NAME = floresg	DESIGNED - VP	REVISED
	CHECKED - MK	REVISED
PLOT SCALE = N.T.S.	DRAWN - MRK	REVISED
PLOT DATE = 5/7/2014	CHECKED - ATB	REVISED

**STATE OF ILLINOIS
DEPARTMENT OF TRANSPORTATION**

**TOP OF SLAB ELEVATIONS PLAN - UNIT IV
STRUCTURE NO. 016-1705**

SHEET NO. S-21 OF S-165 SHEETS

F.A.I. RTE.	SECTION	COUNTY	TOTAL SHEETS	SHEET NO.
90/94/290	2013-010R	COOK	747	337
CONTRACT NO. 60W28				
ILLINOIS FED. AID PROJECT				