

**NOTES:**

1. All Substructure are oriented 90° to  $\bar{B}$  & PGL Ramp NW unless noted otherwise.
2. For Pier 7 Drilled Shaft and Footing construction details, see sheet S-10.
3. Construction of Pier 8 Drilled Shafts shall not start until exploratory Drilled Shaft Test Hole is performed to confirm that the proposed drilled shafts are not in conflict with existing main drain. Contractor shall notify the Engineer immediately if such conflicts exist. Contractor shall take precautions to not to damage existing main drain during the construction. Any damage shall be repaired by the Contractor at no additional cost. See Special Provision for Drilled Shaft Test Hole.
4. It is anticipated that existing light tower foundation conflicts with the installation of the Pier 9 drilled shafts. The Contractor shall provide the necessary equipment, labor and materials as required to construct proposed drilled shafts. This work shall be completed in accordance with the Special Provision Foundation Construction at Existing Obstructions.
5. See sheet S-11 for Braced Excavation details at Pier 6, 7, 8 & 10.

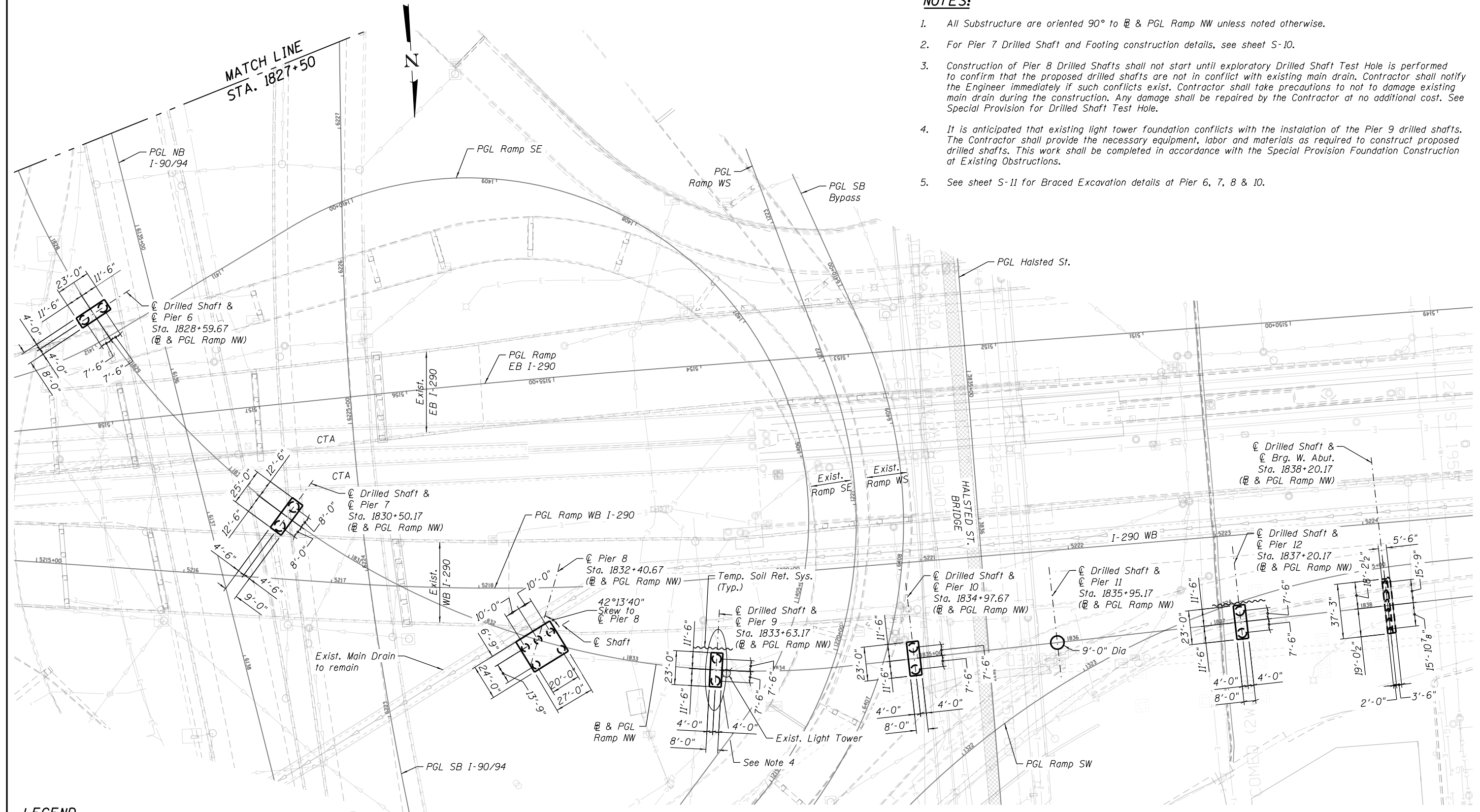

**LEGEND:**

Telephone	— T —
Combined Sewer	←←←←←
Water Line	— W —
Electric	— E —
Gas Line	— G —
Fiber Optic	— FO —
Fire Hydrant	⊙
Storm Sewer	▶▶▶▶▶
Light Pole	⊗

**SUBSTRUCTURE LAYOUT PLAN**

0161705-60W28-5009-SubStruct.dgn



USER NAME = floresg	DESIGNED - ATB	REVISED
	CHECKED - DD	REVISED
PLOT SCALE = N.T.S.	DRAWN - MRK	REVISED
PLOT DATE = 5/7/2014	CHECKED - ATB	REVISED

**STATE OF ILLINOIS  
DEPARTMENT OF TRANSPORTATION**

**SUBSTRUCTURE LAYOUT II  
STRUCTURE NO. 016-1705**

SHEET NO. S-9 OF S-165 SHEETS

F.A.I. RTE. 90/94/290	SECTION 2013-010R	COUNTY COOK	TOTAL SHEETS 747	SHEET NO. 325
CONTRACT NO. 60W28			ILLINOIS FED. AID PROJECT	