

Location	A
S. Abut.	50°23'38"
Pier 1	49°36'25"
Pier 2	45°59'05"
Pier 3	45°50'34"
Pier 4	49°30'07"
Pier 5	34°09'55"
Pier 6	20°12'46"
Pier 7	00°00'00"
Pier 8	20°12'45"
Pier 9	33°12'36"
Pier 10	42°39'51"
Pier 11	42°39'51"
Pier 12	42°39'51"
W. Abut.	42°39'51"

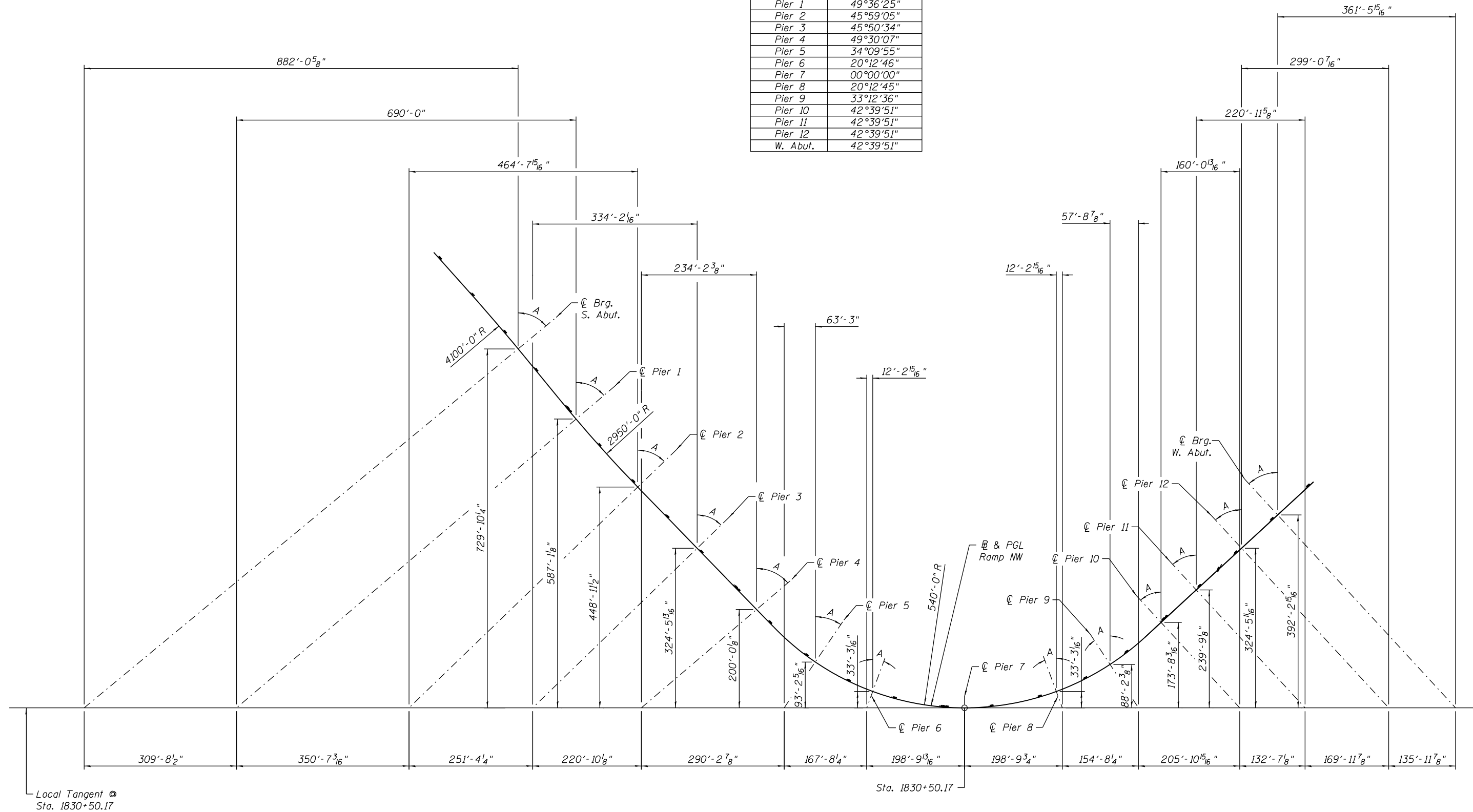

OFFSET SKETCH

0161705-60W28-5007-Offset.dgn



USER NAME = floresg	DESIGNED - DD	REVISED
	CHECKED - ATB	REVISED
PLOT SCALE = N.T.S.	DRAWN - DD	REVISED
PLOT DATE = 5/7/2014	CHECKED - ATB	REVISED

STATE OF ILLINOIS
DEPARTMENT OF TRANSPORTATION

OFFSET SKETCH
STRUCTURE NO. 016-1705

SHEET NO. S-7 OF S-165 SHEETS

F.A.I. RTE.	SECTION	COUNTY	TOTAL SHEETS	SHEET NO.
90/94/290	2013-010R	COOK	747	323
CONTRACT NO. 60W28			ILLINOIS FED. AID PROJECT	