

FILE PATH = p:\388035\pmt\lecomonline\local\p\AECOM\Documents\01_Americas\Transportation\60269938_Circle\Phase_1\1000_CAD\005_Roadway_Sheets\60W28-sh-ITS-07

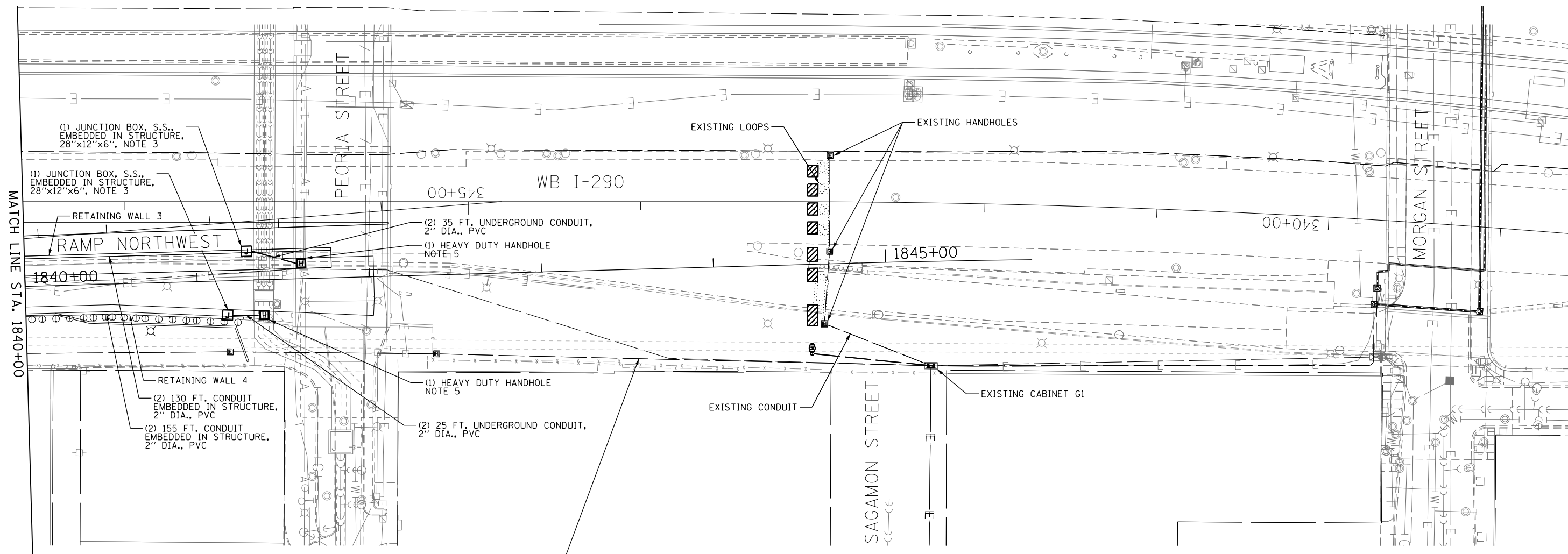

TO BE INSTALLED UNDER CONTRACTS 60W26 AND 60W29 (BY OTHERS);
 3" PVC CONDUIT
 (1) 6/C #19 COMM. CABLE
 (1) 2/C #6 WITH #8 GROUND POWER CABLE

NOTES:

1. MAINTAIN THE EXISTING IDOT DETECTION SYSTEMS (ITS) AFFECTED BY THE NW FLYOVER CONSTRUCTION. THIS WORK SHALL BE INCLUDED IN THE COST OF THE 'MAINTAINING ITS DURING CONSTRUCTION' PAY ITEM. SEE THE 'OPERATION OF EXISTING TRAFFIC SURVEILLANCE/SPEED/COUNT STATIONS' SPECIAL PROVISION FOR ADDITIONAL DETAILS.
2. TWO 2" DIAMETER CONDUITS TO BE INSTALLED IN THE BARRIER WALL OF THE RETAINING WALL.
3. JUNCTION BOX TO BE INSTALLED IN BARRIER RAILS OF RETAINING WALL.
4. TWO 2" DIAMETER CONDUITS IN BARRIER RAIL TO TRANSITION TO HEAVY DUTY HANDHOLE.
5. HEAVY DUTY HANDHOLES AT THE END OF WALL 3 AND WALL 4 TO BE INSTALLED IN THE SHOULDER OF THE NW RAMP.

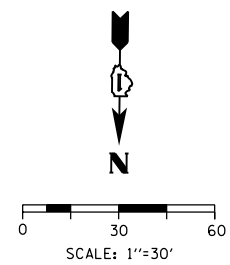

D160W28-sh-ITS-07
 USER NAME = myersc
 PLOT SCALE = 30.0000' / in.
 PLOT DATE = 4/24/2014

DESIGNED -	GWS	REVISED -	
DRAWN -	CAM	REVISED -	
CHECKED -	JDG	REVISED -	
DATE -	04/28/14	REVISED -	

**STATE OF ILLINOIS
 DEPARTMENT OF TRANSPORTATION**

**PROPOSED ITS PLAN
 RAMP NORTHWEST**

SCALE: 1"=30' SHEET 7 OF 9 SHEETS STA. 1840+00 TO STA.

F.A.I. RTE.	SECTION	COUNTY	TOTAL SHEETS	SHEET NO.
90/94/290	2013-010R	COOK	747	314
CONTRACT NO. 60W28				
ILLINOIS FED. AID PROJECT				