

**NOTES:**

1. TWO 2" DIAMETER CONDUITS TO BE INSTALLED IN THE BARRIER RAIL OF THE RETAINING WALL.
2. JUNCTION BOX TO BE INSTALLED IN THE BARRIER RAIL OF THE RETAINING WALL.
3. MAINTAIN THE EXISTING IDOT DETECTION SYSTEM (ITS) AFFECTED BY THE NW FLYOVER CONSTRUCTION. THIS WORK SHALL BE INCLUDED IN THE COST OF THE 'MAINTAINING ITS DURING CONSTRUCTION' PAY ITEM. SEE THE 'OPERATION OF EXISTING TRAFFIC SURVEILLANCE/SPEED/COUNT STATIONS' SPECIAL PROVISION FOR MORE DETAILS.
4. TWO CONDUITS IN JUNCTION BOX TO TRANSITION TO HEAVY DUTY HANDHOLE.

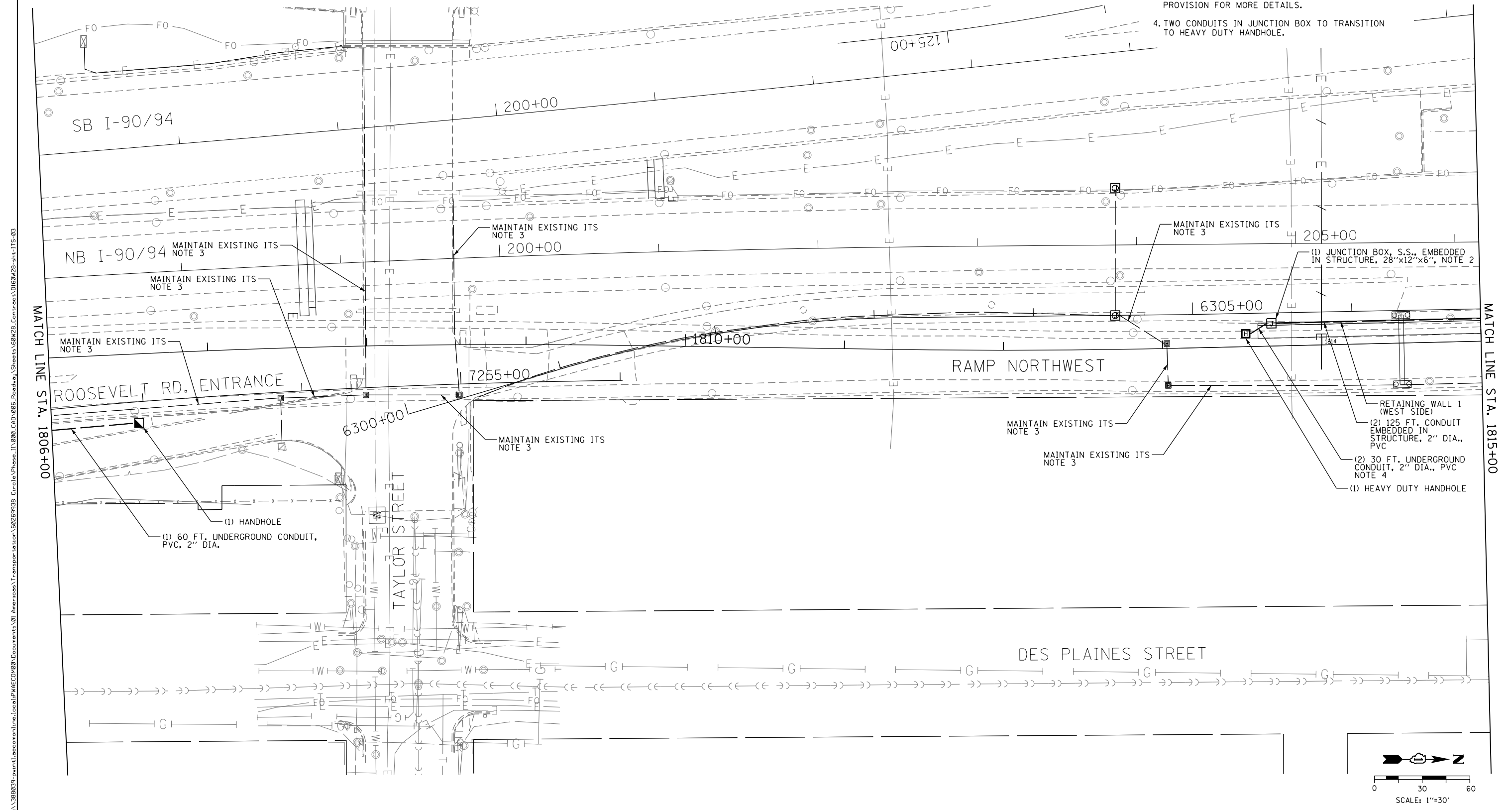

FILE PATH = p:\388035\pmt\aecon\line\local\p\AECD\00\Documents\01\_Americas\Transportation\66269938\_Circle\Phase\_1\000\_CAD\005\_Roadway\_Sheets\66W28-sht-ITS-03



D160W28-sht-ITS-03  
 USER NAME = myersc  
 PLOT SCALE = 30.0000' / in.  
 PLOT DATE = 4/24/2014

DESIGNED - GWS	REVISED -
DRAWN - CAM	REVISED -
CHECKED - JDG	REVISED -
DATE - 04/28/14	REVISED -

**STATE OF ILLINOIS**  
**DEPARTMENT OF TRANSPORTATION**

**PROPOSED ITS PLAN**  
**RAMP NORTHWEST**

SCALE: 1"=30'    SHEET 3 OF 9 SHEETS    STA. 1806+00 TO STA. 1815+00

F.A.I. RTE.	SECTION	COUNTY	TOTAL SHEETS	SHEET NO.
90/94/290	2013-010R	COOK	747	310
CONTRACT NO. 60W28				
ILLINOIS FED. AID PROJECT				