

FILE PATH = p:\388035\pmt\escomonline\local\AECOM\Documents\01\_Americas\Transportation\6269938\_Circle\Phase\_1\000\_CAD\005\_Roadway\_Sheets\60W28\_Contract\0160W28-sht-ITS-01

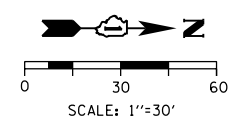
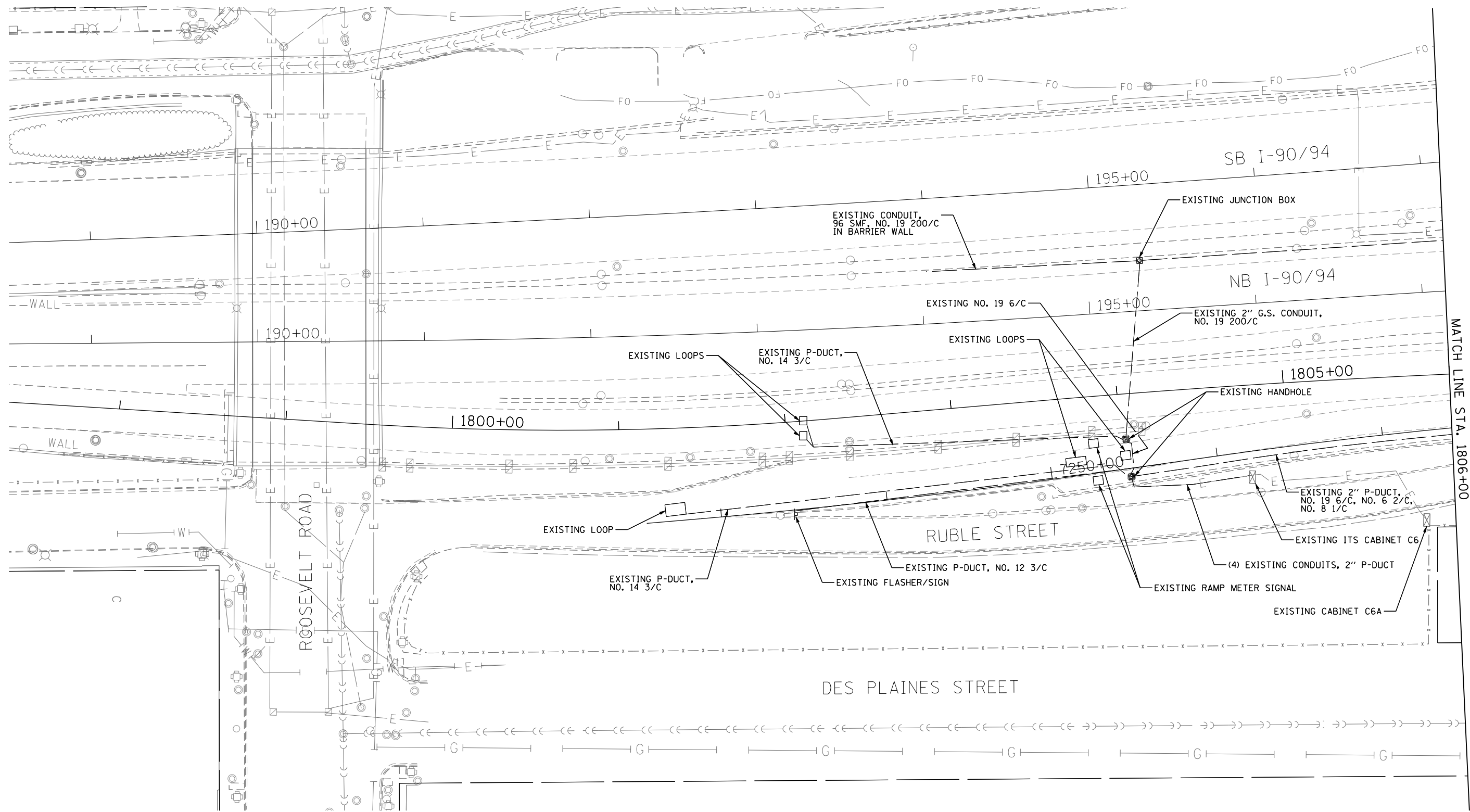

D160W28-sht-ITS-01  
 USER NAME = myersc  
 PLOT SCALE = 30.0000' / in.  
 PLOT DATE = 4/24/2014

DESIGNED - GWS  
 DRAWN - CAM  
 CHECKED - JDG  
 DATE - 04/28/14

REVISED -  
 REVISED -  
 REVISED -  
 REVISED -

**STATE OF ILLINOIS  
 DEPARTMENT OF TRANSPORTATION**

**EXISTING ITS PLAN  
 RAMP NORTHWEST**

SCALE: 1"=30' SHEET 1 OF 9 SHEETS STA. TO STA. 1806+00

| F.A.I. RTE.        | SECTION   | COUNTY | TOTAL SHEETS              | SHEET NO. |
|--------------------|-----------|--------|---------------------------|-----------|
| 90/94/290          | 2013-010R | COOK   | 747                       | 308       |
| CONTRACT NO. 60W28 |           |        | ILLINOIS FED. AID PROJECT |           |