

SIGNING NOTES

1. SEE SIGN SCHEDULE FOR SIGN PANEL AND MOUNTING INFORMATION.
2. BEFORE BEGINNING ANY WORK, THE CONTRACTOR SHALL RECORD AND RETAIN ALL EXISTING SIGN INFORMATION FOR FUTURE REFERENCE. EXACT LOCATIONS OF ALL SIGNS SHALL BE DIRECTED BY THE ENGINEER.

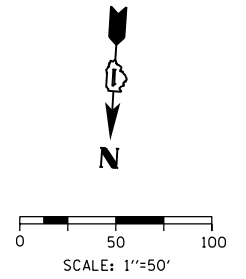

EX-01-GM
 STA 1833+88
 REMOVE, STORE AND RE-ERECT
 SIGN PANEL (SPECIAL)

NOTICE
 MOVE OVER - SLOW DOWN
 FOR STOPPED EMERGENCY
 OR MAINTENANCE VEHICLES
 IT'S THE LAW

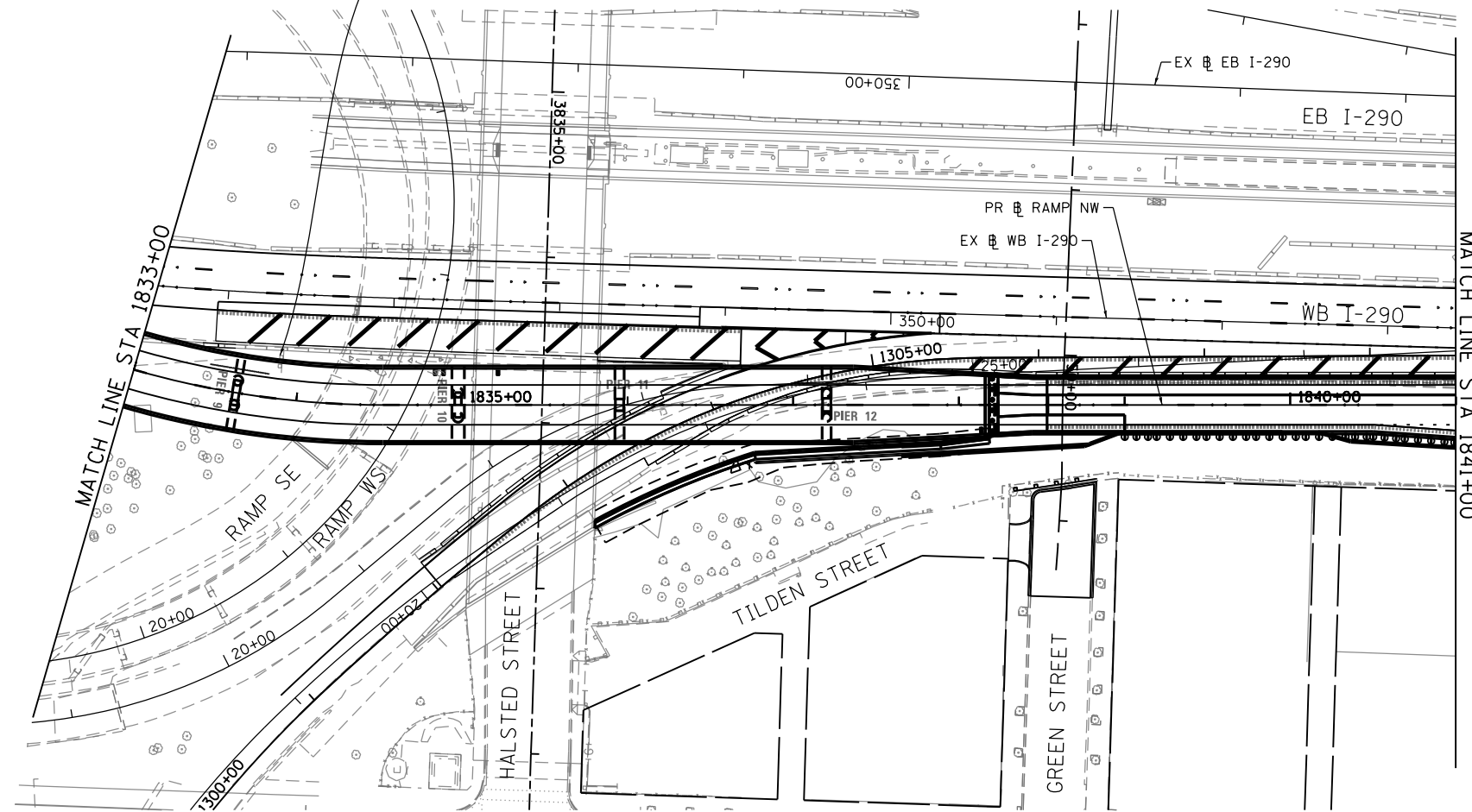

FILE PATH = p:\388035\pmt\escomon\me\local\AECOM\Documents\01_Americas\Transportation\6264938_Circle\Phase_1\000_CAD\005_Roadway_Sheets\60W28_Contract\0160W28-SHT-Sign-06.dgn



D160W28-SHT-Sign-06.dgn	DESIGNED - OPS	REVISED -
USER NAME = pimsarno	DRAWN - NSA	REVISED -
PLOT SCALE = 100.0000' / in.	CHECKED - KCF	REVISED -
PLOT DATE = 4/28/2014	DATE - 04/28/14	REVISED -

**STATE OF ILLINOIS
 DEPARTMENT OF TRANSPORTATION**

SIGNING PLAN

SCALE: 1"=50' SHEET 6 OF 7 SHEETS STA. 1833+00 TO STA. 1841+00

F.A.I. RTE.	SECTION	COUNTY	TOTAL SHEETS	SHEET NO.
90/94/290	2013-010R	COOK	747	275
CONTRACT NO. 60W28			ILLINOIS FED. AID PROJECT	