

PROPOSED TEMP PAVEMENT MARKINGS AND TRAFFIC CONTROL DEVICES

- (A) TEMP EPOXY PVT MK LINE 4 (SOLID WHITE)
- (B) TEMP EPOXY PVT MK LINE 4 (SOLID YELLOW)
- (C) TEMP EPOXY PVT MK LINE 4 (2' DASH 6' SKIP, WHITE)
- (D) TEMP EPOXY PVT MK LINE 5 (10' DASH 30' SKIP, WHITE)
- (E) TEMP EPOXY PVT MK LINE 8 (SOLID WHITE)
- (F) TEMP EPOXY PVT MK LINE 12 (WHITE CHEVRONS @ 45°, 30' SPACING) (TYP)
- (G) TEMP CONC BARRIER @ 12:1 ON TAPERS UNLESS OTHERWISE NOTED
- (H) IMP ATTN TEMP FRN TL3
- (I) TYPE II BARRICADE OR DRUMS WITH STEADY BURN MONODIRECTIONAL LIGHT @ 50' C-C (TYP) ON TAPERS AND RAMP @ 100' C-C (TYP) ON TANGENTS
- (J) DIRECTIONAL INDICATOR BARRICADE WITH STEADY BURN MONODIRECTIONAL LIGHT @ 50' C-C
- (K) REL TEMP CONC BARRIER @ 12:1 ON TAPERS UNLESS OTHERWISE NOTED
- (L) IMP ATTN REL FRN TL3

LEGEND:

- WORK ZONE
- TEMPORARY CONCRETE BARRIER
- TEMPORARY IMPACT ATTENUATOR
- TEMPORARY SOIL RETENTION SYSTEM OR BRACED EXCAVATION
- DIRECTION OF TRAFFIC FLOW
- TYPE III BARRICADE
- TYPE II BARRICADE OR DRUMS WITH STEADY BURN MONODIRECTIONAL LIGHT
- DIRECTIONAL INDICATOR BARRICADE WITH STEADY BURN MONODIRECTIONAL LIGHT @ 50' C-C
- SIGN
- ARROW BOARD
- REMOVAL LIMITS
- TEMPORARY PAVEMENT

* FROM PREVIOUS TO REMAIN

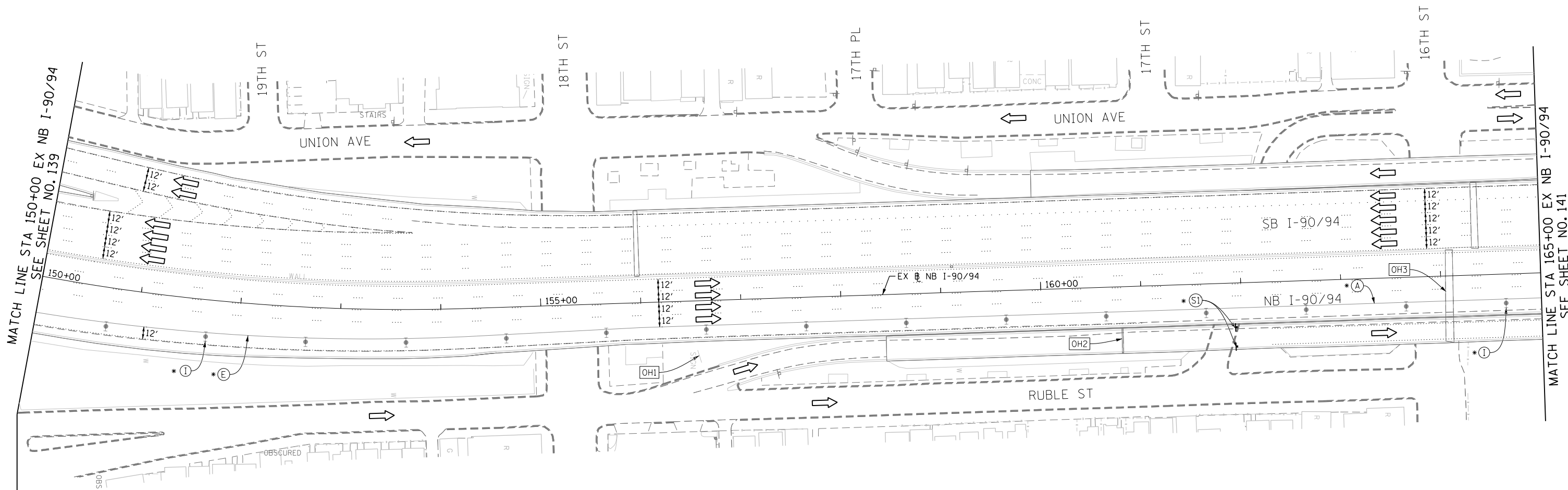

NOTES:
UNLESS NOTED OTHERWISE ALL PAVEMENT MARKING ARE FROM PREVIOUS STAGE

OH1 COVER EXISTING GROUND MOUNTED SIGN (FROM PREVIOUS STAGE TO REMAIN)

OH2 COVER EXISTING OVERHEAD SIGN (FROM PREVIOUS STAGE TO REMAIN)

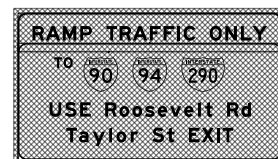
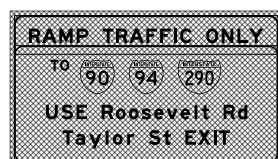

W20-1103(O)-48
S1

OH3 EXISTING OVERHEAD SIGNS

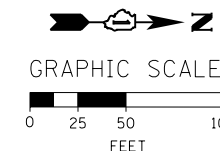
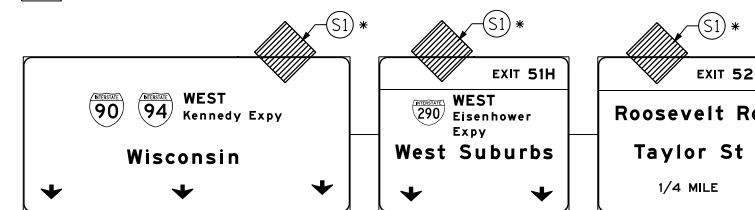

FILE PATH = C:\Project\Case\160W28-Sht-Staging3A-03.dgn



D160W28-Sht-Staging3A-03.dgn
USER NAME = auyeungh
PLOT SCALE = 50.0000' / 1"
PLOT DATE = 4/28/2014

DESIGNED - OPS
DRAWN - PHP
CHECKED - KCF
DATE - 04/28/14

REVISED -
REVISED -
REVISED -
REVISED -

**STATE OF ILLINOIS
DEPARTMENT OF TRANSPORTATION**

**SUGGESTED STAGES OF CONSTRUCTION AND TRAFFIC CONTROL PLAN
MAINLINE STAGING 3A**

SCALE: 1" = 50' SHEET 4 OF 14 SHEETS STA. 150+00 TO STA. 165+00

F.A.I. RTE.	SECTION	COUNTY	TOTAL SHEETS	SHEET NO.
90/94/290	2013-010R	COOK	747	140
CONTRACT NO. 60W28				
ILLINOIS FED. AID PROJECT				