

- LEGEND:**
- WORK ZONE
 - TEMPORARY CONCRETE BARRIER
 - TEMPORARY IMPACT ATTENUATOR
 - TEMPORARY SOIL RETENTION SYSTEM OR BRACED EXCAVATION
 - DIRECTION OF TRAFFIC FLOW
 - TYPE III BARRICADE
 - TYPE II BARRICADE OR DRUMS WITH STEADY BURN MONODIRECTIONAL LIGHT
 - DIRECTIONAL INDICATOR BARRICADE WITH STEADY BURN MONODIRECTIONAL SIGN
 - ARROW BOARD
 - REMOVAL LIMITS
 - TEMPORARY PAVEMENT

- PROPOSED TEMP PAVEMENT MARKINGS AND TRAFFIC CONTROL DEVICES**
- (A) TEMP EPOXY PVT MK LINE 4 (SOLID WHITE)
 - (B) TEMP EPOXY PVT MK LINE 4 (SOLID YELLOW)
 - (C) TEMP EPOXY PVT MK LINE 4 (2' DASH 6' SKIP, WHITE)
 - (D) TEMP EPOXY PVT MK LINE 5 (10' DASH 30' SKIP, WHITE)
 - (E) TEMP EPOXY PVT MK LINE 8 (SOLID WHITE)
 - (F) TEMP EPOXY PVT MK LINE 12 (WHITE CHEVRONS @ 45°, 30' SPACING) (TYP)
 - (G) TEMP CONC BARRIER @ 12:1 ON TAPERS UNLESS OTHERWISE NOTED
 - (H) IMP ATTN TEMP FRN TL3
 - (I) TYPE II BARRICADE OR DRUMS WITH STEADY BURN MONODIRECTIONAL LIGHT @ 50' C-C (TYP) ON TAPERS AND RAMP @ 100' C-C (TYP) ON TANGENTS
 - (J) DIRECTIONAL INDICATOR BARRICADE WITH STEADY BURN MONODIRECTIONAL LIGHT @ 50' C-C
 - (K) REL TEMP CONC BARRIER @ 12:1 ON TAPERS UNLESS OTHERWISE NOTED
 - (L) IMP ATTN REL FRN TL3

** FROM CONTRACT 60W26 TO REMAIN
 *** FROM CONTRACT 60W71 TO REMAIN

MATCH LINE STA 1819+00 PR RAMP NW
 SEE SHEET NO. 115

MATCH LINE STA 1833+00 PR RAMP NW
 SEE SHEET NO. 117

MATCH LINE STA 16+35 I-90/94 SB
 SEE SHEET NO. 119

MATCH LINE STA 362+00.00 I-290 WB
 SEE SHEET NO. 122

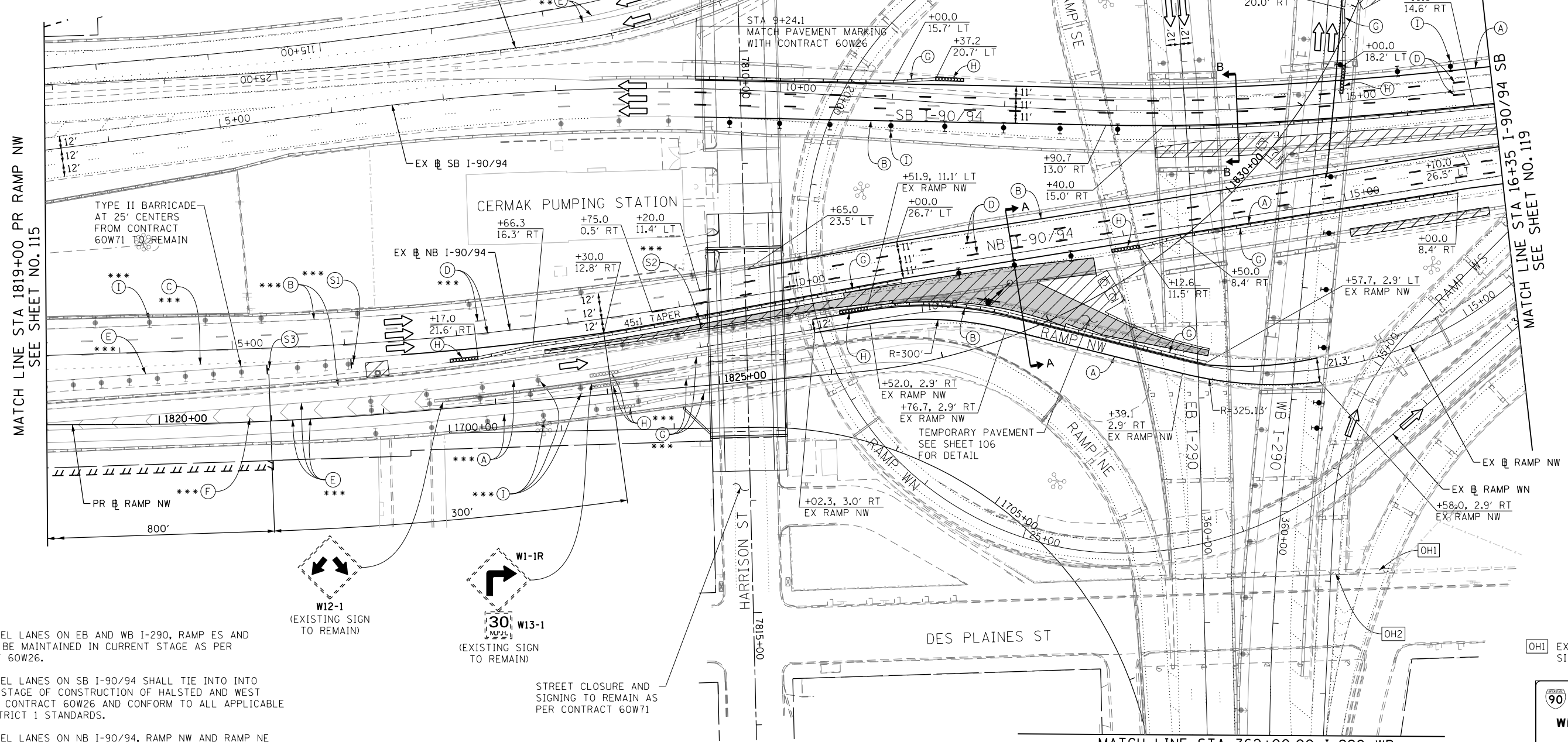

- NOTES:**
- ALL TRAVEL LANES ON EB AND WB I-290, RAMP ES AND RAMP WS BE MAINTAINED IN CURRENT STAGE AS PER CONTRACT 60W26.
 - ALL TRAVEL LANES ON SB I-90/94 SHALL TIE INTO INTO CURRENT STAGE OF CONSTRUCTION OF HALSTED AND WEST HARRISON CONTRACT 60W26 AND CONFORM TO ALL APPLICABLE IDOT DISTRICT 1 STANDARDS.
 - ALL TRAVEL LANES ON NB I-90/94, RAMP NW AND RAMP NE SHALL TIE INTO INTO CURRENT STAGE OF CONSTRUCTION OF EAST HARRISON CONTRACT 60W71 AND CONFORM TO ALL APPLICABLE IDOT DISTRICT 1 STANDARDS.
 - UNLESS NOTED OTHERWISE ALL PAVEMENT MARKING AND SIGNS ARE FROM CONTRACT 60W26 AND 60W71. DETOUR AND EAST HARRISON BRIDGE CLOSURE SIGNING SHALL BE MAINTAINED AS PER CONTRACT 60W71.

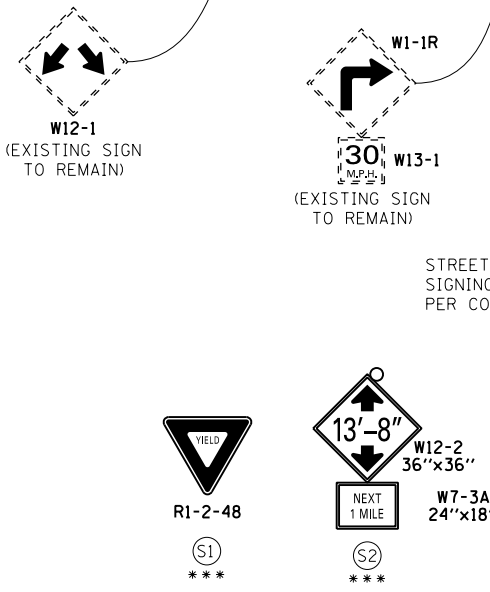

STREET CLOSURE AND SIGNING TO REMAIN AS PER CONTRACT 60W71

OH2 EXISTING OVERHEAD SIGN

OH1 EXISTING OVERHEAD SIGN

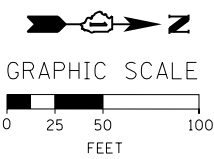
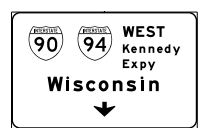

FILE PATH = C:\Projects\60W26-sht-Staging\07.dgn



D160W28-sht-Staging\07.dgn
 USER NAME = auyeuqh
 PLOT SCALE = 50.0000' / in.
 PLOT DATE = 4/28/2014

DESIGNED - OPS	REVISED -
DRAWN - PHP	REVISED -
CHECKED - KCF	REVISED -
DATE - 04/28/14	REVISED -

STATE OF ILLINOIS
 DEPARTMENT OF TRANSPORTATION

SUGGESTED STAGES OF CONSTRUCTION AND TRAFFIC CONTROL PLAN
MAINLINE STAGING 1
 SCALE: 1" = 50' SHEET 7 OF 13 SHEETS STA. 1819+00 TO STA. 16+35

F.A.I. RTE. 90/94/290	SECTION 2013-010R	COUNTY COOK	TOTAL SHEETS 747	SHEET NO. 116
CONTRACT NO. 60W28			ILLINOIS FED. AID PROJECT	