

PLAN	SURVEYED	DATE
	PLOTTED	
	ALIGNED	
	CHECKED	
	FILED	
	NO.	
	NO.	
	NO.	

PROFILE	SURVEYED	DATE
	PLOTTED	
	GRADES	
	CHECKED	
	STRUCTURE	
	NOTATIONS	
	CHKD	
	NO.	
	NO.	
	NO.	

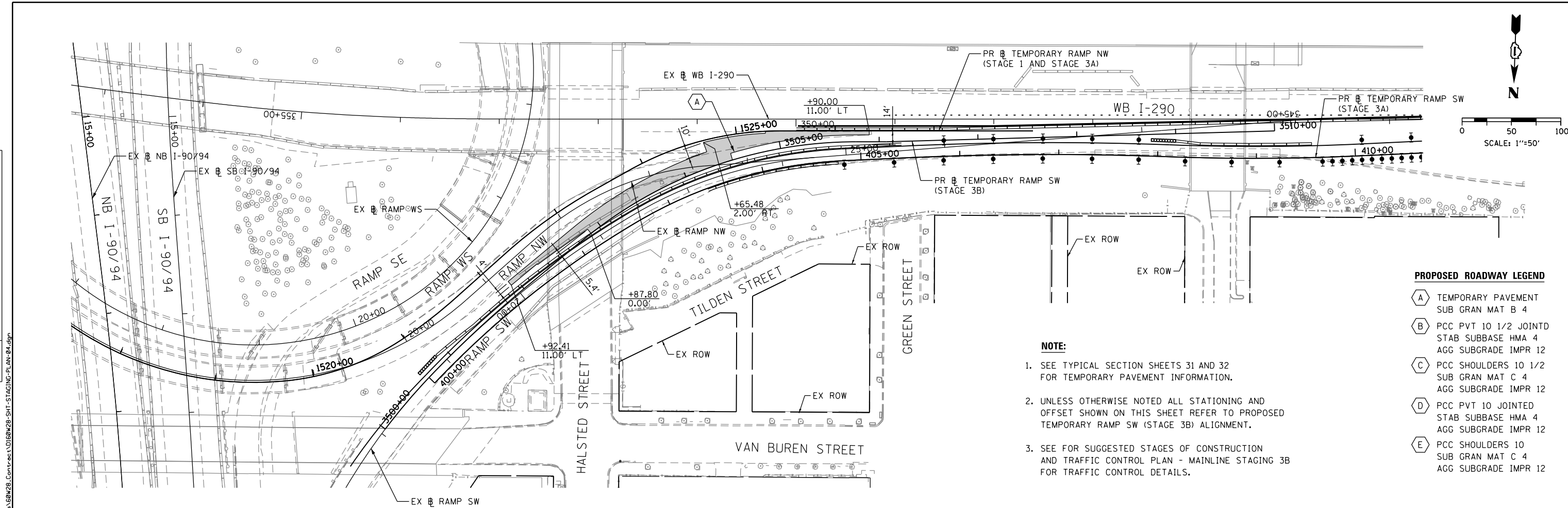

**PROPOSED ROADWAY LEGEND**

- (A) TEMPORARY PAVEMENT SUB GRAN MAT B 4
- (B) PCC PVT 10 1/2 JOINTD STAB SUBBASE HMA 4 AGG SUBGRADE IMPR 12
- (C) PCC SHOULDERS 10 1/2 SUB GRAN MAT C 4 AGG SUBGRADE IMPR 12
- (D) PCC PVT 10 JOINTED STAB SUBBASE HMA 4 AGG SUBGRADE IMPR 12
- (E) PCC SHOULDERS 10 SUB GRAN MAT C 4 AGG SUBGRADE IMPR 12

**NOTE:**

1. SEE TYPICAL SECTION SHEETS 31 AND 32 FOR TEMPORARY PAVEMENT INFORMATION.
2. UNLESS OTHERWISE NOTED ALL STATIONING AND OFFSET SHOWN ON THIS SHEET REFER TO PROPOSED TEMPORARY RAMP SW (STAGE 3B) ALIGNMENT.
3. SEE FOR SUGGESTED STAGES OF CONSTRUCTION AND TRAFFIC CONTROL PLAN - MAINLINE STAGING 3B FOR TRAFFIC CONTROL DETAILS.

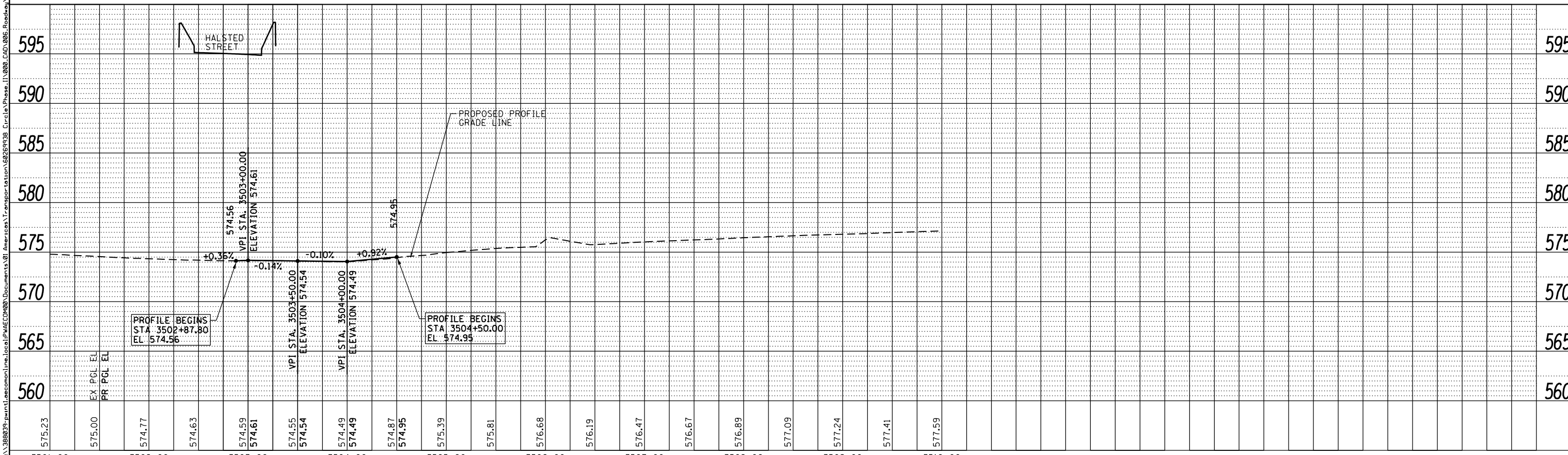

D160W28-SHT-STAGING-PLAN-04.dgn  
 USER NAME = pimsarno  
 PLOT SCALE = 100.0000' / in.  
 PLOT DATE = 4/28/2014

DESIGNED - KAM/OPS  
 DRAWN - NSA/OPS  
 CHECKED - KCF  
 DATE - 04/28/14

REVISED -  
 REVISED -  
 REVISED -  
 REVISED -

**STATE OF ILLINOIS  
 DEPARTMENT OF TRANSPORTATION**

**PROPOSED ROADWAY PLAN AND PROFILE  
 TEMPORARY RAMP SW TIE IN AT WB I-290 (STAGE 3B)**  
 SCALE: 1"=50' SHEET 1 OF 1 SHEETS STA. 3502+87.80 TO STA. 3509+64.30

F.A.I. RTE.	SECTION	COUNTY	TOTAL SHEETS	SHEET NO.
90/94/290	2013-010R	COOK	747	109
CONTRACT NO. 60W28			ILLINOIS FED. AID PROJECT	