

OH1 EXISTING OVERHEAD SIGN TO REMAIN

OH2 EXISTING OVERHEAD SIGN

OH3 EXISTING OVERHEAD SIGNS

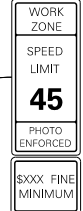
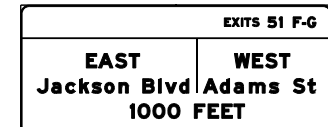
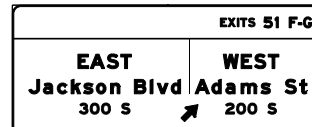
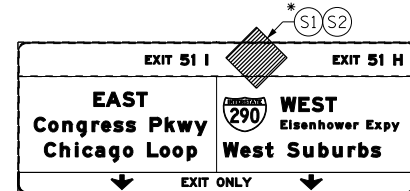

HIT A WORKER \$10,000 FINE 14 YRS JAIL

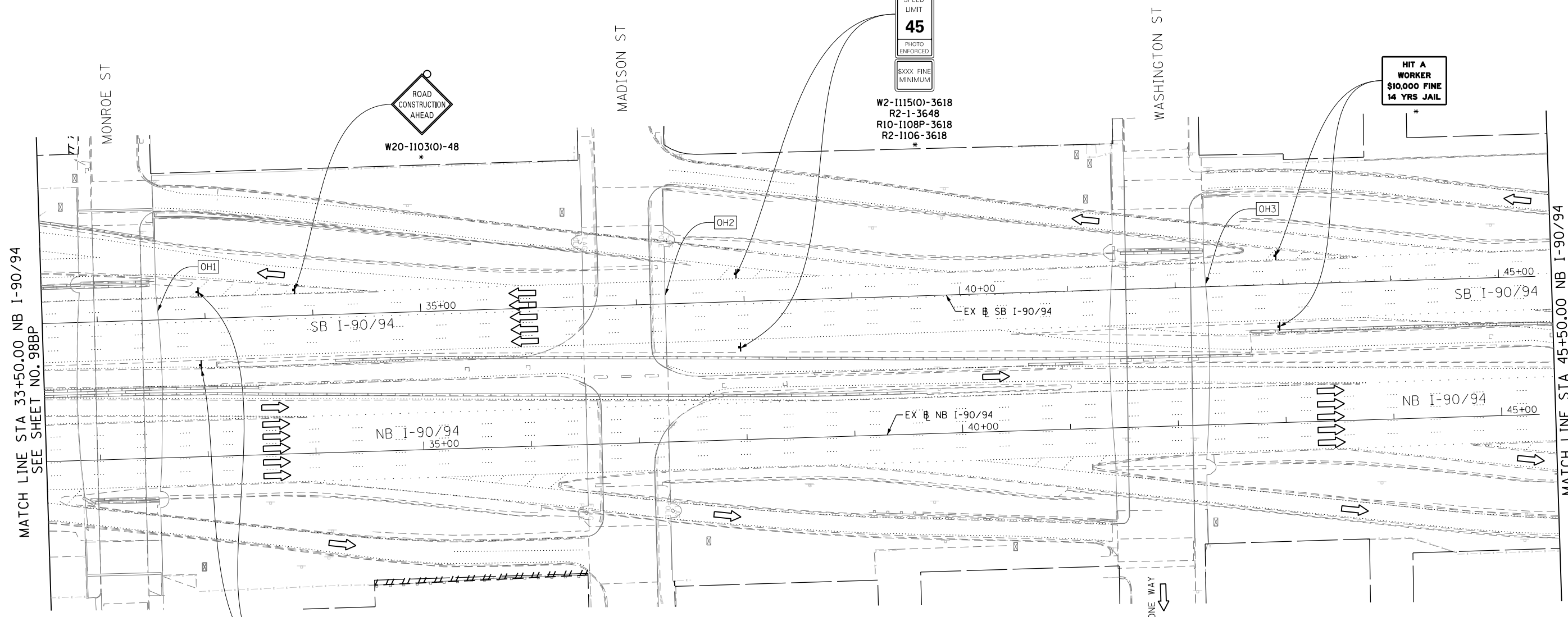

MATCH LINE STA 33+50.00 NB I-90/94 SEE SHEET NO. 98BP

MATCH LINE STA 45+50.00 NB I-90/94 SEE SHEET NO. 98BR

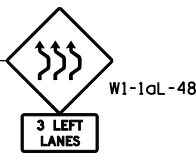

PROPOSED TEMP PAVEMENT MARKINGS AND TRAFFIC CONTROL DEVICES

- (A) TEMP EPOXY PVT MK LINE 4 (SOLID WHITE)
(B) TEMP EPOXY PVT MK LINE 4 (SOLID YELLOW)
(C) TEMP EPOXY PVT MK LINE 4 (2' DASH 6' SKIP, WHITE)
(D) TEMP EPOXY PVT MK LINE 5 (10' DASH 30' SKIP, WHITE)
(E) TEMP EPOXY PVT MK LINE 8 (SOLID WHITE)
(F) TEMP EPOXY PVT MK LINE 12 (WHITE CHEVRONS @ 45, 30' SPACING) (TYP)
(G) TEMP CONC BARRIER @ 12:1 ON TAPERS UNLESS OTHERWISE NOTED
(H) IMP ATTN TEMP FRN TL3
(I) TYPE II BARRICADE OR DRUMS WITH STEADY BURN MONODIRECTIONAL LIGHT @ 50' C-C (TYP) ON TAPERS AND RAMP @ 100' C-C (TYP) ON TANGENTS
(J) DIRECTIONAL INDICATOR BARRICADE WITH STEADY BURN MONODIRECTIONAL LIGHT @ 50' C-C
(K) REL TEMP CONC BARRIER @ 12:1 ON TAPERS UNLESS OTHERWISE NOTED
(L) IMP ATTN REL FRN TL3

LEGEND:

- WORK ZONE
TEMPORARY CONCRETE BARRIER
TEMPORARY IMPACT ATTENUATOR
TEMPORARY SOIL RETENTION SYSTEM OR BRACED EXCAVATION
DIRECTION OF TRAFFIC FLOW
TYPE III BARRICADE
TYPE II BARRICADE OR DRUMS WITH STEADY BURN MONODIRECTIONAL LIGHT
DIRECTIONAL INDICATOR BARRICADE WITH STEADY BURN MONODIRECTIONAL LIGHT
SIGN
ARROW BOARD
REMOVAL LIMITS
TEMPORARY PAVEMENT

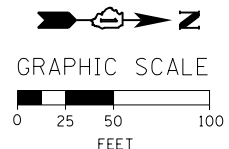

\* FROM PREVIOUS STAGE TO REMAIN



USER NAME = auyeungh
PLOT SCALE = 50.0000' / in.
PLOT DATE = 4/28/2014

Table with columns: DESIGNED - OPS, DRAWN - PHP, CHECKED - KCF, DATE - 04/28/14, REVISED -

STATE OF ILLINOIS DEPARTMENT OF TRANSPORTATION

SUGGESTED STAGES OF CONSTRUCTION AND TRAFFIC CONTROL PLAN GIRDER ERECTION - STAGING PLAN

SCALE: 1" = 50' SHEET 12 OF 14 SHEETS STA. 31+50 TO STA. 45+50

Table with columns: F.A.I. RTE., SECTION, COUNTY, TOTAL SHEETS, SHEET NO., CONTRACT NO. 60W28

FILE PATH = C:\Project\stg\160W28-sht-Staging\_GEP-09.dgn