

OH1 EXISTING OVERHEAD SIGN TO REMAIN
SEE CONTRACT 60W26 FOR SIGN DETAIL

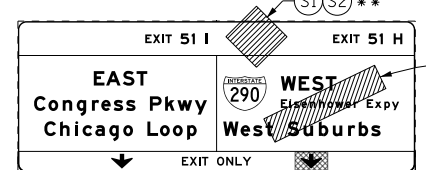

RAMP CLOSED
S3
INSTALLED BLACK ON ORANGE "RAMP CLOSED" PANEL ON DIAGONAL ACROSS EXISTING SIGN SEE DISTRICT DETAIL TC-08 FOR PANEL DETAILS

OH2 EXISTING OVERHEAD SIGN

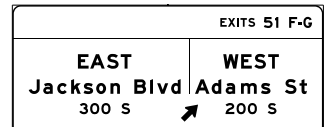

OH3 EXISTING OVERHEAD SIGNS

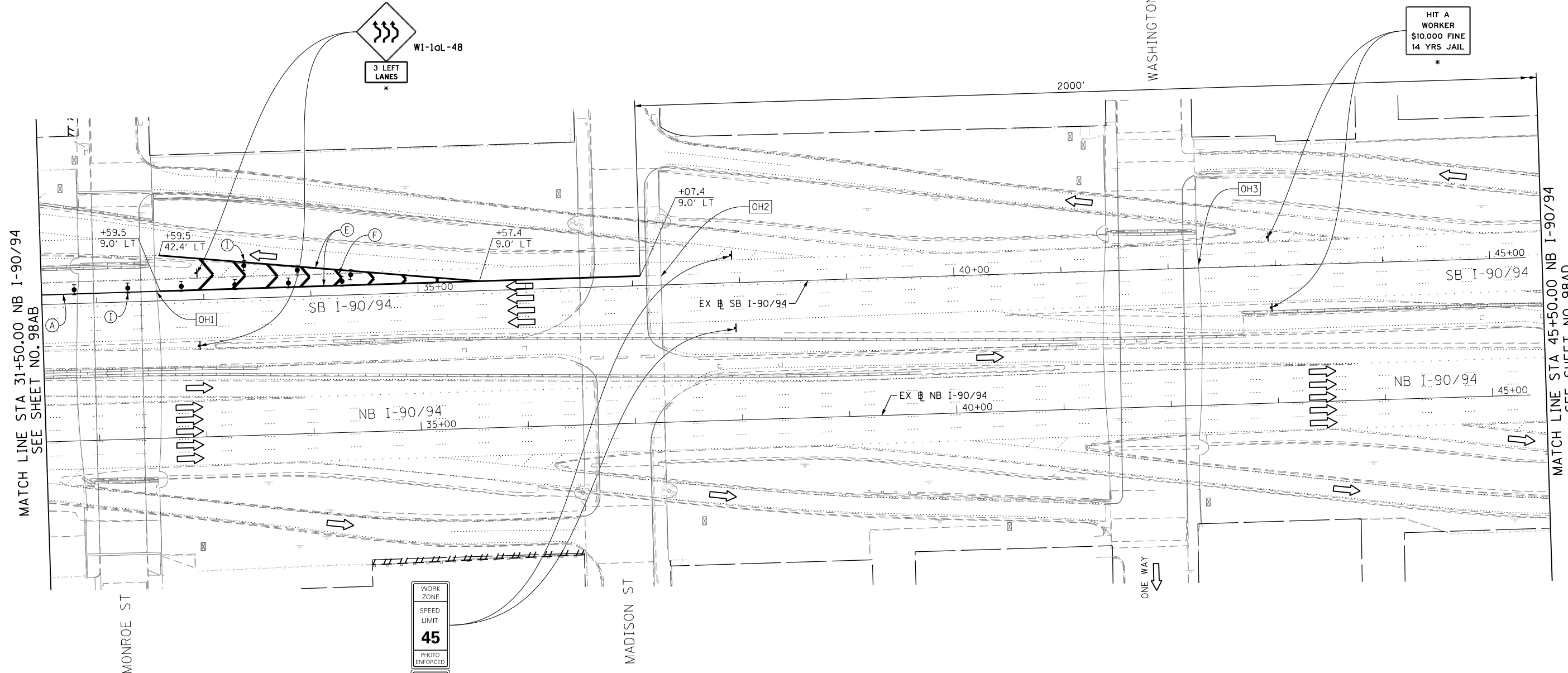
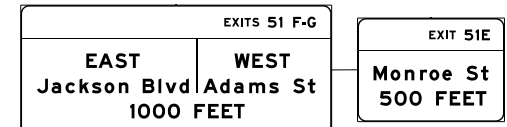

MATCH LINE STA 31+50.00 NB I-90/94
SEE SHEET NO. 98AB

MATCH LINE STA 45+50.00 NB I-90/94
SEE SHEET NO. 98AD

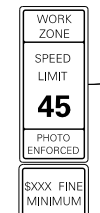

W2-1115(O)-3618
R2-1-3648
R10-1108P-3618
R2-1106-3618

- NOTES:**
- FOR RAMP CLOSURE RESTRICTIONS AND REQUIREMENTS, SEE "STAGING AND INTERCHANGE RESTRICTIONS" AND "GIRDER ERECTION INFORMATION AND RESTRICTIONS" SPECIAL PROVISIONS.
 - FOR RAMP DETOUR INFORMATION, SEE DETOUR PLAN DETAIL SHEETS.
 - ALL TEMPORARY PAVEMENT MARKING AND SIGNING INSTALLED DURING RAMP SW CLOSURE TO BE REMOVED AND RESTORED AS PER CURRENT STAGING PRIOR TO RAMP SW OPENING TO TRAFFIC.

* FROM STAGE 1 TO REMAIN
** FROM CONTRACT 60W26 TO REMAIN

PROPOSED TEMP PAVEMENT MARKINGS AND TRAFFIC CONTROL DEVICES

- (A) TEMP EPOXY PVT MK LINE 4 (SOLID WHITE)
- (B) TEMP EPOXY PVT MK LINE 4 (SOLID YELLOW)
- (C) TEMP EPOXY PVT MK LINE 4 (2' DASH 6' SKIP, WHITE)
- (D) TEMP EPOXY PVT MK LINE 5 (10' DASH 30' SKIP, WHITE)
- (E) TEMP EPOXY PVT MK LINE 8 (SOLID WHITE)
- (F) TEMP EPOXY PVT MK LINE 12 (WHITE CHEVRONS @ 45°, 30' SPACING) (TYP)
- (G) TEMP CONC BARRIER @ 12:1 ON TAPERS UNLESS OTHERWISE NOTED
- (H) IMP ATTN TEMP FRN TL3
- (I) TYPE II BARRICADE OR DRUMS WITH STEADY BURN MONODIRECTIONAL LIGHT @ 50' C-C (TYP) ON TAPERS AND RAMP @ 100' C-C (TYP) ON TANGENTS
- (J) DIRECTIONAL INDICATOR BARRICADE WITH STEADY BURN MONODIRECTIONAL LIGHT @ 50' C-C
- (K) REL TEMP CONC BARRIER @ 12:1 ON TAPERS UNLESS OTHERWISE NOTED
- (L) IMP ATTN REL FRN TL3

LEGEND:

- WORK ZONE
- TEMPORARY CONCRETE BARRIER
- TEMPORARY IMPACT ATTENUATOR
- TEMPORARY SOIL RETENTION SYSTEM OR BRACED EXCAVATION
- DIRECTION OF TRAFFIC FLOW
- TYPE III BARRICADE
- TYPE II BARRICADE OR DRUMS WITH STEADY BURN MONODIRECTIONAL LIGHT
- DIRECTIONAL INDICATOR BARRICADE WITH STEADY BURN MONODIRECTIONAL LIGHT
- SIGN
- ARROW BOARD
- REMOVAL LIMITS
- TEMPORARY PAVEMENT

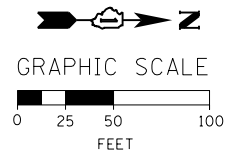

FILE PATH = CA:\Projectbase\DI60W28-sht-Staging\WM-RSW-83.dgn



DI60W28-sht-Staging\WM-RSW-83.dgn
USER NAME = auyeungh
PLOT SCALE = 50.0000' / in.
PLOT DATE = 4/28/2014

DESIGNED - OPS	REVISED -
DRAWN - PHP	REVISED -
CHECKED - KCF	REVISED -
DATE - 04/28/14	REVISED -

STATE OF ILLINOIS
DEPARTMENT OF TRANSPORTATION

SUGGESTED STAGES OF CONSTRUCTION AND TRAFFIC CONTROL PLAN
RAMP SW CLOSURE FOR WATERMAIN CONNECTION

SCALE: 1" = 50' SHEET 3 OF 5 SHEETS STA. 31+50 TO STA. 45+50

F.A.I. RTE. 90/94/290	SECTION 2013-010R	COUNTY COOK	TOTAL SHEETS 747	SHEET NO. 98AC
CONTRACT NO. 60W28				
ILLINOIS FED. AID PROJECT				