

EX WB I-290 (EISENHOWER EXPY)				
POINT	DESCRIPTION	STATION	NORTHING	EASTING
POT		293+90.95	1,898,109.2305	1,165,314.6967
TS	IKE-EWB-00-1B	322+24.26	1,898,195.6075	1,168,146.6931
PIS	IKE-EWB-00-1B	323+57.62	1,898,199.6729	1,168,279.9836
SC	IKE-EWB-00-1	324+24.26	1,898,198.2148	1,168,346.6517
PI	IKE-EWB-00-1	325+38.06	1,898,195.7265	1,168,460.4198
CS	IKE-EWB-00-1	326+51.59	1,898,179.7466	1,168,573.0875
PIS	IKE-EWB-00-1A	327+18.26	1,898,170.3839	1,168,639.1010
ST	IKE-EWB-00-1A	328+51.56	1,898,144.7784	1,168,769.9517
TS	IKE-EWB-00-2B	329+78.32	1,898,120.4341	1,168,894.3575
PIS	IKE-EWB-00-2B	331+11.67	1,898,094.8247	1,169,025.2278
SC	IKE-EWB-00-2	331+78.32	1,898,085.4611	1,169,091.2512
PI	IKE-EWB-00-2	332+11.06	1,898,080.8638	1,169,123.6666
CS	IKE-EWB-00-2	332+43.79	1,898,077.3803	1,169,156.2204
PIS	IKE-EWB-00-2A	333+10.47	1,898,070.2861	1,169,222.5160
ST	IKE-EWB-00-2A	334+43.76	1,898,063.0562	1,169,355.6523
PC	IKE-EWB-00-3	338+11.32	1,898,043.1252	1,169,722.6716
PI	IKE-EWB-00-3	340+66.38	1,898,029.2947	1,169,977.3536
PT	IKE-EWB-00-3	343+21.10	1,898,038.1489	1,170,232.2572
TS	IKE-EWB-00-4B	352+47.24	1,898,070.2993	1,171,157.8387

EX WB I-290 (EISENHOWER EXPY)				
PIS	DESCRIPTION	STATION	NORTHING	EASTING
SC	IKE-EWB-00-4	353+47.25	1,898,073.7709	1,171,257.7841
PI	IKE-EWB-00-4	354+73.38	1,898,074.0231	1,171,383.9319
CS	IKE-EWB-00-4	355+49.47	1,898,069.1215	1,171,459.9169
PIS	IKE-EWB-00-4A	355+99.47	1,898,065.9031	1,171,509.8083
ST	IKE-EWB-00-4A	356+99.44	1,898,056.2063	1,171,609.3226
TS	IKE-EWB-00-5B	359+16.74	1,898,035.1324	1,171,825.5961
PIS	IKE-EWB-00-5B	360+16.74	1,898,025.4337	1,171,925.1303
SC	IKE-EWB-00-5	360+66.74	1,898,022.2149	1,171,975.0317
PI	IKE-EWB-00-5	361+31.77	1,898,018.0288	1,172,039.9323
CS	IKE-EWB-00-5	361+96.78	1,898,017.5295	1,172,104.9659
PIS	IKE-EWB-00-5A	362+46.77	1,898,017.1456	1,172,154.9595
ST	IKE-EWB-00-5A	363+46.75	1,898,019.6488	1,172,254.9138
POT		368+89.26	1,898,033.2310	1,172,797.2593

EX RAMP EN				
POINT	DESCRIPTION	STATION	NORTHING	EASTING
POT		12+93.08	1,897,848.1878	1,170,893.4859
PC	CIR-EEN-00-1	15+91.71	1,897,857.1288	1,171,191.9870
PI	CIR-EEN-00-1	17+04.03	1,897,860.4915	1,171,304.2530
PT	CIR-EEN-00-1	18+02.83	1,897,778.7914	1,171,381.3247
PC	CIR-EEN-00-2	19+20.70	1,897,693.0531	1,171,462.2057
PI	CIR-EEN-00-2	26+59.42	1,897,155.6972	1,171,969.1196
PCC	CIR-EEN-00-2/CIR-EEN-00-3	25+97.46	1,897,894.0512	1,171,945.7405
PI	CIR-EEN-00-3	27+12.77	1,898,009.3040	1,171,942.0911
PT	CIR-EEN-00-3	28+19.03	1,898,096.3533	1,171,866.4674
PC	CIR-EEN-00-4	30+42.56	1,898,265.6061	1,171,720.4502
PI	CIR-EEN-00-4	31+37.75	1,898,337.2909	1,171,657.8157
PT	CIR-EEN-00-4	32+28.69	1,898,430.5657	1,171,638.8002
POT		33+64.77	1,898,563.9073	1,171,611.6164

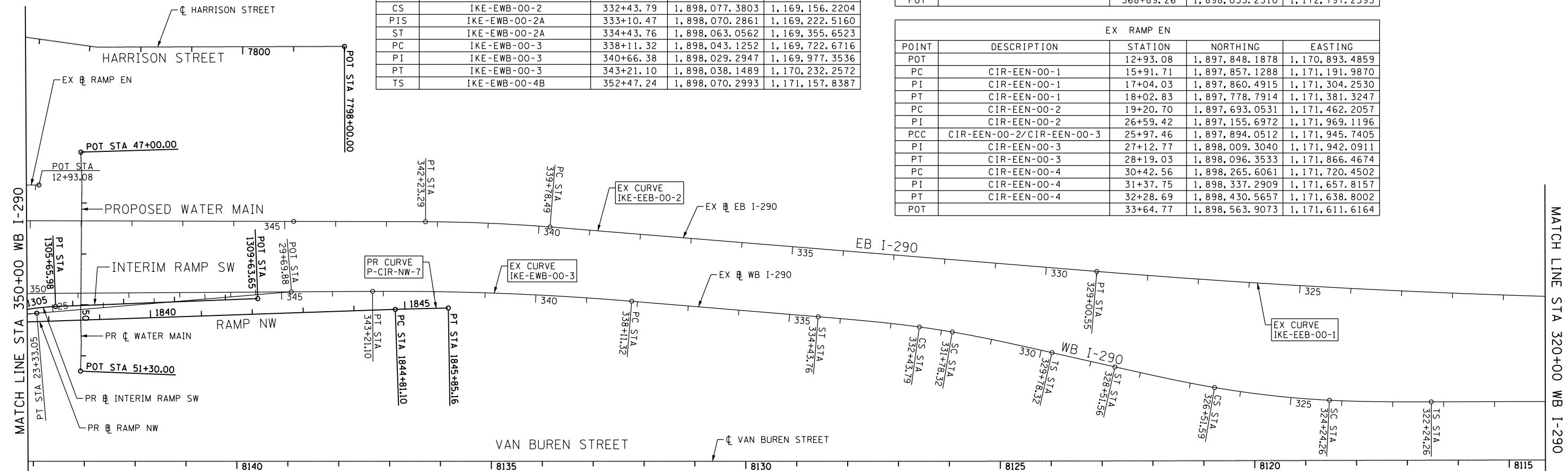

EX EB I-290 (EISENHOWER EXPY)				
POINT	DESCRIPTION	STATION	NORTHING	EASTING
POT		293+88.84	1,897,910.7311	1,165,300.7513
PC	IKE-EEB-00-1	314+72.13	1,897,974.3410	1,167,383.0682
PI	IKE-EEB-00-1	321+86.75	1,897,996.1608	1,168,097.3549
PT	IKE-EEB-00-1	329+00.55	1,897,958.6150	1,168,810.9878
PC	IKE-EEB-00-2	339+78.49	1,897,901.9806	1,169,887.4363
PI	IKE-EEB-00-2	341+00.95	1,897,895.5464	1,170,009.7311
PT	IKE-EEB-00-2	342+23.29	1,897,898.7017	1,170,132.1545
POT		344+82.35	1,897,905.3762	1,170,391.1241
PC	IKE-EEB-00-3	353+59.49	1,897,927.9756	1,171,267.9805
PI	IKE-EEB-00-3	354+82.42	1,897,931.1429	1,171,390.8707
PT	IKE-EEB-00-3	356+05.32	1,897,939.5781	1,171,513.5119
PC	IKE-EEB-00-4	356+51.86	1,897,942.7715	1,171,559.9401
PI	IKE-EEB-00-4	357+76.88	1,897,951.3501	1,171,684.6669
PT	IKE-EEB-00-4	359+01.86	1,897,954.4801	1,171,809.6491
POT		368+91.13	1,897,979.2472	1,172,798.6113

EX RAMP NW				
POINT	DESCRIPTION	STATION	NORTHING	EASTING
POT		7+96.20	1,897,507.4719	1,171,763.3763
PC	CIR-ENW-00-1	9+85.04	1,897,693.9515	1,171,733.5850
PI	CIR-ENW-00-1	10+35.96	1,897,744.2285	1,171,725.5529
PT	CIR-ENW-00-1	10+85.49	1,897,793.6250	1,171,737.8925
PC	CIR-ENW-00-2	12+39.06	1,897,942.6154	1,171,775.1112
PI	CIR-ENW-00-2	23+51.29	1,899,021.6848	1,172,044.6691
PT	CIR-ENW-00-2	20+73.26	1,898,256.1989	1,171,237.7716
PC	CIR-ENW-00-3	21+70.03	1,898,189.5975	1,171,167.5671
PI	CIR-ENW-00-3	22+66.58	1,898,123.1471	1,171,097.5218
PT	CIR-ENW-00-3	23+56.35	1,898,112.3438	1,171,001.5775
POT		29+69.88	1,898,043.6940	1,170,391.8959

PR RAMP SW INTERIM				
POINT	DESCRIPTION	STATION	NORTHING	EASTING
PC	P-CIR-SWI-1	1300+00.00	1,898,395.2268	1,171,305.9382
PI	P-CIR-SWI-1	1300+54.30	1,898,350.6360	1,171,274.9510
PCC	P-CIR-SWI-1/P-CIR-SWI-2	1301+08.39	1,898,311.2362	1,171,237.5851
PI	P-CIR-SWI-2	1301+87.08	1,898,254.1385	1,171,183.4348
PCC	P-CIR-SWI-2/P-CIR-SWI-3	1302+65.70	1,898,201.2123	1,171,125.2006
PI	P-CIR-SWI-3	1304+21.73	1,898,096.2736	1,171,009.7374
PT	P-CIR-SWI-3	1305+65.98	1,898,085.7629	1,170,854.0667
POT		1309+63.65	1,898,058.9737	1,170,457.2996

PR WATER MAIN				
POINT	DESCRIPTION	STATION	NORTHING	EASTING
POT	PWM001	47+00.00	1,897,781.3101	1,170,813.2206
PI	PWM002	47+18.58	1,897,799.8600	1,170,812.1300
PI	PWM003	47+36.60	1,897,817.8242	1,170,810.7551
PI	PWM004	47+42.10	1,897,823.3082	1,170,810.3354
PI	PWM005	47+53.45	1,897,834.6198	1,170,809.4354
PI	PWM006	50+26.06	1,898,107.1798	1,170,804.0954
PI	PWM007	50+75.23	1,898,156.2886	1,170,801.5138
PI	PWM008	51+15.45	1,898,196.5030	1,170,801.4058
POT	PWM009	51+30.00	1,898,211.0511	1,170,801.5644

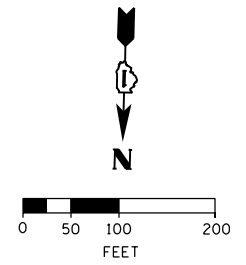

FILE PATH = C:\Users\pmsarno\Desktop\Drawings\28-Sht-ATB-06.dgn



D16028-Sht-ATB-06.dgn	DESIGNED - KAM	REVISED -
USER NAME = pmsarno	DRAWN - NSA/OPS	REVISED -
PLOT SCALE = 200.0000' / in.	CHECKED - KCF	REVISED -
PLOT DATE = 4/26/2014	DATE - 04/28/14	REVISED -

**STATE OF ILLINOIS  
DEPARTMENT OF TRANSPORTATION**

**ALIGNMENT, TIES AND BENCHMARKS**

SCALE: 1" = 100' SHEET 6 OF 12 SHEETS STA. TO STA.

F.A.I. RTE.	SECTION	COUNTY	TOTAL SHEETS	SHEET NO.
90/94/290	2013-010R	COOK	747	52
CONTRACT NO. 60W28			ILLINOIS FED. AID PROJECT	