

06-17-2022 LETTING ITEM 196

FOR INDEX OF SHEETS, HIGHWAY STANDARDS, AND PR LEGEND SEE SHEET NO. 2

POLICY STATEMENT: PLANS DESIGNED IN ACCORDANCE WITH THE BUREAU OF LOCAL ROADS AND STREETS MANUAL

DESIGN DESIGNATION MAJOR COLLECTOR
DESIGN SPEED: 45 MPH
POSTED SPEED: 40 MPH
ADT (2019): 2,150 VPD 5% TRUCKS

PROJECT LOCATED IN THE UNITED CITY OF YORKVILLE

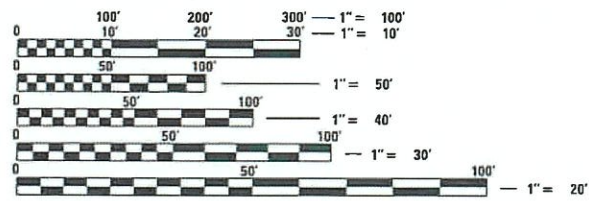

FULL SIZE PLANS HAVE BEEN PREPARED USING STANDARD ENGINEERING SCALES. REDUCED SIZED PLANS WILL NOT CONFORM TO STANDARD SCALES. IN MAKING MEASUREMENTS ON REDUCED PLANS, THE ABOVE SCALES MAY BE USED.



CONTRACT NO. 87786

STATE OF ILLINOIS DEPARTMENT OF TRANSPORTATION DIVISION OF HIGHWAYS

PLANS FOR PROPOSED FEDERAL-AID HIGHWAY

STU FUNDING
FAU 1555 (BRISTOL RIDGE ROAD)
US 34 (E. VETERANS PARKWAY) TO KENNEDY ROAD
SECTION 21-00052-00-RS
PROJECT NUMBER: AQ5Y (681)
RESURFACING
UNITED CITY OF YORKVILLE
KENDALL COUNTY, ILLINOIS
JOB NO. C-93-002-23

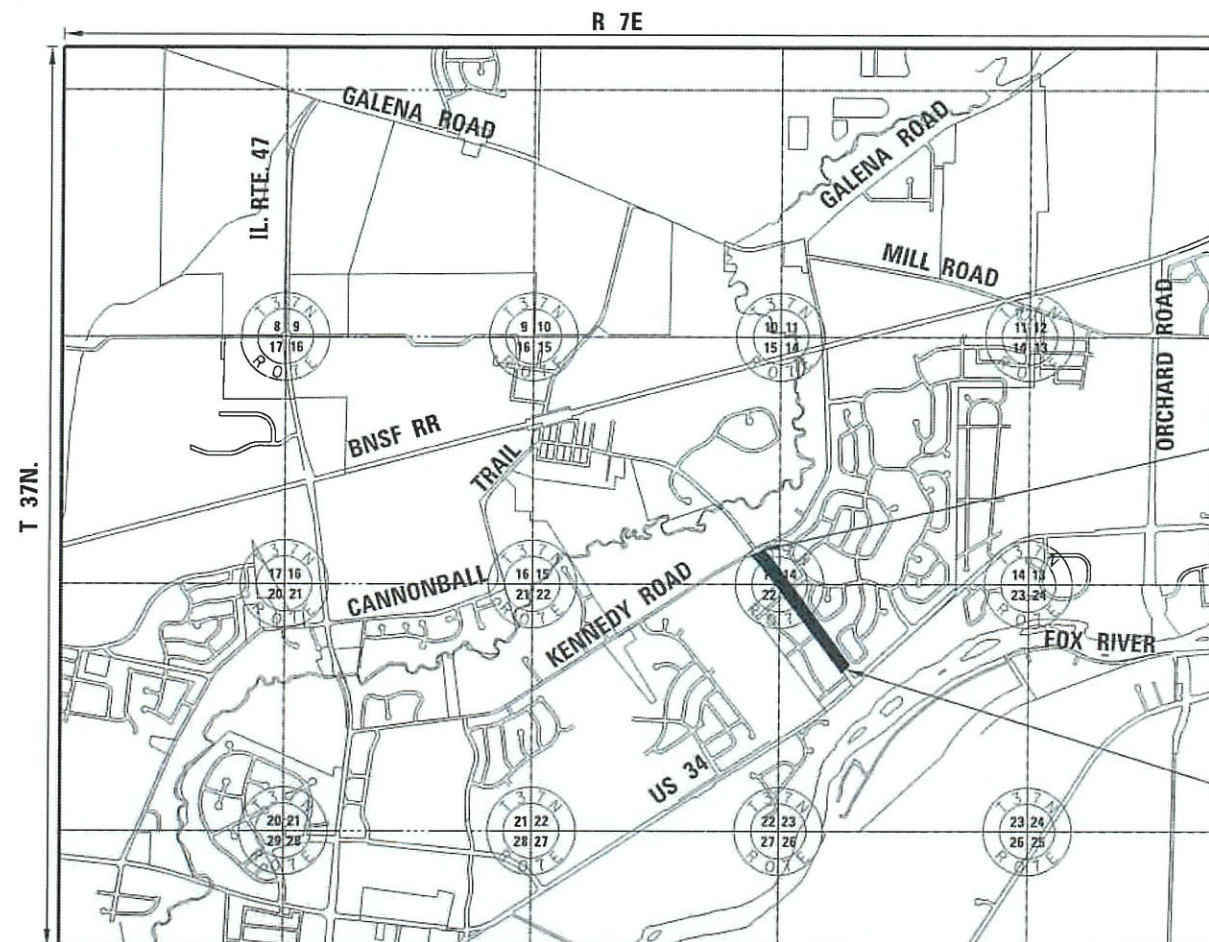

LOCATION MAP (SCALE 1" = 2000')
NW 1/4 SEC. 23, SE 1/4 SEC. 15, T37N, R 7E, 3RD P.M.
BRISTOL TOWNSHIP
TOTAL GROSS AND NET LENGTH OF PROJECT = 3,013 FEET (0.571 MILES)

Table with columns: F.A.U. RTE., SECTION, COUNTY, TOTAL SHEETS, SHEET NO. Values: 1555, 21-00052-00-RS, KENDALL, 13, 1

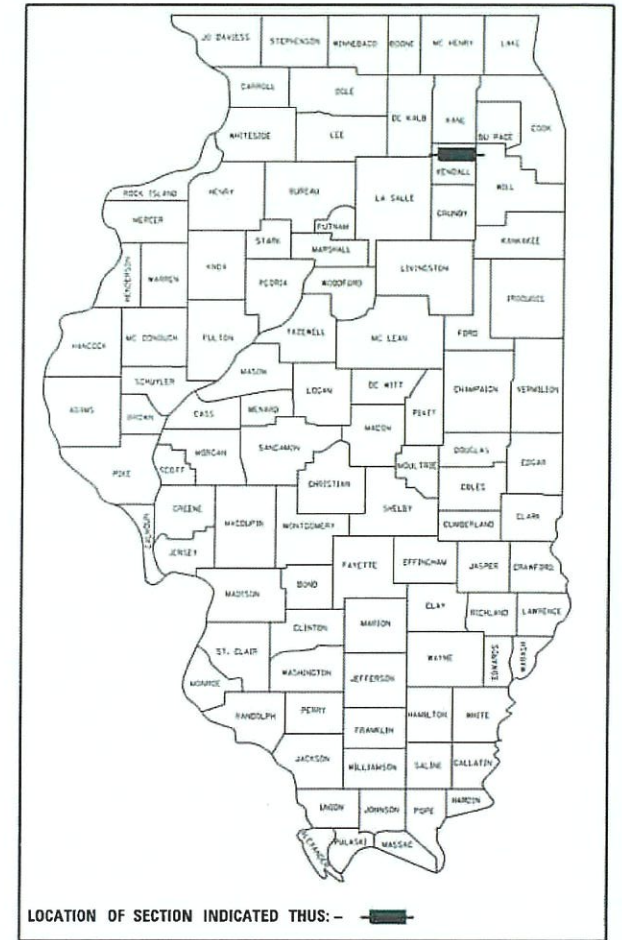

STATE OF ILLINOIS DEPARTMENT OF TRANSPORTATION DIVISION OF HIGHWAYS
APPROVED: [Signature] APRIL 4, 2022
UNITED CITY OF YORKVILLE, PUBLIC WORKS DIRECTOR
PASSED: [Signature] APRIL 14, 2022
DISTRICT 3 ENGINEER OF LOCAL ROADS & STREETS
RELEASING FOR BID BASED ON LIMITED REVIEW: [Signature] APRIL 14, 2022
DEPUTY DIRECTOR OF HIGHWAYS, REGION 2 ENGINEER

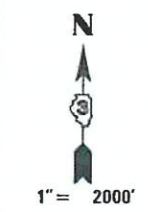

PROJECT ENDS STA. 44+58 BRISTOL RIDGE ROAD

PROJECT BEGINS STA. 14+45 BRISTOL RIDGE ROAD

Professional Engineer seal for Christopher J. Ott, License No. 062-069699, State of Illinois. Includes date 4/14/2022, license expiration November 30, 2023, and sheet count 1-13.

Engineering Enterprises, Inc. CONSULTING ENGINEERS
52 Wheeler Road
Sugar Grove, Illinois 60554
Phone: (630) 466-6700

PRINTED BY THE AUTHORITY OF THE STATE OF ILLINOIS

GENERAL NOTES

SPECIFICATIONS, STANDARDS, AND SPECIAL PROVISIONS

ALL CONSTRUCTION SHALL BE DONE IN ACCORDANCE WITH THE "STANDARD SPECIFICATIONS FOR ROAD AND BRIDGE CONSTRUCTION," ADOPTED JANUARY 1, 2022 (HEREINAFTER REFERRED TO AS THE STANDARD SPECIFICATIONS), THE "SUPPLEMENTAL SPECIFICATIONS AND RECURRING SPECIAL PROVISIONS," ADOPTED JANUARY 1, 2022, THE LATEST EDITION OF THE "ILLINOIS MANUAL ON UNIFORM TRAFFIC CONTROL DEVICES FOR STREETS AND HIGHWAYS", THE "STANDARD SPECIFICATIONS FOR WATER & SEWER MAIN CONSTRUCTION IN ILLINOIS", SEVENTH EDITION, THE CODES AND ORDINANCES OF THE UNITED CITY OF YORKVILLE, ILLINOIS, THE DETAILS IN THE PLANS AND THE SPECIAL PROVISIONS INCLUDED IN THE CONTRACT DOCUMENTS.

NO SUBSTITUTIONS OR VARIANCES WILL BE PERMITTED TO ANY STANDARD NOTES OR ORDINANCES UNLESS APPROVED OTHERWISE IN WRITING PRIOR TO COMMENCING CONSTRUCTION ACTIVITY.

ALL TRAFFIC CONTROL AND OTHER ADVISORY SIGNS NEEDED FOR CONSTRUCTION ARE TO BE FURNISHED BY THE CONTRACTOR IN ACCORDANCE WITH ARTICLE 107.14 OF THE STANDARD SPECIFICATIONS.

THE CONTRACTOR SHALL AT ALL TIMES PROVIDE PROTECTION FOR TRAFFIC AS CALLED FOR IN THE APPLICATION OF TRAFFIC CONTROL DEVICES, THE STANDARD SPECIFICATIONS, THE SPECIAL PROVISIONS AND THE PLANS

UTILITIES

THE CONTRACTOR SHALL COOPERATE WITH THE OWNER IF ANY UTILITY IMPROVEMENTS ARE REQUIRED WITHIN THE DURATION OF THE CONTRACT.

THE LOCATION OF EXISTING DRAINAGE STRUCTURES, STORM SEWERS, WATER MAINS, SANITARY SEWERS, FIELD TILES AND ANY OTHER PUBLIC OR PRIVATE UTILITIES AS SHOWN ON THE PLANS IS APPROXIMATE AND NOT NECESSARY COMPLETE. THEIR EXACT LOCATION IS TO BE DETERMINED IN THE FIELD BY THE CONTRACTOR. THIS WORK SHALL BE CONSIDERED INCLUDED IN THE COST OF THE CONTRACT.

THE CONTRACTOR SHALL BE RESPONSIBLE FOR CONTACTING THE OWNERS OF ALL UTILITIES PRIOR TO CONSTRUCTION TO DETERMINE THE LOCATION OF ALL EXISTING AND PROPOSED UTILITY EQUIPMENT. THE CONTRACTOR SHALL COOPERATE WITH ALL UTILITY OWNERS AS PROVIDED FOR IN THE STANDARD SPECIFICATIONS IF UTILITY RELOCATION, ADJUSTMENT, OR PROTECTION IS NECESSARY.

IF EXISTING UTILITY LINES OF ANY NATURE ARE ENCOUNTERED WHICH CONFLICT IN LOCATION WITH NEW CONSTRUCTION, THE CONTRACTOR SHALL NOTIFY THE ENGINEER SO THAT THE CONFLICT MAY BE RESOLVED.

UNDER NO CIRCUMSTANCES SHALL THE CONTRACTOR OPERATE ANY VALVES OR HYDRANTS.

STAKING

THE CONTRACTOR SHALL PROTECT AND CAREFULLY PRESERVE ALL SECTION OR SUBSECTION MONUMENTS, PROPERTY CORNERS, AND REFERENCE MARKERS UNTIL THE OWNER, THE OWNER'S AGENT, OR AN AUTHORIZED SURVEYOR HAS WITNESSED OR OTHERWISE REFERENCED THEIR LOCATIONS.

ALL OFFSET LOCATIONS GIVEN ON THE DETAILED PLANS ARE FROM THE CENTERLINE AS SHOWN ON THE PLANS.

MISCELLANEOUS

FOR STABILIZATION, ALL TYPE III BARRICADES WILL REQUIRE A MINIMUM OF FOUR SAND BAGS PER BARRICADE.

THE THICKNESS OF ASPHALT MIXTURES SHOWN IN THE PLANS ARE NOMINAL. DEVIATIONS MAY OCCUR DUE TO IRREGULARITIES IN THE SURFACES OR BASES ON WHICH THE ASPHALT MIXTURES ARE TO BE PLACED.

IT IS THE CONTRACTOR'S RESPONSIBILITY TO ASCERTAIN EXISTING FIELD CONDITIONS BEFORE BIDDING ON THIS CONTRACT.

WHERE NEW WORK MEETS EXISTING FEATURES TO REMAIN, THE CONTRACTOR SHALL FIELD CHECK ALL DIMENSIONS AND ELEVATIONS BEFORE PROCEEDING WITH CONSTRUCTION. IMMEDIATELY NOTIFY THE ENGINEER OF ANY DISCREPANCIES.

THE CONTRACTOR SHALL MAINTAIN EXISTING SIDE STREET AND DRIVEWAY ACCESS TO EACH ABUTTING PROPERTY AT ALL TIMES DURING CONSTRUCTION OF THE PROJECT UNLESS OTHERWISE NOTED ON THE PLANS OR DIRECTED BY THE ENGINEER.

THE CONTRACTOR WILL BE REQUIRED TO COMPLY WITH ALL STATE REGULATIONS REGARDING AIR, WATER AND NOISE POLLUTION. THE CONTRACTOR IS PROHIBITED FROM BURNING ANY MATERIAL WITHIN OR ADJACENT TO THE IMPROVEMENT.

THE ENGINEER IS NOT RESPONSIBLE FOR THE CONSTRUCTION MEANS, METHODS, TECHNIQUES, SEQUENCES OR PROCEDURES, TIME OF PERFORMANCE, PROGRAMS OR FOR ANY SAFETY PRECAUTIONS USED BY THE CONTRACTOR. THE CONTRACTOR IS SOLELY RESPONSIBLE FOR EXECUTION OF THEIR WORK IN ACCORDANCE WITH THE CONTRACT DOCUMENTS AND SPECIFICATIONS.

PATCHING AND COMBINATION CONCRETE CURB AND GUTTER REMOVAL AND REPLACEMENT LOCATIONS SHALL BE VERIFIED BY THE ENGINEER AND MARKED OUT BY THE ENGINEER IN THE FIELD.

BRISTOL RIDGE ROAD SHALL BE OPEN TO TRAFFIC AT ALL TIMES. WHEN IT IS NECESSARY TO CLOSE ONE LANE OF TRAFFIC DUE TO CONSTRUCTION, THE CONTRACTOR SHALL MAINTAIN TWO-WAY TRAFFIC DURING CONSTRUCTION HOURS WITH THE USE OF TRAFFIC CONTROL DEVICES, SIGNS AND FLAGGERS AS APPLICABLE IN THE TRAFFIC CONTROL STANDARDS.

THE CONTRACTOR SHALL DISPOSE OF AND REMOVE FROM THE SITE EACH DAY ALL CURB AND GUTTER, PAVEMENT AND ALL OTHER EXCAVATED MATERIAL NOT FOR SALVAGE. THE COST FOR HAULING AND TRUCKING TO DISPOSAL LOCATIONS WILL BE INCLUDED IN THE COST OF THE ITEM BEING REMOVED.

ANY AREAS ON DRIVEWAYS OUTSIDE THE LIMITS OF MAINLINE MILLING SHALL BE MILLED UTILIZING THE HOT-MIX ASPHALT SURFACE REMOVAL BUTT-JOINT ITEM. ANY AREAS ON DRIVEWAYS OUTSIDE THE LIMITS OF MAINLINE PAVING SHALL BE RESURFACED UTILIZING THE INCIDENTAL HOT-MIX ASPHALT SURFACING PAY ITEM. ANY DRIVEWAYS THAT ARE WITHIN THE LIMITS OF THE SCREED EXTENSIONS DURING MAINLINE PAVING SHALL BE PAID FOR AS A PART OF THE BINDER AND SURFACE COURSE PAY ITEMS. BITUMINOUS MATERIALS (TACK COAT) SHALL BE INSTALLED ON DRIVEWAYS AND PAID SEPARATELY AS PAY ITEM 40800029 ACCORDING TO THE STANDARD SPECIFICATIONS.

INDEX OF SHEETS





SHEET NO.	SHEET DESCRIPTION
1.	COVER SHEET
2.	INDEX OF SHEETS, GENERAL NOTES, HIGHWAY STANDARDS, AND LEGEND
3.-5.	SUMMARY OF QUANTITIES
6.-7.	TYPICAL SECTIONS
8.	SCHEDULE OF QUANTITIES
9.-12.	PLAN SHEETS
13.	SPECIAL DETAILS

IDOT HIGHWAY STANDARDS

000001-08	STANDARD SYMBOLS, ABBREVIATIONS AND PATTERNS
424001-11	PERPENDICULAR CURB RAMPS FOR SIDEWALKS
424006-05	DIAGONAL CURB RAMPS FOR SIDEWALKS
424011-04	CORNER PARALLEL CURB RAMPS FOR SIDEWALKS
424016-05	MID-BLOCK CURB RAMPS FOR SIDEWALKS
424021-06	DEPRESSED CORNER FOR SIDEWALKS
442201-03	CLASS C AND D PATCHES
606001-08	CONCRETE CURB TYPE B AND COMBINATION CONCRETE CURB AND GUTTER
701006-05	OFF-ROAD OPERATIONS, 2L, 2W, 15' (4.5 m) TO 24" (600 mm) FROM PAVEMENT EDGE
701011-04	OFF-ROAD MOVING OPERATIONS, 2L, 2W, DAY ONLY
701301-04	LANE CLOSURE, 2L, 2W, SHORT TIME OPERATIONS
701311-03	LANE CLOSURE, 2L, 2W, MOVING OPERATIONS- DAY ONLY
701501-06	URBAN LANE CLOSURE, 2L, 2W, UNDIVIDED
701502-09	URBAN LANE CLOSURE, 2L, 2W UNDIVIDED
701701-10	URBAN LANE CLOSURE, MULTI LANE INTERSECTION
701801-06	SIDEWALK, CORNER OR CROSSWALK CLOSURE
701901-08	TRAFFIC CONTROL DEVICES
720001-01	SIGN PANEL MOUNTING DETAILS
720006-04	SIGN PANEL ERECTION DETAILS
728001-01	TELESCOPING STEEL SIGN SUPPORT
780001-05	TYPICAL PAVEMENT MARKINGS
781001-04	TYPICAL APPLICATIONS RAISED REFLECTIVE PAVEMENT MARKERS

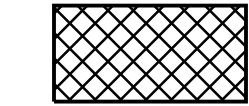
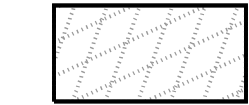
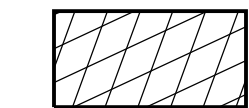
SUPPLEMENTAL LEGEND

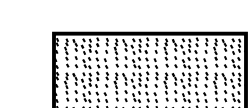
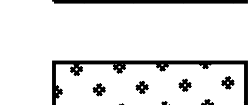
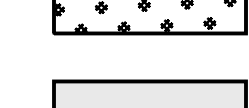
SEE IDOT HIGHWAY STANDARDS FOR ADDITIONAL INFORMATION

	EXISTING GRAVEL
	PATCHING
	HOT-MIX ASPHALT SURFACE REMOVAL, VARIABLE DEPTH
	HOT-MIX ASPHALT SURFACE REMOVAL, 3"
	PCC SIDEWALK REMOVAL AND REPLACEMENT
	HOT-MIX ASPHALT SURFACE REMOVAL - BUTT JOINT
	HOT-MIX ASPHALT SURFACE REMOVAL - BUTT JOINT AND INCIDENTAL HMA SURFACING
	BIKE PATH REMOVAL AND INCIDENTAL HOT-MIX ASPHALT SURFACING
	EXISTING CURB OR CURB & GUTTER
	PROPOSED CURB OR CURB & GUTTER

USER NAME = jschmidt PLOT SCALE = \$SCALES
 PLOT DATE = 4/12/2022 9:33:08 AM
 MODEL = \$MODELNAME\$
 FILE NAME = \$3525\$Pkg\YD -Yorkville\2020\YD2041\1Dgm\Dgn -Final\YD2041-Cvr.dgn

 **Engineering Enterprises, Inc.**
 CONSULTING ENGINEERS
 52 Wheeler Road
 Sugar Grove, Illinois 60554
 630.466.6700 / www.eeiweb.com

DESIGNED -	REVISED -
DRAWN -	REVISED -
CHECKED -	REVISED -
DATE -	REVISED -

UNITED CITY OF YORKVILLE
 KENDALL COUNTY, ILLINOIS

INDEX OF SHEETS, GENERAL NOTES, HIGHWAY STANDARDS, AND LEGEND

SCALE: N.T.S. SHEET 1 OF 1 SHEETS STA. TO STA.

F.A.U. RTE.	SECTION	COUNTY	TOTAL SHEETS	SHEET NO.
1555	21-00052-00-RS	KENDALL	13	2
				CONTRACT NO. 87786
FED. ROAD DIST. NO. 3		ILLINOIS	FED. AID PROJECT	

Pack: H:\5056\$Pkg\YD -Yorkville\2020\YD2041\1Dgm\0Dgn -Final\Eng\YD2041-Cvr.dgn

USER NAME = jkshirer
 PLOT SCALE = 1:SCALE
 PLOT DATE = 4/4/2022 7:43:52 AM
 MODEL = KNDL01A100
 FILE NAME = H:\SDS\Proj\YK_Yorkville\2020\Y02041\Drawn\Drawn\Final\Envt\Y02041-Cor.dwg

CODE NUMBER	ITEM	UNIT	TOTAL QUANTITY	
			75% FEDERAL	25% LOCAL
				0005
21101615	TOPSOIL FURNISH AND PLACE, 4"	SQ YD	100	
25200110	SODDING, SALT TOLERANT	SQ YD	100	
25200200	SUPPLEMENTAL WATERING	UNIT	10	
40600290	BITUMINOUS MATERIALS (TACK COAT)	POUND	9,610	
40600400	MIXTURE FOR CRACKS, JOINTS, AND FLANGEWAYS	TON	10	
40600982	HOT-MIX ASPHALT SURFACE REMOVAL - BUTT JOINT	SQ YD	457	
40602978	HOT-MIX ASPHALT BINDER COURSE, IL-9.5, N50	TON	1,205	
40604060	HOT-MIX ASPHALT SURFACE COURSE, IL-9.5, MIX "D", N50	TON	1,205	
40800029	BITUMINOUS MATERIAL (TACK COAT)	POUND	158	
40800050	INCIDENTAL HOT-MIX ASPHALT SURFACING	TON	47	
42400200	PORTLAND CEMENT CONCRETE SIDEWALK 5 INCH	SQ FT	555	
42400800	DETECTABLE WARNINGS	SQ FT	32	
44000161	HOT-MIX ASPHALT SURFACE REMOVAL, 3"	SQ YD	2,005	
44000500	COMBINATION CURB AND GUTTER REMOVAL	FOOT	188	
44000600	SIDEWALK REMOVAL	SQ FT	555	

Δ INDICATES SPECIALTY ITEM
 * SEE SPECIAL PROVISIONS

Engineering Enterprises, Inc.
 CONSULTING ENGINEERS
 52 Wheeler Road
 Sugar Grove, Illinois 60554
 630.466.6700 / www.eeiweb.com

DESIGNED -	REVISED -
DRAWN -	REVISED -
CHECKED -	REVISED -
DATE -	REVISED -

UNITED CITY OF YORKVILLE
 KENDALL COUNTY, ILLINOIS

SUMMARY OF QUANTITIES

SCALE: N.T.S. SHEET 1 OF 3 SHEETS STA. TO STA.

F.A.U. RTE.	SECTION	COUNTY	TOTAL SHEETS	SHEET NO.
1555	21-00052-00-RS	KENDALL	13	3
FED. ROAD DIST. NO. 3 ILLINOIS FED. AID PROJECT			CONTRACT NO. 87786	

P:\2020\Y02041\Drawn\Drawn\Final\Envt\Y02041-Cor.dwg

USER NAME = kschmidr PLOT SCALE = 5/8"=1'-0"
 PLOT DATE = 4/12/2023 8:00:08 AM
 MODEL = S:\MODEL\NAME4
 FILE NAME = K:\SSK\Proj\NO Yorkville\2020\2020110m\Den Final Engr\02041-Cvr.dwg

CODE NUMBER	ITEM	UNIT	TOTAL QUANTITY	
			75% FEDERAL	25% LOCAL
			0005	
44201741	CLASS D PATCHES, TYPE II, 8 INCH	SQ YD	72	
44201745	CLASS D PATCHES, TYPE III, 8 INCH	SQ YD	214	
44201747	CLASS D PATCHES, TYPE IV, 8 INCH	SQ YD	570	
48102100	AGGREGATE WEDGE SHOULDER, TYPE B	TON	235	
60255500	MANHOLES TO BE ADJUSTED	EACH	3	
60257900	MANHOLES TO BE RECONSTRUCTED	EACH	2	
60603800	COMBINATION CURB AND GUTTER, TYPE B-6.12	FOOT	188	
67100100	MOBILIZATION	L SUM	1	
70102620	TRAFFIC CONTROL AND PROTECTION, STANDARD 701501	L SUM	1	
70102622	TRAFFIC CONTROL AND PROTECTION, STANDARD 701502	L SUM	1	
70102635	TRAFFIC CONTROL AND PROTECTION, STANDARD 701701	L SUM	1	
70102640	TRAFFIC CONTROL AND PROTECTION, STANDARD 701801	L SUM	1	
70107025	CHANGEABLE MESSAGE SIGN	CAL DA	50	
70300100	SHORT TERM PAVEMENT MARKING	FOOT	1,600	

Δ INDICATES SPECIALTY ITEM
 * SEE SPECIAL PROVISIONS

Engineering Enterprises, Inc.
 CONSULTING ENGINEERS
 52 Wheeler Road
 Sugar Grove, Illinois 60554
 630.466.6700 / www.eeiweb.com

DESIGNED -	REVISED -
DRAWN -	REVISED -
CHECKED -	REVISED -
DATE -	REVISED -

UNITED CITY OF YORKVILLE
 KENDALL COUNTY, ILLINOIS

SUMMARY OF QUANTITIES

SCALE: N.T.S. SHEET 2 OF 3 SHEETS STA. TO STA.

F.A.U. RTE.	SECTION	COUNTY	TOTAL SHEETS	SHEET NO.
1555	21-00052-00-RS	KENDALL	13	4
FED. ROAD DIST. NO. 3 ILLINOIS FED. AID PROJECT			CONTRACT NO. 87786	

Path: H:\SSK\Proj\NO Yorkville\2020\2020110m\Den Final Engr\02041-Cvr.dwg

USER NAME = h:\admin\... PLOT SCALE = \$Scales
 PLOT DATE = 4/2/2022 8:13:46 AM
 MODEL = \$MODELNAME\$
 FILE NAME = H:\SDSK\Proj\VO Yorkville\2020\VO2041\Drawn Final Eng\VO2041.dwg

	CODE NUMBER	ITEM	UNIT	TOTAL QUANTITY	
				75% FEDERAL	25% LOCAL
					0005
	70300150	SHORT TERM PAVEMENT MARKING REMOVAL	SQ FT	400	
	70300221	TEMPORARY PAVEMENT MARKING - LINE 4" - PAINT	FOOT	1,600	
Δ	72000100	SIGN PANEL - TYPE 1	SQ FT	83	
Δ	72400100	REMOVE SIGN PANEL ASSEMBLY - TYPE A	EACH	2	
Δ	72400310	REMOVE SIGN PANEL - TYPE 1	SQ FT	65	
Δ	72800100	TELESCOPING STEEL SIGN SUPPORT	FOOT	32	
Δ	78000100	THERMOPLASTIC PAVEMENT MARKING - LETTERS AND SYMBOLS	SQ FT	296	
Δ	78000200	THERMOPLASTIC PAVEMENT MARKING - LINE 4"	FOOT	11,939	
Δ	78000400	THERMOPLASTIC PAVEMENT MARKING - LINE 6"	FOOT	891	
Δ	78000600	THERMOPLASTIC PAVEMENT MARKING - LINE 12"	FOOT	105	
Δ	78000650	THERMOPLASTIC PAVEMENT MARKING - LINE 24"	FOOT	59	
	78300200	RAISED REFLECTIVE PAVEMENT MARKER REMOVAL	EACH	135	
*	X0327036	BIKE PATH REMOVAL	SQ YD	45	
*	X4401198	HOT-MIX ASPHALT SURFACE REMOVAL, VARIABLE DEPTH	SQ YD	12,235	
Δ *	X7810300	RECESSED REFLECTIVE PAVEMENT MARKER	EACH	135	

Δ INDICATES SPECIALTY ITEM
 * SEE SPECIAL PROVISIONS

Engineering Enterprises, Inc.
 CONSULTING ENGINEERS
 52 Wheeler Road
 Sugar Grove, Illinois 60554
 630.466.6700 / www.eeiweb.com

DESIGNED -	REVISED -
DRAWN -	REVISED -
CHECKED -	REVISED -
DATE -	REVISED -

UNITED CITY OF YORKVILLE
 KENDALL COUNTY, ILLINOIS

SUMMARY OF QUANTITIES			
SCALE: N.T.S.	SHEET 3	OF 3 SHEETS	STA. TO STA.

F.A.U. RTE.	SECTION	COUNTY	TOTAL SHEETS	SHEET NO.
1555	21-00052-00-R5	KENDALL	13	5
FED. ROAD DIST. NO. 3 ILLINOIS FED. AID PROJECT			CONTRACT NO. 87786	

P:\h\MS\05\Proj\VO Yorkville\2020\VO2041\Drawn Final Eng\VO2041.dwg

EXISTING LEGEND

- (A) EXISTING HOT-MIX ASPHALT PAVEMENT (10.5"-11")
- (B) EXISTING AGGREGATE BASE COURSE (11"-15")
- (C) EXISTING FABRIC INTERLAYER
- (D) EXISTING B-6.12 COMBINATION CONCRETE CURB & GUTTER
- (E) EXISTING PORTLAND CEMENT CONCRETE SIDEWALK, 5"
- (F) EXISTING HOT-MIX ASPHALT BIKE PATH, 2"
- (G) EXISTING AGGREGATE SHOULDER
- (H) HOT-MIX ASPHALT SURFACE REMOVAL, 3"
- (I) HOT-MIX ASPHALT SURFACE REMOVAL, VARIABLE DEPTH

PROPOSED LEGEND

- (1) HOT-MIX ASPHALT SURFACE COURSE, IL-9.5, MIX "D", N50, 1.5"
- (2) HOT-MIX ASPHALT BINDER COURSE, IL-9.5, N50, 1.5"
- (3) BITUMINOUS MATERIALS (TACK COAT)
- (4) CLASS D PATCHES, 8" (LOCATIONS TO BE DETERMINED BY ENGINEER)
- (5) COMBINATION CONCRETE CURB AND GUTTER REMOVAL AND REPLACEMENT (AT VARIOUS LOCATIONS)
- (6) SIDEWALK REMOVAL AND PORTLAND CEMENT CONCRETE SIDEWALK, 5" (AT VARIOUS LOCATIONS)
- (7) BIKE PATH REMOVAL AND HOT-MIX ASPHALT BIKE PATH, 2" (AT VARIOUS LOCATIONS)
- (8) AGGREGATE WEDGE SHOULDER, TYPE B
- (9) TOPSOIL AND SODDING, SALT TOLERANT

NOTE:

THE PATCHING QUANTITIES HAVE BEEN ESTIMATED BASED UPON FIELD OBSERVATIONS DURING DESIGN. ACTUAL QUANTITIES TO BE DETERMINED DURING CONSTRUCTION BY THE ENGINEER

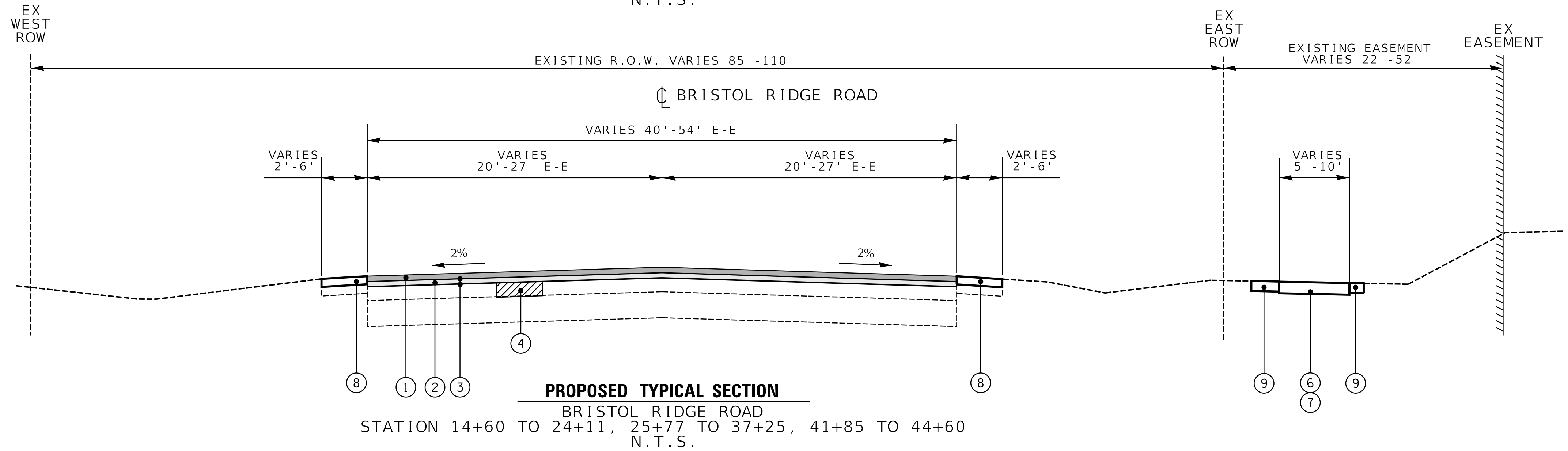
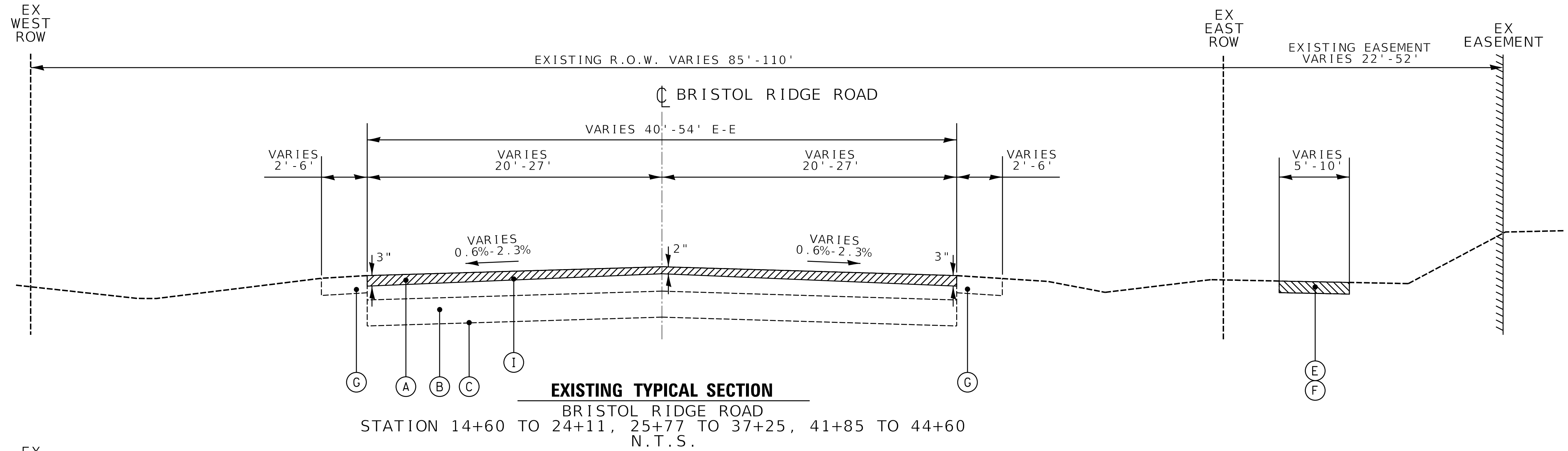

HMA MIXTURE REQUIREMENT TABLE				
LOCATIONS:	BRISTOL RIDGE ROAD	BRISTOL RIDGE ROAD	CLASS D PATCH	INCIDENTAL HMA SURFACING
MIXTURE USE(S):	HMA BINDER	HMA SURFACE	HMA BINDER	HMA SURFACE
BINDER GRADE (PG):	PG 64-22	PG 64-22	PG 64-22	PG 64-22
DESIGN AIR VOIDS:	4.0% @ N50	4.0% @ N50	4.0% @ N50	4.0% @ N50
MIXTURE COMPOSITION: (MIXTURE GRADATION)	IL-9.5	IL-9.5	IL-19.0	IL-9.5
FRICTION AGGREGATE:		MIXTURE D		MIXTURE D
MIXTURE WEIGHT:	112.0 LB/SY/IN	112.0 LB/SY/IN	112.0 LB/SY/IN	112.0 LB/SY/IN
QUALITY MANAGEMENT PROGRAM:	QCQA	QCQA	QCQA	QCQA
SUBLOT SIZE:	NA	NA	NA	NA
DENSITY TEST METHOD:	LR1030-2	LR1030-2	SATISFACTION OF ENGINEER	SATISFACTION OF ENGINEER

USER NAME = jschmidt PLOT SCALE = \$S CALES
 PLOT DATE = 4/12/2022 10:37:03 AM
 MODEL = \$MODELNAME\$
 FILE NAME = \$3DS\$PLOT\$YORKVILLE20220411Dgn.Dgn Final_Eng\Y02041_TYP_SEC.dgn

Engineering Enterprises, Inc.
 CONSULTING ENGINEERS
 52 Wheeler Road
 Sugar Grove, Illinois 60554
 630.466.6700 / www.eeiweb.com

DESIGNED -	REVISED -
DRAWN -	REVISED -
CHECKED -	REVISED -
DATE -	REVISED -

**UNITED CITY OF YORKVILLE
KENDALL COUNTY, ILLINOIS**

TYPICAL SECTIONS

SCALE: N.T.S. SHEET 1 OF 2 SHEETS STA. TO STA.

F.A.U. RTE.	SECTION	COUNTY	TOTAL SHEETS	SHEET NO.
1555	21-00052-00-RS	KENDALL	13	6
FED. ROAD DIST. NO. 3 ILLINOIS FED. AID PROJECT			CONTRACT NO. 87786	

Path: H:\\$3DS\$PLOT\$YORKVILLE20220411Dgn.Dgn Final_Eng\Y02041_TYP_SEC.dgn

EXISTING LEGEND

- (A) EXISTING HOT-MIX ASPHALT PAVEMENT (10.5"-11")
- (B) EXISTING AGGREGATE BASE COURSE (11"-15")
- (C) EXISTING FABRIC INTERLAYER
- (D) EXISTING B-6.12 COMBINATION CONCRETE CURB & GUTTER
- (E) EXISTING PORTLAND CEMENT CONCRETE SIDEWALK, 5"
- (F) EXISTING HOT-MIX ASPHALT BIKE PATH, 2"
- (G) EXISTING AGGREGATE SHOULDER
- (H) HOT-MIX ASPHALT SURFACE REMOVAL, 3"
- (I) HOT-MIX ASPHALT SURFACE REMOVAL, VARIABLE DEPTH

PROPOSED LEGEND

- (1) HOT-MIX ASPHALT SURFACE COURSE, IL-9.5, MIX "D", N50, 1.5"
- (2) HOT-MIX ASPHALT BINDER COURSE, IL-9.5, N50, 1.5"
- (3) BITUMINOUS MATERIALS (TACK COAT)
- (4) CLASS D PATCHES, 8" (LOCATIONS TO BE DETERMINED BY ENGINEER)
- (5) COMBINATION CONCRETE CURB AND GUTTER REMOVAL AND REPLACEMENT (AT VARIOUS LOCATIONS)
- (6) SIDEWALK REMOVAL AND PORTLAND CEMENT CONCRETE SIDEWALK, 5" (AT VARIOUS LOCATIONS)
- (7) BIKE PATH REMOVAL AND HOT-MIX ASPHALT BIKE PATH, 2" (AT VARIOUS LOCATIONS)
- (8) AGGREGATE WEDGE SHOULDER, TYPE B
- (9) TOPSOIL AND SODDING, SALT TOLERANT

NOTE:

THE PATCHING QUANTITIES HAVE BEEN ESTIMATED BASED UPON FIELD OBSERVATIONS DURING DESIGN. ACTUAL QUANTITIES TO BE DETERMINED DURING CONSTRUCTION BY THE ENGINEER

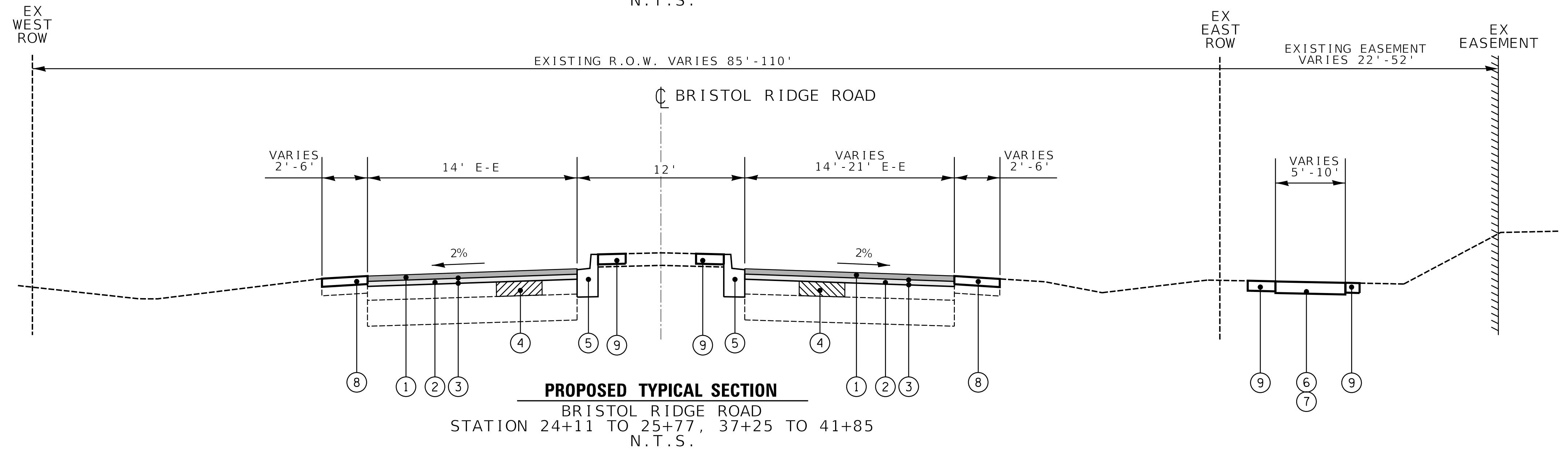
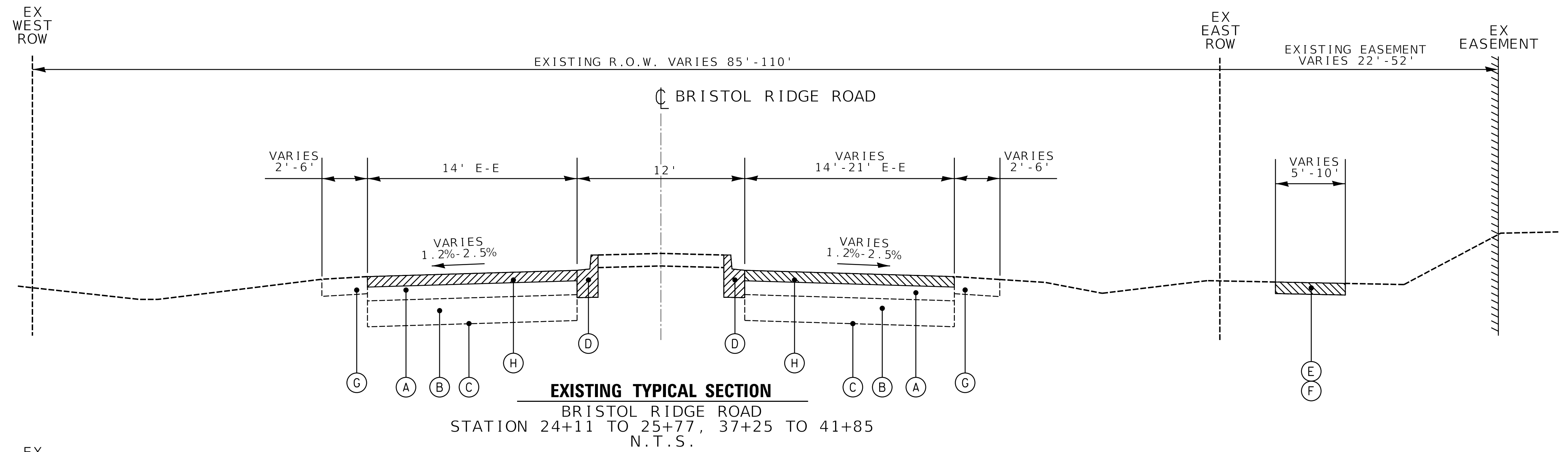

USER NAME = jschmidt PLOT SCALE = \$SCALES
 PLOT DATE = 4/12/2022 10:37:22 AM
 MODEL = \$MODELNAME\$
 FILE NAME = H:\\$DSCHEM\YD_Yorkville\2022\0220\022041\022041.Dgn Final_Eng\YD2041_TYP_SEC.dgn

Engineering Enterprises, Inc.
CONSULTING ENGINEERS
52 Wheeler Road
Sugar Grove, Illinois 60554
630.466.6700 / www.eeiweb.com

DESIGNED -	REVISED -
DRAWN -	REVISED -
CHECKED -	REVISED -
DATE -	REVISED -

**UNITED CITY OF YORKVILLE
KENDALL COUNTY, ILLINOIS**

TYPICAL SECTIONS

SCALE: N.T.S. SHEET 2 OF 2 SHEETS STA. TO STA.

F.A.U. RTE.	SECTION	COUNTY	TOTAL SHEETS	SHEET NO.
1555	21-00052-00-RS	KENDALL	13	7
CONTRACT NO. 87786				
FED. ROAD DIST. NO. 3 ILLINOIS FED. AID PROJECT				

Path: H:\\$DSCHEM\YD_Yorkville\2022\0220\022041\022041.Dgn Final_Eng\YD2041_TYP_SEC.dgn

Storm Sewer Structures Schedule				
Station	O/S	Structure Type and Dimensions	60255500	60257900
			Manholes to be Adjusted (Each)	Manholes to be Reconstructed (Each)
14+34	37' RT	Type 4, T1F OL	1	
16+64	35' RT	Type 4, T1F OL	1	
19+14	35' RT	Type 4, T1F OL	1	
32+68	35' RT	Type 1, T1F OL		1
32+68	32' LT	Type 3, T1F OL		1
Total:			3	2

Roadway Quantities										
STATION	STATION	X4401198	44000161	40600982	44000500	60603800	48102100	40602978	40604060	40600290
		HMA SURF REM VAR DP	HMA SURF REM 3	HMA SURF REM BUTT JT	COMB CURB GUTTER REM	COMB CC&G TB6.12	AGG WEDGE SHOUL TY B	HMA BC IL- 9.5 N50	HMA SC IL- 9.5 D N50	BIT MATLS TACK CT
		SQ YD	SQ YD	SQ YD	FOOT	FOOT	TON	TON	TON	POUND
14+00	18+50	1960	0	23	0	0	25	165	165	1320
18+50	27+50	3490	520	12	44	44	65	340	340	2710
27+50	36+50	4550	0	42	100	100	45	385	385	3070
36+50	44+58	2235	1485	31	44	44	100	315	315	2510
Total:		12235	2005	108	188	188	235	1205	1205	9610

Driveway Pavement, Sidewalk, and Bike Path								
Station	O/S	40600982	X0327036	40800029	72400100	44000600	42400200	42400800
		HOT-MIX ASPHALT SURFACE REMOVAL - BUTT JOINT	BIKE PATH REMOVAL	BIT MATLS TACK CT	INCIDENTAL HOT-MIX ASPHALT SURFACING	SIDEWALK REMOVAL	PC CONC SIDEWALK 5	DETECTABLE WARNINGS
		SQ YD	SQ YD	POUND	TON	SQ FT	SQ FT	SQ FT
15+27	24' LT	41.9		19	5			
16+82	25' LT	5.3		2	1			
18+45	24' LT	30.6		14	4			
19+90	25' LT	40.3		18	5			
20+67	25' LT	15.3		7	2			
21+68	25' LT	24.9		11	3			
26+84	25' LT	38		17	4			
28+27	25' LT	38.2		17	4			
30+07	25' LT	35.2		16	4			
31+70	25' LT	41.9		19	5			
33+52	25' LT	31.8		15	4			
34+05	40' RT					390	390	20
35+30	65' RT		45		5	165	165	10
36+05	25' LT	5.1		3	1			
Total:		348.5	45	158	47	555	555	30

Pavement Markings Schedule							
Station	Station	78000100	78000200	78000400	78000600	78000650	X7810300
		THPL PVT MK LTR & SYM	THPL PVT MK LINE 4	THPL PVT MK LINE 6	THPL PVT MK LINE 12	THPL PVT MK LINE 24	REC REFL PVT MK
		SQ FT	FOOT	FOOT	FOOT	FOOT	EACH
14+00	18+50	31.2	1820	0	0	0	20
18+50	27+50	31.2	3460	0	0	12	34
27+50	36+50	104	3899	469	38	47	49
36+50	44+58	130	2760	422	67	0	32
Total:		296.4	11939	891	105	59	135

Signing Schedule								
Station	O/S	Sign Dimensions	72000100	72400100	72400310	72800100	MUTCD DESIGNATION	Description
			SIGN PANEL - TYPE 1	REMOVE SIGN PANEL ASSEMBLY - TYPE A	REMOVE SIGN PANEL - TYPE 1	TELESCOPING STEEL SIGN SUPPORT		
		(Sq Ft)	(Each)	(Sq Ft)	(Ft)			
14+30	10' RT	24" x 36"	6		6		R3-9b	Two-Way Left Turn Only
23+52	12' LT	30" x 30"	6.25	1		16	R1-1	Stop Sign
24+14	11' RT	24" x 30"	5		5		R2-1	Speed Limit (40 MPH)
24+14	MEDIAN	24" x 30"	5		5		R4-7	Keep Right (mounted on Street Light)
24+14	9' LT	24" x 36"	6		6		R3-9b	Two-Way Left Turn Only
25+72	11' RT	24" x 36"	6		6		R3-9b	Two-Way Left Turn Only
25+72	MEDIAN	24" x 30"	5		5		R4-7	Keep Right (mounted on Street Light)
32+50	10' LT	24" x 30"	5		5		R2-1	Speed Limit (40 MPH)
34+38	17' LT	30" x 30"	6.25	1		16	R1-1	Stop Sign
35+08	10' RT	30" x 30"	6.25		6.25		R1-1	Stop Sign
36+64	4' RT	24" x 30"	5		5		R2-1	Speed Limit (40 MPH)
36+64	12' LT	24" x 36"	6		6		R3-9b	Two-Way Left Turn Only
37+30	MEDIAN	24" x 30"	5				R4-7	Keep Right (mounted on Street Light)
41+68	14' LT	24" x 30"	5		5		R2-1	Speed Limit (40 MPH)
41+82	MEDIAN	24" x 30"	5		5		R4-7	Keep Right (mounted on Street Light)
Total:			82.75	2	65.25	32		

USER NAME = jschmidt PLOT SCALE = \$SCALES
PLOT DATE = 4/12/2022 8:15:57 AM
MODEL = \$MODELNAME\$
FILE NAME = \$3DS\$Pkg\YD_Yorkville\2020\YD2041\Drawings\Final_Eng\YD2041-Cvr.dgn

Engineering Enterprises, Inc.
CONSULTING ENGINEERS
52 Wheeler Road
Sugar Grove, Illinois 60554
630.466.6700 / www.eeiweb.com

DESIGNED -	REVISED -
DRAWN -	REVISED -
CHECKED -	REVISED -
DATE -	REVISED -

UNITED CITY OF YORKVILLE
KENDALL COUNTY, ILLINOIS

SCHEDULE OF QUANTITIES

SCALE: N.T.S. SHEET 1 OF 1 SHEETS STA. TO STA.

F.A.U. RTE.	SECTION	COUNTY	TOTAL SHEETS	SHEET NO.
1555	21-00052-00-RS	KENDALL	13	8
CONTRACT NO. 87786				
FED. ROAD DIST. NO. 3 ILLINOIS FED. AID PROJECT				

Path: H:\\$3DS\$Pkg\YD_Yorkville\2020\YD2041\Drawings\Final_Eng\YD2041-Cvr.dgn

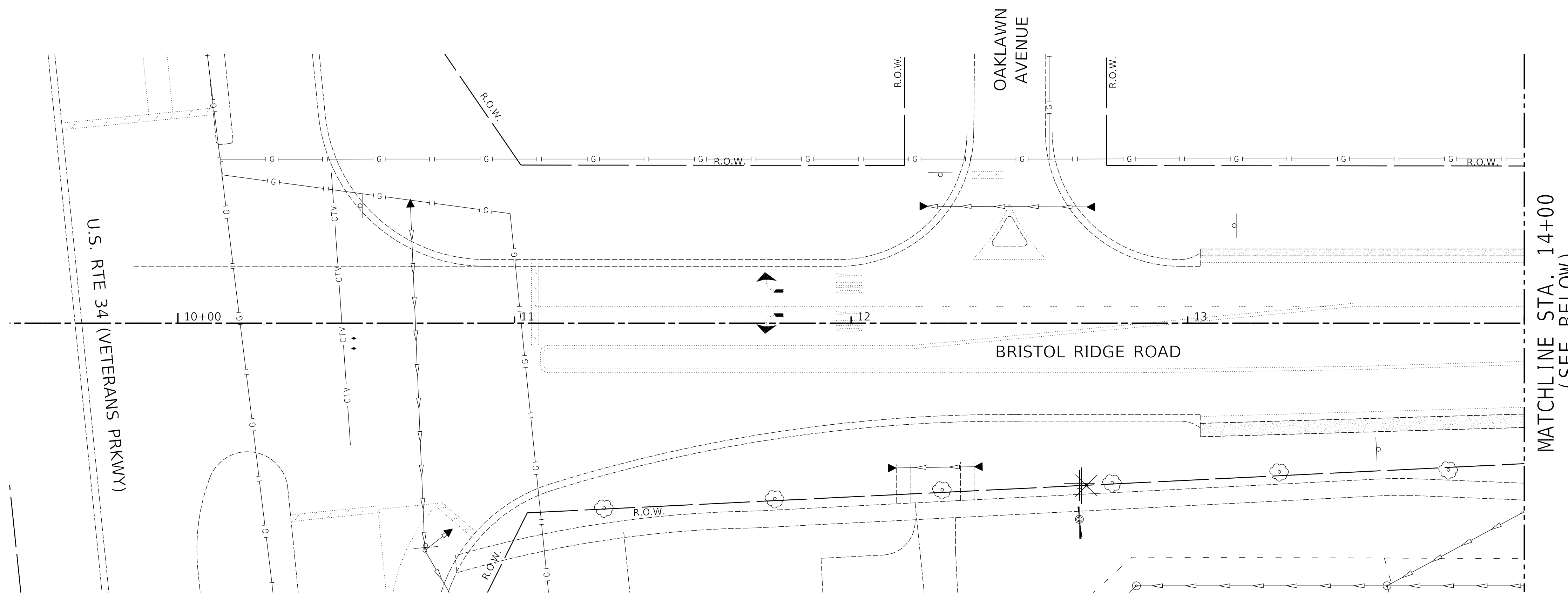
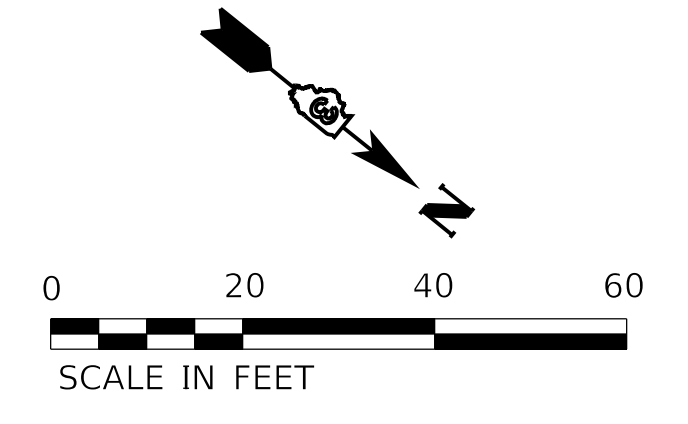

MATCHLINE STA. 14+00
(SEE BELOW)

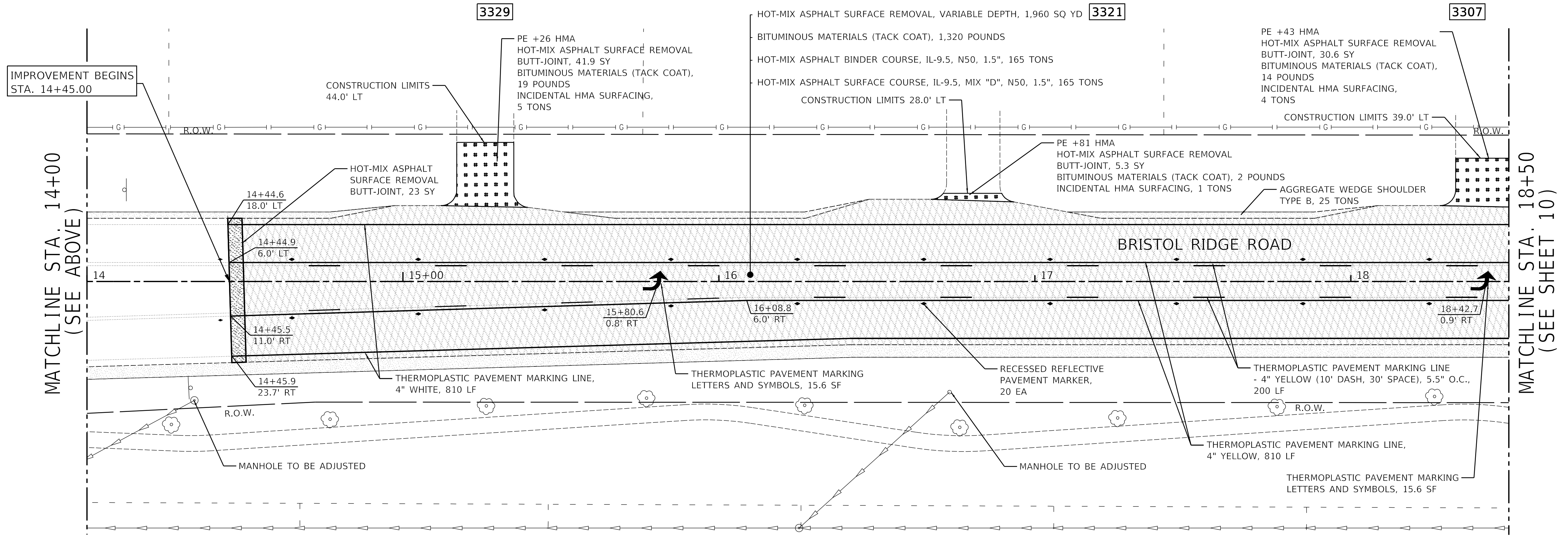

MATCHLINE STA. 14+00
(SEE ABOVE)

MATCHLINE STA. 18+50
(SEE SHEET 10)

USER NAME = jschmidt PLOT SCALE = \$SCALES
 PLOT DATE = 4/12/2022 10:49:53 AM
 MODEL: \$PROJECTNAME\$
 FILE NAME: \$PROJECTNAME\$.Dgn

Engineering Enterprises, Inc.
 CONSULTING ENGINEERS
 52 Wheeler Road
 Sugar Grove, Illinois 60554
 630.466.6700 / www.eeiweb.com

DESIGNED -	REVISD -
DRAWN -	REVISD -
CHECKED -	REVISD -
DATE -	REVISD -

**UNITED CITY OF YORKVILLE
 KENDALL COUNTY, ILLINOIS**

SCALE: 1"=20'	SHEET 1 OF 4 SHEETS	STA. 14+45 TO STA. 18+50
---------------	---------------------	--------------------------

F.A.U. RTE.	SECTION	COUNTY	TOTAL SHEETS	SHEET NO.
1555	21-00052-00-RS	KENDALL	13	9
CONTRACT NO. 87786				
FED. ROAD DIST. NO. 3 ILLINOIS FED. AID PROJECT				

Path: H:\S056\Proj\Y0 - Yorkville\2020\Y02041\Drawn\Drawn Final Eng\Y02041_Plan.dgn

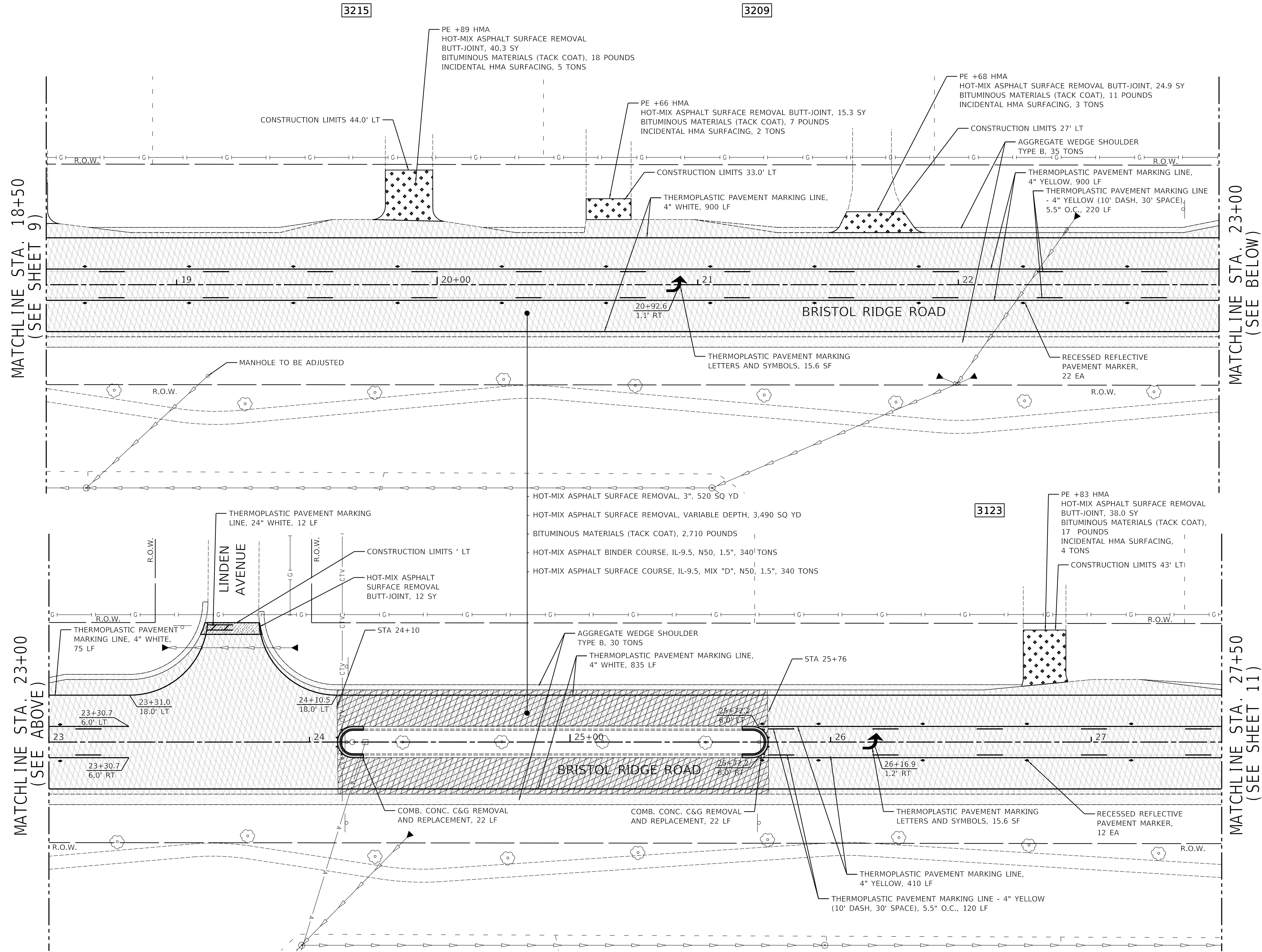
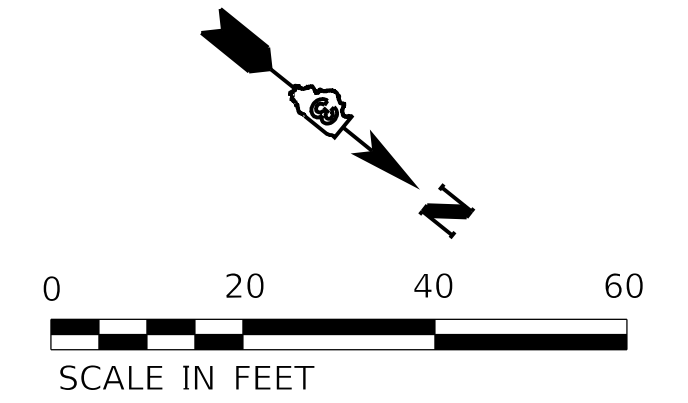

USER NAME = jschmidt PLOT SCALE = \$S CALES
 PLOT DATE = 4/12/2022 10:57:09 AM
 MODEL = \$MODELNAME\$
 FILE NAME = \$SDS\$Png\YD -Yorkville\2020\YD2041\Drawn\Drawn Final -Eng\YD2041 -PLAN.dgn

Engineering Enterprises, Inc.
 CONSULTING ENGINEERS
 52 Wheeler Road
 Sugar Grove, Illinois 60554
 630.466.6700 / www.eeiweb.com

DESIGNED -	REVISED -
DRAWN -	REVISED -
CHECKED -	REVISED -
DATE -	REVISED -

**UNITED CITY OF YORKVILLE
 KENDALL COUNTY, ILLINOIS**

SCALE: 1"=20'	SHEET 2 OF 4 SHEETS	STA. 18+50 TO STA. 27+50
---------------	---------------------	--------------------------

F.A.U. RTE.	SECTION	COUNTY	TOTAL SHEETS	SHEET NO.
1555	21-00052-00-RS	KENDALL	13	10
CONTRACT NO. 87786				
FED. ROAD DIST. NO. 3 ILLINOIS FED. AID PROJECT				

Path: H:\SDS\$Png\YD -Yorkville\2020\YD2041\Drawn\Drawn Final -Eng\YD2041 -PLAN.dgn

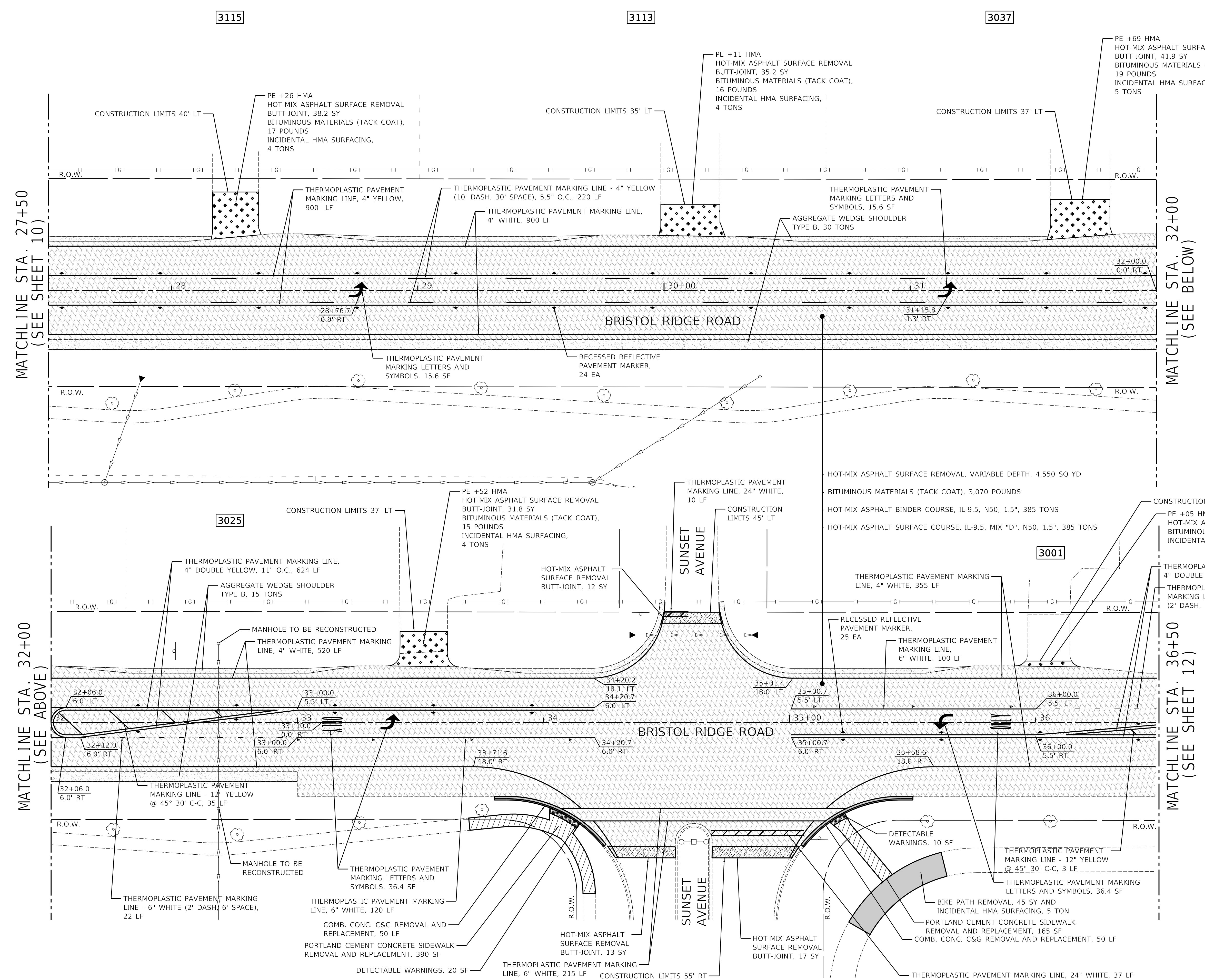
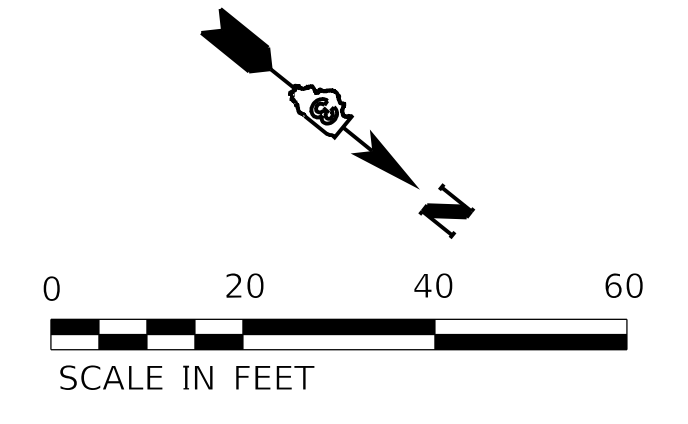

USER NAME = jschmidt PLOT SCALE = \$S\$CALES
 PLOT DATE = 4/12/2022 10:58:49 AM
 MODEL = \$MODELNAME\$
 FILE NAME = \$FILENAME\$.dgn

Engineering Enterprises, Inc.
 CONSULTING ENGINEERS
 52 Wheeler Road
 Sugar Grove, Illinois 60554
 630.466.6700 / www.eeiweb.com

DESIGNED	-	REVISED	-
DRAWN	-	REVISED	-
CHECKED	-	REVISED	-
DATE	-	REVISED	-

**UNITED CITY OF YORKVILLE
 KENDALL COUNTY, ILLINOIS**

SCALE: 1"=20'	SHEET 3	OF 4 SHEETS	STA. 27+50	TO STA. 36+50
---------------	---------	-------------	------------	---------------

F.A.U. RTE.	SECTION	COUNTY	TOTAL SHEETS	SHEET NO.
1555	21-00052-00-RS	KENDALL	13	11
FED. ROAD DIST. NO. 3 ILLINOIS FED. AID PROJECT			CONTRACT NO. 87786	

Path: H:\5056\proj\Y02020\Y02041\Drawn\Drawn.dgn Final: Eng\Y02041.PLAN.dgn

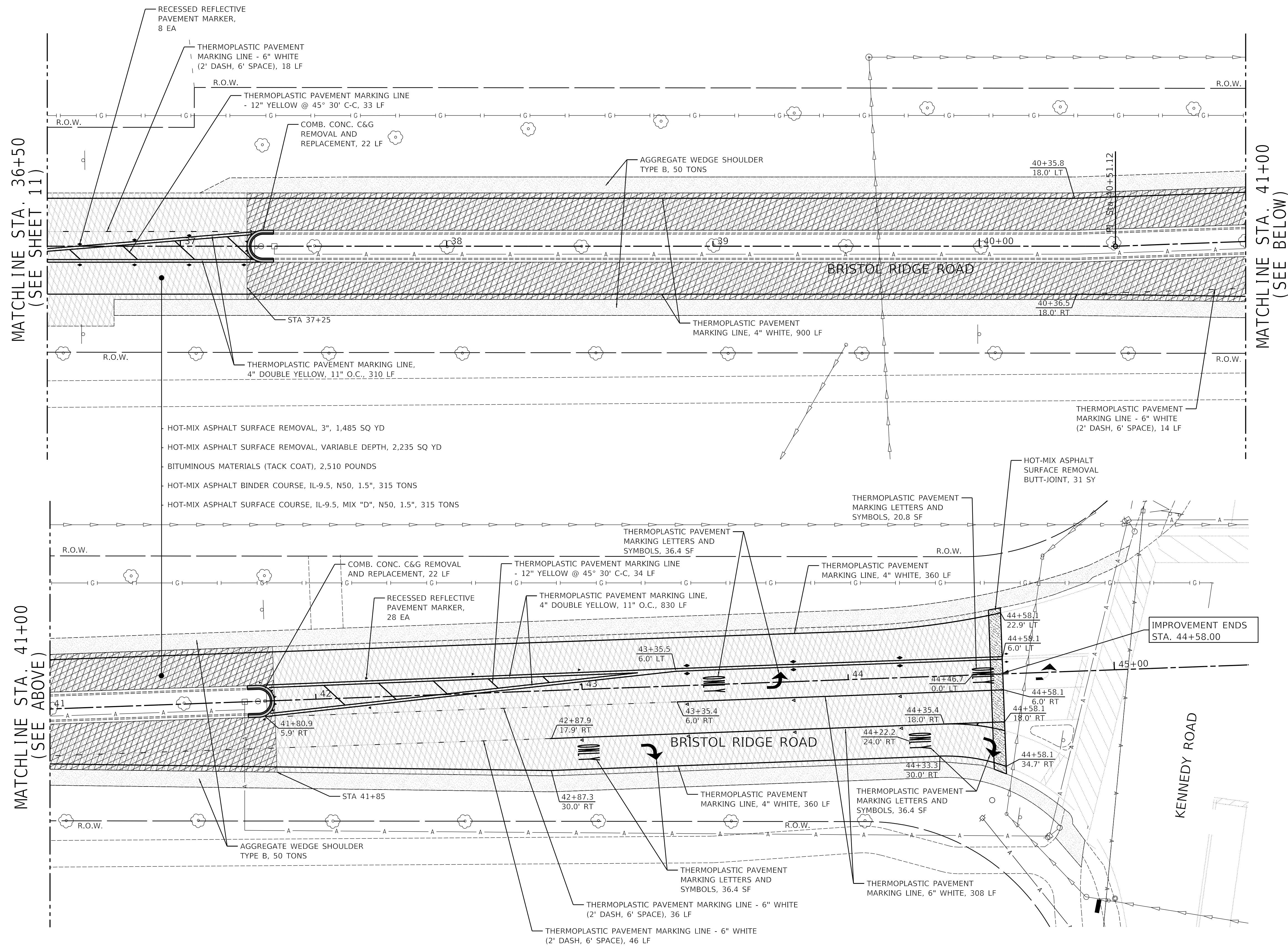
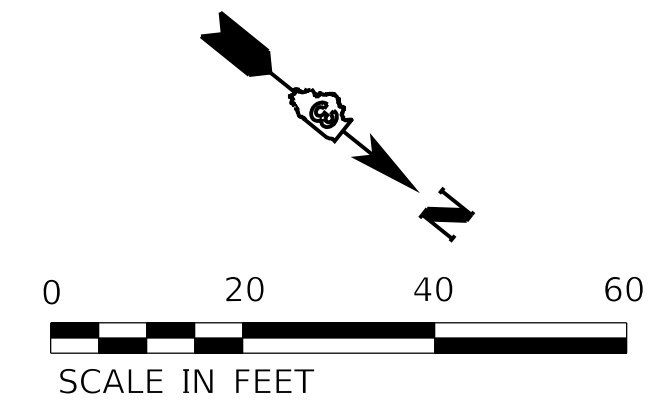

USER NAME = jschmidt PLOT SCALE = \$S CALES
 PLOT DATE = 4/12/2022 11:00:23 AM
 MODEL: \$MODELNAME\$
 FILE NAME: R3525RCPg1\YD_Vorkville\2020\Y02041\Drawn\Drawn Final Eng\Y02041_Plan.dgn

Engineering Enterprises, Inc.
 CONSULTING ENGINEERS
 52 Wheeler Road
 Sugar Grove, Illinois 60554
 630.466.6700 / www.eeiweb.com

DESIGNED -	REVISED -
DRAWN -	REVISED -
CHECKED -	REVISED -
DATE -	REVISED -

**UNITED CITY OF YORKVILLE
 KENDALL COUNTY, ILLINOIS**

SCALE: 1"=20' SHEET 4 OF 4 SHEETS STA. 36+50 TO STA. 44+58

F.A.U. RTE.	SECTION	COUNTY	TOTAL SHEETS	SHEET NO.
1555	21-00052-00-RS	KENDALL	13	12
FED. ROAD DIST. NO. 3 ILLINOIS FED. AID PROJECT			CONTRACT NO. 87786	

Path: H:\5056RCPg1\YD_Vorkville\2020\Y02041\Drawn\Drawn Final Eng\Y02041_Plan.dgn

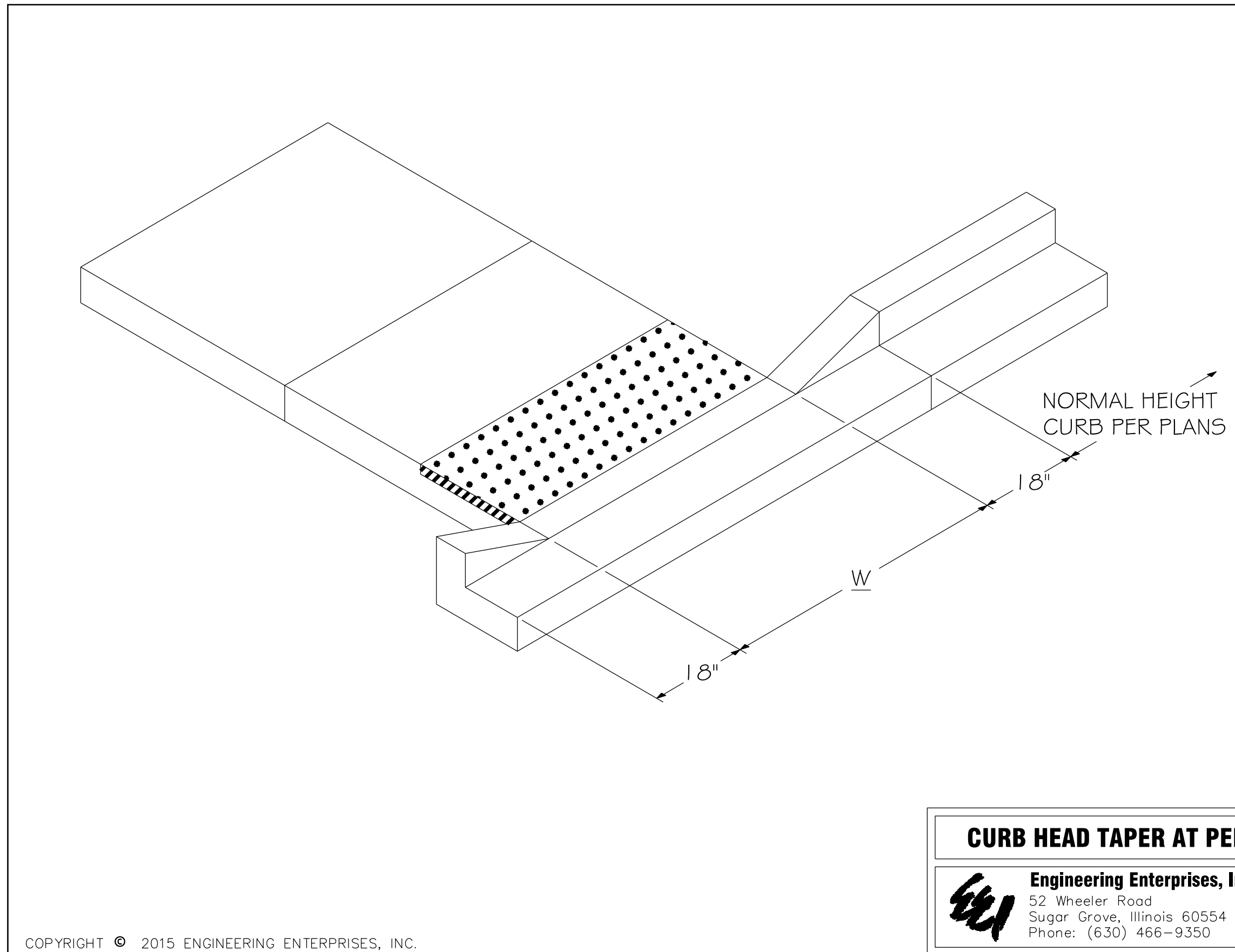

- NOTES:
1. PLACEMENT OF DETECTABLE WARNING TILES SHALL ADHERE TO LOCATIONS & SETBACKS AS SHOWN IN IDOT HIGHWAY STANDARDS INCLUDING 424001, 424006, 424016, 424021, AND 424026 FOR VARIOUS FIELD CONDITIONS. SIDEWALK RAMP WIDTH (W) AND LAYOUT SHALL BE ACCORDING TO THESE IDOT HIGHWAY STANDARDS, EXCEPT A SIDE CURB SHALL NOT BE CONSTRUCTED IN LANDSCAPED AREAS.
 2. DETECTABLE WARNING TILES SHALL BE BRICK RED AND MANUFACTURED BY ADA SOLUTIONS, INC.
 3. TILES SHALL BE INSTALLED PER MANUFACTURER INSTRUCTIONS.
 4. THE COLORING AND STAMPING OF CONCRETE WILL NOT BE ALLOWED.

UNITED CITY OF YORKVILLE

CURB HEAD TAPER AT PEDESTRIAN RAMPS FOR SIDEWALK IN LANDSCAPED AREAS

Engineering Enterprises, Inc. 52 Wheeler Road Sugar Grove, Illinois 60554 Phone: (630) 466-9350	SCALE: N. T. S.	FOLDER:	DRAWING NUMBER: 01	DRAWN BY: CLN
	DATE: 11-09-15			REVISED:

COPYRIGHT © 2015 ENGINEERING ENTERPRISES, INC.

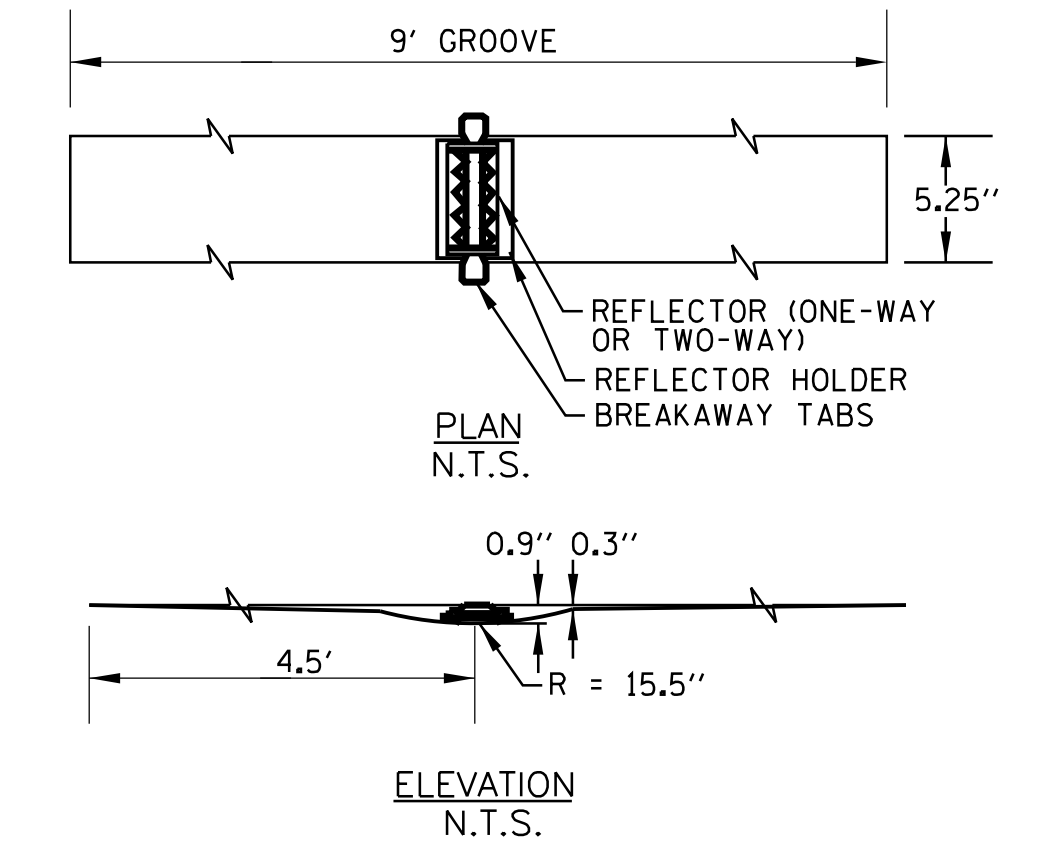

- INSTALLATION NOTES:
1. SAW CUT TO DIMENSIONS SHOWN.
 2. SAW CUT AREAS TO BE DRY AND FREE OF MATERIAL THAT ADVERSELY AFFECTS THE ADHESIVE BOND.
 3. INSTALL THE REFLECTOR WITH AN APPROVED TWO-COMPONENT EPOXY ADHESIVE. EPOXY SHOULD NOT OBSCURE OR BLOCK THE LENS.
 4. REFLECTOR SHALL BE 3M SERIES 190.
 5. THE REFLECTOR HOLDER SHALL BE MARKERONE SERIES R100 REFLECTOR HOLDER.
 6. FOR 1-WAY MARKERS HEADING UPHILL, UPHILL GRIND TAPER MAY BE OMITTED.
- GENERAL NOTE:
1. MARKER PLACEMENT AND COLOR SHALL CONFORM TO IDOT DISTRICT 1 HIGHWAY STANDARD TC-11.

RECESSED REFLECTIVE PAVEMENT MARKERS

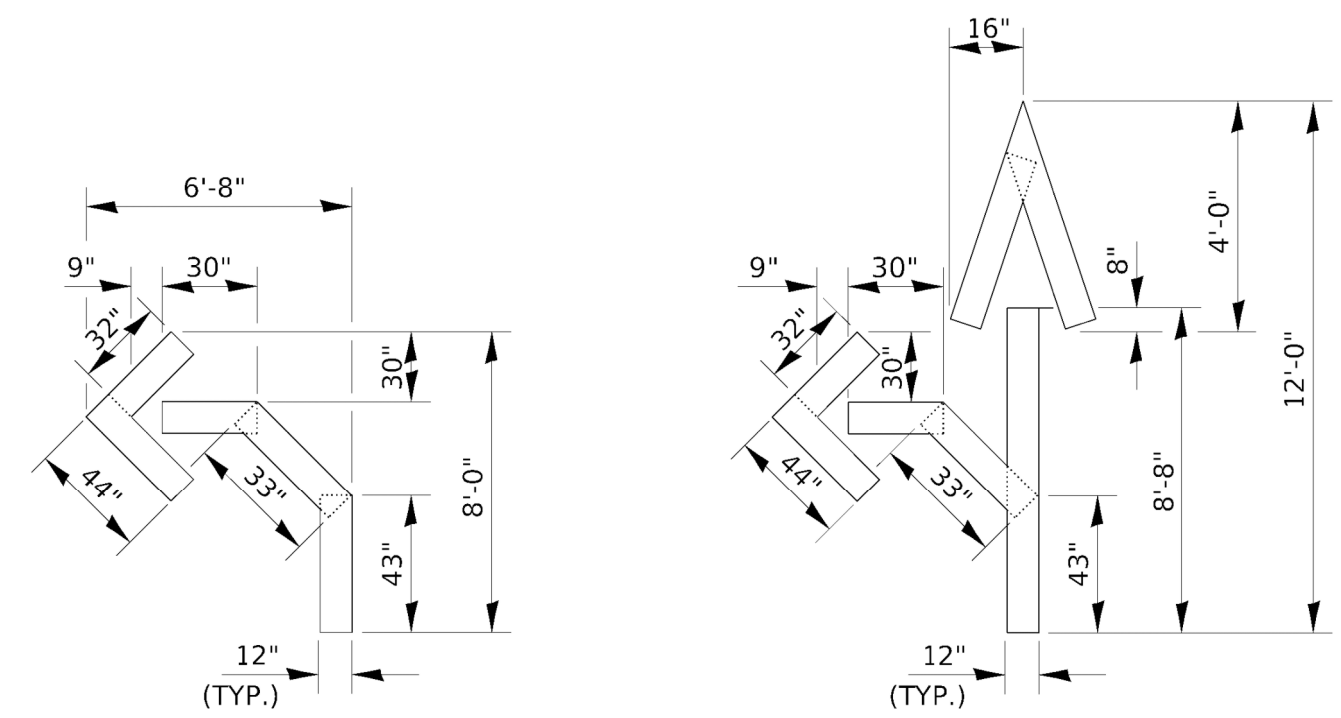

QUANTITY
12" LINE = 16 LIN FT
OR 4" LINE = 48 LIN FT

QUANTITY
12" LINE = 29 LIN FT
OR 4" LINE = 87 LIN FT

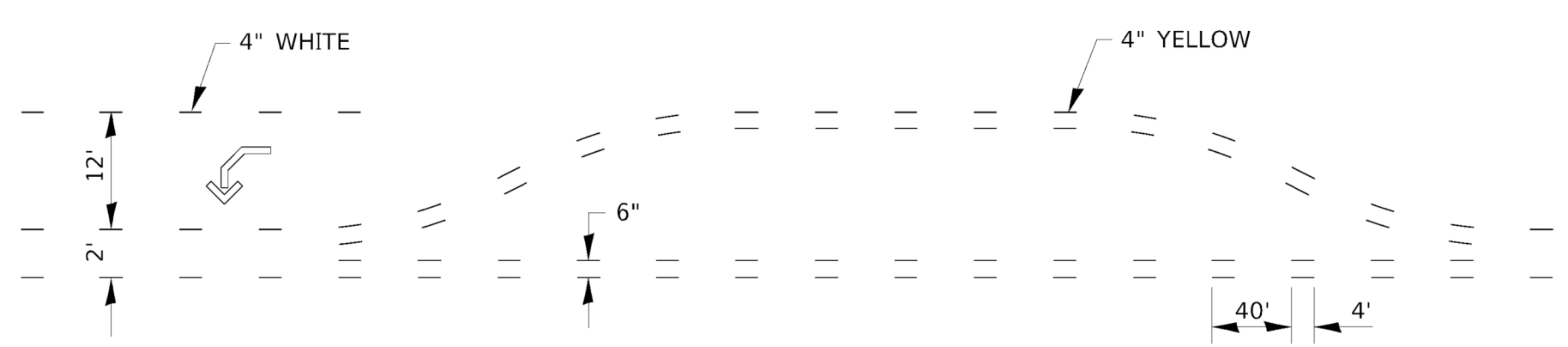

SHORT-TERM PAVEMENT MARKING FOR MEDIANS AND ARROWS
703-1

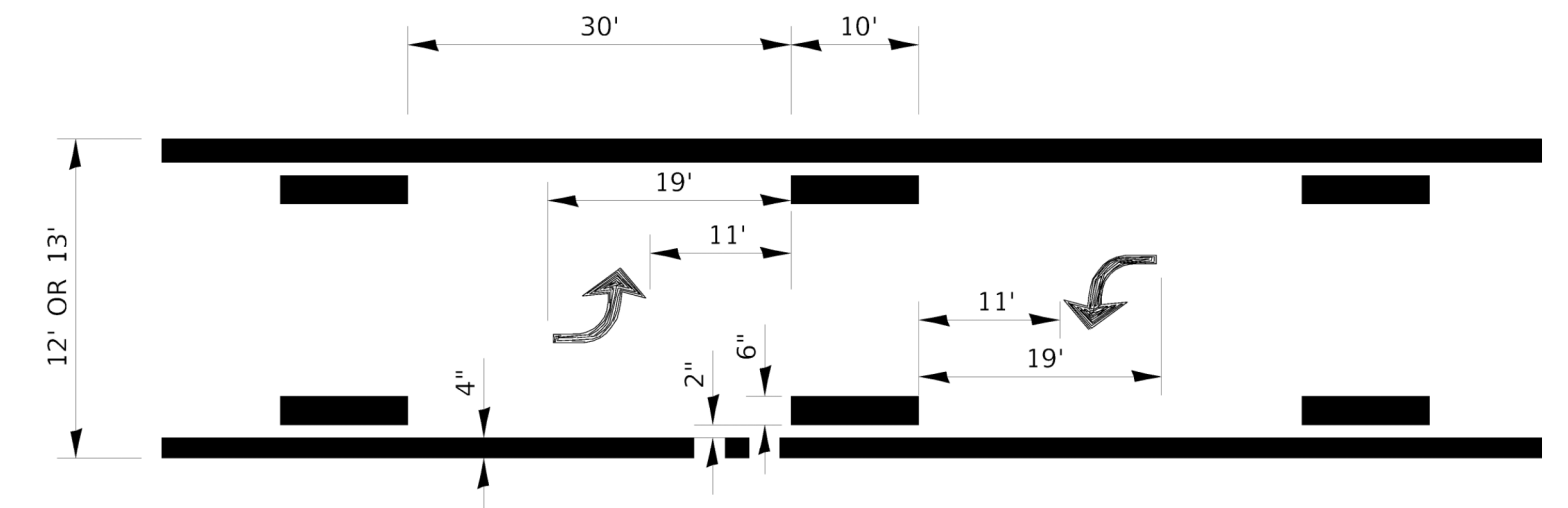

TYPICAL APPLICATION @ BI-DIRECTIONAL TURN LANE
780-2

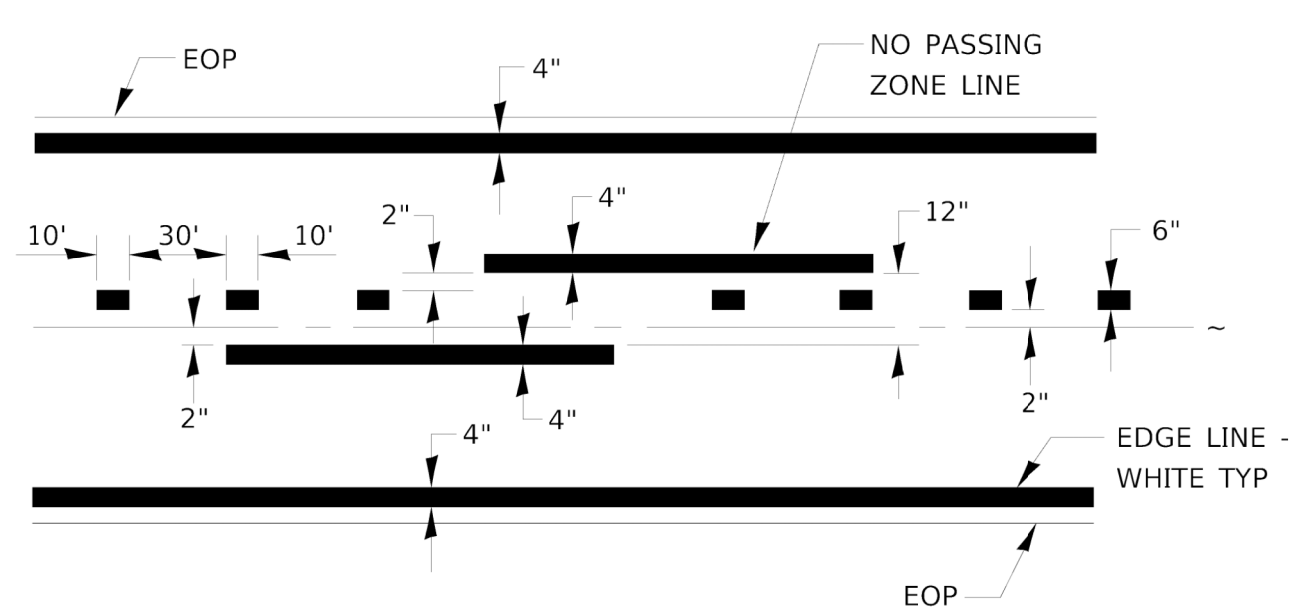

PAVEMENT MARKING
780-8

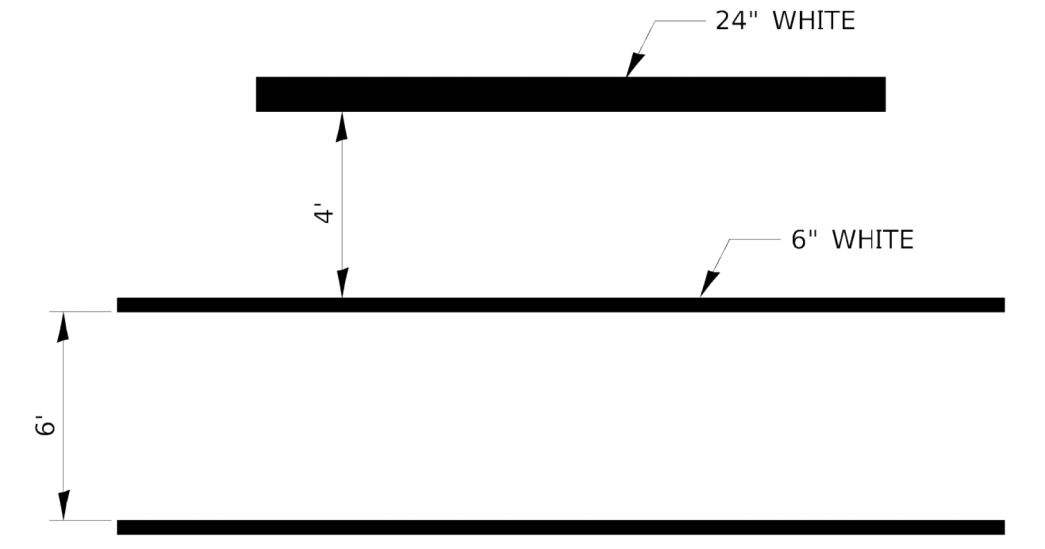

TYPICAL SPACING DETAIL FOR CROSSWALKS AND STOP BARS
780-3
OPTION 1

USER NAME = jschmidt PLOT SCALE = \$SCALES
PLOT DATE = 4/12/2022 9:34:08 AM
MODEL = SMODELNAME
FILE NAME = R:\SDS\Proj\YD_Yorkville\2020\YD2041\Drawings\Final_Eng\YD2041-Cvr.dgn

Engineering Enterprises, Inc.
CONSULTING ENGINEERS
52 Wheeler Road
Sugar Grove, Illinois 60554
630.466.6700 / www.eeiweb.com

DESIGNED -	REVISED -
DRAWN -	REVISED -
CHECKED -	REVISED -
DATE -	REVISED -

UNITED CITY OF YORKVILLE
KENDALL COUNTY, ILLINOIS

SPECIAL DETAILS

SCALE: N.T.S. SHEET 1 OF 1 SHEETS STA. TO STA.

F.A.U. RTE.	SECTION	COUNTY	TOTAL SHEETS	SHEET NO.
1555	21-00052-00-RS	KENDALL	13	13
FED. ROAD DIST. NO. 3 ILLINOIS FED. AID PROJECT			CONTRACT NO. 87786	

Path: H:\SDS\Proj\YD_Yorkville\2020\YD2041\Drawings\Final_Eng\YD2041-Cvr.dgn