

STATE OF ILLINOIS
DEPARTMENT OF TRANSPORTATION

F.A. RTE.	SECTION	COUNTY	TOTAL SHEETS	SHEET NO.
VAR		VARIOUS	12	1
		ILLINOIS	CONTRACT NO. 46599	

*D5 HT PVMNT MRK RPR 23-09

FOR INDEX OF SHEETS, SEE SHEET NO. 2
FOR SOQ, SEE SHEET NO. 6

PROPOSED HIGHWAY PLANS

VARIOUS ROUTES
SECTION D5 HT PVMNT MRK RPR 23-09
PAVEMENT MARKING
VARIOUS COUNTIES

M-60-009-23

FOR LOCATION MAPS, SEE SHEETS 3, 4, & 5

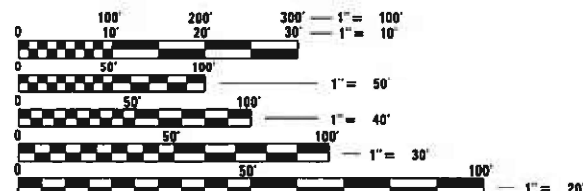

FULL SIZE PLANS HAVE BEEN PREPARED USING STANDARD ENGINEERING SCALES. REDUCED SIZED PLANS WILL NOT CONFORM TO STANDARD SCALES. IN MAKING MEASUREMENTS ON REDUCED PLANS, THE ABOVE SCALES MAY BE USED.

J.U.L.I.E.
JOINT UTILITY LOCATION INFORMATION FOR EXCAVATORS
1-800-892-0123
OR 811

PROJECT ENGINEER: RYAN T. CARROLL
SQUAD LEADER: TYLER J. PIERSON
DESIGNER: AARON FARNHAM
PHONE NUMBER: 217-465-4181
CONTRACT NO. 46599

STATE OF ILLINOIS
DEPARTMENT OF TRANSPORTATION

SUBMITTED 3/23 2022
Xenaila A. Barnett
REGIONAL ENGINEER

May 13, 2022 [Signature]
ENGINEER OF DESIGN AND ENVIRONMENT

May 13, 2022 [Signature]
DIRECTOR OF HIGHWAYS PROJECT IMPLEMENTATION

PRINTED BY THE AUTHORITY
OF THE STATE OF ILLINOIS

LOCATION MAP



HINSHAW AVE FROM:
LOCUST ST TO MARKET ST

LEE ST FROM:
EMPIRE TO LOCUST

TOWANDA AVE FROM:
EMPIRE TO LOCUST

MARKET ST FROM:
INTERSTATE DR TO MITSUBISHI/150/RIVIAN

MARKET ST FROM:
HENSHAW TO BROCK DR

LOCUST ST FROM:
TOWANDA AVE TO CENTER ST

MARKET ST FROM:
BROCK DR TO INTERSTATE DR

LOCUST ST FROM:
CENTER ST TO N. HINSHAW AVE

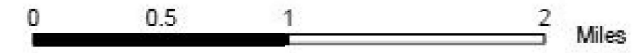

MODEL: I:\MODEL\MRKF... FILE: MRKF... PROJECT: D:\546599\CD\DATA\Design\shu-Location Maps

USER NAME = farnhamba	DESIGNED -	REVISED -
	DRAWN -	REVISED -
PLOT SCALE = 40,0000 * / in.	CHECKED -	REVISED -
PLOT DATE = 3/23/2022	DATE -	REVISED -

**STATE OF ILLINOIS
DEPARTMENT OF TRANSPORTATION**

LOCATION MAP

SCALE: NTS SHEET 2 OF 3 SHEETS STA. TO STA.

F.A. RTE.	SECTION	COUNTY	TOTAL SHEETS	SHEET NO.
	*	VARIOUS	12	4
CONTRACT NO. 46599				
ILLINOIS FED. AID PROJECT				

LOCATION MAP

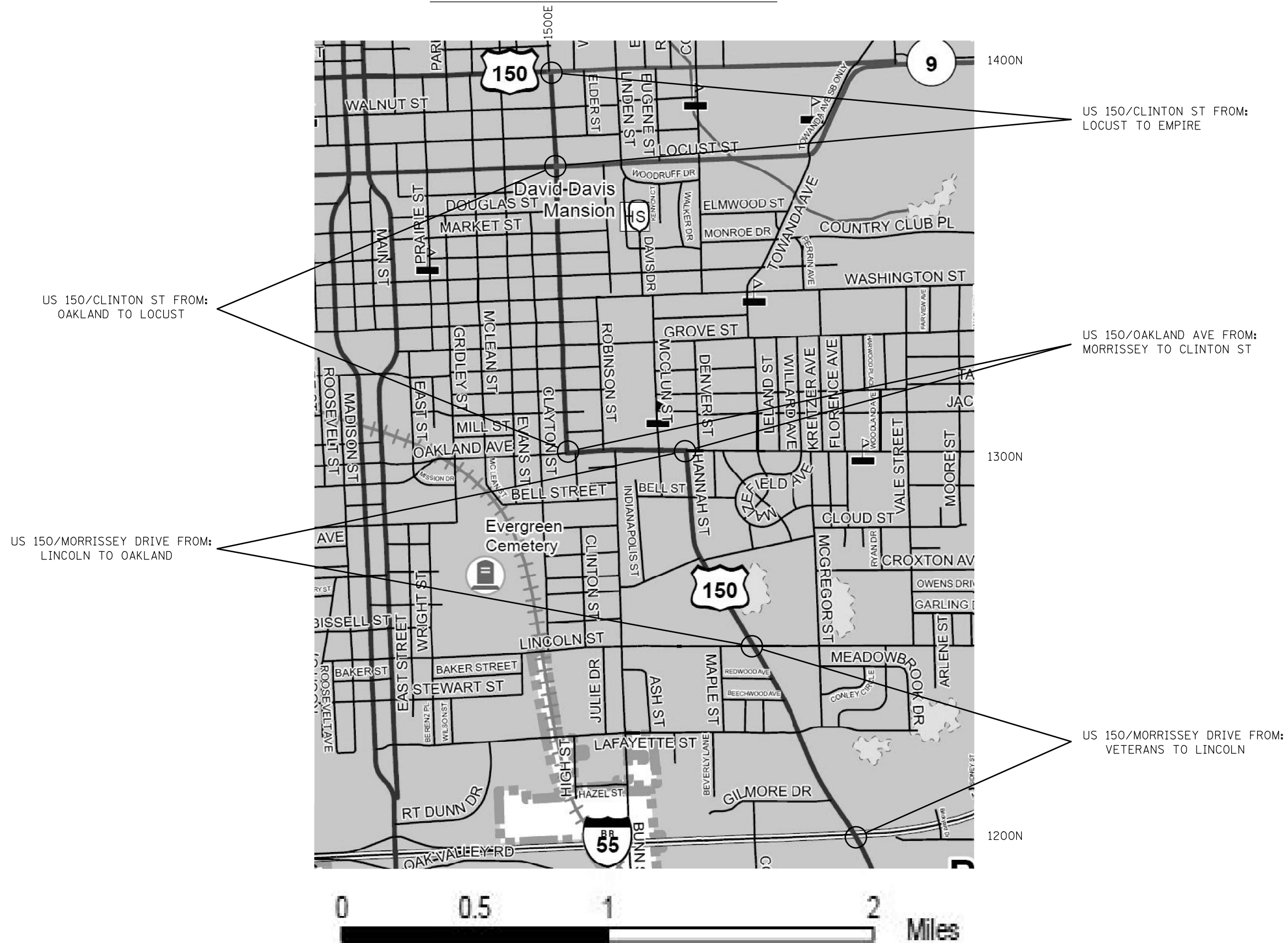

MODEL: \\MODEL\MAPS
 FILE: \\MAPS_P\Public\paw_benefy.com\PIV\DOT\Documents\DOT_Offices\Dir\dir: S\Project\0546599\CADD\data\Design\ch-Location_Maps

VARIOUS	USER NAME = farnhamba	DESIGNED -	REVISED -
		DRAWN -	REVISED -
	PLOT SCALE = 40,0000 * / in.	CHECKED -	REVISED -
	PLOT DATE = 3/23/2022	DATE -	REVISED -

STATE OF ILLINOIS
DEPARTMENT OF TRANSPORTATION

LOCATION MAP			
SCALE: NTS	SHEET 3	OF 3	SHEETS
STA.		TO STA.	

F.A. RTE.	SECTION	COUNTY	TOTAL SHEETS	SHEET NO.
	*	VARIOUS	12	5
CONTRACT NO. 46599				
ILLINOIS FED. AID PROJECT				

SCHEDULES OF QUANTITIES

PAY ITEM #	78008300				78008310				78008350		78008370		
	15.6 SQFT POLYUREA TY2 SINGLE ARROWS	26.0 SQFT POLYUREA TY2 DOUBLE ARROWS	42.0 SQFT POLYUREA TY2 MERGE ARROWS	61.2 SQFT POLYUREA TY2 RR SYMBOLS	4" POLYUREA TY2 SOLID WHITE	4" POLYUREA TY2 WHITE SKIPDASH	4" POLYUREA TY2 YELLOW SOLID	4" POLYUREA TY2 YELLOW SKIPDASH	4" POLYUREA TY2 YELLOW DOUBLE SOLID	4" POLYUREA TY2 LANE LINE EXTENSIONS	12" POLYUREA TY2 WHITE DIAGONALS	12" POLYUREA TY2 YELLOW DIAGONALS	24" POLYUREA TY2 STOP BARS
DESCRIPTION	(SQ FT)	(SQ FT)	(SQ FT)	(SQ FT)	(FOOT)	(FOOT)	(FOOT)	(FOOT)	(FOOT)	(FOOT)	(FOOT)	(FOOT)	
UNIT OF MEASUREMENT	(SQ FT)	(SQ FT)	(SQ FT)	(SQ FT)	(FOOT)	(FOOT)	(FOOT)	(FOOT)	(FOOT)	(FOOT)	(FOOT)	(FOOT)	
SECTION													
IL-9													
EAST EMPIRE ST													
TOWANDA/BARNES TO HAEFFELE	124.8				385.5				776.2		95.1	68.7	200.7
HAEFFELE TO TRINITY LANE	78.0								427.7			42.3	174.3
TRINITY LANE TO AIRPORT	124.8				179.6				823.7		242.9	58.1	169.0
AIRPORT TO CARNAHAN	78.0												137.3
CARNAHAN TO EASTPORT	171.6				5750.0	1283.1	570.3				63.4		169.0
EASTPORT TO HERSHEY	140.4				3184.0	636.3					433.0		248.2
HERSHEY TO PROSPECT RD	265.2				338.0						893.4		374.9
PROSPECT TO VETERANS	156.0												174.3
VETERANS TO SERVICE DR	171.6									50.0			200.7
SERVICE TO TOWANDA AVE	234.0				1728.0	1701.5					121.5		433.0
TOWANDA AVE TO COLTON AVE						513.5							95.1
COLTON AVE TO PARK ST	62.5	52.0			100.4	800.0							206.0
PARK ST TO LEE ST.	93.6	104.0			549.2	471.3				59.3	26.4		295.7
IL-9													
LEE ST FROM:													
EMPIRE TO LOCUST	31.2	52.0			124.5		163.7	269.3		17.5			95.1
IL-9													
TOWANDA AVE FROM:													
EMPIRE TO LOCUST	31.2					913.5							58.1
IL-9													
LOCUST ST FROM:													
TOWANDA AVE TO CENTER ST	124.8	104.0			1547.1	1512.8					343.2		599.7
CENTER ST TO N. HINSHAW AV	187.2	52.0			2080.4	311.6	475.2	340.6	1467.9	57.5	580.8	116.2	232.4
IL-9													
HINSHAW AVE FROM:													
LOCUST ST TO MARKET ST	31.2				121.5				480.5				79.2
SUB-TOTALS =	2106.1	364.0	0.0	0.0	16088.2	8143.6	1209.2	609.9	3976.0	184.3	2799.6	285.2	3942.6

MODEL: I:\MODEL\MHFS
 FILE: MHFS_Plan\Subcontract\beefey.com\FW\DOT\Documents\DOT Office\Dir\Dir: S:\Project\0546599\CADD\DATA\Design\Subcontract\beefey.com

USER NAME = farnhamba	DESIGNED -	REVISED -
	DRAWN -	REVISED -
PLOT SCALE = 40,0000 * / in.	CHECKED -	REVISED -
PLOT DATE = 3/23/2022	DATE -	REVISED -

**STATE OF ILLINOIS
DEPARTMENT OF TRANSPORTATION**

SCHEDULES OF QUANTITIES

SCALE: SHEET 1 OF 2 SHEETS STA. TO STA.

F.A. RTE.	SECTION	COUNTY	TOTAL SHEETS	SHEET NO.
VAR.	*	VARIOUS	12	7
CONTRACT NO. 46599				
ILLINOIS FED. AID PROJECT				

SCHEDULES OF QUANTITIES

PAY ITEM #	78008300				78008310						78008350		78008370
	15.6 SQFT	26.0 SQFT	42.0 SQFT	61.2 SQFT	4"	4"	4"	4"	4"	4"	12"	12"	24"
	POLYUREA TY2 SINGLE ARROWS	POLYUREA TY2 DOUBLE ARROWS	POLYUREA TY2 MERGE ARROWS	POLYUREA TY2 RR SYMBOLS	POLYUREA TY2 SOLID WHITE	POLYUREA TY2 WHITE SKIPDASH	POLYUREA TY2 YELLOW SOLID	POLYUREA TY2 YELLOW SKIPDASH	POLYUREA TY2 YELLOW DOUBLE SOLID	POLYUREA TY2 LANE LINE EXTENSIONS	POLYUREA TY2 WHITE DIAGONALS	POLYUREA TY2 YELLOW DIAGONALS	POLYUREA TY2 STOP BARS
UNIT OF MEASUREMENT	(SQ FT)	(SQ FT)	(SQ FT)	(SQ FT)	(FOOT)	(FOOT)	(FOOT)	(FOOT)	(FOOT)	(FOOT)	(FOOT)	(FOOT)	(FOOT)
SECTION													
IL-9													
HINSHAW AVE FROM:													
LOCUST ST TO MARKET ST	31.2				121.5				480.5				79.2
IL-9													
MARKET ST FROM:													
HENSHAW TO BROCK DR	390.0			244.8	1552.4	1217.1			5396.2	99.4	311.6	380.2	617.8
BROCK DR TO INTERSTATE DR	343.2				2508.0				3469.0	982.8	543.9	686.4	1024.4
INTERSTATE DR TO MITSUBISHI	514.6				4371.9	1899.5	7439.6	1668.5			295.7		137.3
US 150													
MORRISSEY DRIVE FROM:													
VETERANS TO LINCOLN	390.0		84.0		802.6	203.3		250.8	1415.1			274.6	163.7
LINCOLN TO OAKLAND	156.0				4181.8		121.5	1003.2	1272.5	8.8			132.0
US 150													
OAKLAND AVE FROM:													
MORRISSEY TO CLINTON ST	15.6				316.9	604.6			1214.4		31.7		132.0
US 150													
CLINTON ST FROM:													
OAKLAND TO LOCUST	249.6				1108.8			155.8	2946.3			422.4	327.4
LOCUST TO EMPIRE	46.8				211.2		285.2	229.7	306.3	17.5			31.7
TOTALS =													
	4211.9	364.0	84.0	244.8	31141.8	12068.1	9055.5	3917.9	19995.8	1292.8	3982.5	2048.8	6508.9
	SQFT	SQFT	SQFT	SQFT	FT	FT	FT	FT	FT	FT	FT	FT	FT
ADD 10% AND ROUND FOR WORK ORDER QUANTITY													
	4633.1	400.4	92.4	269.3	34256.0	13274.9	9961.0	4309.7	21995.4	1422.1	4380.8	2253.7	7159.8
USE													
	4700.0	400.0	100.0	275.0	34500.0	13500.0	10000.0	4500.0	22000.0	1500.0	4500.0	2500.0	7500.0
	SQFT	SQFT	SQFT	SQFT	FT	FT	FT	FT	FT	FT	FT	FT	FT
GRAND TOTALS =													
	5475.0				86000.0				7000.0		7500.0		

MODEL: \\MODEL\MAME
 FILE: \\MAILS\pub\lucy\paw\lucy.com\FW\DOT\Documents\DOT\Office\Dir\dir: S:\Project\0546599\CADD\data\Design\sh-schedule.k

USER NAME = farnhamba	DESIGNED -	REVISED -
	DRAWN -	REVISED -
PLOT SCALE = 40,0000 * / in.	CHECKED -	REVISED -
PLOT DATE = 3/23/2022	DATE -	REVISED -

STATE OF ILLINOIS
DEPARTMENT OF TRANSPORTATION

SCHEDULES OF QUANTITIES			
SCALE:	SHEET 2	OF 2	SHEETS
STA.	TO STA.		

F.A. RTE.	SECTION	COUNTY	TOTAL SHEETS	SHEET NO.
VAR.	*	VARIOUS	12	8
			CONTRACT NO. 46599	
		ILLINOIS	FED. AID PROJECT	

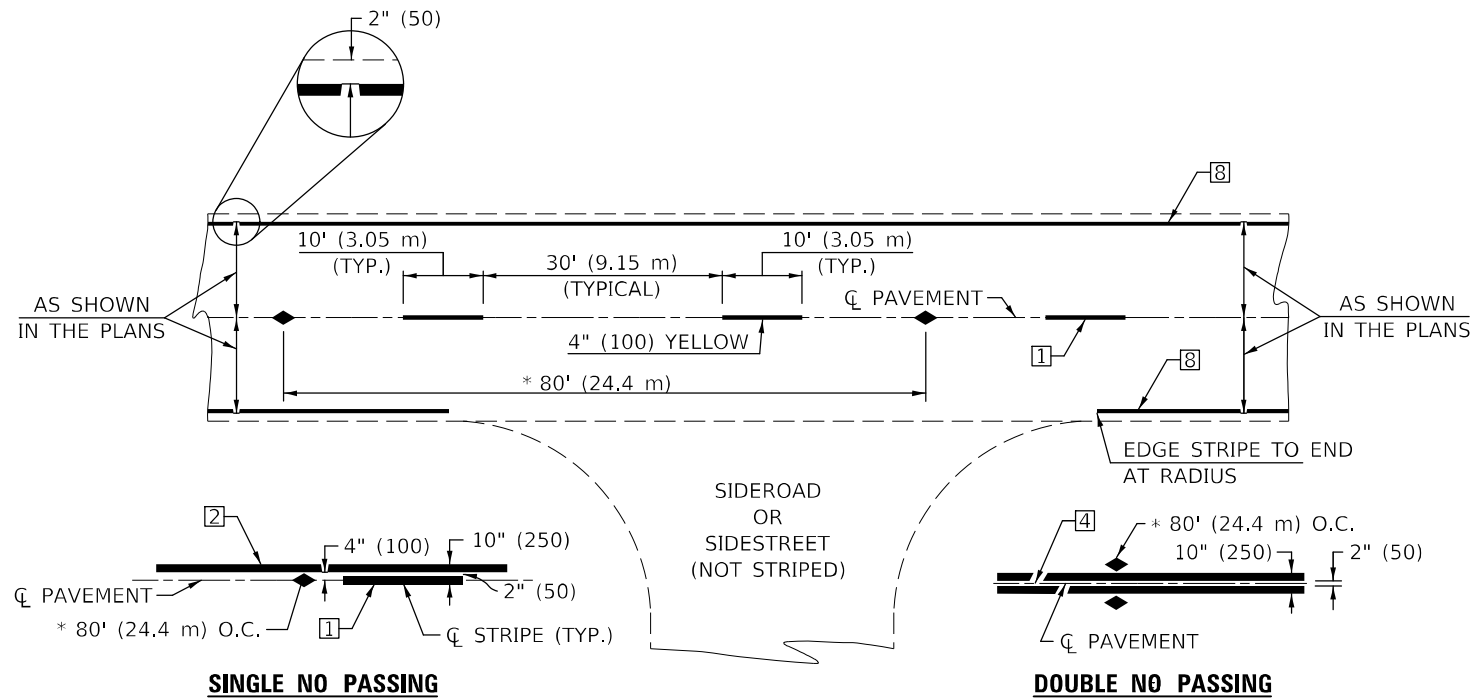

* REDUCE TO 40' (12.2 m) O.C. ON CURVES WITH POSTED OR ADVISORY SPEEDS OF 45 mph (70 km/h) OR LESS.

TWO LANE/TWO WAY

TYPICAL PAVEMENT MARKING LEGEND

- 1 4" (100) SKIP-DASH (YELLOW)
- 2 4" (100) SOLID (YELLOW)
- 3 12" (300) DIAGONAL (YELLOW)
- 4 4" (100) DOUBLE YELLOW (NARROW)
- 5 RESERVED
- 6 RESERVED
- 7 4" (100) SKIP-DASH (WHITE)
- 8 4" (100) SOLID (WHITE)
- 9 12" (300) DIAGONAL (WHITE)
- 10 6" (150) SOLID (WHITE)
- 11 24" (600) STOP BAR (WHITE)
- 12 8" (200) SOLID (WHITE)
- 13 4" (100) LANE LINE EXTENSIONS (WHITE)
- 14 4" (100) PARKING WHITE

TYPICAL PAVEMENT MARKERS LEGEND

- ◆ TWO-WAY AMBER MARKER
- ▶ ONE-WAY AMBER MARKER
- ▷ ONE-WAY CRYSTAL MARKER

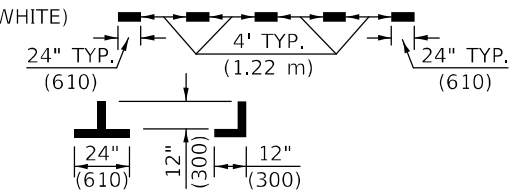
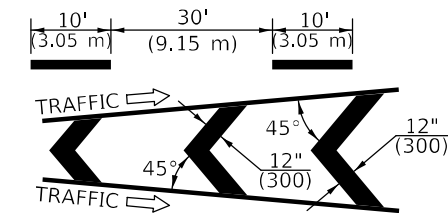
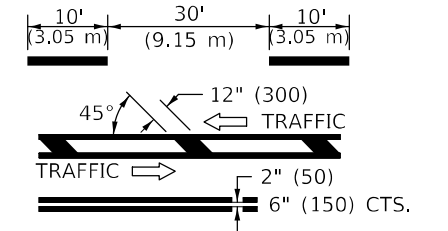

RURAL LEFT TURN

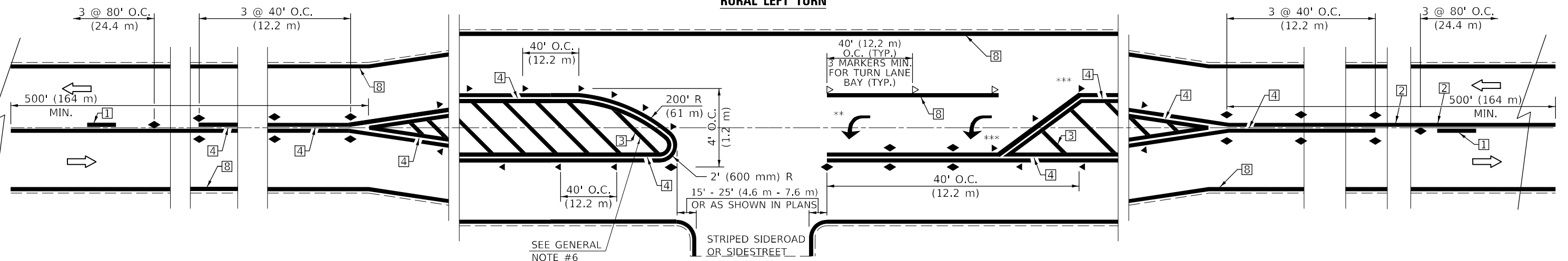

*** REDUCE SPACING IF NECESSARY TO ASSURE MARKERS AT CORNER POINTS.
 ** TURN ARROWS SHALL BE PLACED AS SHOWN ON SHEET #2.

Note: All dimensions are in INCHES (millimeters) unless otherwise shown.

DISTRICT 5 DETAIL NO. 7800AAAA

USER NAME = farnhamba	DESIGNED -	REVISED - 11/06
	DRAWN -	REVISED - 9/2009 KJT
PLOT SCALE = 40,0000 */ in.	CHECKED -	REVISED - 04/14 JLA
PLOT DATE = 3/23/2022	DATE -	REVISED - 3/2019 SWN

**STATE OF ILLINOIS
DEPARTMENT OF TRANSPORTATION**

**PAVEMENT MARKING AND MARKERS
(RURAL & URBAN APPLICATIONS)**

SCALE: NONE SHEET 1 OF 4 SHEETS STA. TO STA.

F.A. RTE.	SECTION	COUNTY	TOTAL SHEETS	SHEET NO.
	*	VARIOUS	12	9
CONTRACT NO. 46599				

MODEL: I:\MODEL MARKS
 FILE: MARKS_PAVEMENT.dwg
 PROJECT: I:\DOT Documents\DOT Office\Drawings\Projects\0546599\CADD\Drawings\Detail

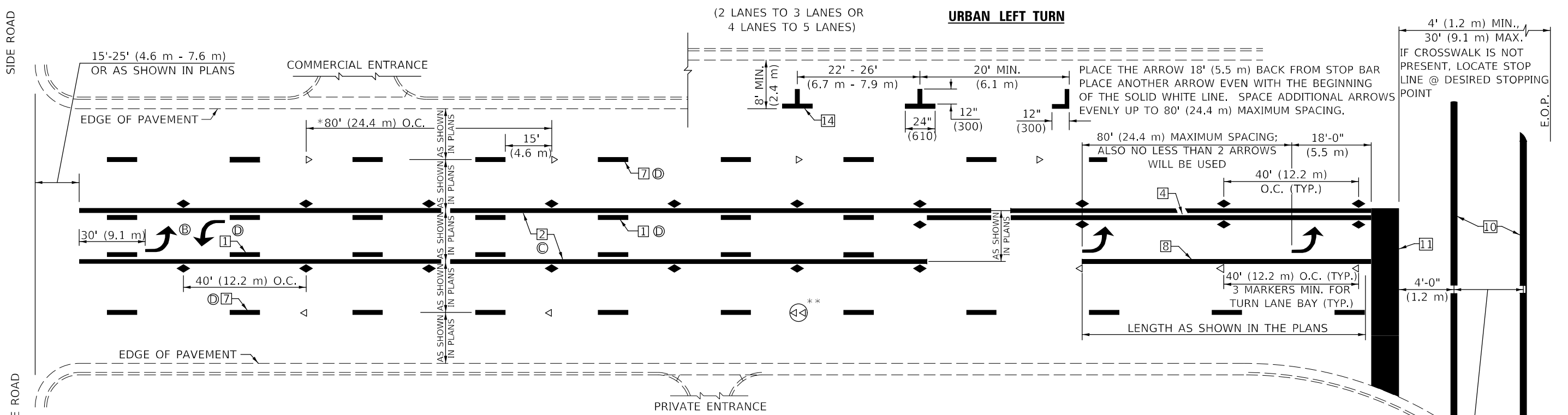

* REDUCE TO 40 FEET (12.2 METERS) ON CENTER ON CURVES WHERE ADVISORY SPEEDS ARE 10 MPH (15 km/h) LOWER THAN POSTED SPEEDS.

** DOUBLE LANE LINE MARKERS SHALL BE SPECIFIED AND SPACED AS SHOWN IN HIGHWAY STANDARD 781001 FOR MULTI-LANE DIVIDED AND UNDIVIDED HIGHWAYS.

GENERAL NOTES:

- Ⓑ TURN ARROW PAIRS SHALL BE PLACED AT 250' (75 m) INTERVALS AND SHALL BE EVENLY SPACED BETWEEN BOTH ENDS OF THE BIDIRECTIONAL LEFT TURN LANE.
- Ⓒ THE SOLID YELLOW PAVEMENT MARKINGS [2] SHOULD GENERALLY START OR END NEAR THE RADIUS POINT OF EACH STREET RETURN EXCEPT WHERE ONE OR BOTH ENDS WOULD INCLUDE STOP BARS.
- Ⓓ THE SKIP-DASH PAVEMENT MARKINGS [1] OR [7] SHOULD BE CENTERED BETWEEN BOTH ENDS OF EACH CITY BLOCK AND SHALL BE PLACED SO THEY LINE UP ACROSS FROM EACH OTHER. SEE EXAMPLE ON SHEET 2 OF 3.
- Ⓔ USE LARGE ARROW SIZE FOR BOTH RURAL AND URBAN LOCATIONS. (SEE LAST PAGE OF SECTION 780x FOR SYMBOLS TABLE)

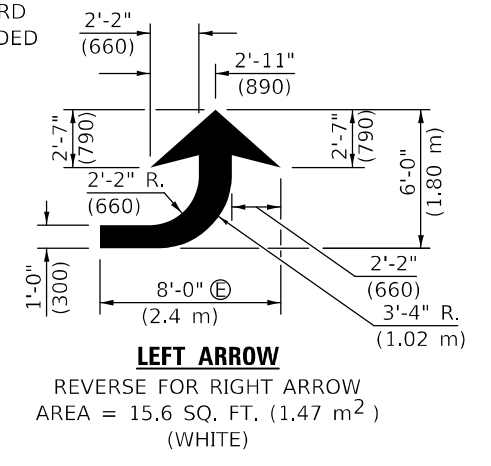

LEFT ARROW

REVERSE FOR RIGHT ARROW
AREA = 15.6 SQ. FT. (1.47 m²)
(WHITE)

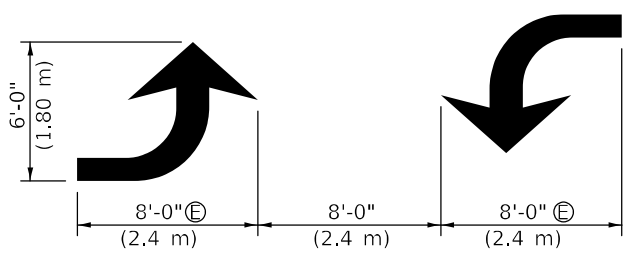

TYPICAL DOUBLE TURN ARROWS (WHITE)

BLOOMINGTON-NORMAL CITY LIMITS ONLY

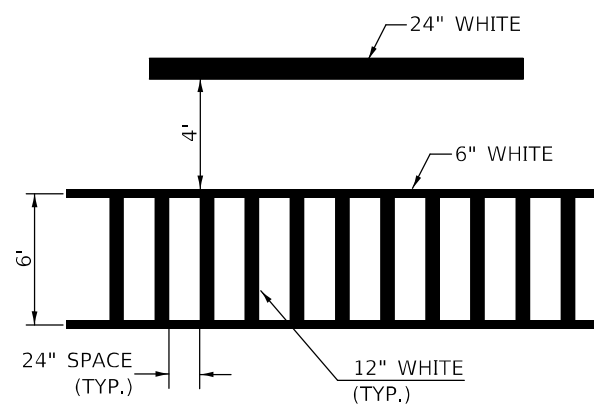

TYPICAL SPACING FOR CROSSWALKS & STOP BARS

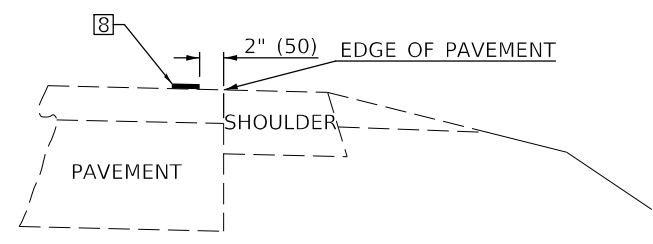

RELATIONSHIP OF EDGE LINE TO EDGE OF PAVEMENT

(SAFETY SHOULDER OR PAVED SURFACE)
SEE ARTICLE 780.04

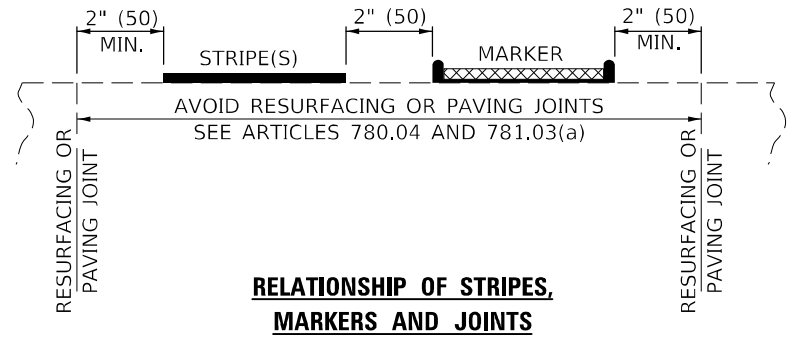

RELATIONSHIP OF STRIPES, MARKERS AND JOINTS

Note: All dimensions are in INCHES (millimeters) unless otherwise shown.

MODEL: I:\MODEL MARKS FILE NAME: pav\pvmnt_mrk_rpr_detail.dwg PROJECT: D:\546599\CADD\DATA\Design\sh-detail

USER NAME = farnhamba	DESIGNED -	REVISED - 11/06
	DRAWN -	REVISED - 9/2009 KJT
PLOT SCALE = 40,0000 * / in.	CHECKED -	REVISED - 04/14 JLA
PLOT DATE = 3/23/2022	DATE -	REVISED - 3/2019 SWN

**STATE OF ILLINOIS
DEPARTMENT OF TRANSPORTATION**

**PAVEMENT MARKING AND MARKERS
(RURAL & URBAN APPLICATIONS)**

SCALE: NONE SHEET 2 OF 4 SHEETS STA. TO STA.

DISTRICT 5 DETAIL NO. 7800AAAA				
F.A. RTE.	SECTION	COUNTY	TOTAL SHEETS	SHEET NO.
VAR.	*	VARIOUS	12	10
			CONTRACT NO. 46599	
		ILLINOIS	FED. AID PROJECT	

