

STATE OF ILLINOIS
DEPARTMENT OF TRANSPORTATION

F.A.I. RTE.	SECTION	COUNTY	TOTAL SHEETS	SHEET NO.
*	D2 RRI 2022-1	**	17	1
		ILLINOIS	64R59	

INDEX OF SHEETS

- 1 COVER SHEET
INDEX OF SHEETS
- 2 GENERAL NOTES
SUMMARY OF QUANTITIES
- 3 SCHEDULE OF QUANTITIES
- 4 - 5 IL 92 (1st AVE) & 17th STREET PLAN SHEETS
- 6 - 7 IL 92 (1st AVE) & 18th STREET PLAN SHEETS
- 8 IL 92 (1st AVE) INTERCONNECT BETWEEN 17th & 18th STREETS
- 9 - 10 IL 92 (4th AVE) & 15th STREET PLAN SHEETS
- 11 - 12 IL 92 (4th AVE) & 17th STREET PLAN SHEETS
- 13 - 14 IL 92 (4th AVE) & 19th STREET PLAN SHEETS
- 15 - 16 IL 92 (4th AVE) & 23rd STREET PLAN SHEETS
- 17 IL 92 (18th AVE) & IL 84 (19th ST)
US ROUTE 6 & PATRIOT WAY
US 20 (EAST RAMP) & SOUTH APPLETON ROAD

STANDARDS

- 701001-02
- 701006-05
- 701101-05
- 701106-02
- 701301-04
- 701901-08

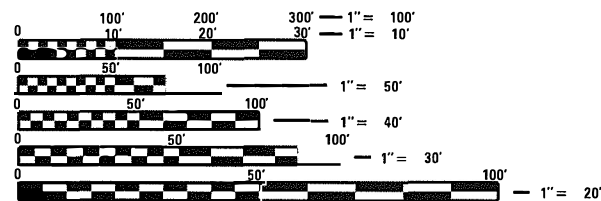

FULL SIZE PLANS HAVE BEEN PREPARED USING STANDARD ENGINEERING SCALES. REDUCED SIZED PLANS WILL NOT CONFORM TO STANDARD SCALES. IN MAKING MEASUREMENTS ON REDUCED PLANS, THE ABOVE SCALES MAY BE USED.

J.U.L.I.E.
JOINT UTILITY LOCATION INFORMATION FOR EXCAVATORS
1-800-892-0123
OR 811

PROJECT ENGINEER: PAUL DREZEN
PROJECT MANAGER: SCOTT KULLERSTRAND, PE

CONTRACT NO. 64R59

PROPOSED
HIGHWAY PLANS

VARIOUS ROUTES
SECTION: D2 RRI 2022-1
TRAFFIC SIGNAL CABINET AND CONTROLLER UPGRADES
AT RAILROAD INTERCONNECTED INTERSECTIONS
VARIOUS COUNTIES

C92-070-22

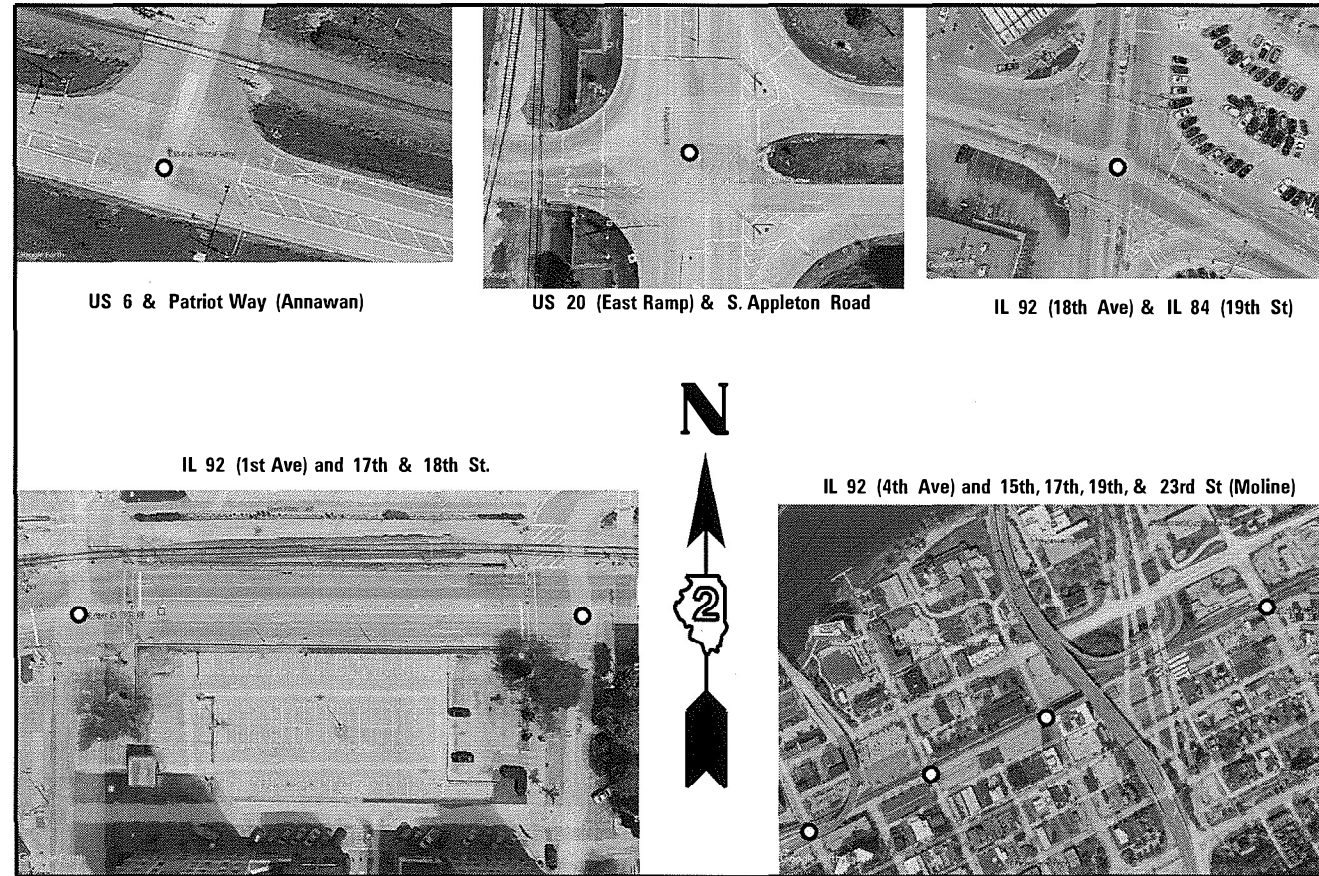

GROSS LENGTH & NET LENGTH = POINT LOCATIONS

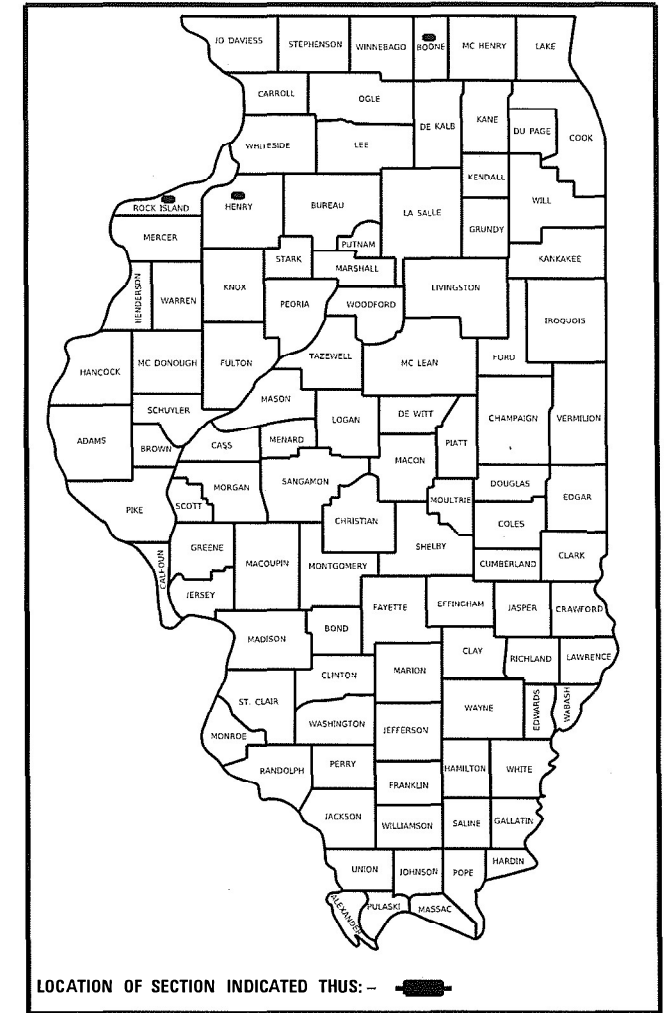

STATE OF ILLINOIS
DEPARTMENT OF TRANSPORTATION

SUBMITTED March 18, 2022

[Signature]
REGIONAL ENGINEER

May 13, 2022 [Signature]
ENGINEER OF DESIGN AND ENVIRONMENT

May 13, 2022 [Signature]
DIRECTOR OF HIGHWAYS PROJECT IMPLEMENTATION

PRINTED BY THE AUTHORITY
OF THE STATE OF ILLINOIS

GENERAL NOTES:

1. THE CONTRACTOR SHALL COORDINATE WITH ICC AND IDOT STAFF (Scott Kullerstrand 815-284-5468) TO SCHEDULE JOINT SHOP TESTING OF ALL APPLICABLE TRAFFIC CONTROL EQUIPMENT AT THE VENDORS FACILITY PRIOR TO FIELD INSTALLATION.
2. THE CONTRACTOR SHALL COORDINATE WITH ICC, IDOT STAFF (Scott Kullerstrand 815-284-5468), AND VENDOR REPRESENTATIVE FOR INSPECTION DURING FIELDINSTALLATION. THE VENDOR REPRESENTATIVE SHALL BE EXPECTED TO BE ABLE TO PROGRAM THE CONTROLLER, TROUBLESHOOT, AND CORRECT ANY PROBLEMS WITH THE EQUIPMENT WHICH MAY ARISE DURING THE INSTALLATION PROCESS. THE VENDOR SHALL VERIFY IN WRITING THAT THE EQUIPMENT IS FUNCTIONING ACCORDING TO THE PLANS AND SPECIFICATIONS.
3. THE TRAFFIC SIGNAL SECTION AT IDOT DISTRICT 2 (SCOTT KULLERSTRAND) SHALL BE NOTIFIED AT LEAST 72 HOURS PRIOR TO THE TURN ON OF ANY CONTROLLER UNITS.
4. ALL CONTROLLER CABINETS SHALL BE INSTALLED ON THE EXISTING BASE IN ACCORDANCE WITH THE CURRENT IDOT STANDARD SPECIFICATIONS FOR ROAD AND BRIDGE CONSTRUCTION.
5. THE PROPOSED TRAFFIC SIGNAL CONTROLLER CABINET SHAL BE FURNISHED WITH RAILROAD PREEMPTION "TEST B" INPUT AND A MOMENTARY TEST SWITCH. THIS WORK SHALL BE INCLUDED IN THE COST OF THE CONTROLLER CABINET.
6. UPON A DEMAND FOR RAILROAD PREEMPTION, ANY ACTIVE WALK INDICATORS SHALL IMMEDIATELY TERMINATE AND FLASHING DONT WALK WILL BE LIMITED THROUGH THE ASSOCIATED VEHICULAR YELLOW CLEARANCE INTERVAL ONLY. REFERING TO STANDARD 2393, THE VEHICULAR AND PEDESTRIAN PHASES ARE DESIGNATED ON THE APPLICABLE PHASE DESIGNATION DIAGRAM.
7. THE CONTRACTOR SHALL NOTIFY THE APPLICABLE RAILROAD REPRESENTATIVE 48-HOURS IN ADVANCE OF THE DATE THE RAILROAD TRAFFIC SIGNAL "INTERCONNECT" WILL BE DOWN" (NON OPERATIONAL), AND SHALL CONFIRM IN WRITING THAT THE MESSAGE HAS BEEN RECEIVED.
8. ALL TEMPORARY TRAFFIC MEASURES REQUIRED FOR CONSTRUCTION AS WELL AS TO ENSURE SAFE AND EFFICIENT FLOW OF TRAFFIC DURING TIMES WHEN THE TRAFFIC SIGNALS ARE INOPERABLE SHALL BE THE RESPONSIBILITY OF THE CONTRACTOR AND SHALL CONFORM TO BOTH THE CURRENT EDITION OF THE MANUAL ON UNIFORM TRAFFIC CONTROL DEVICES (M.U.T.C.D.) AND THE ILLINOIS DOT STANDARD SPECIFICATIONS FOR ROAD AND BRIDGE CONSTRUCTION.
9. ALL TRAFFIC SIGNAL CONTROLLERS AND CABINETS ARE TO BE COMPATIBLE WITH THE EXISTING FSK COPPER COMMUNICATIONS TO EXISTING MASTER CONTROLLERS.

100% STATE

SUMMARY OF QUANTITIES			
Code	Pay Item	Unit	Qty
67100100	MOBILIZATION	L SUM	1
85700210	RAILROAD, FULL ACTUATED CONTROLLER AND TYPE IV CABINET *	EACH	6
86400100	TRAN SCIEVER - FIBER OPTIC	EACH	2
87301900	ELECTRIC CABLE IN CONDUIT, EQUIPMENT GROUNDING CONDUCTOR, NO. 6 1C	FOOT	90
X0326836	REMOVE AND REIN STALL VIDEO DETECTION CAMERA AND EQUIPMENT *	EACH	2
X1400214	SPARE RAILROAD, FULL ACTUATED CONTROLLER , SPECIAL *	EACH	6
X8570010	CONTROLLER, TRAFFIC SIGNAL	EACH	2
X8620200	UNINTERRUPTIBLE POWER SUPPLY, SPECIAL *	EACH	1
X8620250	UNINTERRUPTIBLE POWER SUPPLY AND CABINET, SPECIAL *	EACH	7
X7010216	TRAFFIC CONTROL AND PROTECTION, (SPECIAL) *	L SUM	1
X8950105	REMOVE EXI STING TRAFFIC CONTROLLER AND CABINET	EACH	6
X8950114	MODIFY EXISTING CONTROLLER AND CABINET *	EACH	5
* SPECIAL PROVISION FOR PA Y ITEM			

MODEL: D:\fruit... FILE NAME: C:\Users\drezenp\Desktop\03182022_0929099999.rvt_rhan.dgn

USER NAME = drezenp	DESIGNED -	REVISED - L.D. HILL 9/22/00	STATE OF ILLINOIS DEPARTMENT OF TRANSPORTATION	GENERAL NOTES & SUMMARY OF QUANTITIES	F.A.I. RTE.	SECTION	COUNTY	TOTAL SHEETS	SHEE NO.
PLOT SCALE = 40.0000' / in.	DRAWN - L.D. HILL	REVISED - P. DREZEN 2/15/22			*	D2 RRI 2022-1	VARIOUS	17	2
PLOT DATE = Mar-17-2022 05:18:37 PM	CHECKED -	REVISED -			SCALE: 20	SHEET 2	OF 17 SHEETS	STA. _____	TO STA. _____
	DATE - 5/17/00	REVISED -			ILLINOIS FED. AID PROJECT				

PAY ITEM CODE	PAY ITEM	QUANTITY
67100100	MOBILIZATION	L SUM
	District 2 wide	1
	TOTAL	1
86400100	TRANSCIEVER - FIBER OPTIC	EACH
	IL 92 (1st Ave) @ 18th St (Crossing No. 069600W; RR: BNSF: Munic: Rock Island)	1
	IL 92 (1st Ave) @ 17th St (Crossing No. 069601D; RR: BNSF: Munic: Rock Island)	1
	TOTAL	2
87301900	ELECTRIC CABLE IN CONDUIT, EQUIPMENT GROUNDING CONDUCTOR, NO. 6	FOOT
	ILlinois 92 WB (4th Ave) @ 23rd Street (Crossing No. 605931N ; RR: IAIS; Munic.: Moline)	10
	ILlinois 92 WB (4th Ave) @ 19th Street (Crossing No. 605930G; RR: IAIS; Munic.: Moline)	10
	ILlinois 92 WB (4th Ave) @ 17th Street (Crossing No. 605929M; RR: IAIS; Munic.: Moline)	10
	ILlinois 92 WB (4th Ave) @ 15th Street (Crossing No. 604314S; RR: IAIS; Munic.: Moline)	10
	IL 92 (1st Ave) @ 18th St (Crossing No. 069600W; RR: BNSF: Munic: Rock Island)	10
	IL 92 (1st Ave) @ 17th St (Crossing No. 069601D; RR: BNSF: Munic: Rock Island)	10
	US 6 @ Patriot Way (Crossing No. 926045S; RR: IAIS; Munic.: Annawan)	10
	Illinois 92 (1st Ave/18th Ave) @ IL 84 (19th St) (Crossing No. 605942B; RR: IAIS; Munic.: Silvis)	10
	Daimler/US 20 (East Ramp) @ South Appleton Rd. (Crossing No. 174678C; RR: UP: Munic.: Belvidere)	10
	TOTAL	90
X0326836	REMOVE AND REINSTALL VIDEO DETECTION CAMERA AND EQUIPMENT	EACH
	IL 92 (1st Ave) @ 18th St (Crossing No. 069600W; RR: BNSF: Munic: Rock Island)	1
	IL 92 (1st Ave) @ 17th St (Crossing No. 069601D; RR: BNSF: Munic: Rock Island)	1
	TOTAL	2
X1400214	SPARE RAILROAD, FULL ACTUATED CONTROLLER , SPECIAL	EACH
	Illinois 92 (1st Ave/18th Ave) @ IL 84 (19th St) (Crossing No. 605942B; RR: IAIS; Munic.: Silvis)	1
	ILlinois 92 WB (4th Ave) @ 19th Street (Crossing No. 605930G; RR: IAIS; Munic.: Moline)	1
	IL 92 (1st Ave) @ 18th St (Crossing No. 069600W; RR: BNSF: Munic: Rock Island)	1
	IL 92 (1st Ave) @ 17th St (Crossing No. 069601D; RR: BNSF: Munic: Rock Island)	1
	US 6 @ Patriot Way (Crossing No. 926045S; RR: IAIS; Munic.: Annawan) (Econolite-Cobalt C, Type 2)	2
	TOTAL	6
X7010216	TRAFFIC CONTROL AND PROTECTION, SPECIAL	L SUM
	District 2 wide	1
	TOTAL	1
X8570010	CONTROLLER, TRAFFIC SIGNAL	EACH
	Daimler/US 20 (East Ramp) at South Appleton Rd. (Crossing No. 174678C; RR: UP: Munic.: Belvidere)	2
	TOTAL	2
X8571215	RAILROAD, FULL ACTUATED CONTROLLER AND TYPE IV CABINET	EACH
	ILlinois 92 WB (4th Ave) @ 23rd Street (Crossing No. 605931N ; RR: IAIS; Munic.: Moline)	1
	ILlinois 92 WB (4th Ave) @ 19th Street (Crossing No. 605930G; RR: IAIS; Munic.: Moline)	1
	ILlinois 92 WB (4th Ave) @ 17th Street (Crossing No. 605929M; RR: IAIS; Munic.: Moline)	1
	ILlinois 92 WB (4th Ave) @ 15th Street (Crossing No. 604314S; RR: IAIS; Munic.: Moline)	1
	IL 92 (1st Ave) @ 18th St (Crossing No. 069600W; RR: BNSF: Munic: Rock Island)	1
	IL 92 (1st Ave) @ 17th St (Crossing No. 069601D; RR: BNSF: Munic: Rock Island)	1
	TOTAL	6

PAY ITEM CODE	PAY ITEM	QUANTITY
X8620200	UNINTERRUPTIBLE POWER SUPPLY, SPECIAL	
	US 6 @ Patriot Way (Crossing No. 926045S; RR: IAIS; Munic.: Annawan)	1
	TOTAL	1
X8620250	UNINTERRUPTIBLE POWER SUPPLY AND CABINET, SPECIAL	EACH
	Illinois 92 (1st Ave/18th Ave) @ IL 84 (19th St) (Crossing No. 605942B; RR: IAIS; Munic.: Silvis)	1
	ILlinois 92 WB (4th Ave) @ 23rd Street (Crossing No. 605931N ; RR: IAIS; Munic.: Moline)	1
	ILlinois 92 WB (4th Ave) @ 19th Street (Crossing No. 605930G; RR: IAIS; Munic.: Moline)	1
	ILlinois 92 WB (4th Ave) @ 17th Street (Crossing No. 605929M; RR: IAIS; Munic.: Moline)	1
	ILlinois 92 WB (4th Ave) @ 15th Street (Crossing No. 604314S; RR: IAIS; Munic.: Moline)	1
	IL 92 (1st Ave) @ 18th St (Crossing No. 069600W; RR: BNSF: Munic: Rock Island)	1
	IL 92 (1st Ave) @ 17th St (Crossing No. 069601D; RR: BNSF: Munic: Rock Island)	1
	TOTAL	7
X8950105	REMOVE EXISTING TRAFFIC CONTROLLER AND CABINET	EACH
	ILlinois 92 WB (4th Ave) @ 23rd Street (Crossing No. 605931N ; RR: IAIS; Munic.: Moline)	1
	ILlinois 92 WB (4th Ave) @ 19th Street (Crossing No. 605930G; RR: IAIS; Munic.: Moline)	1
	ILlinois 92 WB (4th Ave) @ 17th Street (Crossing No. 605929M; RR: IAIS; Munic.: Moline)	1
	ILlinois 92 WB (4th Ave) @ 15th Street (Crossing No. 604314S; RR: IAIS; Munic.: Moline)	1
	IL 92 (1st Ave) @ 18th St (Crossing No. 069600W; RR: BNSF: Munic: Rock Island)	1
	IL 92 (1st Ave) @ 17th St (Crossing No. 069601D; RR: BNSF: Munic: Rock Island)	1
	TOTAL	6
X8950114	MODIFY EXISTING CONTROLLER AND CABINET	EACH
	Illinois 92 (1st Ave/18th Ave) @ IL 84 (19th St) (Crossing No. 605942B; RR: IAIS; Munic.: Silvis)	1
	IL 92 (1st Ave) @ 18th St (Crossing No. 069600W; RR: BNSF: Munic: Rock Island)	1
	IL 92 (1st Ave) @ 17th St (Crossing No. 069601D; RR: BNSF: Munic: Rock Island)	1
	Daimler/US 20 (East Ramp) at South Appleton Rd. (Crossing No. 174678C; RR: UP: Munic.: Belvidere)	1
	US 6 @ Patriot Way (Crossing No. 926045S; RR: IAIS; Munic.: Annawan)	1
	TOTAL	5

MODEL Path: C:\Users\drezenp\OneDrive\Documents\092022\092022.dgn
FILE NAME: C:\Users\drezenp\OneDrive\Documents\092022\092022.dgn

USER NAME = drezenp	DESIGNED -	REVISED - P. DREZEN 2/15/22
PLOT SCALE = 40.0000 ' / in.	DRAWN - LD. HILL	REVISED -
PLOT DATE = May-09-2022 04:38:45 PM	CHECKED -	REVISED -
	DATE - 5/7/00	REVISED -

**STATE OF ILLINOIS
DEPARTMENT OF TRANSPORTATION**

SCHEDULE OF QUANTITIES

SCALE: 20 SHEET 3 OF 17 SHEETS STA. TO STA.

F.A.I. RTE.	SECTION	COUNTY	TOTAL SHEETS	SHEET NO.
*	D2 RRI 2022-1	VARIOUS	17	3
CONTRACT NO. 64R59			ILLINOIS FED. AID PROJECT	

FOR INFORMATION ONLY

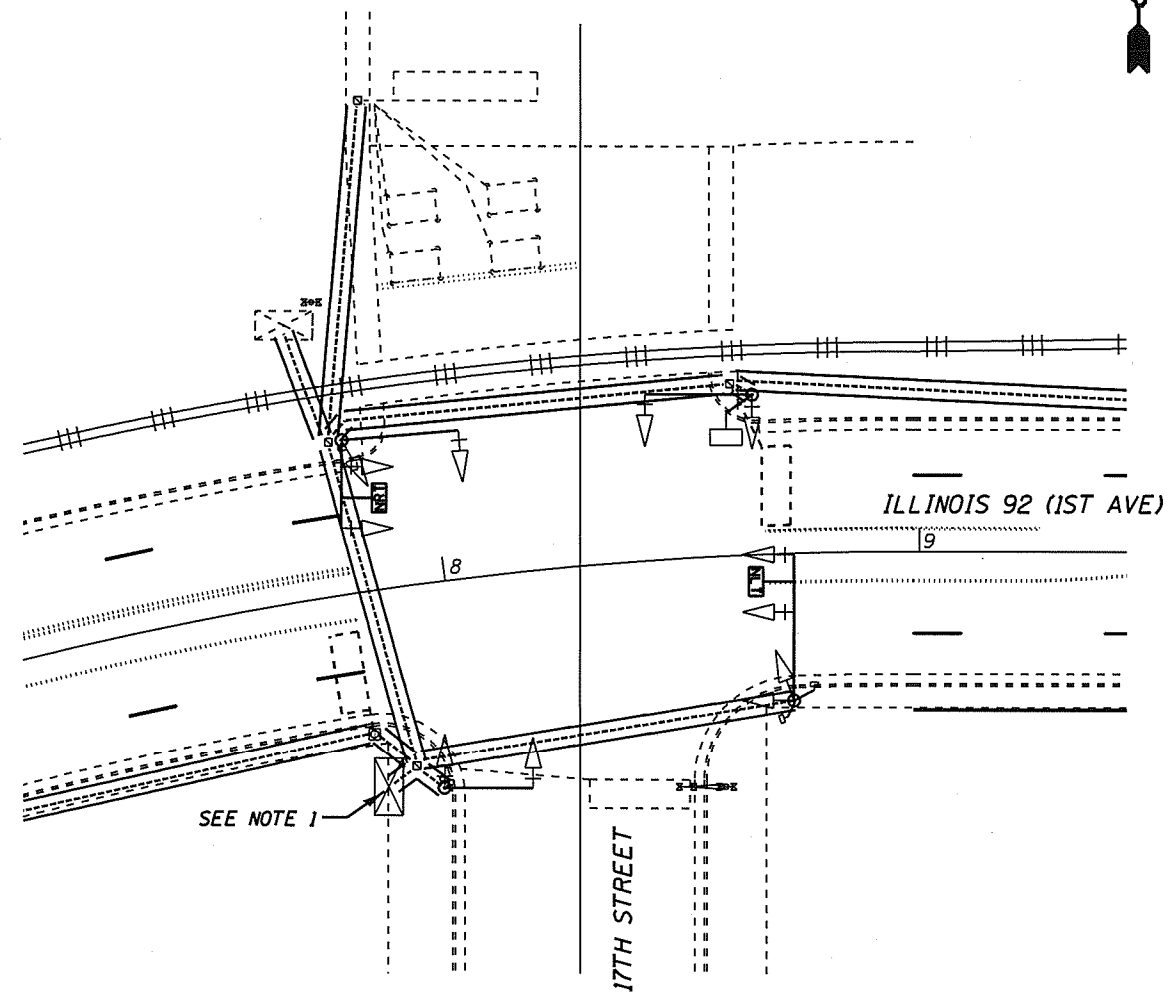

LEGEND

- EXISTING CONTROLLER
- NEW CONTROLLER
- EXISTING ALUMINUM MAST ARM ASSEMBLY AND POLE
- EXISTING STEEL MAST ARM ASSEMBLY AND POLE
- EXISTING SIGNAL HEAD AND POST
- EXISTING SIGNAL HEAD
- EXISTING PEDESTRIAN HEAD
- EXISTING HANDHOLE
- EXISTING CONDUIT (LENGTH AND SIZE)
- GALVANIZED STEEL OR PVC CONDUIT
UPPER NUMERAL INDICATES LENGTH
"T" INDICATES CONDUIT IN TRENCH
"P" INDICATES CONDUIT PUSHED
LOWER NUMERAL INDICATES SIZE AND TYPE
- NO RIGHT TURN (ILLUMINATED SIGN - FIBER OPTIC)
- NO LEFT TURN (ILLUMINATED SIGN - FIBER OPTIC)

NOTES

1. DISCONNECT AND SAFELY REMOVE THE EXISTING CONTROLLER AND CABINET. INSTALL, TEST, TROUBLESHOOT, AND PLACE INTO OPERATION ONE (1) RAILROAD, FULL ACTUATED CONTROLLER AND TYPE IV CABINET, SPECIAL.
2. INSTALL, TEST, TROUBLESHOOT, AND PLACE INTO OPERATION ONE (1) SPARE, RAILROAD, FULL ACTUATED CONTROLLER, SPECIAL.
3. DISCONNECT AND SAFELY REMOVE THE EXISTING CMU/MMU. INSTALL, TEST, TROUBLESHOOT, AND PLACE INTO OPERATION ONE (1) NEW MALFUNCTION MANAGEMENT UNIT (MMU).
4. INSTALL, TEST, TROUBLESHOOT, AND PLACE INTO OPERATION ONE (1) NEW UNINTERRUPTED POWER SUPPLY (UPS) AND CABINET, SPECIAL.
5. REMOVE EXISTING VIDEO DETECTION EQUIPMENT WITHIN THE EXISTING CABINET AND REINSTALL, TEST, TROUBLESHOOT, AND PLACE INTO OPERATION IN THE NEW CABINET. THE EXISTING VIDEO DETECTION CAMERA DOES NOT GET MOVED - IT WILL REMAIN IN PLACE.
6. EXISTING TYPE D FOUNDATION DIMENSIONS: 48" x 30"
7. STORE CONTROLLERS, CABINETS, CMU/MMU, AND ANY OTHER EQUIPMENT IN A DRY SECURE LOCATION. COORDINATE WITH MUNICIPAL REPRESENTATIVE FOR DELIVERY OR PICKUP OF SAID ITEMS. POC: TIM KAVANAUGH (563) 524-3203 OR LUKE VAN LANDEGEN (309) 732-2261 FROM THE CITY OF ROCK ISLAND.

MODEL: Default
 FILE NAME: C:\Users\drezenpe\Desktop\092097999_r0af_plan.dwg

USER NAME = drezenpe	DESIGNED -	REVISED - P. DREZEN 2/15/22
	DRAWN - L.D. HILL	REVISED -
PLOT SCALE = 40,0000' / 1 in.	CHECKED -	REVISED -
PLOT DATE = May-09-2022 04:40:02 PM	DATE - 5/17/00	REVISED -

STATE OF ILLINOIS
DEPARTMENT OF TRANSPORTATION

ILLINOIS 92 (1ST AVE) AT 17TH ST PLAN SHEET		F.A.I. RTE.	SECTION	COUNTY	TOTAL SHEETS	SHEET NO.
			D2 RRI 2022-1	VARIOUS	17	4
		CONTRACT NO. 64R59				
SCALE: 20	SHEET 4 OF 17 SHEETS	STA.	TO STA.			
		ILLINOIS FED. AID PROJECT				

FOR INFORMATION ONLY

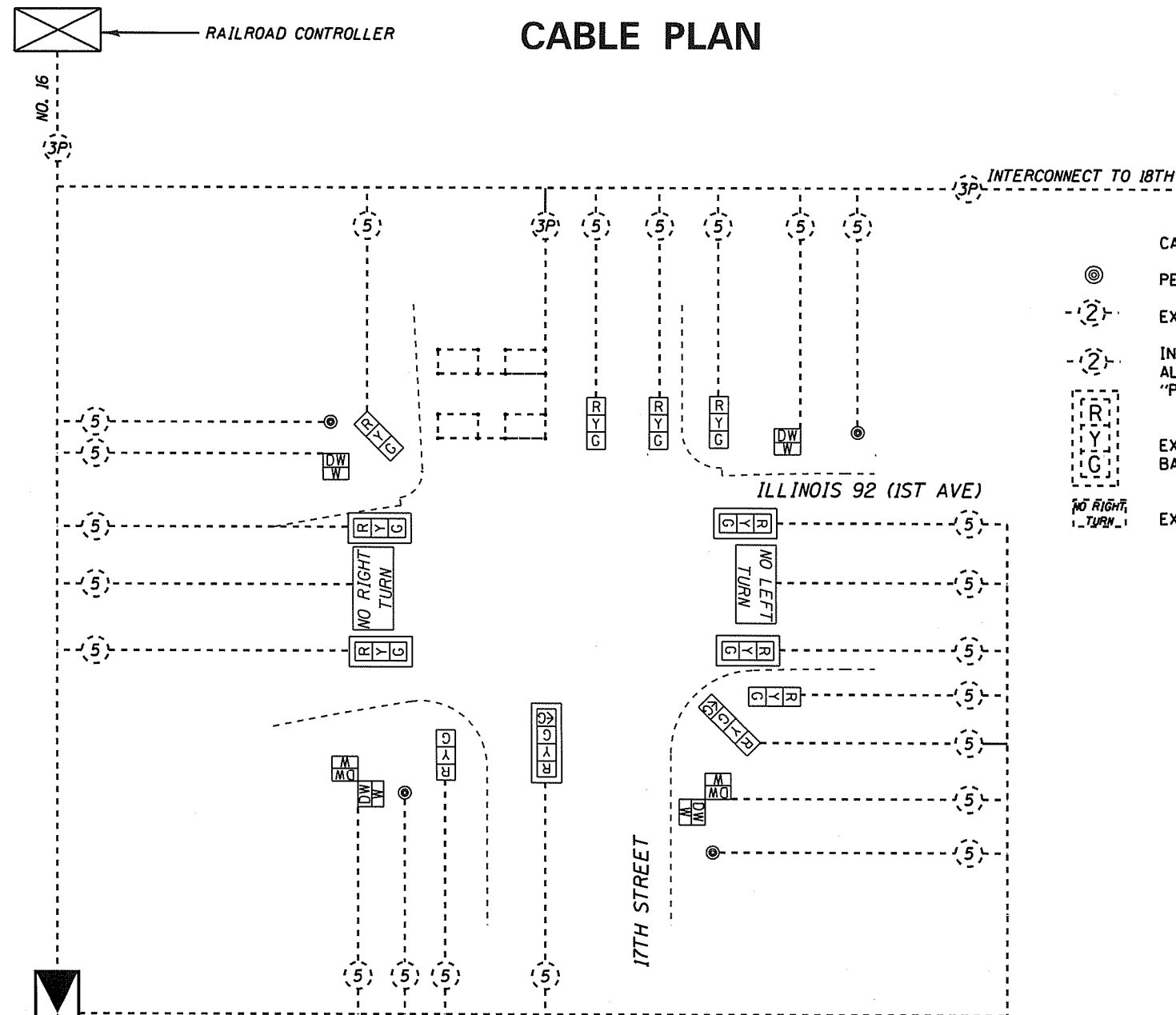

- CABLE PLAN LEGEND**
- ⊙ PED BUTTON
 - 2- EXISTING CABLE TO REMAIN
 - 2- INDICATES NUMBER OF NEW CONDUCTORS. ALL CABLE IS NO. 14 EXCEPT AS INDICATED. "P" INDICATES PAIR CABLE
 - [RY G] EXISTING SIGNAL HEAD WITH OR WITHOUT BACK PLATE
 - [NO RIGHT TURN] EXISTING ILLUMINATED FIBER-OPTIC SIGN

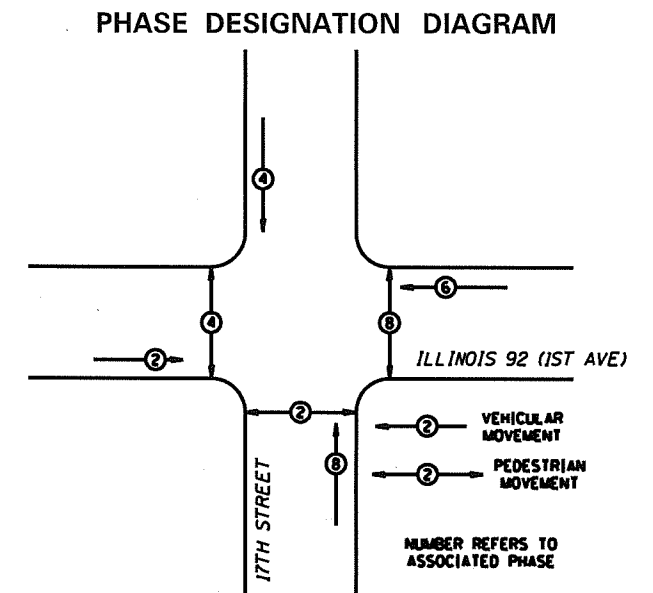

REFER TO STANDARD 857001

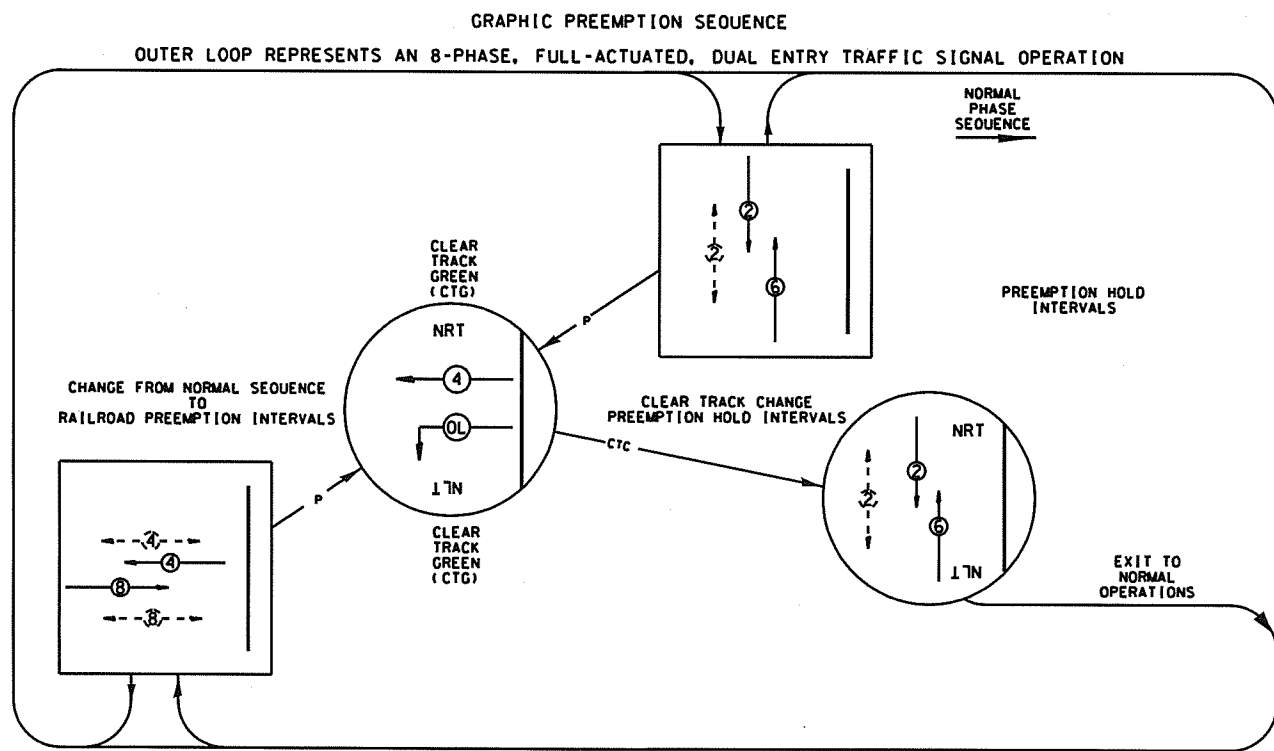

RAILROAD GRADE CROSSING PREEMPTION

RIGHT - of - WAY CHANGE INTERVALS

SIGNAL PHASE #	RIGHT - of - WAY CHANGE INTERVALS				CLEAR TRACK INTERVALS		PREEMPTION PHASES	EXIT TO NORMAL OPERATION
	Ø2 & Ø6	Ø4 & Ø8	ØL Ø4	CL	CTG	CTC		
ØG to RR CL	ØG	ØG	ØG	ØG	DARK	DARK	R	R
Ø2	G	Y	R	R	DARK	DARK	R	R
Ø4	R	R	G	G	DARK	DARK	G	Y
Ø6	G	Y	R	R	DARK	DARK	R	R
Ø8	R	R	G	Y	DARK	DARK	R	R
OL Ø4	DARK	DARK	DARK	DARK	DARK	DARK	← G	DARK
PED								
Ø2	W	FL DW	DW	DW			DW	DW
Ø4	DW	DW	W	FL DW			DW	DW
Ø8	DW	DW	W	FL DW			DW	DW
NLT SIGN	OFF	ON	OFF	ON			ON	ON
NRT SIGN	OFF	ON	OFF	ON			ON	ON

• THE TRACK CLEAR SHALL BE FOLLOWED BY AN ALL "RED" CLEARANCE.

MODEL: Default
FILE NAME: C:\Users\drezenpe\Desktop\092022\092022-1\17th-trat-plan.dgn

USER NAME = drezenpe	DESIGNED -	REVISED - P. DREZEN 2/15/22
PLOT SCALE = 40.0000' / in.	DRAWN - L.D. HILL	REVISED -
PLOT DATE = May-09-2022 04:40:35 PM	CHECKED -	REVISED -
	DATE - 5/17/00	REVISED -

STATE OF ILLINOIS
DEPARTMENT OF TRANSPORTATION

ILLINOIS 92 (1ST AVE) AT 17TH ST
SEQUENCE OF OPERATION AND CABLE PLAN
SCALE: 20 SHEET 5 OF 17 SHEETS STA. TO STA.

F.A.L. RTE.	SECTION	COUNTY	TOTAL SHEETS	SHEET NO.
	D2 RRI 2022-1	VARIOUS	17	5
CONTRACT NO. 64R59			ILLINOIS FED. AID PROJECT	

FOR INFORMATION ONLY

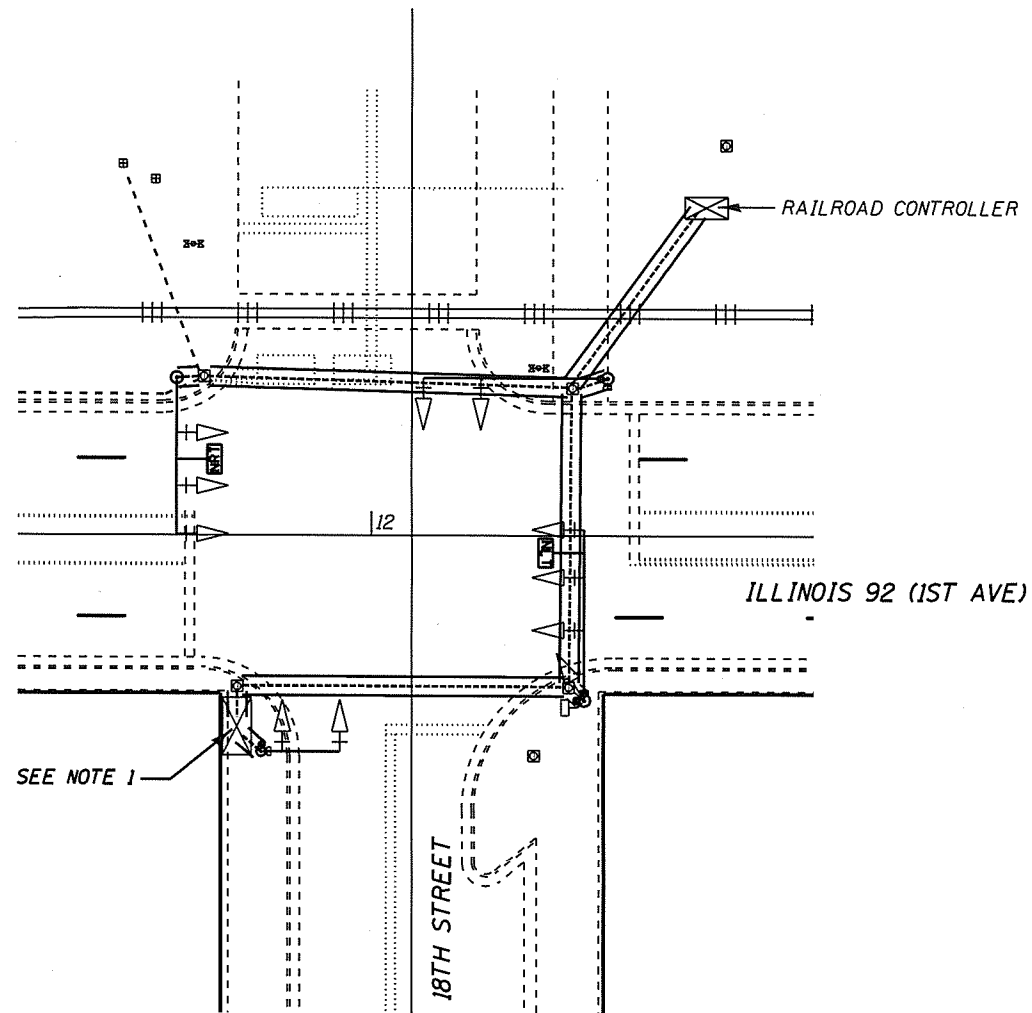

LEGEND

- EXISTING CONTROLLER
- NEW CONTROLLER
- EXISTING ALUMINUM MAST ARM ASSEMBLY AND POLE
- EXISTING STEEL MAST ARM ASSEMBLY AND POLE
- EXISTING SIGNAL HEAD AND POST
- EXISTING SIGNAL HEAD
- EXISTING PEDESTRIAN HEAD
- EXISTING HANDHOLE
- EXISTING CONDUIT (LENGTH AND SIZE)
- GALVANIZED STEEL OR PVC CONDUIT
UPPER NUMERAL INDICATES LENGTH
"T" INDICATES CONDUIT IN TRENCH
"P" INDICATES CONDUIT PUSHED
LOWER NUMERAL INDICATES SIZE AND TYPE
- NRT NO RIGHT TURN (ILLUMINATED SIGN - FIBER OPTIC)
- NLT NO LEFT TURN (ILLUMINATED SIGN - FIBER OPTIC)

NOTES

1. DISCONNECT AND SAFELY REMOVE THE EXISTING CONTROLLER AND CABINET. INSTALL, TEST, TROUBLESHOOT, AND PLACE INTO OPERATION ONE (1) RAILROAD, FULL ACTUATED CONTROLLER AND TYPE IV CABINET, SPECIAL.
2. INSTALL, TEST, TROUBLESHOOT, AND PLACE INTO OPERATION ONE (1) SPARE, RAILROAD, FULL ACTUATED CONTROLLER, SPECIAL.
3. DISCONNECT AND SAFELY REMOVE THE EXISTING CMU/MMU. INSTALL, TEST, TROUBLESHOOT, AND PLACE INTO OPERATION ONE (1) NEW MALFUNCTION MANAGEMENT UNIT (MMU).
4. INSTALL, TEST, TROUBLESHOOT, AND PLACE INTO OPERATION ONE (1) NEW UNINTERRUPTED POWER SUPPLY (UPS) AND CABINET, SPECIAL.
5. REMOVE EXISTING VIDEO DETECTION EQUIPMENT WITHIN THE EXISTING CABINET AND REINSTALL, TEST, TROUBLESHOOT, AND PLACE INTO OPERATION IN THE NEW CABINET. THE EXISTING VIDEO DETECTION CAMERA DOES NOT GET MOVED-IT REMAINS IN PLACE.
6. EXISTING TYPE D FOUNDATION DIMENSIONS: 48" x 30"
7. STORE CONTROLLERS, CABINETS, CMU/MMU, AND ANY OTHER EQUIPMENT IN A DRY SECURE LOCATION. COORDINATE WITH MUNICIPAL REPRESENTATIVE FOR DELIVERY OR PICKUP OF SAID ITEMS. POC: TIM KAVANAUGH (563) 524-3203 OR LUKE VAN LANDEGEN (309) 732-2261 FROM THE CITY OF ROCK ISLAND.

**STATE OF ILLINOIS
DEPARTMENT OF TRANSPORTATION**

ILLINOIS 92 (1ST AVE) AT 18TH ST
PLAN SHEET AND CABINET DETAIL

SCALE: 20 SHEET 6 OF 17 SHEETS STA. TO STA.

F.A.I. RTE.	SECTION	COUNTY	TOTAL SHEETS	SHEET NO.
•	D2 RRI 2022-1	VARIOUS	17	6
CONTRACT NO. 64R59				
ILLINOIS FED. AID PROJECT				

USER NAME = drezenpe	DESIGNED -	REVISED - P. DREZEN 2/15/22
	DRAWN - L.D. HILL	REVISED -
PLOT SCALE = 40.0000' / in.	CHECKED -	REVISED -
PLOT DATE = May-09-2022 04:41:06 PM	DATE - 5/17/00	REVISED -

MODEL: Default
FILE NAME: c:\users\drezenpe\desktop\18092709\plan.dwg

FOR INFORMATION ONLY

CABLE PLAN

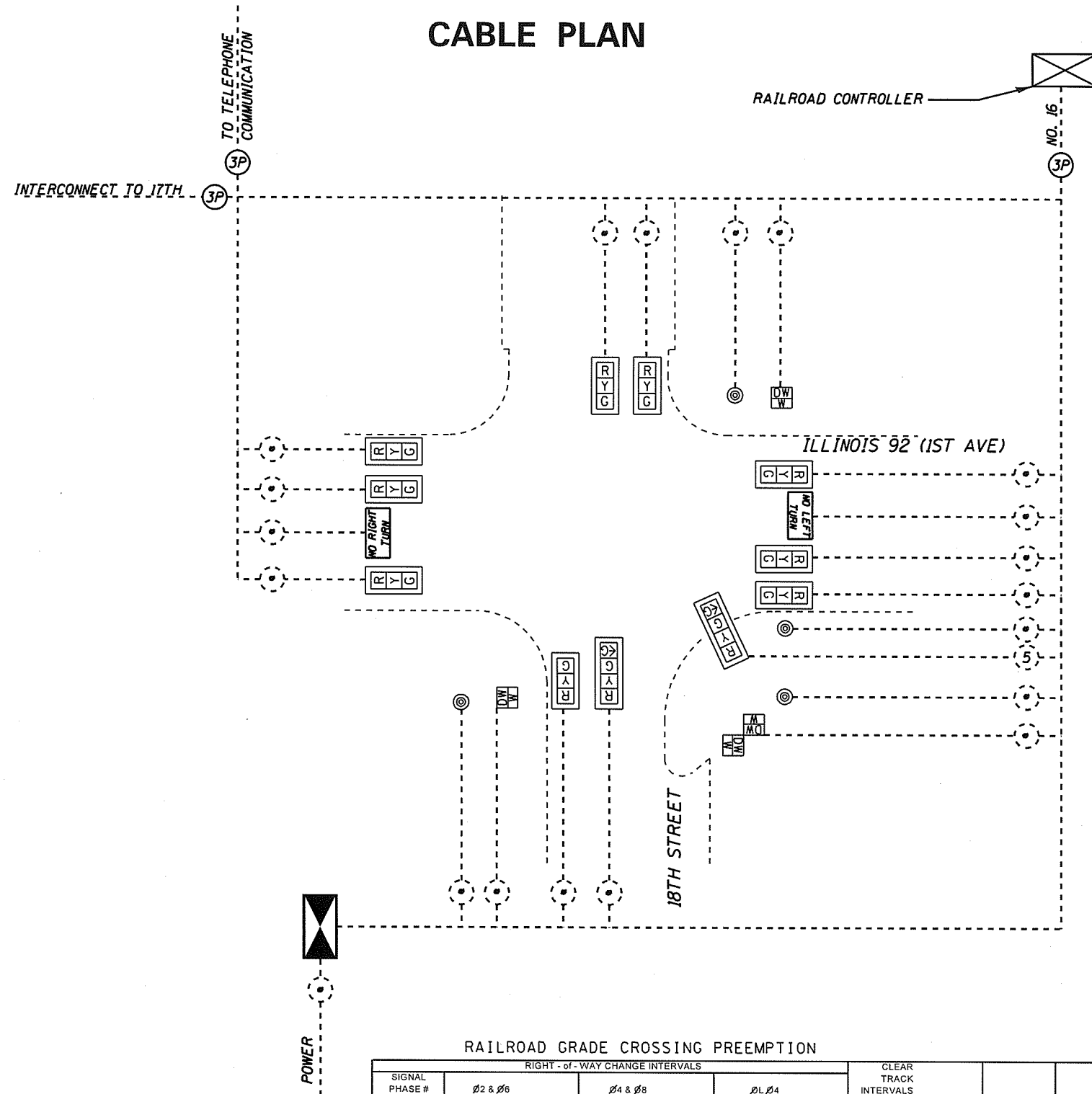

PHASE DESIGNATION DIAGRAM

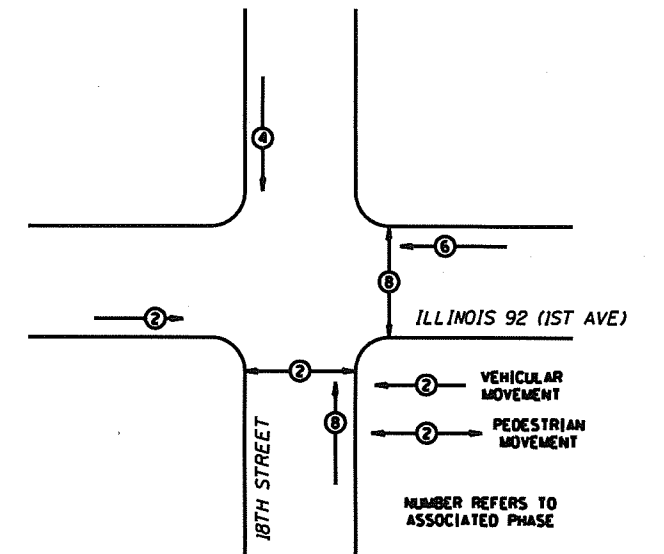

REFER TO STANDARD 857001

- CABLE PLAN LEGEND**
- ⊙ PED BUTTON
 - (2)- EXISTING CABLE TO REMAIN
 - (2)- INDICATES NUMBER OF NEW CONDUCTORS. ALL CABLE IS NO. 14 EXCEPT AS INDICATED. "P" INDICATES PAIR CABLE
 - [R Y G] EXISTING SIGNAL HEAD WITH OR WITHOUT BACK PLATE
 - [NO RIGHT TURN] EXISTING ILLUMINATED FIBER-OPTIC SIGN

GRAPHIC PREEMPTION SEQUENCE

OUTER LOOP REPRESENTS AN 8-PHASE, FULL-ACTUATED, DUAL ENTRY TRAFFIC SIGNAL OPERATION

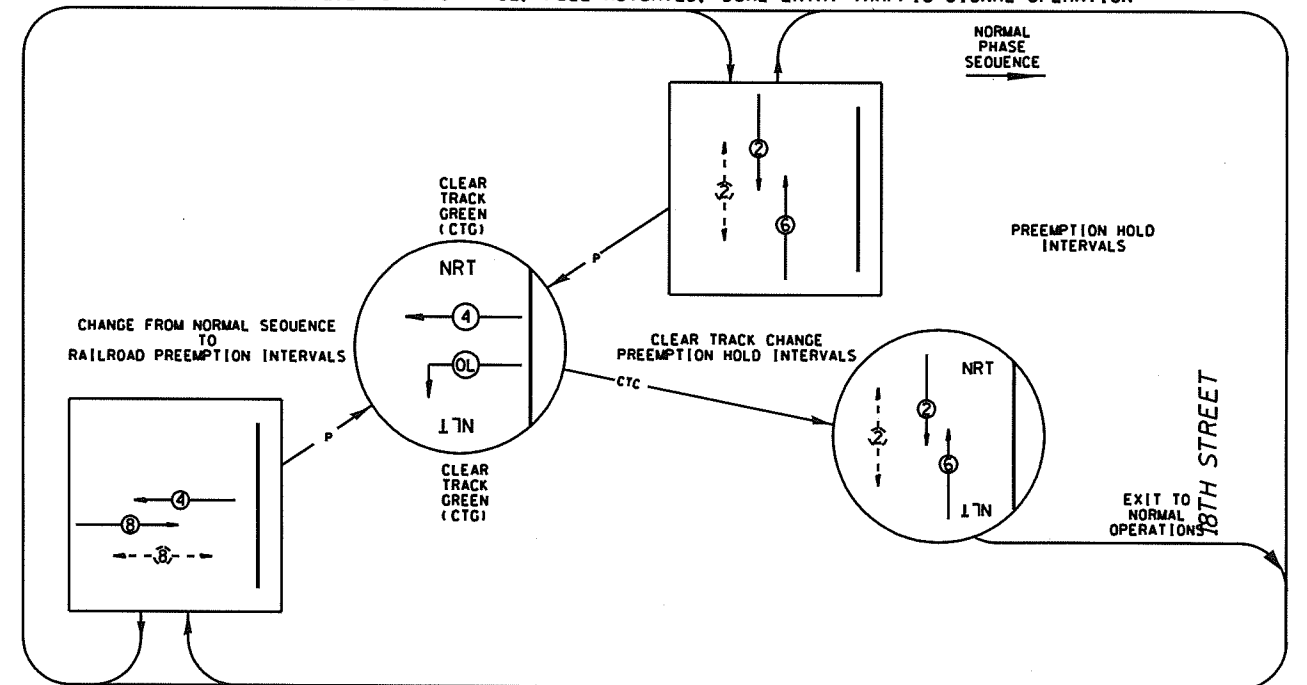

RAILROAD GRADE CROSSING PREEMPTION

SIGNAL PHASE #	RIGHT-OF-WAY CHANGE INTERVALS				CLEAR TRACK INTERVALS		PREEMPTION INTERVALS	EXIT PHASES TO NORMAL OPERATION
	Ø2 & Ø6	CL	Ø4 & Ø8	CL	ØG	CL		
Ø2	G	Y	R	R	DARK	DARK	R	R
Ø4	R	R	G	G	DARK	DARK	R	Y
Ø6	G	Y	R	R	DARK	DARK	R	R
Ø8	R	R	G	Y	DARK	DARK	R	R
OL Ø4	DARK	DARK	DARK	DARK	DARK	DARK	← G	DARK
PED								
Ø2	W	FL DW	DW	DW			DW	DW
Ø4	DW	DW	W	FL DW			DW	DW
Ø8	DW	DW	W	FL DW			DW	DW
NLT SIGN	OFF	ON	OFF	ON			ON	ON
NRT SIGN	OFF	ON	OFF	ON			ON	ON

• THE TRACK CLEAR SHALL BE FOLLOWED BY AN ALL "RED" CLEARANCE.

STATE OF ILLINOIS
DEPARTMENT OF TRANSPORTATION

ILLINOIS 92 (1ST AVE) AT 18TH ST
SEQUENCE OF OPERATION AND CABLE PLAN

F.A.I. RTE.	SECTION	COUNTY	TOTAL SHEETS	SHEET NO.
	D2 RRI 2022-1	VARIOUS	17	7
CONTRACT NO. 64R59			ILLINOIS FED. AID PROJECT	

SCALE: 20 SHEET 7 OF 17 SHEETS STA. TO STA.

USER NAME = drezenp	DESIGNED -	REVISED - P. DREZEN 2/15/22
	DRAWN - L.D. HILL	REVISED -
PLOT SCALE = 40.0000' / in.	CHECKED -	REVISED -
PLOT DATE = May-09-2022 04:41:34 PM	DATE - 5/17/00	REVISED -

FOR INFORMATION ONLY

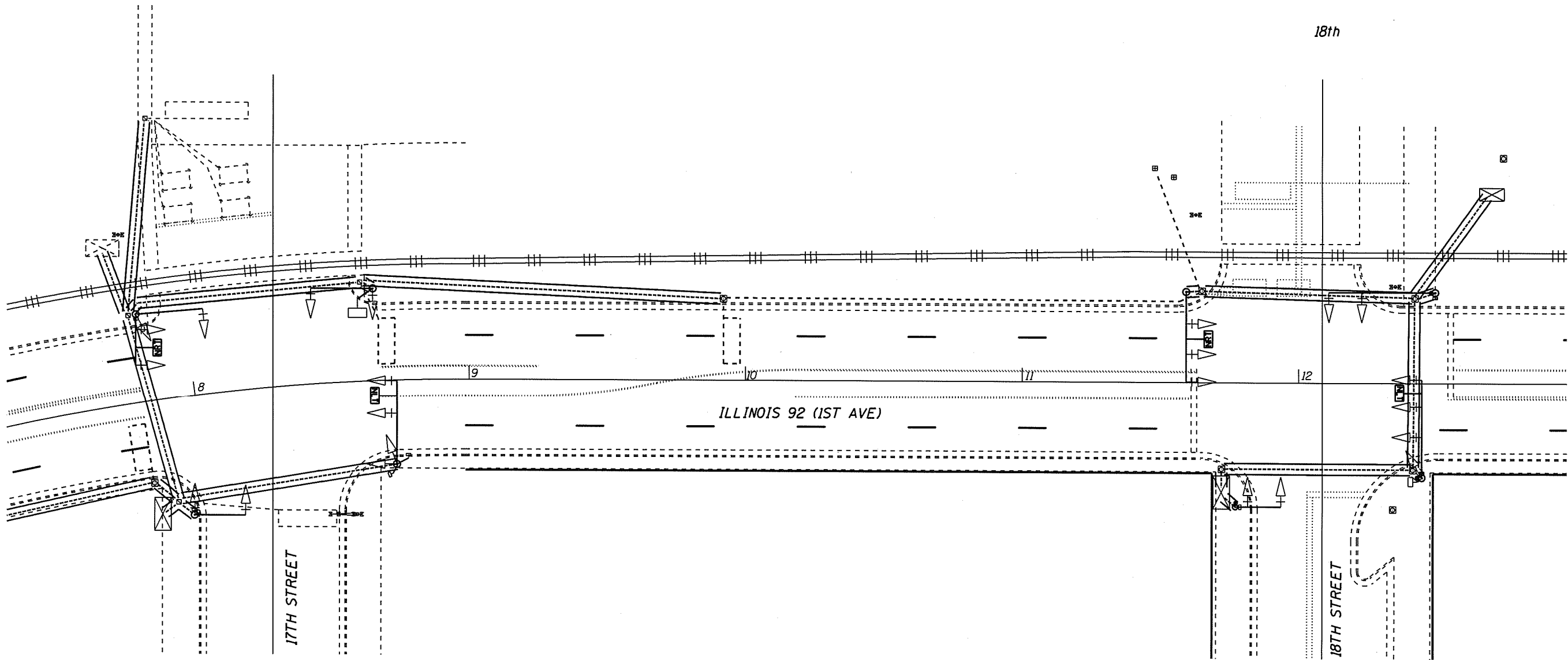

MODEL: Default
 FILE NAME: C:\Users\drezenpe\Desktop\Illinois92\17th-18th-Interconnect\plan.dwg

USER NAME = drezenpe	DESIGNED -	REVISED - P. DREZEN 2/15/22
	DRAWN - L.D. HILL	REVISED -
PLOT SCALE = 40.0000' / in.	CHECKED -	REVISED -
PLOT DATE = May-09-2022 04:42:15 PM	DATE - 5/17/00	REVISED -

STATE OF ILLINOIS
DEPARTMENT OF TRANSPORTATION

ILLINOIS 92 (1ST AVE) INTERCONNECT BETWEEN 17TH
ST AND 18TH ST

SCALE: 20 SHEET 8 OF 17 SHEETS STA. TO STA.

F.A.I. RTE.	SECTION	COUNTY	TOTAL SHEETS	SHEET NO.
*	D2 RRI 2022-1	VARIOUS	17	8
CONTRACT NO. 64R59				
ILLINOIS FED. AID PROJECT				

FOR INFORMATION ONLY

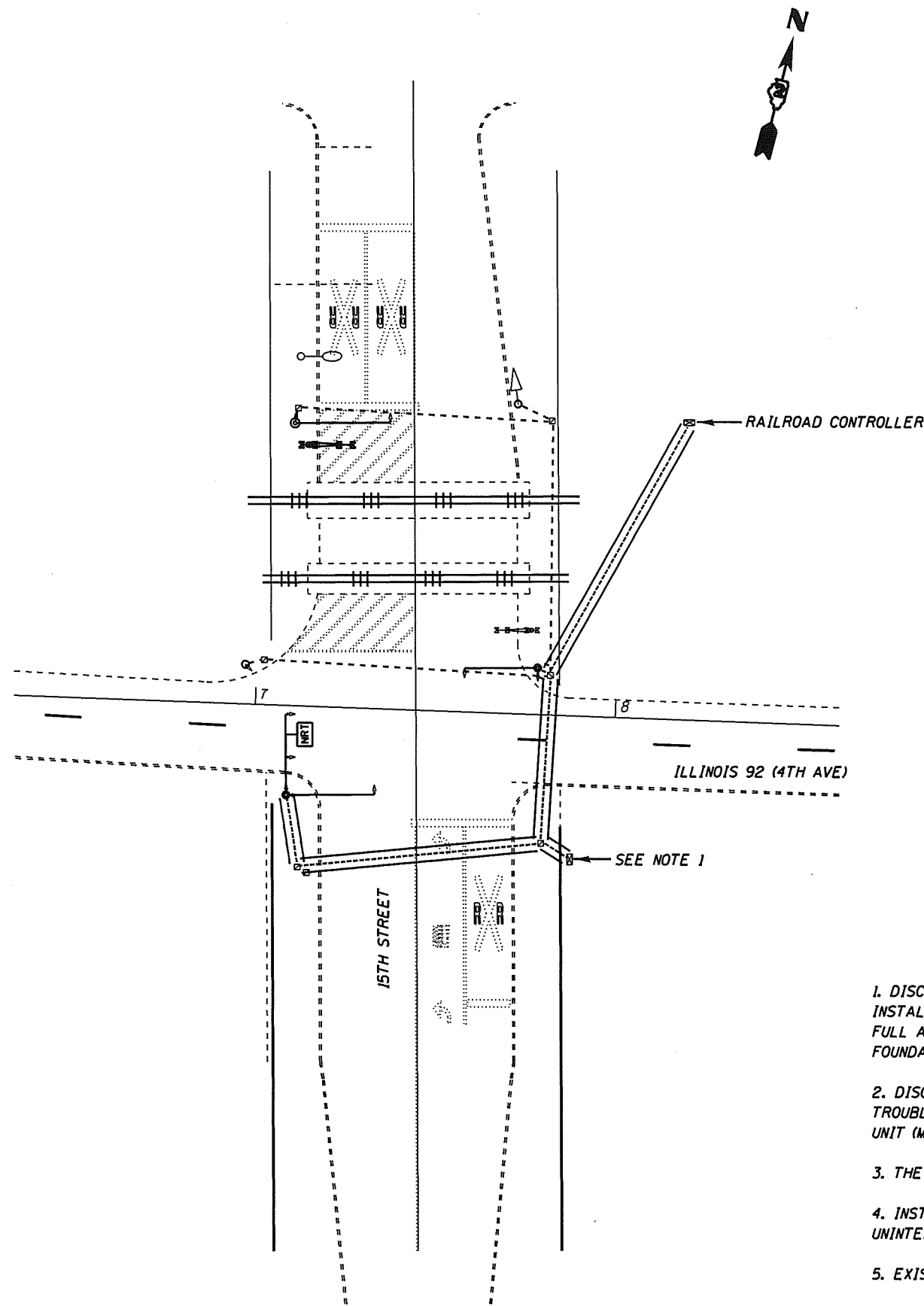

LEGEND

- EXISTING CONTROLLER
- NEW CONTROLLER
- EXISTING ALUMINUM MAST ARM ASSEMBLY AND POLE
- EXISTING STEEL MAST ARM ASSEMBLY AND POLE
- EXISTING SIGNAL HEAD AND POST
- EXISTING SIGNAL HEAD
- EXISTING PEDESTRIAN HEAD
- EXISTING HANDHOLE
- EXISTING CONDUIT (LENGTH AND SIZE)
- GALVANIZED STEEL OR PVC CONDUIT
- UPPER NUMERAL INDICATES LENGTH
"T" INDICATES CONDUIT IN TRENCH
- "P" INDICATES CONDUIT PUSHED
LOWER NUMERAL INDICATES SIZE AND TYPE
- NRT NO RIGHT TURN (ILLUMINATED SIGN - FIBER OPTIC)
- NLT NO LEFT TURN (ILLUMINATED SIGN - FIBER OPTIC)

NOTES

1. DISCONNECT AND SAFELY REMOVE THE EXISTING CONTROLLER AND CABINET. INSTALL, TEST, TROUBLESHOOT, AND PLACE INTO OPERATION ONE (1) RAILROAD, FULL ACTUATED CONTROLLER AND TYPE IV CABINET, SPECIAL ON THE EXISTING FOUNDATION.
2. DISCONNECT AND SAFELY REMOVE THE EXISTING CMU/MMU. INSTALL, TEST, TROUBLESHOOT, AND PLACE INTO OPERATION ONE (1) NEW MALFUNCTION MANAGEMENT UNIT (MMU).
3. THE EXISTING CONTROLLER WILL BECOME THE SPARE CONTROLLER.
4. INSTALL, TEST, TROUBLESHOOT, AND PLACE INTO OPERATION ONE (1) UNINTERRUPTABLE POWER SUPPLY AND CABINET, SPECIAL.
5. EXISTING TYPE D FOUNDATION DIMENSIONS: 48" x 30"
6. STORE CONTROLLERS, CMU/MMU, AND CABINETS IN A DRY SECURE LOCATION. COORDINATE WITH MUNICIPAL REPRESENTATIVE FOR DELIVERY OR PICKUP. POC: Mr. JOSH WHITING AT (309) 429-5153 FROMM THE CITY OF MOLINE.

MODEL: Default
FILE NAME: C:\Users\drezenpe\Desktop\DR20220929\15th.rvt

USER NAME = drezenpe	DESIGNED -	REVISED - P. DREZEN 2/15/22
	DRAWN - L.D. HILL	REVISED -
PLOT SCALE = 40,0000' / in.	CHECKED -	REVISED -
PLOT DATE = May-09-2022 04:42:41 PM	DATE - 5/17/20	REVISED -

**STATE OF ILLINOIS
DEPARTMENT OF TRANSPORTATION**

ILLINOIS 92 (4TH AVE) AT 15TH ST PLAN SHEET

SCALE: 20 SHEET 9 OF 17 SHEETS STA. TO STA.

F.A.I. RTE.	SECTION	COUNTY	TOTAL SHEETS	SHEET NO.
*	D2 RRI 2022-1	VARIOUS	17	9
			CONTRACT NO. 64R59	
ILLINOIS FED. AID PROJECT				

FOR INFORMATION ONLY

CABLE PLAN

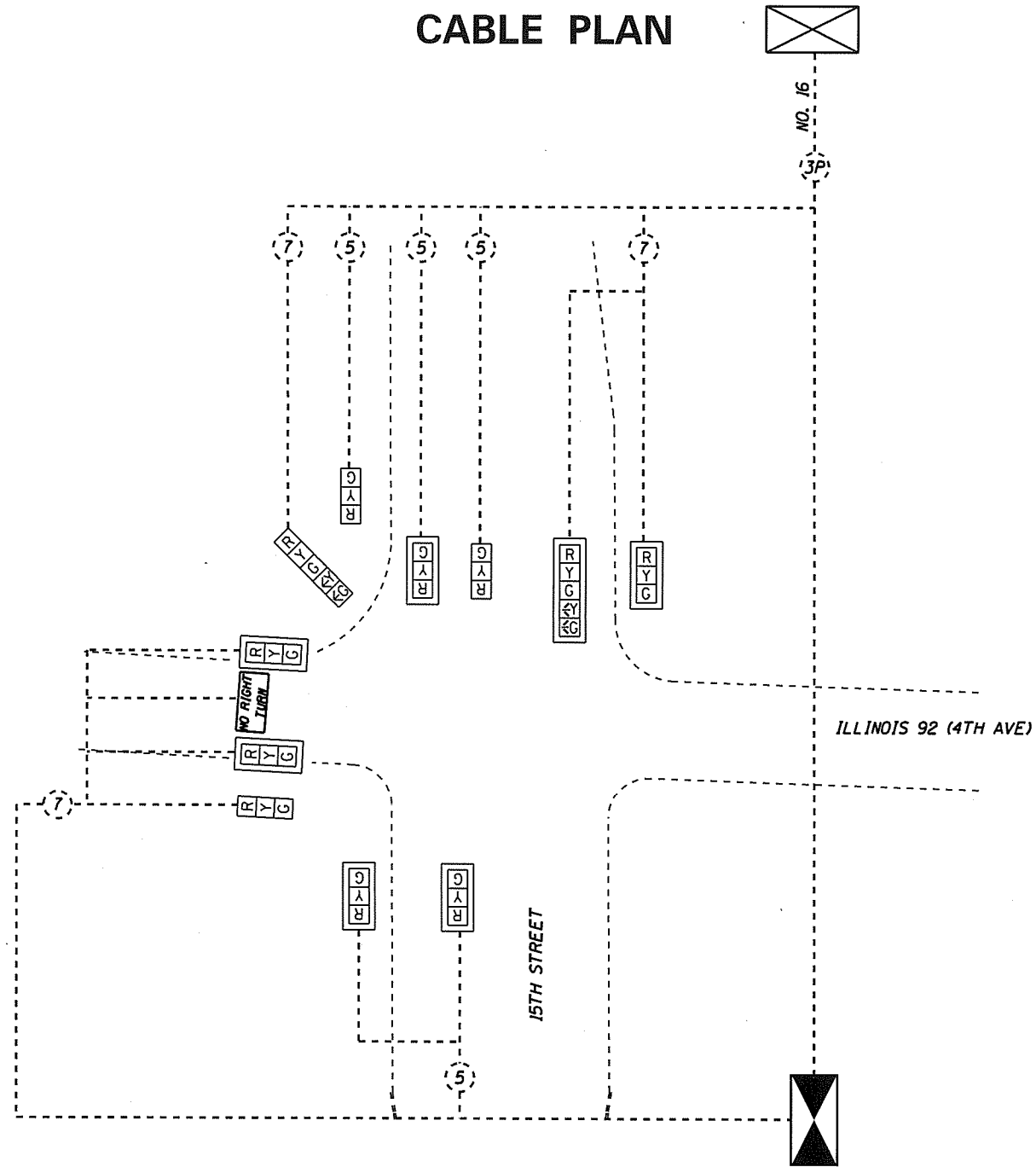

- CABLE PLAN LEGEND**
- ⊙ PED BUTTON
 - (2) - EXISTING CABLE TO REMAIN
 - (2) - INDICATES NUMBER OF NEW CONDUCTORS. ALL CABLE IS NO. 14 EXCEPT AS INDICATED. "P" INDICATES PAIR CABLE
 - [R Y G] EXISTING SIGNAL HEAD WITH OR WITHOUT BACK PLATE
 - [NO RIGHT TURN] EXISTING ILLUMINATED FIBER-OPTIC SIGN

PHASE DESIGNATION DIAGRAM

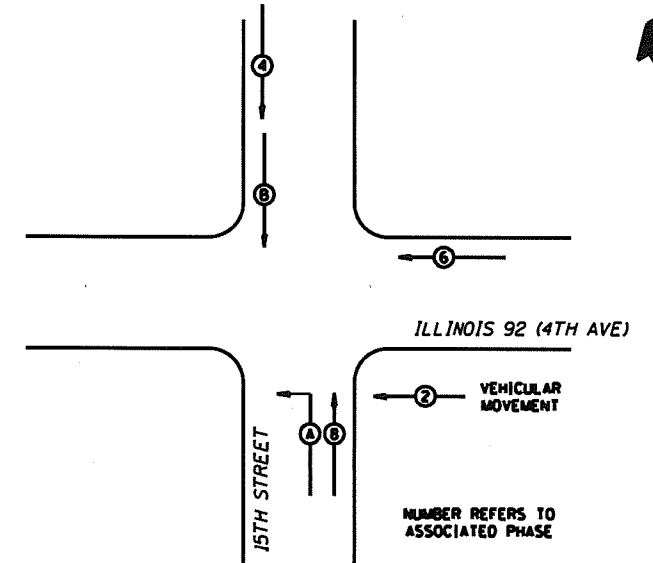

REFER TO STANDARD 857001

GRAPHIC PREEMPTION SEQUENCE

OUTER LOOP REPRESENTS AN 8-PHASE, FULL-ACTUATED, DUAL ENTRY TRAFFIC SIGNAL OPERATION

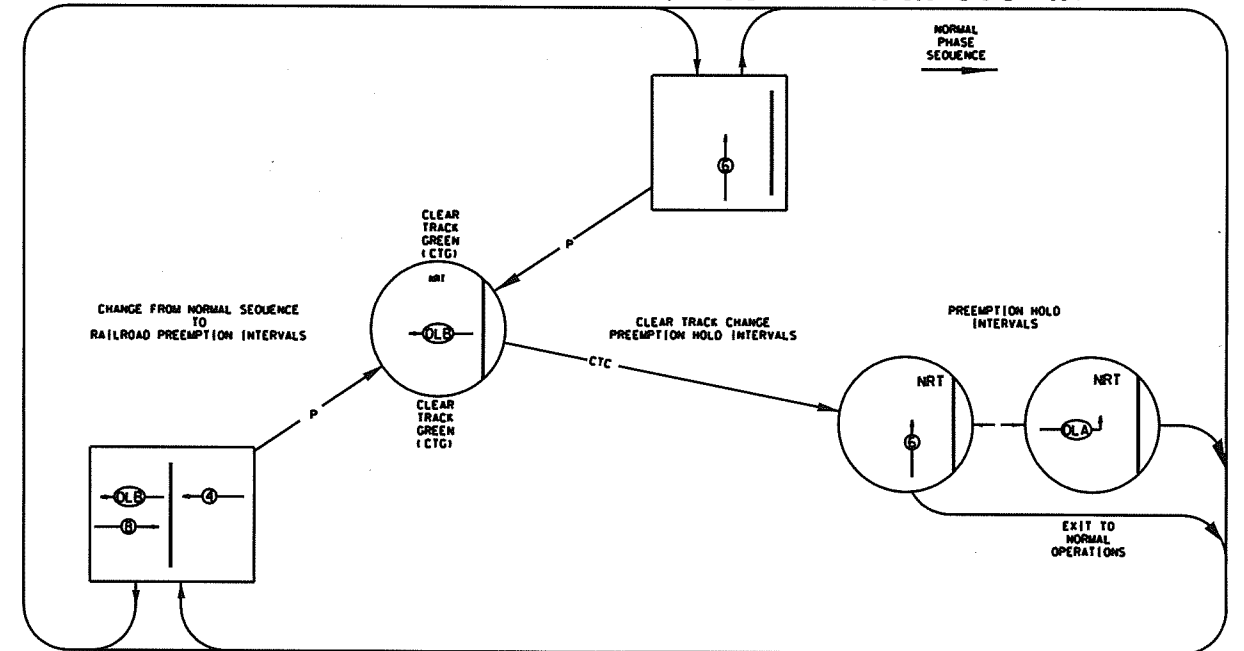

OVERLAP "A" IS ACTIVE ONLY DURING THE PREEMPTION HOLD INTERVAL

RAILROAD GRADE CROSSING PREEMPTION

SIGNAL PHASE #	RIGHT - of - WAY CHANGE INTERVALS				CLEAR TRACK INTERVALS				PREEMPTION HOLD INTERVALS	EXIT TO NORMAL OPERATION
	Ø6	Ø4	Ø8	OLB	Ø6	Ø4 & Ø8	Ø6	Ø4		
Ø4 to RR CL	ØG	CL	ØG	CL	ØG	CL	CTG	CTC **		
Ø4	R	R	G	Y	R	R	R	R		
Ø6	G	Y	R	R	R	R	R	R		
Ø8	R	R	G	Y	R	R	R	R		
OLA*	DARK	DARK	DARK	DARK	DARK	DARK	DARK	DARK		
OLB	R	R	G	G	G	G	G	Y		
NRT SIGN	OFF	ON	OFF	ON			ON	ON		

- * "OL "A"" IS ONLY ACTIVE DURING THE PREEMPTION HOLD INTERVAL
- ** THE TRACK CLEAR SHALL BE FOLLOWED BY AN ALL "RED" CLEARANCE

MODEL: Default
FILE NAME: C:\Users\drezenp\Documents\Illinois 92 at 15th St.dgn

USER NAME = drezenp	DESIGNED -	REVISED - P. DREZEN 2/15/22
PLOT SCALE = 40,000' / in.	DRAWN - L.D. HILL	REVISED -
PLOT DATE = May-09-2022 04:43:14 PM	CHECKED -	REVISED -
	DATE - 5/17/00	REVISED -

STATE OF ILLINOIS
DEPARTMENT OF TRANSPORTATION

ILLINOIS 92 AT 15TH ST	
SEQUENCE OF OPERATION AND CABLE PLAN	
SCALE: 20	SHEET 10 OF 17 SHEETS

F.A.I. RTE.	SECTION	COUNTY	TOTAL SHEETS	SHEET NO.
.	D2 RRI 2022-1	VARIOUS	17	10
CONTRACT NO. 64R59				
ILLINOIS FED. AID PROJECT				

FOR INFORMATION ONLY

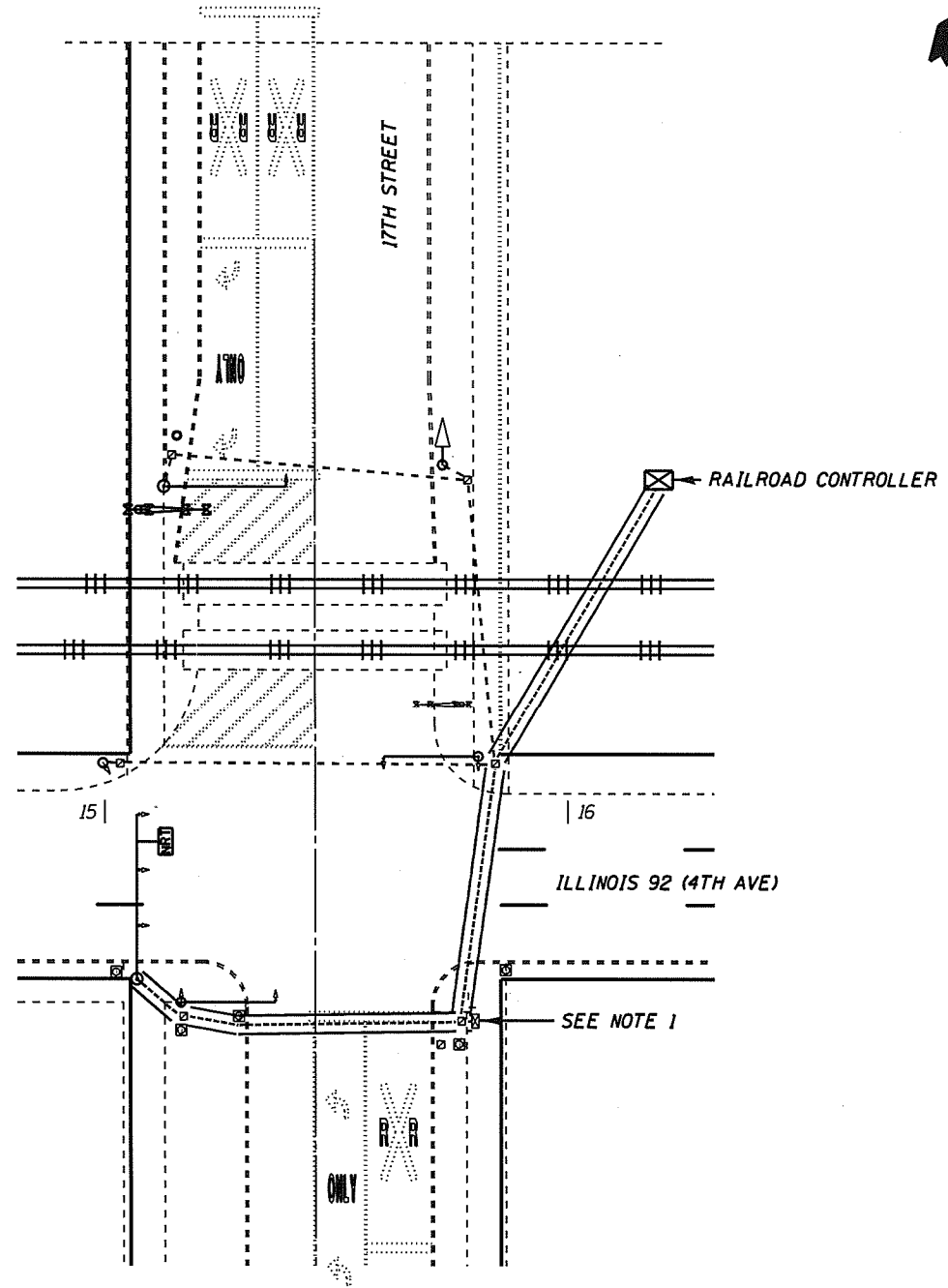

LEGEND

- EXISTING CONTROLLER
- NEW CONTROLLER
- EXISTING ALUMINUM MAST ARM ASSEMBLY AND POLE
- EXISTING STEEL MAST ARM ASSEMBLY AND POLE
- EXISTING SIGNAL HEAD AND POST
- EXISTING SIGNAL HEAD
- EXISTING PEDESTRIAN HEAD
- EXISTING HANDHOLE
-
-
-
-
- NO RIGHT TURN (ILLUMINATED SIGN - FIBER OPTIC)
- NO LEFT TURN (ILLUMINATED SIGN - FIBER OPTIC)

NOTES

1. DISCONNECT AND SAFELY REMOVE THE EXISTING CONTROLLER AND CABINET. INSTALL, TEST, TROUBLESHOOT, AND PLACE INTO OPERATION ONE (1) RAILROAD, FULL ACTUATED CONTROLLER AND TYPE IV CABINET, SPECIAL ON THE EXISTING FOUNDATION.
2. DISCONNECT AND SAFELY REMOVE THE EXISTING CMU/MMU. INSTALL, TEST, TROUBLESHOOT, AND PLACE INTO OPERATION ONE (1) NEW MALFUNCTION MANAGEMENT UNIT (MMU).
3. THE EXISTING CONTROLLER WILL BECOME THE SPARE CONTROLLER.
4. INSTALL, TEST, TROUBLESHOOT, AND PLACE INTO OPERATION ONE (1) UNINTERRUPTABLE POWER SUPPLY AND CABINET, SPECIAL.
5. EXISTING TYPE D FOUNDATION DIMENSIONS: 48" x 30"
6. STORE CONTROLLERS, CMU/MMU, AND CABINETS IN A DRY SECURE LOCATION. COORDINATE WITH MUNICIPAL REPRESENTATIVE FOR DELIVERY OR PICKUP. POC: Mr. JOSH WHITING AT (309) 429-5153 FROMM THE CITY OF MOLINE.

MODEL: Default
FILE NAME: C:\Users\drezenpe\Desktop\DR2022092909.txd

USER NAME = drezenpe	DESIGNED -	REVISED - P. DREZEN 2/15/22	STATE OF ILLINOIS DEPARTMENT OF TRANSPORTATION	ILLINOIS 92 AT 17TH ST PLAN SHEET			F.A.I. RTE.	SECTION	COUNTY	TOTAL SHEETS	SHEET NO.
PLOT SCALE = 40.0000' / in.	DRAWN - L.D. HILL	REVISED -		SCALE: 20	SHEET 11 OF 17 SHEETS	STA.	TO STA.	D2 RRI 2022-1	VARIOUS	17	11
PLOT DATE = May-09-2022 04:43:55 PM	CHECKED -	REVISED -					CONTRACT NO. 64R59				
DATE - 5/17/00	REVISED -	REVISED -					ILLINOIS FED AID PROJECT				

CABLE PLAN

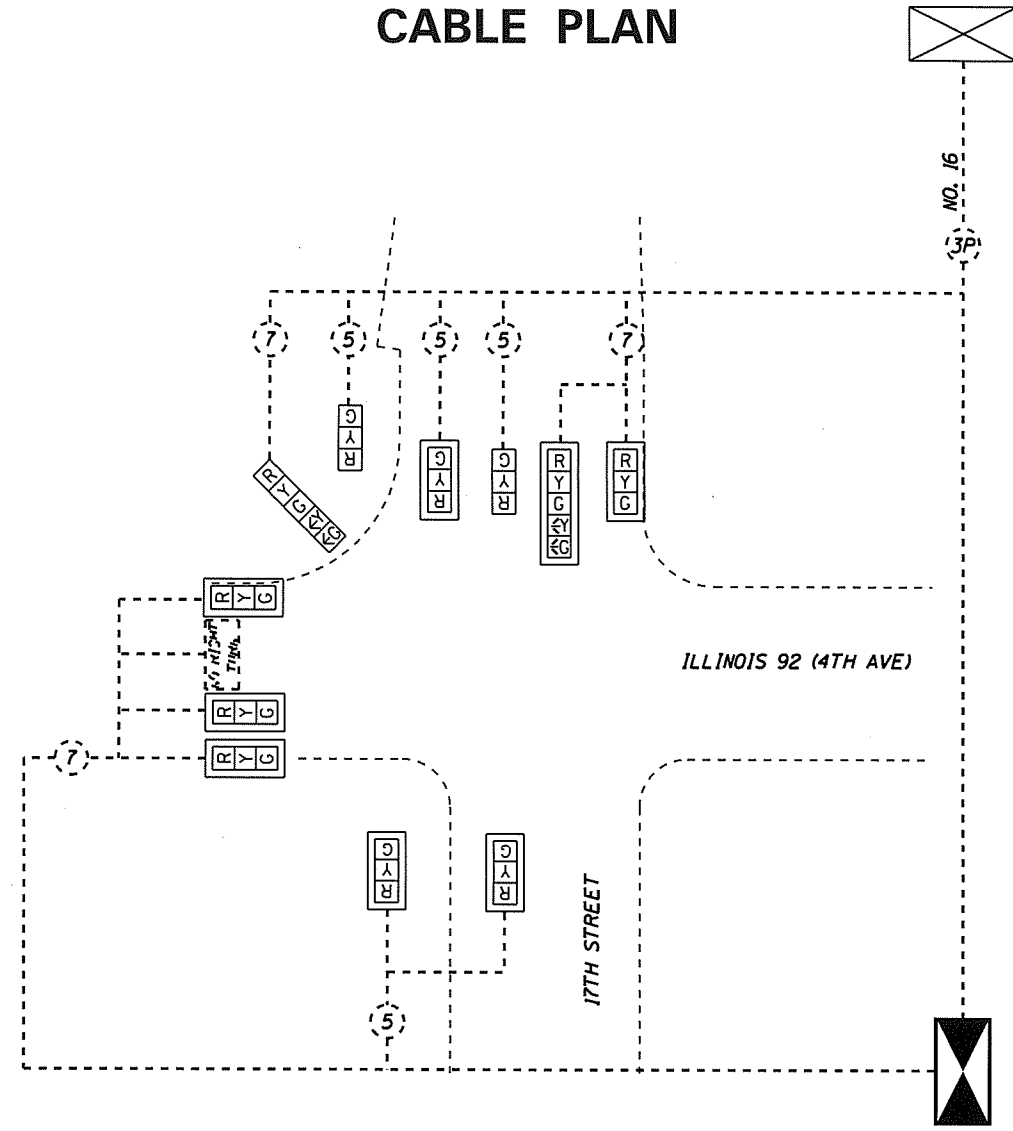

- CABLE PLAN LEGEND**
- ⊙ PED BUTTON
 - (2) - EXISTING CABLE TO REMAIN
 - (2) - INDICATES NUMBER OF NEW CONDUCTORS. ALL CABLE IS NO. 14 EXCEPT AS INDICATED. "P" INDICATES PAIR CABLE
 - [R Y G] EXISTING SIGNAL HEAD WITH OR WITHOUT BACK PLATE
 - NO RIGHT TURN EXISTING ILLUMINATED FIBER-OPTIC SIGN

PHASE DESIGNATION DIAGRAM

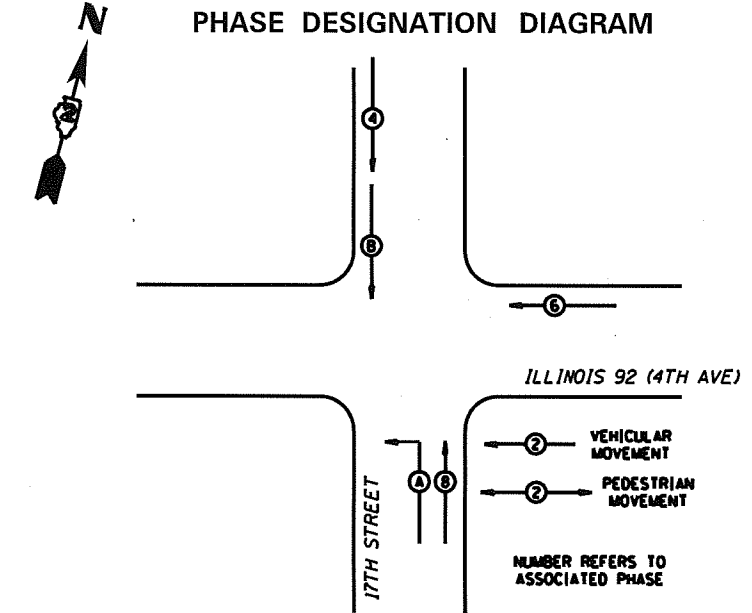

REFER TO STANDARD 857001

RAILROAD GRADE CROSSING PREEMPTION

SIGNAL PHASE #	RIGHT - of - WAY CHANGE INTERVALS						CLEAR TRACK INTERVALS		PREEMPTION INTERVALS	EXIT PHASES TO NORMAL OPERATION
	Ø6	CL	Ø4 & Ø8	CL	ØLB	CL	CTG	CTC **		
ØG to RR CL	ØG	CL	ØG	CL	ØG	CL	CTG	CTC **	PREEMPTION HOLD INTERVALS	EXIT PHASES TO NORMAL OPERATION
Ø4	R	R	G	Y	R	R	R	R		
Ø6	G	Y	R	R	R	R	R	R		
Ø8	R	R	G	Y	R	R	R	R		
OLA*	DARK	DARK	DARK	DARK	DARK	DARK	DARK	DARK		
OLB	R	R	G	G	G	G	G	Y		
NRT SIGN	OFF	ON	OFF	ON			ON	ON		

- OL "A" IS ONLY ACTIVE DURING THE PREEMPTION HOLD INTERVALS
- THE TRACK CLEAR SHALL BE FOLLOWED BY AN ALL "RED" CLEARANCE

GRAPHIC PREEMPTION SEQUENCE

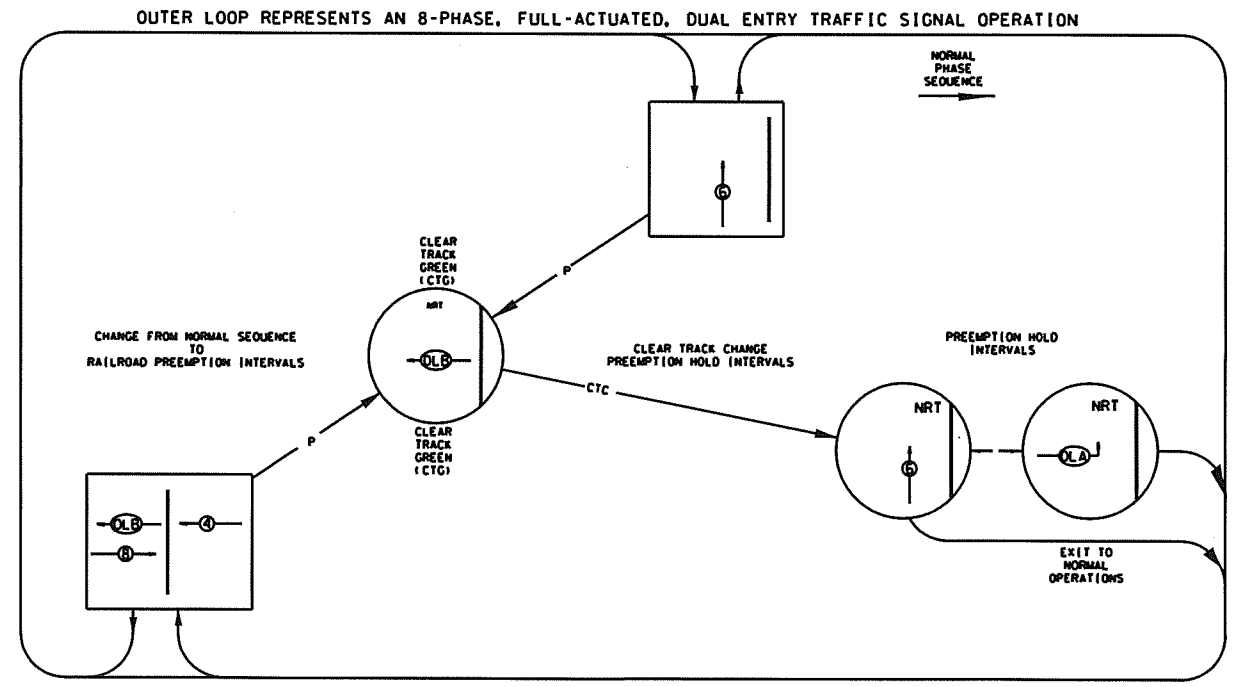

OVERLAP "A" IS ACTIVE ONLY DURING THE PREEMPTION HOLD INTERVAL

MODEL: Default
FILE NAME: C:\Users\drezenpe\Desktop\092097599.traf_plan.dgn

USER NAME = drezenpe	DESIGNED -	REVISED - P. DREZEN 2/15/22
	DRAWN - L.D. HILL	REVISED -
PLOT SCALE = 40.0000' / in.	CHECKED -	REVISED -
PLOT DATE = May-09-2022 04:44:19 PM	DATE - 5/17/00	REVISED -

STATE OF ILLINOIS
DEPARTMENT OF TRANSPORTATION

ILLINOIS 92 AT 17TH ST	
SEQUENCE OF OPERATION AND CABLE PLAN	
SCALE: 20	SHEET 12 OF 17 SHEETS STA. TO STA.

F.A.I. RTE.	SECTION	COUNTY	TOTAL SHEETS	SHEET NO.
*	D2 RRI 2022-1	VARIOUS	17	12
CONTRACT NO. 64R59				
ILLINOIS FED. AID PROJECT				

FOR INFORMATION ONLY

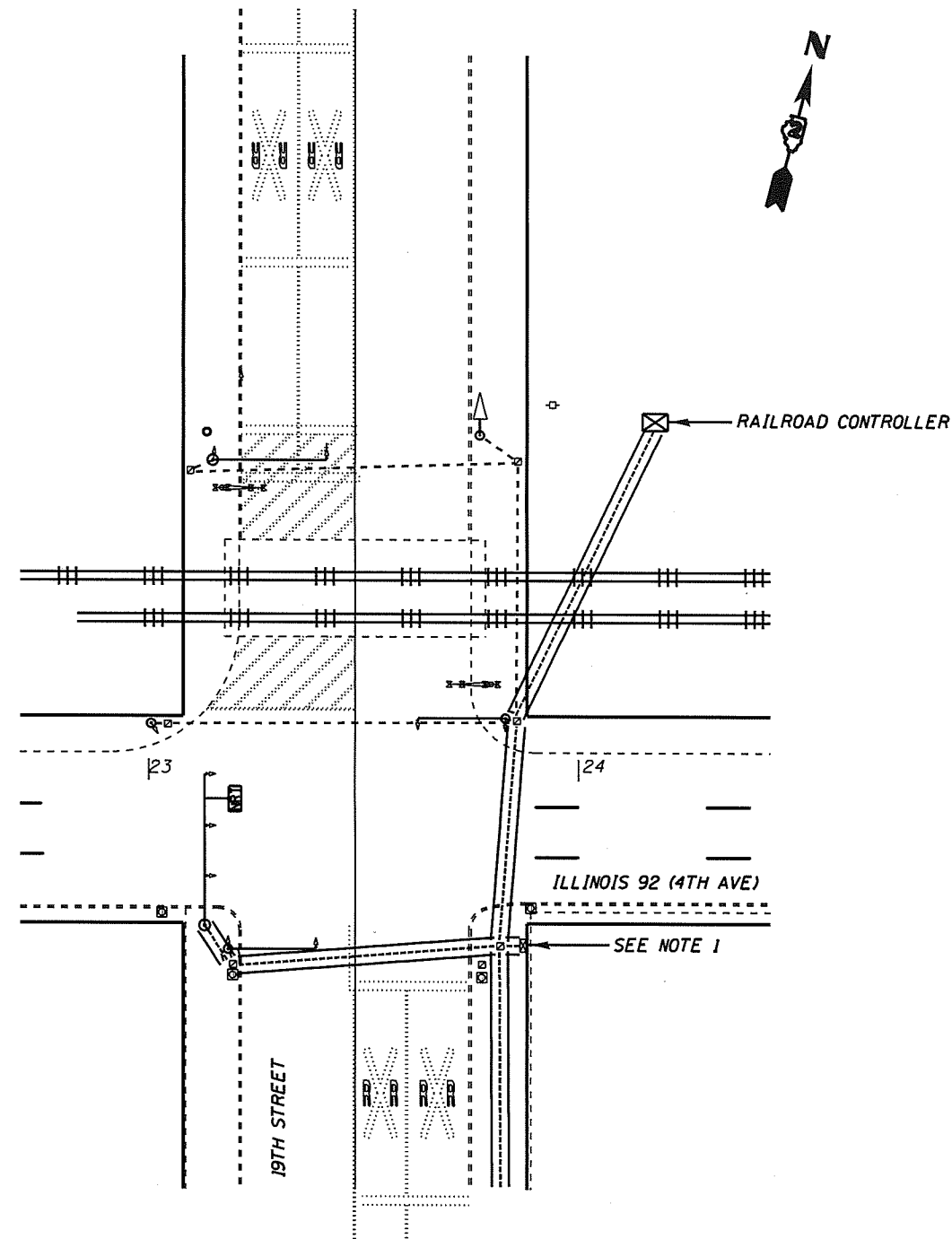

LEGEND

- EXISTING CONTROLLER
- NEW CONTROLLER
- EXISTING ALUMINUM MAST ARM ASSEMBLY AND POLE
- EXISTING STEEL MAST ARM ASSEMBLY AND POLE
- EXISTING SIGNAL HEAD AND POST
- EXISTING SIGNAL HEAD
- EXISTING PEDESTRIAN HEAD
- EXISTING HANDHOLE
- EXISTING CONDUIT (LENGTH AND SIZE)
- GALVANIZED STEEL OR PVC CONDUIT
UPPER NUMERAL INDICATES LENGTH
"T" INDICATES CONDUIT IN TRENCH
"P" INDICATES CONDUIT PUSHED
LOWER NUMERAL INDICATES SIZE AND TYPE
- NRT NO RIGHT TURN (ILLUMINATED SIGN - FIBER OPTIC)
- NLT NO LEFT TURN (ILLUMINATED SIGN - FIBER OPTIC)

NOTES

1. DISCONNECT AND SAFELY REMOVE THE EXISTING CONTROLLER AND CABINET. INSTALL, TEST, TROUBLESHOOT, AND PLACE INTO OPERATION ONE (1) RAILROAD, FULL ACTUATED CONTROLLER AND TYPE IV CABINET, SPECIAL ON THE EXISTING FOUNDATION.
2. INSTALL, TEST, TROUBLESHOOT, AND PLACE INTO OPERATION ONE (1) SPARE, RAILROAD FULL ACTUATED CONTROLLER, SPECIAL.
3. DISCONNECT AND SAFELY REMOVE THE EXISTING CMU/MMU. INSTALL, TEST, TROUBLESHOOT, AND PLACE INTO OPERATION ONE (1) NEW MALFUNCTION MANAGEMENT UNIT (MMU).
4. INSTALL, TEST, TROUBLESHOOT, AND PLACE INTO OPERATION ONE (1) UNINTERRUPTABLE POWER SUPPLY AND CABINET, SPECIAL.
5. EXISTING TYPE D FOUNDATION DIMENSIONS: 48" x 30"
6. STORE CONTROLLERS, CABINETS, AND CMU/MMU IN A DRY SECURE LOCATION. COORDINATE WITH MUNICIPAL REPRESENTATIVE FOR DELIVERY OR PICKUP OF SAID ITEMS. POC: Mr JOSH WHITING (309) 4295153 FROM THE CITY OF MOLINE.

MODEL: Default
 FILE NAME: C:\Users\drezenpe\Desktop\Illinois 92 at 19th St.rvt

USER NAME = drezenpe	DESIGNED -	REVISED - P. DREZEN 2/15/22
	DRAWN - L.D. HILL	REVISED -
PLOT SCALE = 40,0000' / in.	CHECKED -	REVISED -
PLOT DATE = May-09-2022 04:44:48 PM	DATE - 5/17/00	REVISED -

STATE OF ILLINOIS
DEPARTMENT OF TRANSPORTATION

ILLINOIS 92 AT 19TH ST PLAN SHEET

SCALE: 20 SHEET 13 OF 17 SHEETS STA. TO STA.

F.A.I. RTE.	SECTION	COUNTY	TOTAL SHEETS	SHEET NO.
	D2 RRI 2022-1	VARIOUS	17	13
CONTRACT NO. 64R59				
ILLINOIS FED. AID PROJECT				

CABLE PLAN

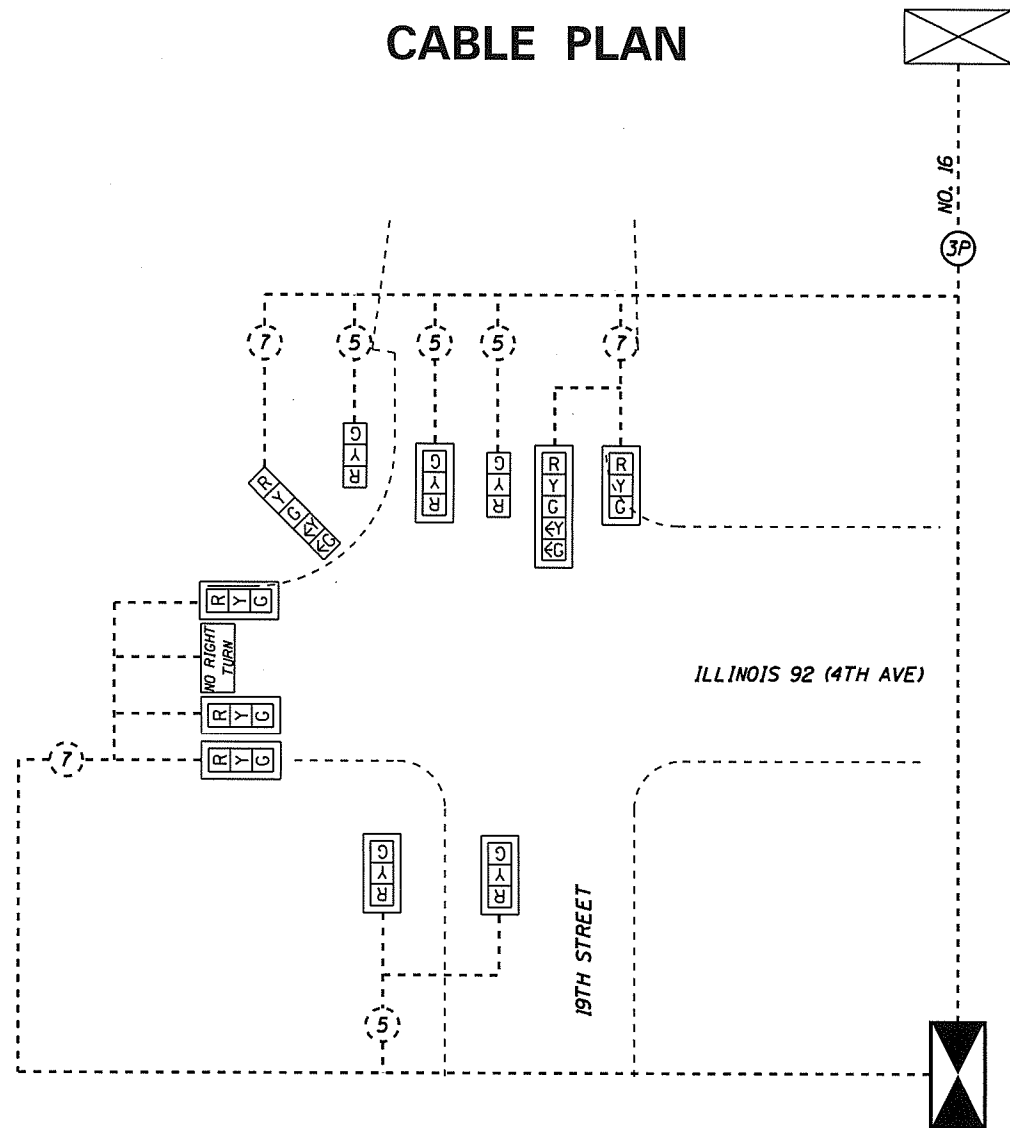

- CABLE PLAN LEGEND**
- ⊙ PED BUTTON
 - (2) - EXISTING CABLE TO REMAIN
 - (2) - INDICATES NUMBER OF NEW CONDUCTORS. ALL CABLE IS NO. 14 EXCEPT AS INDICATED. "P" INDICATES PAIR CABLE
 - [R Y G] EXISTING SIGNAL HEAD WITH OR WITHOUT BACK PLATE
 - [NO RIGHT TURN] EXISTING ILLUMINATED FIBER-OPTIC SIGN



PHASE DESIGNATION DIAGRAM

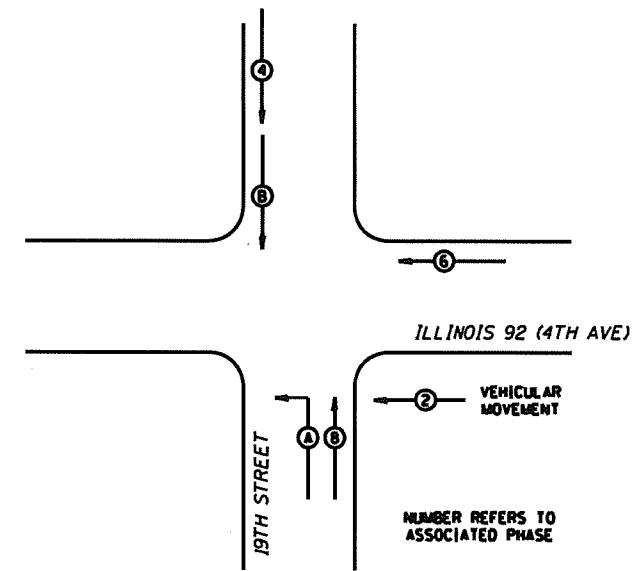

REFER TO STANDARD 857001

RAILROAD GRADE CROSSING PREEMPTION

SIGNAL PHASE #	RIGHT - of - WAY CHANGE INTERVALS						CLEAR TRACK INTERVALS		PREEMPTION HOLD INTERVALS	EXIT TO NORMAL OPERATION
	Ø6	CL	Ø4 & Ø8	CL	Ø6	CL	CTG	CTC **		
Ø4	R	R	G	Y	R	R	R	R	HOLD INTERVALS	TO NORMAL OPERATION
Ø6	G	Y	R	R	R	R	R	R		
Ø8	R	R	G	Y	R	R	R	R	HOLD INTERVALS	TO NORMAL OPERATION
OLA*	DARK	DARK	DARK	DARK	DARK	DARK	DARK	DARK		
OLB	R	R	G	G	G	G	G	Y	HOLD INTERVALS	TO NORMAL OPERATION
NRT SIGN	OFF	ON	OFF	ON			ON	ON		

- * OL "A" IS ONLY ACTIVE DURING THE PREEMPTION HOLD INTERVAL
- ** THE TRACK CLEAR SHALL BE FOLLOWED BY AN ALL "RED" CLEARANCE

GRAPHIC PREEMPTION SEQUENCE

OUTER LOOP REPRESENTS AN 8-PHASE, FULL-ACTUATED, DUAL ENTRY TRAFFIC SIGNAL OPERATION

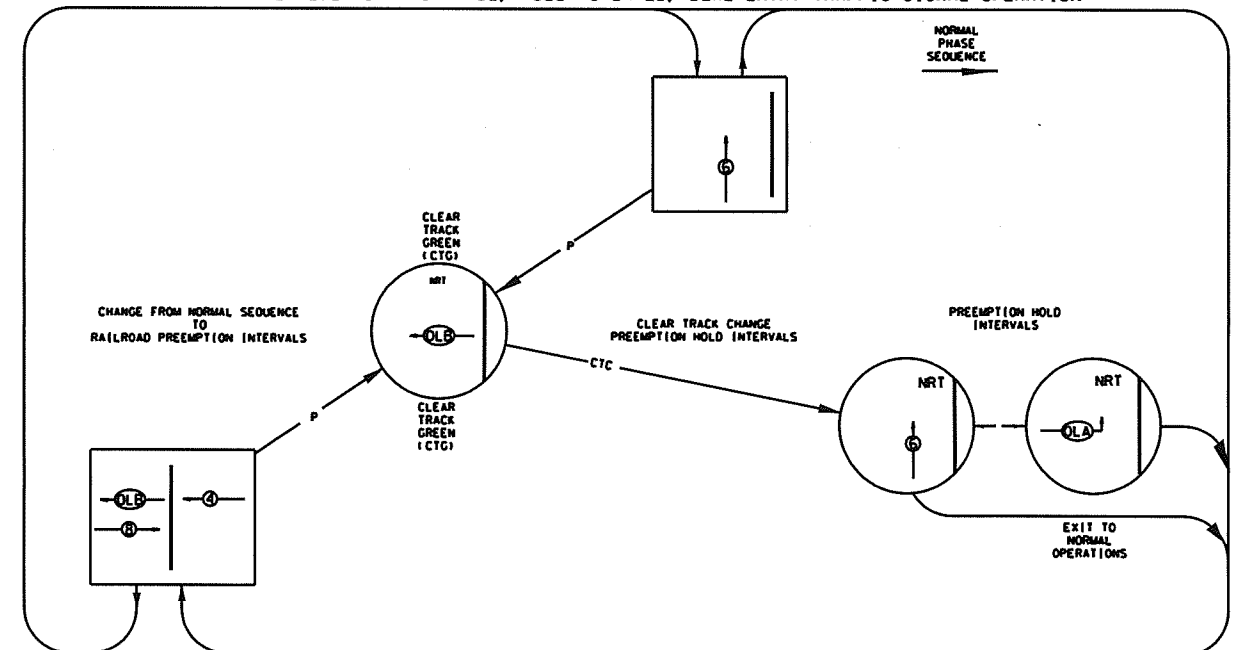

OVERLAP "A" IS ACTIVE ONLY DURING THE PREEMPTION HOLD INTERVAL

STATE OF ILLINOIS
DEPARTMENT OF TRANSPORTATION

ILLINOIS 92 AT 19TH ST
SEQUENCE OF OPERATION AND CABLE PLAN

F.A.I. RTE.	SECTION	COUNTY	TOTAL SHEETS	SHEET NO.
*	D2 RRI 2022-1	VARIOUS	17	14
CONTRACT NO. 64R59				
ILLINOIS FED. AID PROJECT				

SCALE: 20 SHEET 14 OF 17 SHEETS STA. TO STA.

USER NAME = drezenpe	DESIGNED -	REVISED - P. DREZEN 2/15/22
	DRAWN - L.D. HILL	REVISED -
PLOT SCALE = 40.0000' / in.	CHECKED -	REVISED -
PLOT DATE = May-09-2022 04:45:33 PM	DATE - 5/17/00	REVISED -

FOR INFORMATION ONLY

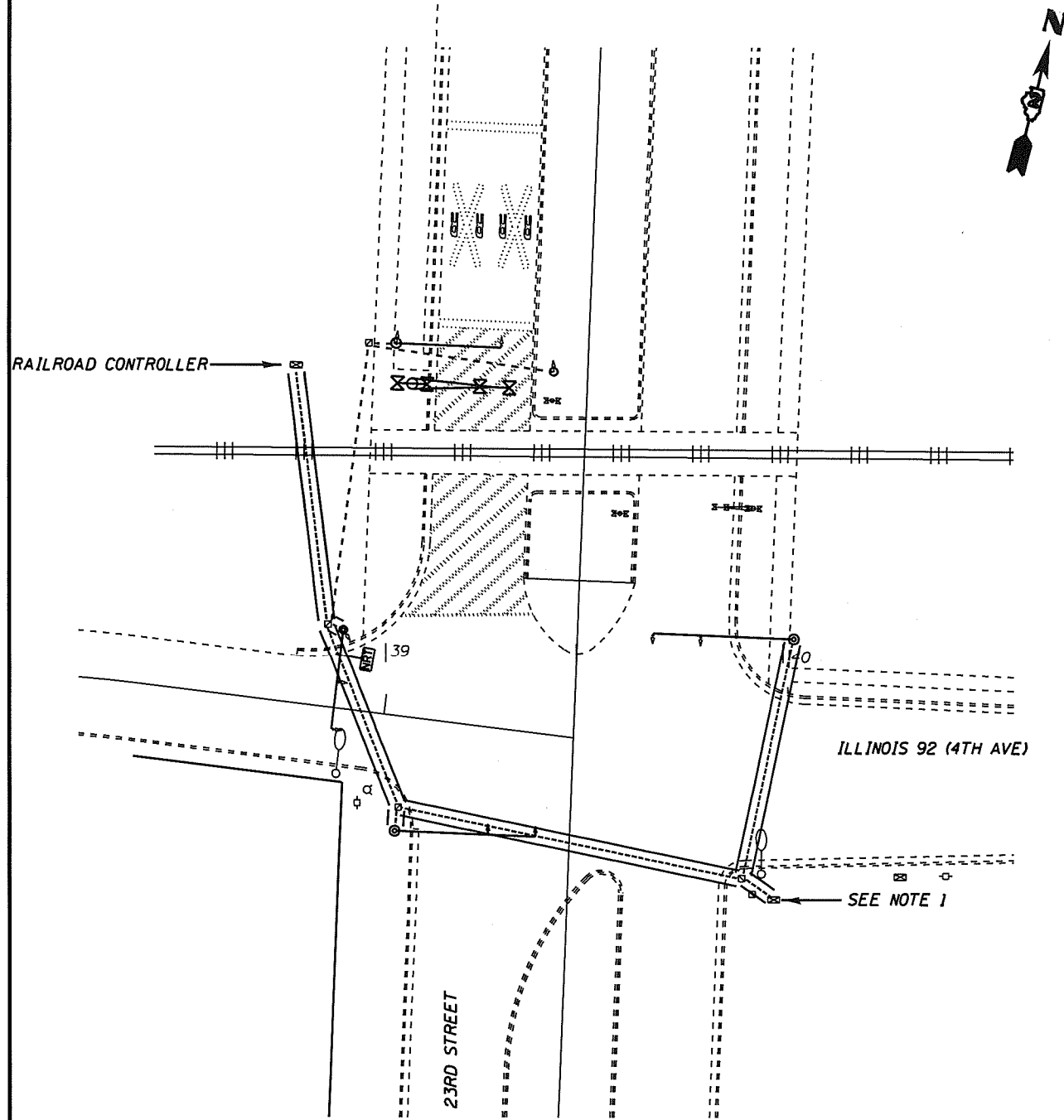

LEGEND

- EXISTING CONTROLLER
- NEW CONTROLLER
- EXISTING ALUMINUM MAST ARM ASSEMBLY AND POLE
- EXISTING STEEL MAST ARM ASSEMBLY AND POLE
- EXISTING SIGNAL HEAD AND POST
- EXISTING SIGNAL HEAD
- EXISTING PEDESTRIAN HEAD
- EXISTING HANDHOLE
- EXISTING CONDUIT (LENGTH AND SIZE)
- GALVANIZED STEEL OR PVC CONDUIT
UPPER NUMERAL INDICATES LENGTH
"T" INDICATES CONDUIT IN TRENCH
"P" INDICATES CONDUIT PUSHED
LOWER NUMERAL INDICATES SIZE AND TYPE
- NO RIGHT TURN (ILLUMINATED SIGN - FIBER OPTIC)
- NO LEFT TURN (ILLUMINATED SIGN - FIBER OPTIC)

NOTES

1. DISCONNECT AND SAFELY REMOVE THE EXISTING CONTROLLER AND CABINET. INSTALL, TEST, TROUBLESHOOT, AND PLACE INTO OPERATION ONE (1) RAILROAD, FULL ACTUATED CONTROLLER AND TYPE IV CABINET, SPECIAL ON THE EXISTING FOUNDATION.
2. DISCONNECT AND SAFELY REMOVE THE EXISTING CMU/MMU. INSTALL, TEST, TROUBLESHOOT, AND PLACE INTO OPERATION ONE (1) NEW MALFUNCTION MANAGEMENT UNIT (MMU).
3. THE EXISTING CONTROLLER WILL BECOME THE SPARE CONTROLLER.
4. INSTALL, TEST, TROUBLESHOOT, AND PLACE INTO OPERATION ONE (1) UNINTERRUPTABLE POWER SUPPLY AND CABINET, SPECIAL.
5. EXISTING TYPE D FOUNDATION DIMENSIONS: 48" x 30"
6. STORE CONTROLLERS, CMU/MMU, AND CABINETS IN A DRY SECURE LOCATION. COORDINATE WITH MUNICIPAL REPRESENTATIVE FOR DELIVERY OR PICKUP. POC: Mr. JOSH WHITING AT (309) 429-5153 FROMM THE CITY OF MOLINE.

MODEL: Default
 FILE NAME: C:\Users\drezena\Desktop\Illinois92\Illinois92.dwg

USER NAME = drezena	DESIGNED -	REVISED - P. DREZEN 2/15/22
	DRAWN - L.D. HILL	REVISED -
PLOT SCALE = 40.0000' / in.	CHECKED -	REVISED -
PLOT DATE = May-09-2022 04:45:50 PM	DATE - 5/17/00	REVISED -

STATE OF ILLINOIS
DEPARTMENT OF TRANSPORTATION

ILLINOIS 92 AT 23RD ST PLAN SHEET			
SCALE: 20	SHEET 15	OF 17 SHEETS	STA. TO STA.

F.A.I. RTE.	SECTION	COUNTY	TOTAL SHEETS	SHEET NO.
*	D2 RRI 2022-1	VARIOUS	17	15
CONTRACT NO. 64R59				
ILLINOIS FED. AID PROJECT				

RR CABINET

CABLE PLAN

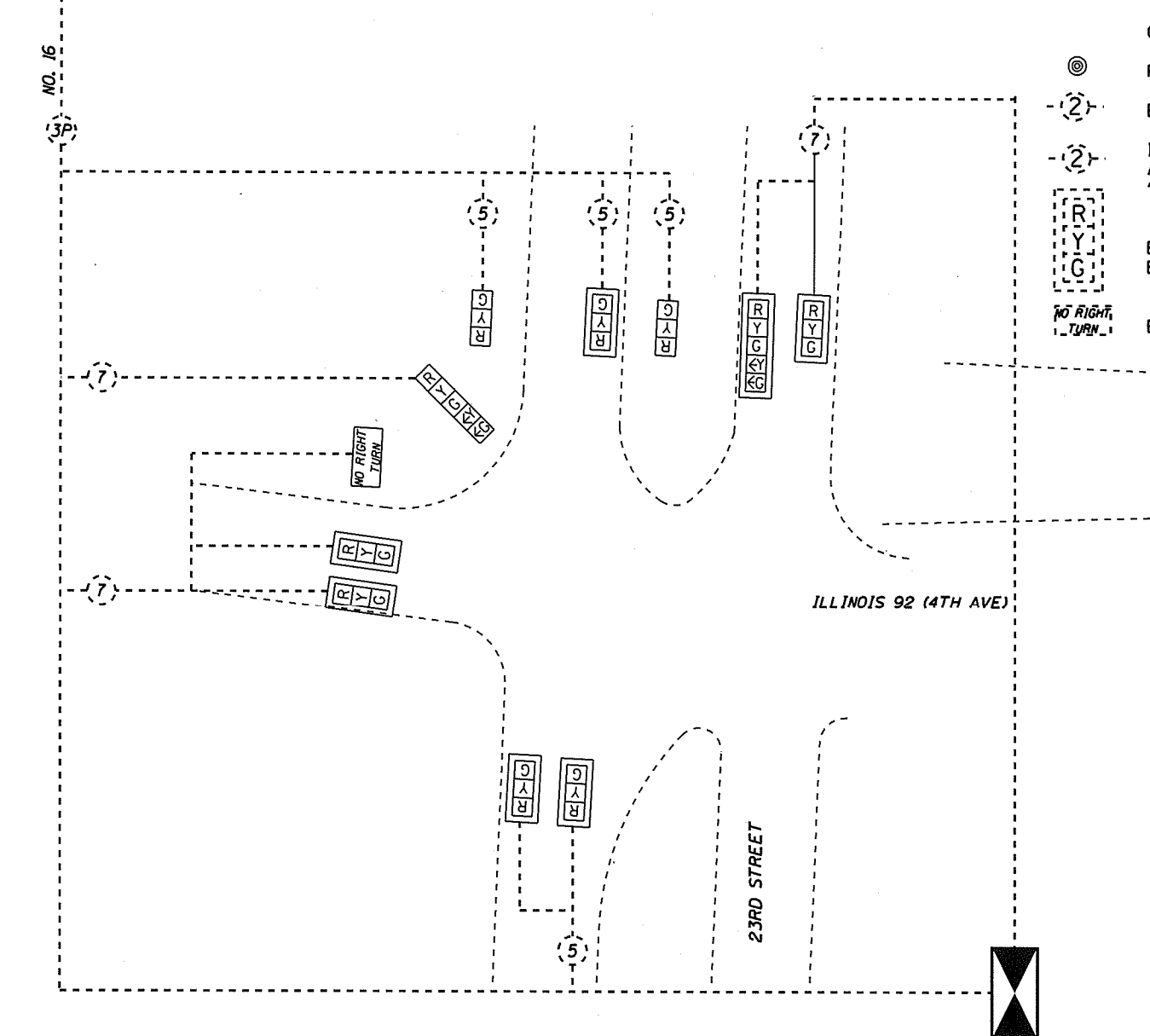

CABLE PLAN LEGEND

- ⊙ PED BUTTON
- ⊖ EXISTING CABLE TO REMAIN
- ⊖ INDICATES NUMBER OF NEW CONDUCTORS. ALL CABLE IS NO. 14 EXCEPT AS INDICATED. "P" INDICATES PAIR CABLE
- RYG EXISTING SIGNAL HEAD WITH OR WITHOUT BACK PLATE
- NO RIGHT TURN EXISTING ILLUMINATED FIBER-OPTIC SIGN

PHASE DESIGNATION DIAGRAM

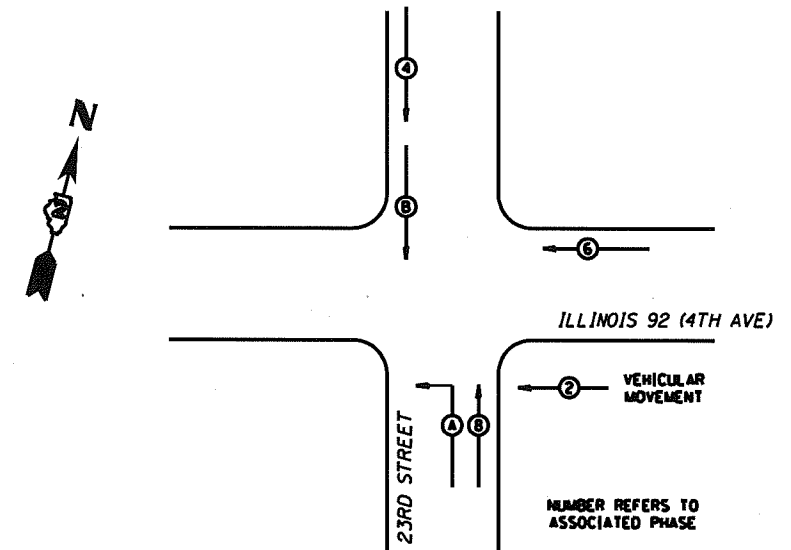

REFER TO STANDARD 857001

GRAPHIC PREEMPTION SEQUENCE

OUTER LOOP REPRESENTS AN 8-PHASE, FULL-ACTUATED, DUAL ENTRY TRAFFIC SIGNAL OPERATION

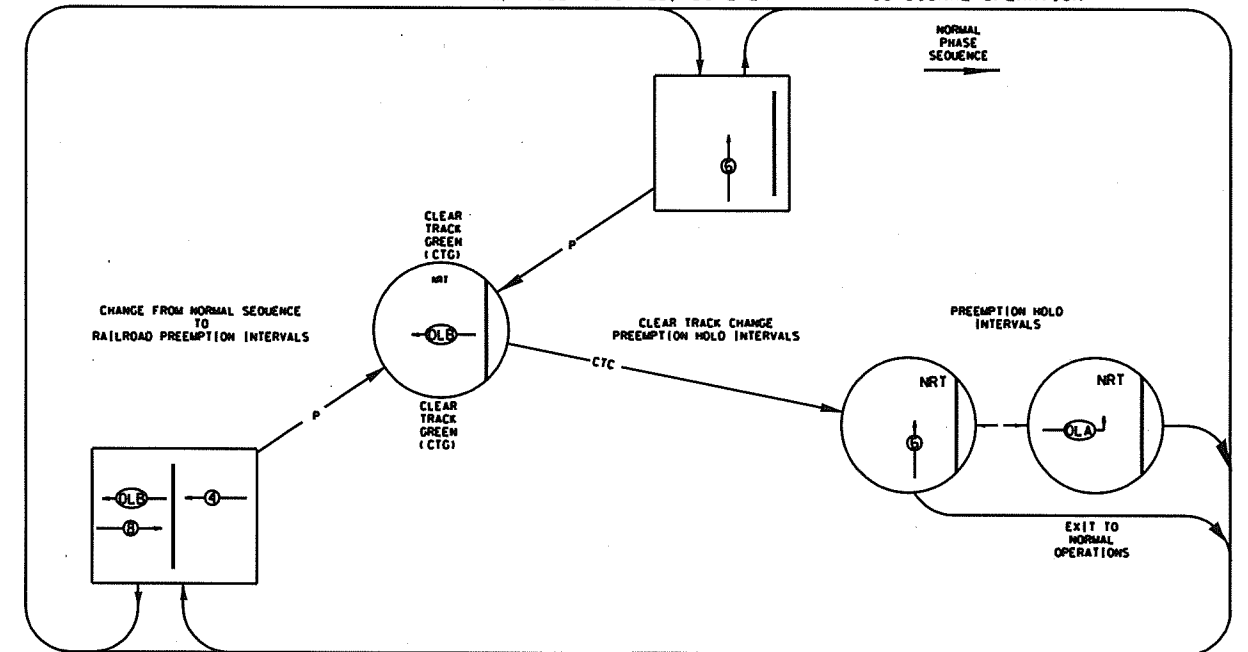

OVERLAP "A" IS ACTIVE ONLY DURING THE PREEMPTION HOLD INTERVAL

RAILROAD GRADE CROSSING PREEMPTION

SIGNAL PHASE #	RIGHT - of - WAY CHANGE INTERVALS						CLEAR TRACK INTERVALS		PREEMPTION HOLD INTERVALS	EXIT PHASES TO NORMAL OPERATION
	Ø6		Ø4 & Ø8		OLB		CTG	CTC **		
ØG to RR CL	ØG	CL	ØG	CL	ØG	CL	CTG	CTC	HOLD	PHASES TO NORMAL OPERATION
Ø4	R	R	G	Y	R	R	R	R		
Ø6	G	Y	R	R	R	R	R	R		
Ø8	R	R	G	Y	R	R	R	R	HOLD	PHASES TO NORMAL OPERATION
OL A*	DARK	DARK	DARK	DARK	DARK	DARK	DARK	DARK		
OL B	R	R	G	G	G	G	G	Y	HOLD	PHASES TO NORMAL OPERATION
NRT SIGN	OFF	ON	OFF	ON			ON	ON		

- OL "A" IS ONLY ACTIVE DURING THE PREEMPTION HOLD INTERVALS
- THE TRACK CLEAR SHALL BE FOLLOWED BY AN ALL "RED" CLEARANCE

MODEL: Default
FILE NAME: C:\Users\drezenpe\Desktop\Illinois 92 at 23rd St.dwg

USER NAME = drezenpe	DESIGNED -	REVISED - P. DREZEN 2/15/22
	DRAWN - L.D. HILL	REVISED -
PLOT SCALE = 40.0000' / in.	CHECKED -	REVISED -
PLOT DATE = May-09-2022 04:50:37 PM	DATE - 5/17/00	REVISED -

STATE OF ILLINOIS
DEPARTMENT OF TRANSPORTATION

ILLINOIS 92 AT 23RD ST
SEQUENCE OF OPERATION AND CABLE PLAN

SCALE: 20 SHEET 16 OF 17 SHEETS STA. TO STA.

F.A.I. RTE.	SECTION	COUNTY	TOTAL SHEETS	SHEET NO.
*	D2 RRI 2022-1	VARIOUS	17	16
CONTRACT NO. 64R59				
ILLINOIS FED. AID PROJECT				



IL 92 (1st Ave/18th Ave) at IL 84 (19th St)



US 20 (E. Ramp) at South Appleton Road

U.S. Route 6 at Patriot Way

IL 92 (1st Ave/18th Ave) & IL 84 (19th St)

- Notes**
1. Disconnect and safely remove existing traffic signal controller.
 2. Install, test, troubleshoot, and place into operation one (1) Spare, Railroad Full Actuated Controller Special. The existing Traffic Signal Controller will become the spare.
 3. Install, test, troubleshoot, and place into operation a new Uninterruptible Power Supply (UPS) in a new UPS cabinet.
 4. Disconnect and safely remove existing CMU/MMU.
 5. Install, test, troubleshoot, and place into operation a new CMU/MMU.
 6. Store the controller and CMU/MMU in a dry secure area. Coordinate with municipal representative for delivery or pick up. POC: Mr. Eric McLaughlin at (309) 738-6048 (Cellular) or at (309) 752-1773 (Office).

U.S. Route 6 at Patriot Way

- Notes**
1. Disconnect and safely remove existing traffic signal controller.
 2. Install, test, troubleshoot, and place into operation two (2) Spare, Railroad Full Actuated Controller Special (Econolite-Cobalt).
 3. Disconnect and safely remove the existing Uninterruptible Power Supply (UPS).
Install, test, troubleshoot, and place into operation a new UPS into the existing UPS cabinet.
 4. Disconnect and safely remove existing CMU/MMU.
 5. Install, test, troubleshoot, and place into operation a new MMU.
 6. Store the existing controllers, CMU/MMU, and UPS in a dry secure area. Coordinate with municipal representative for delivery or pick up. POC: Mr. Mark Crosby (309) 935-6632.



U.S. 20 (E. Ramp) @ South Appleton Road

- Notes**
1. Disconnect and safely remove existing traffic signal controller.
 2. Install, test, troubleshoot, and place into operation two (2) Full Actuated Controllers (Primary & Spare).
 3. Disconnect and safely remove the existing CMU/MMU. Install, test, troubleshoot, and place into operation a new CMU.
 4. Store the existing controllers and CMU/MMU in a dry secure area. Coordinate with municipal representative for delivery or pick up. POC: Mr. Dan Anderson (815) 378-2928 City of Belvidere.

MODEL: Default
FILE NAME: C:\Users\drezenpe\Desktop\9209709-1701-plan.dgn

USER NAME = drezenpe	DESIGNED -	REVISED - P. DREZEN 2/15/22
	DRAWN - L.D. HILL	REVISED -
PLOT SCALE = 40,0000' / in.	CHECKED -	REVISED -
PLOT DATE = May-09-2022 04:46:53 PM	DATE - 5/17/00	REVISED -

**STATE OF ILLINOIS
DEPARTMENT OF TRANSPORTATION**

IL 92 (1st Ave/18th Ave) & IL 84 (19th St); U.S.ROUTE 6 & PATRIOT WAY
U.S.20 (EAST RAMP) & SOUTH APPLETON ROAD
SCALE: 20

F.A.I. RTE.	SECTION	COUNTY	TOTAL SHEETS	SHEET NO.
.	D2 RRI 2022-1	VARIOUS	17	17
CONTRACT NO. 64R59			ILLINOIS FED. AID PROJECT	