

678	EX.	676	674	672	670	668
678	PROP.	676	674	672	670	668
503+50	EX.					
503+50	PROP.					
503+00	EX.					
503+00	PROP.					
503+00	EX.					
503+00	PROP.					
502+00	EX.					
502+00	PROP.					
502+00	EX.					
502+00	PROP.					
502+00	EX.					
502+00	PROP.					
501+00	EX.					
501+00	PROP.					
501+00	EX.					
501+00	PROP.					
501+00	EX.					
501+00	PROP.					
500+00	EX.					
500+00	PROP.					
500+00	EX.					
500+00	PROP.					
499+50	EX.					
499+50	PROP.					

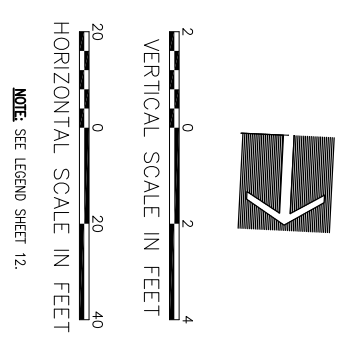

NOTE: SEE LEGEND SHEET 12.

**PLAN AND PROFILE  
 ALIGNMENT 500  
 STA 500+00 - 503+00**

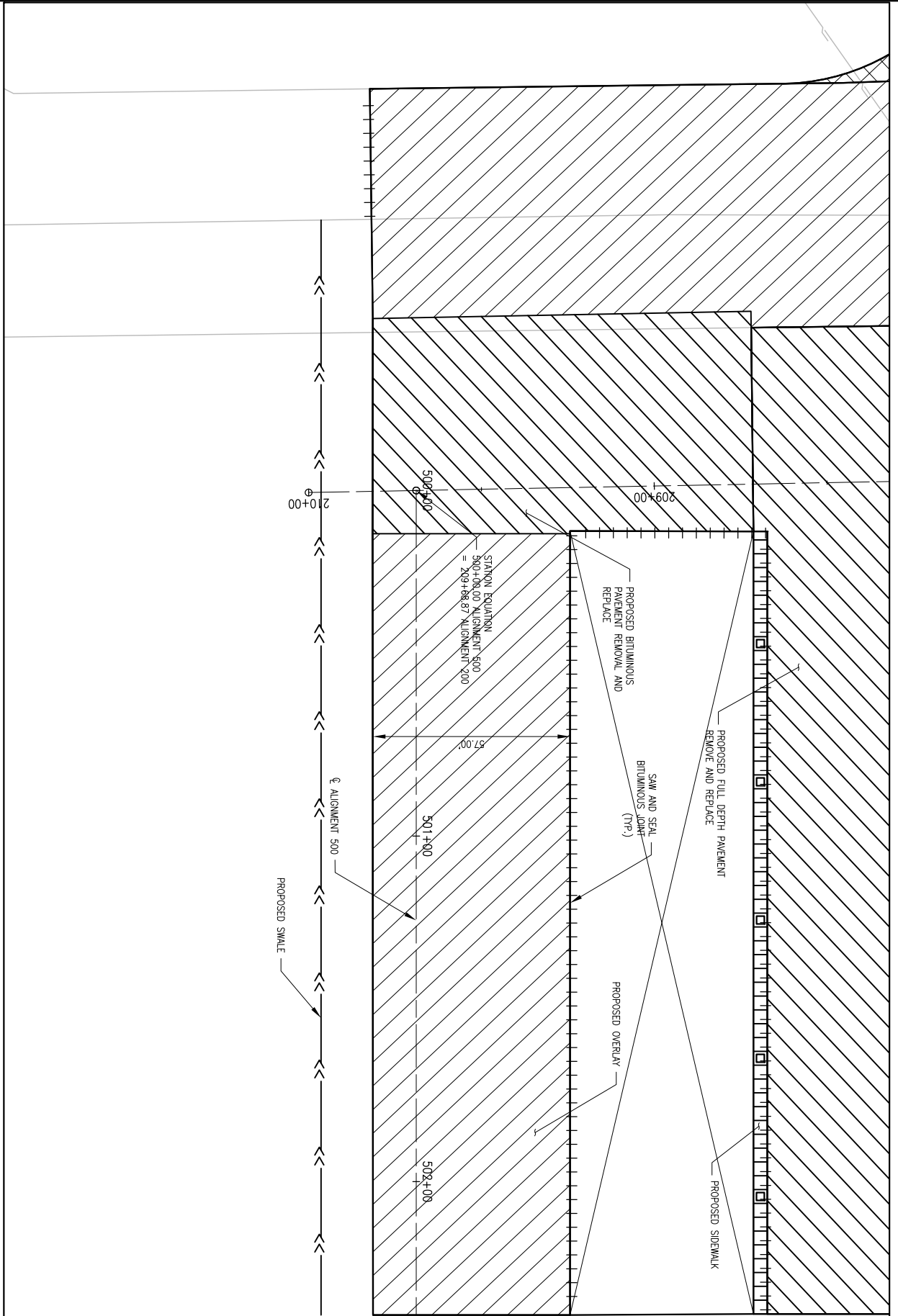
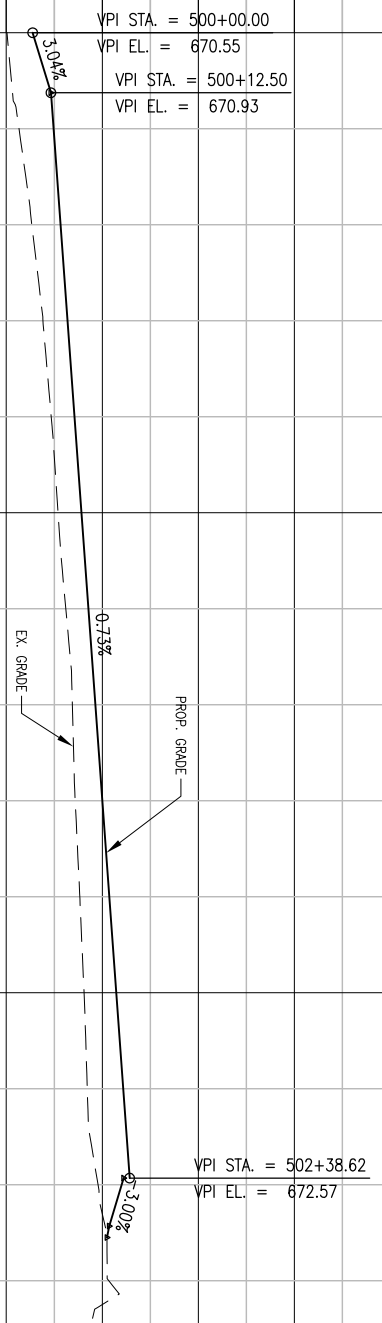

Hanson No. 10A0072  
 Filename 17- PLAN & PROFILE 500  
 Scale 1"=20'  
 Date APRIL 22, 2011



**Chicago-Romeoville Airport**  
**JOLIET REGIONAL PORT DISTRICT**  
 1 George Michas Drive  
 Romeoville, Illinois 60446  
 Telephone: 815.838.9497  
 Fax: 815.838.9524

DATE	REVISION

REHABILITATE NORTH HANGAR PAVEMENTS,  
 IDA No. LOT-4020 AIP No. 3-17-0140-B48

**Hanson Professional Services Inc.**  
 815 Commerce Drive Suite 200  
 Oak Brook, Illinois 60523

LAYOUT	KMS	02/18/11
DRAWN	KMS	02/18/11
REVIEWED	RMH	4/22/11