

Notes: See sheet 14 of 26 for Sections C-C & D-D and View E-E.

a₁₀₀ (E), a₁₀₁ (E), a₁₀₂ (E), a₁₀₃ (E), w₁₀₀ (E) and w₁₀₁ (E) bar spacings measured along \varnothing Rdwy.

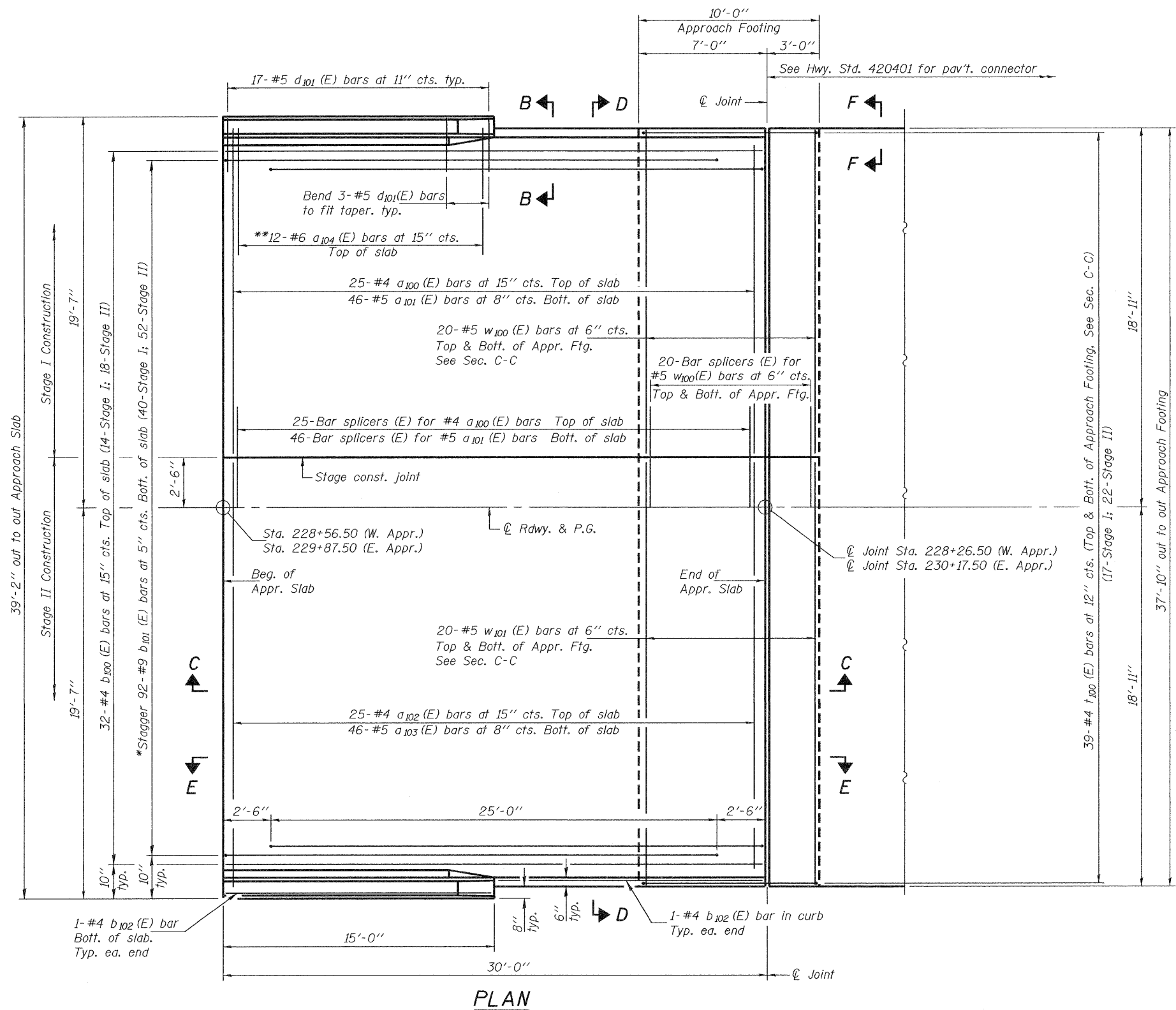
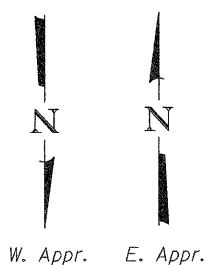

PLAN
(East Approach shown - West Approach similar by mirror image)

*Tilt #9 b₁₀₁ (E) bars as required to maintain clearance.
**Spaced between a₁₀₀ (E) & a₁₀₂ (E) bars, typ. ea. parapet.

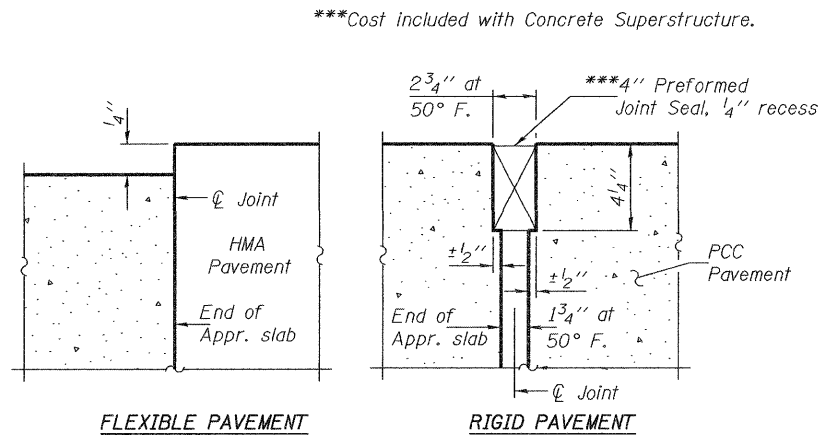

DETAIL A

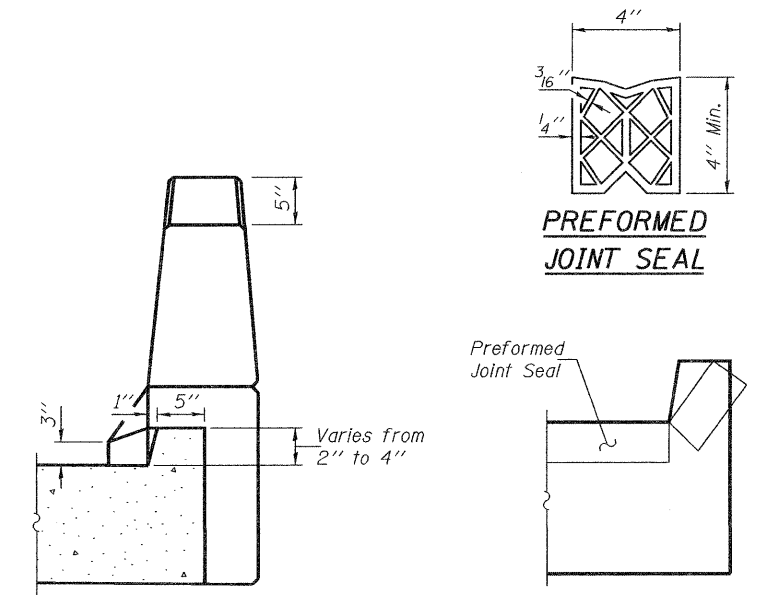

VIEW B-B

VIEW F-F

Angle Preformed Joint Seal at 45° at curbs when req'd for drainage.

DESIGNED - Jessica C. Forrest	EXAMINED - <i>Thomas J. Damagala</i>	DATE - 5/10/2011	STATE OF ILLINOIS DEPARTMENT OF TRANSPORTATION		BRIDGE APPROACH SLAB DETAILS STRUCTURE NO. 073-0038		F.A.P. RTE. 869	SECTION 6B-2	COUNTY *	TOTAL SHEETS 271	SHEET NO. 143
CHECKED - Nicholas R. Barnett	PASSED - <i>Carl Perry</i>						SHEET NO. 13 OF 26 SHEETS		CONTRACT NO. 98797		ILLINOIS FED. AID PROJECT
DRAWN - h.t. duong							*PERRY/FRANKLIN				
CHECKED - JCF/NRB											