

STAGING NOTES

1. CHANGEABLE MESSAGE SIGN REQUIRED AT US 51.
2. IL 148 SOUTHBOUND TURNING MOVEMENT CLOSED TO IL 14 EASTBOUND TRAFFIC.
3. CHANGEABLE MESSAGE SIGN REQUIRED AT ZIEGLER.
4. IL 14 WESTBOUND TURNING MOVEMENT CLOSED TO IL 148 NORTHBOUND TRAFFIC.
5. SEE TYPICAL SECTION FOR ROADWAY STAGING DIMENSIONS.

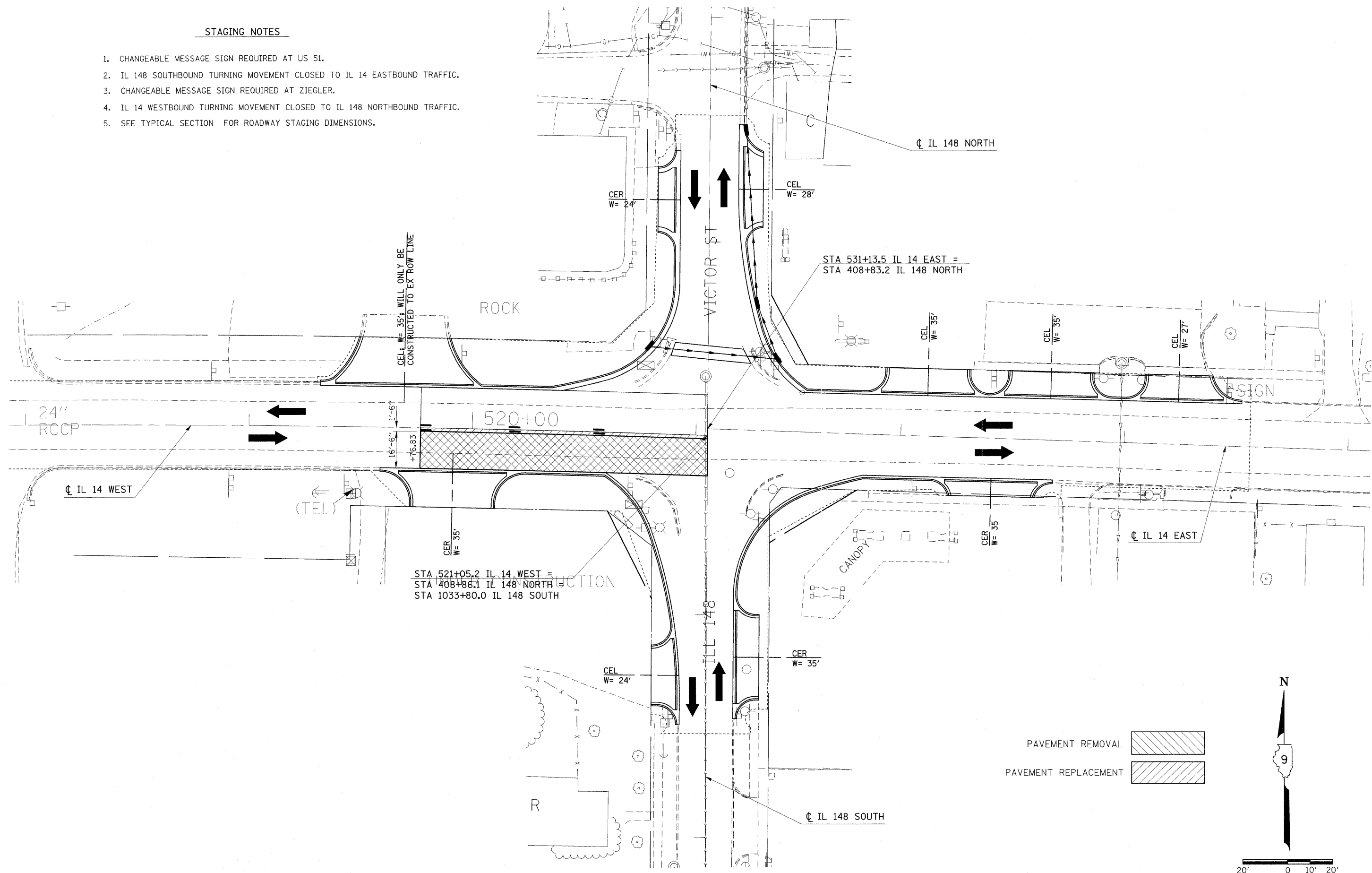

FILE NAME =	USER NAME = #USER#	DESIGNED -	REVISED -	STATE OF ILLINOIS DEPARTMENT OF TRANSPORTATION	STAGE 2: IL 14 /IL 148 INTERSECTION			F.A.P. RTE.	SECTION	COUNTY	TOTAL SHEETS	SHEET NO.
#FILE#		DRAWN -	REVISED -		SCALE: 20	SHEET NO. OF SHEETS	STA. TO STA.	869	(1-1,3,6)R-1,RS-3(1,3,6)B-2	*	299	61
		CHECKED -	REVISED -					* PERRY & FRANKLIN COUNTY CONTRACT NO. 98797				
		DATE -	REVISED -					ILLINOIS FED. AID PROJECT				