

STAGING NOTES

1. CHANGEABLE MESSAGE SIGN REQUIRED AT US 51.
2. IL 148 NORTHBOUND TURNING MOVEMENT CLOSED TO IL 14 EASTBOUND TRAFFIC.
3. CHANGEABLE MESSAGE SIGN REQUIRED AT IL 148 AND IL 154 INTERSECTION.
4. IL 14 WESTBOUND TURNING MOVEMENT CLOSED TO IL 148 SOUTHBOUND TRAFFIC.
5. SEE TYPICAL SECTION FOR ROADWAY STAGING DIMENSIONS.

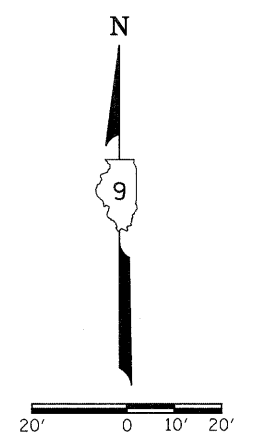
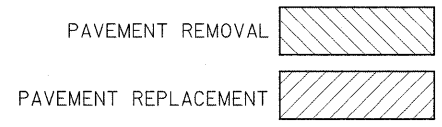
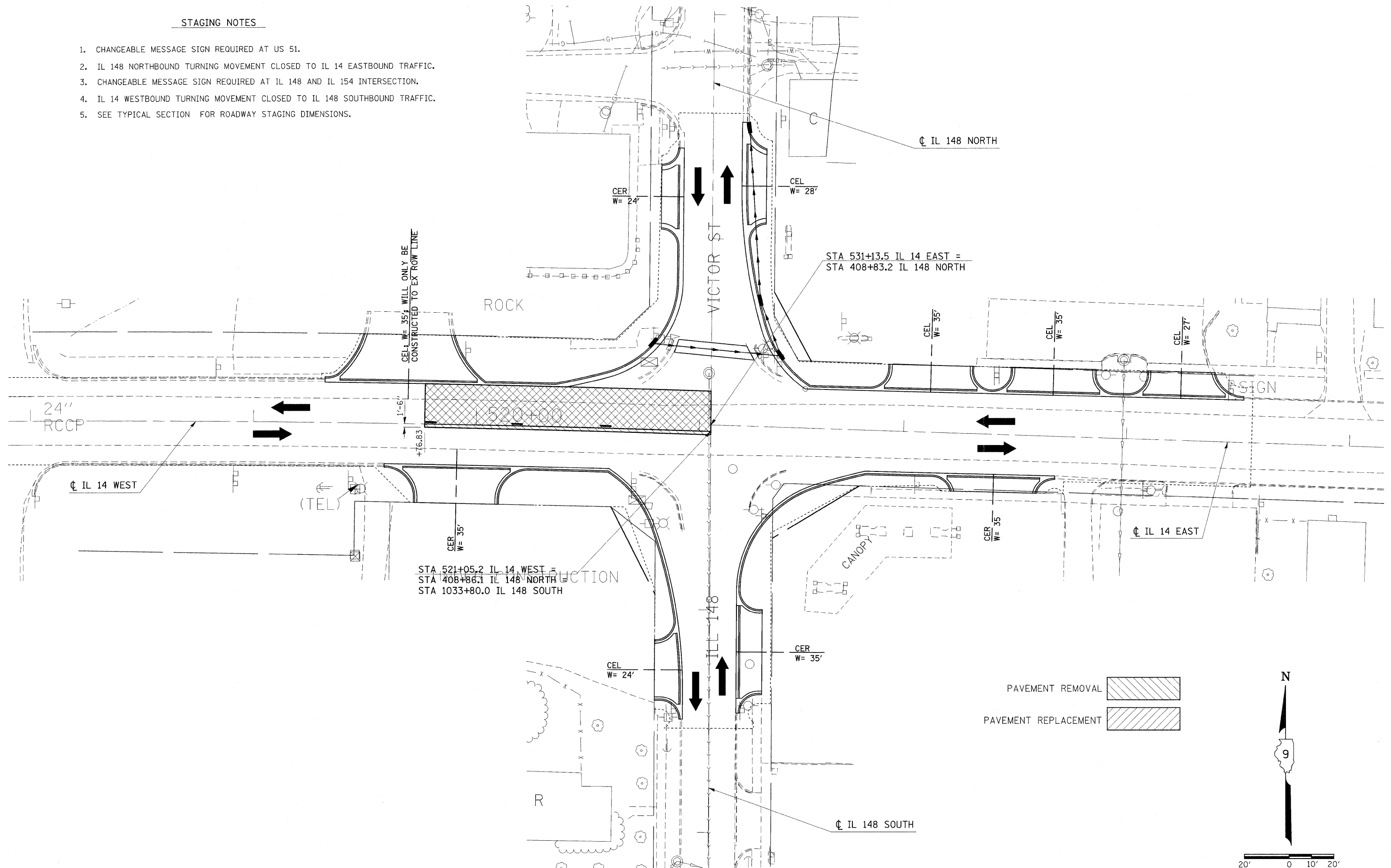

FILE NAME = #FILE#	USER NAME = #USER#	DESIGNED -	REVISED -	<b>STATE OF ILLINOIS DEPARTMENT OF TRANSPORTATION</b>	<b>STAGE 1: IL 14 /IL 148 INTERSECTION</b>			F.A.P. RTE.	SECTION	COUNTY	TOTAL SHEETS	SHEET NO.
	PLOT SCALE = #SCALE#	DRAWN -	REVISED -		SCALE: 20	SHEET NO. OF SHEETS	STA. TO STA.	869	(1-1,1,3,6)R-1,RS-3;(1,3,6)B-2	*	299	60
	PLOT DATE = #DATE#	CHECKED -	REVISED -					* PERRY & FRANKLIN COUNTY CONTRACT NO. 98797				
		DATE -	REVISED -					[ILLINOIS] FED. AID PROJECT				