



LT. STA. 291+38.5
 PIPE CULVERT REMOVAL
 PIPE CULVERTS, CL A, TY 1 24"
 PRC FLARED END SECTIONS 24"

STA. 291+38.5 IL 14 =
 STA. 20+00.0 SECTION LINE ROAD NORTH

LT. STA. 297+77.6
 PIPE CULVERT REMOVAL
 PIPE CULVERTS, CL D, TY 1 12"
 END SECTIONS 12"

EXIST. CURVE 4REV
 PI STA. = 300+61.57
 $\Delta = 1^\circ 04' 48''$ (RT)
 $D = 0^\circ 08' 06''$
 $R = 42,441.67'$
 $T = 400.00'$
 $L = 799.98'$
 $E = 1.88'$
 $e =$
 $T.R. =$
 $S.E. RUN =$
 $P.C. STA. = 296+61.57$
 $P.T. STA. = 304+61.55$

CONSTRUCTION LIMITS

TREES TO BE REMOVED

PECAN TREE SHALL NOT BE DISTURBED

PR ROW LINE

STA 289+94
 REMOVAL OF EXISTING STRUCTURE NO. 5,
 PRECAST CONC PIPE CULVERTS, CL A, TY 1,
 REINFORCED CONCRETE-ELLIPTICAL,
 EQUIVALENT ROUND-SIZE 30"
 PRC FLARED END SECTIONS-ELLIPTICAL,
 EQUIVALENT ROUND-SIZE 30"

CONSTRUCTION LIMITS

IL 14

STA 299+38
 REMOVAL OF EXISTING STRUCTURE NO. 6
 PRECAST CONC PIPE CULVERTS, CL A, TY 1,
 REINFORCED CONCRETE-ELLIPTICAL,
 EQUIVALENT ROUND-SIZE 30"
 PRC FLARED END SECTIONS-ELLIPTICAL,
 EQUIVALENT ROUND-SIZE 30"

LEGEND
 WETLAND

TH14- IRON PIN & CAP, NORTH SIDE OF ROUTE 14
 @ STA. 297+11.4, LEFT 16.8', ELEV. 434.904

BM 103 - CUT " " ON TOP OF A HEADWALL OF AN ACROSS ROAD BOX
 CULVERT (A.R.C.), NORTH SIDE OF ROUTE 14 @ STA. 299+36,
 LEFT 18.0', ELEV. 433.502

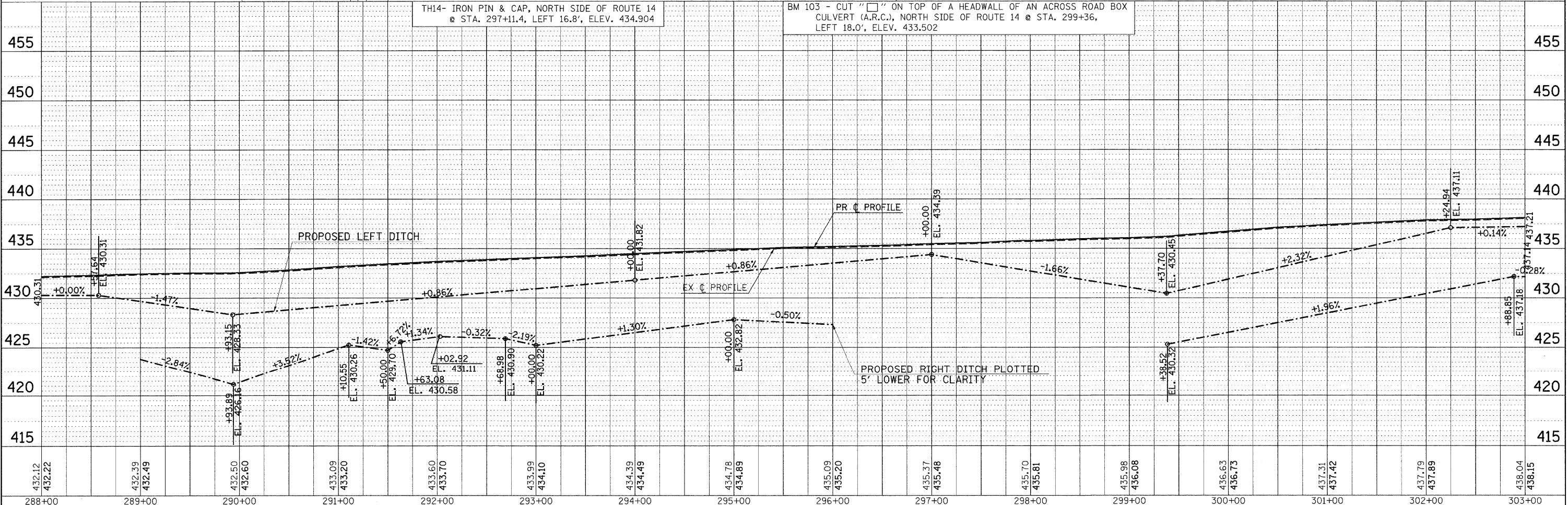

432.12	432.22	432.39	432.49	432.50	432.60	433.09	433.20	433.60	433.70	433.99	434.10	434.39	434.49	434.78	434.89	435.09	435.20	435.37	435.48	435.70	435.81	435.98	436.08	436.63	436.75	437.31	437.42	437.79	437.89	438.04	438.15		
288+00	289+00	290+00	291+00	292+00	293+00	294+00	295+00	296+00	297+00	298+00	299+00	300+00	301+00	302+00	303+00																		

DATE: _____
 PLAN: _____
 SURVEYED: _____
 PLOTTED: _____
 NOTE BOOK NO.: _____
 ALIGNMENT CHECKED: _____
 STRUCTURE NOTATIONS CHKD: _____
 CAD FILE NAME: _____

DATE: _____
 BY: _____
 PROFILE: _____
 SURVEYED: _____
 PLOTTED: _____
 NOTE BOOK NO.: _____
 GRADES CHECKED: _____
 STRUCTURE NOTATIONS CHKD: _____

STATE OF ILLINOIS
 DEPARTMENT OF TRANSPORTATION

IL ROUTE 14 PLAN & PROFILE SHEET

F.A.P. RTE.	SECTION	COUNTY	TOTAL SHEETS	SHEET NO.
869	(1-1,1,3,6)R-1,R5-3(1,3,6)B-2		299	36
CONTRACT NO. 98797				

D:\901803\CADdata\CADsheets\901803p3.m32

* FRANKLIN & PERRY COUNTIES