

FINAL SURVEY	SURVEYED	BY	DATE
NOTE BOOK	TEMPLATE		
AREAS CHECKED			
NO.			

ORIGINAL SURVEY	SURVEYED	BY	DATE
NOTE BOOK	TEMPLATE		
AREAS CHECKED			
NO.			

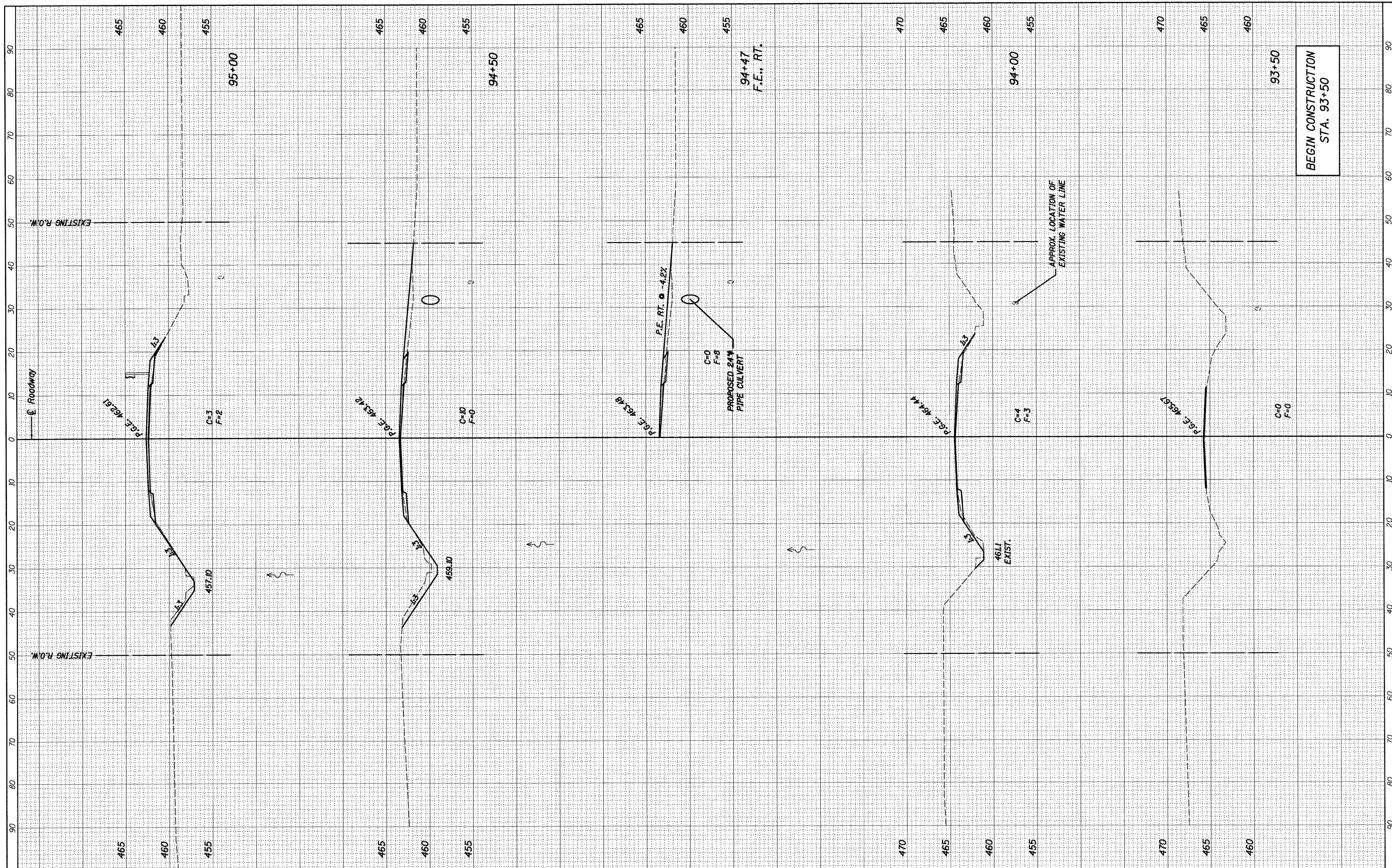

BEGIN CONSTRUCTION
STA. 93+50

FILE NAME = h:\5789\5789.dgn
USER NAME = USERDESCR...

DESIGNED - B.I.B.
DRAWN - K.H.L.
CHECKED - L.D.G.
DATE -

REVISED -
REVISED -
REVISED -
REVISED -

STATE OF ILLINOIS
DEPARTMENT OF TRANSPORTATION

CROSS SECTIONS
EXISTING & PROPOSED ROADWAY
SCALE: SHEET NO. 1 OF 5 SHEETS STA. 93+50 TO STA. 95+00

F.A.S. RTE.	SECTION	COUNTY	TOTAL SHEETS	SHEET NO.
782	07-00084-00-BR/07-00088-00-BR	BOND/CLINTON	19	15
S.N. 003-3052		CONTRACT NO. 97469		
ILLINOIS FED. AID PROJECT				

HMG NO. 5789