

LEGEND

T POST MOUNTED SIGN

ALL ITEMS OF WORK INVOLVED WITH THE ROAD CLOSURE WILL BE PAID FOR AT THE CONTRACT UNIT PRICE PER LUMP SUM FOR TRAFFIC CONTROL AND PROTECTION.

☼ ALL ROAD CONSTRUCTION AHEAD SIGNS AND ROAD CLOSED AHEAD SIGNS SHALL HAVE FLASHING LIGHTS.

NOTES:

ENGINEER MAY MODIFY SIGN PLACEMENT TO MEET FIELD CONDITIONS.

DETOUR SIGNING ASSEMBLY SHALL MAINTAIN THE HEIGHT TO THE BOTTOM OF THE LOWEST SIGN NO LESS THAN 5 FEET ABOVE THE EDGE OF PAVEMENT.

* 200' TYPICAL TO FIRST SIGN OR TO MEET FIELD CONDITIONS.

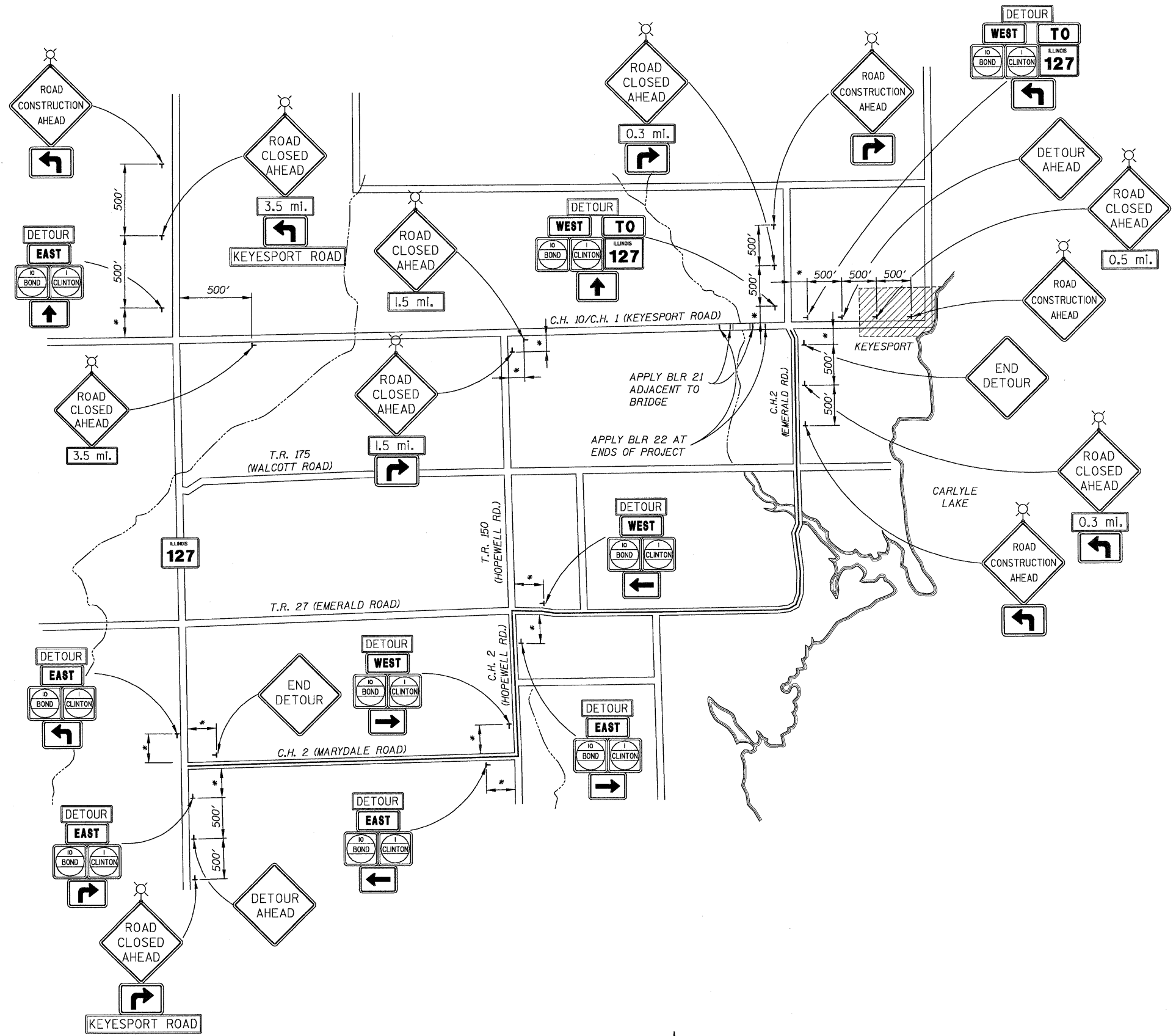

DETOUR MAP WITH SIGNING

FILE NAME =	USER NAME =
h:\5789\05.Detour-5789.dgn	..USERDESCR..

PLOT SCALE =	PLOT DATE =
200.0004 / / IN.	4/12/2011

DESIGNED -	CHECKED -	DRAWN -	CHECKED -
B.I.B.	L.D.G.	K.H.L.	B.G.H.

REVISED -	REVISED -	REVISED -	REVISED -

**STATE OF ILLINOIS
DEPARTMENT OF TRANSPORTATION**

DETOUR MAP

SHEET NO. 1 OF 1 SHEETS

F.A.S. RTE.	SECTION	COUNTY	TOTAL SHEETS	SHEET NO.
782	07-00084-00-BR/07-00088-00-BR	BOND/CLINTON	19	5
S.N. 003-3052		CONTRACT NO. 97469		
ILLINOIS FED. AID PROJECT				

H.M.G. NO. 5789