

INDEX OF SHEETS

- 1 COVER SHEET
- 2 SUMMARY OF QUANTITIES, GENERAL NOTES, AND TYPICAL SECTIONS
- 3 PLAN AND PROFILE
- 4-8 STATION CROSS SECTIONS
- 9-21 BRIDGE PLANS

STATE OF ILLINOIS  
DEPARTMENT OF TRANSPORTATION  
DIVISION OF HIGHWAYS  
**PLANS FOR PROPOSED  
LOCAL AGENCY IMPROVEMENT**

ROUTE NO.	SECTION	COUNTY	TOTAL SHEETS	SHEET NO.
T.R. 939	10-P4000-00-BR	MACON	21	1
FED. ROAD DIST. NO.	ILLINOIS PROJECT:			

LIST OF STANDARDS

STANDARD 000001-06	STANDARD SYMBOLS, ABBREVIATIONS AND PATTERNS
STANDARD 280001-05	TEMPORARY EROSION CONTROL SYSTEMS
STANDARD 482001-02	HMA SHOULDER ADJACENT TO FLEXIBLE PAVEMENT
STANDARD 515001-03	NAME PLATE FOR BRIDGES
STANDARD 606201-02	TYPE B GUTTER (INLET, OUTLET & ENTRANCE)
STANDARD 701901-01	TRAFFIC CONTROL DEVICES
STANDARD BLR-21-8	TYPICAL APPLICATION OF TRAFFIC CONTROL DEVICES FOR CONSTRUCTION ON RURAL LOCAL HIGHWAYS

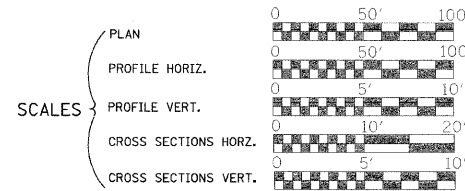

SURFACE TRANSPORTATION  
URBAN (STU) FUNDS  
DECATUR PARK DISTRICT  
T.R. 939 (PARK DRIVE) OVER STEVENS CREEK  
SECTION 10-P4000-00-BR  
MACON COUNTY

T.R. 939 (PARK DRIVE) OVER STEVENS CREEK  
SECTION 10-P4000-00-BR  
MACON COUNTY  
CONTRACT NO. 95660  
PROJ. #M-5169(049)

ROADWAY CLASSIFICATION: URBAN LOCAL ROAD  
2033 ADT = 1050  
DESIGN SPEED: 30 MPH  
DESIGN GUIDELINES: URBAN  
VARIANCES GRANTED: ELIMINATION OF APPROACH GUARDRAIL  
COMMITMENTS: EXISTING ROADWAY AND BRIDGE MUST REMAIN OPEN THROUGH LABOR DAY 2011

EXIST. STR. NO. 058-9200  
PROP. STR. NO. 058-9201

C-97-065-11  
R2E, 3rd P.M.

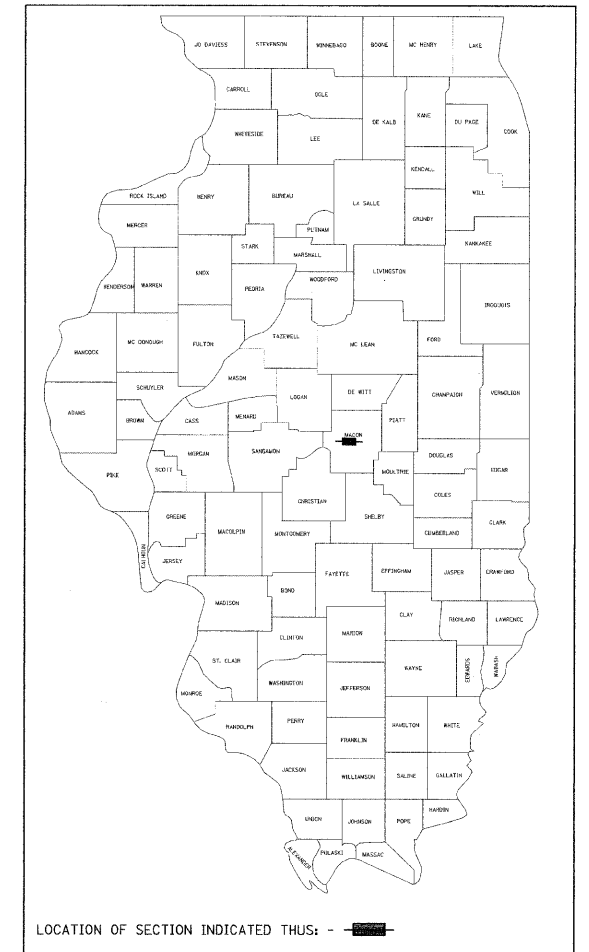

JOINT UTILITY LOCATING INFORMATION FOR EXCAVATORS  
J.U.L.I.E. TELEPHONE NO. TOLL FREE 1-800-892-0123

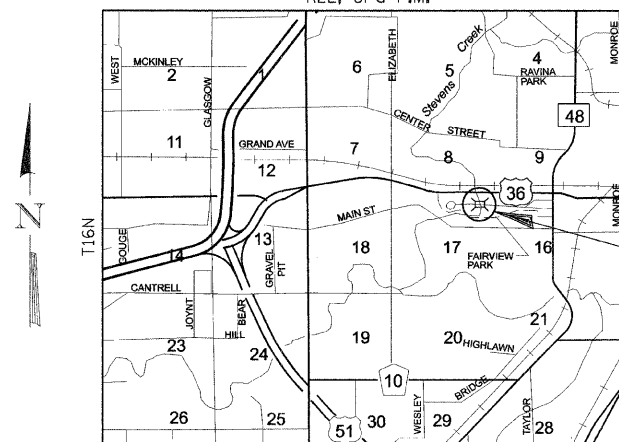

PROJECT LOCATION  
IMPROVEMENT BEGINS  
STA. 11+28.98  
IMPROVEMENT ENDS  
STA. 18+36.19

IMPROVEMENT CONSISTS OF THE REMOVAL OF A THREE SPAN CONCRETE SLAB BRIDGE WITH STEEL STRINGERS ON CLOSED CONCRETE ABUTMENTS AND CONCRETE PIERS 0-0 DECK = 28'-0". BK.-BK. ABUTMENTS = 89'-0" AND THE CONSTRUCTION OF A THREE SPAN PRECAST PRESTRESSED CONCRETE DECK BEAM BRIDGE ON CONCRETE SPILL THRU ABUTMENTS AND CONCRETE PIERS. TOTAL LENGTH = 119'-2", WIDTH = 30'-0" 0.-0. DECK AND NECESSARY APPROACH ROADWAY WORK.

LAYOUT

APPROXIMATE SCALE scale miles

TOTAL AND NET LENGTH OF IMPROVEMENT 707.21 FEET = 0.134 MILES



345 EAST ASH AVENUE, SUITE B  
DECATUR, ILLINOIS 62526  
PH. 217-875-4800

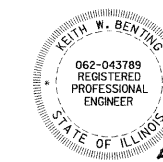

Exp. 11/30/2011

*Keith W. Benning*  
ILLINOIS PROFESSIONAL NO. 43789

4/21/2011  
DATE

APPROVED *Mark W. ...* 7-21 2011  
EXECUTIVE DIRECTOR

PASSED *Maureen ...* 4-26 2011  
DISTRICT SEVEN ENGINEER OF LOCAL ROADS & STREETS

RELEASING FOR BID BASED ON LIMITED REVIEW *Roger R. ...* 4-26 2011  
DEPUTY DIRECTOR OF HIGHWAYS, REGION FOUR ENGINEER

STATE OF ILLINOIS  
DEPARTMENT OF TRANSPORTATION