

ROUTE NO.	SECTION	COUNTY	TOTAL SHEETS	SHEET NO.
T.R. 283A	06-02119-00-BR	SHELBY	22	4
ROAD DIST.	ILLINOIS		BIG SPRING	
CONTRACT NO. 95657				

NOTE: SEE SHEET 2 FOR PARKING LOT DETAILS.

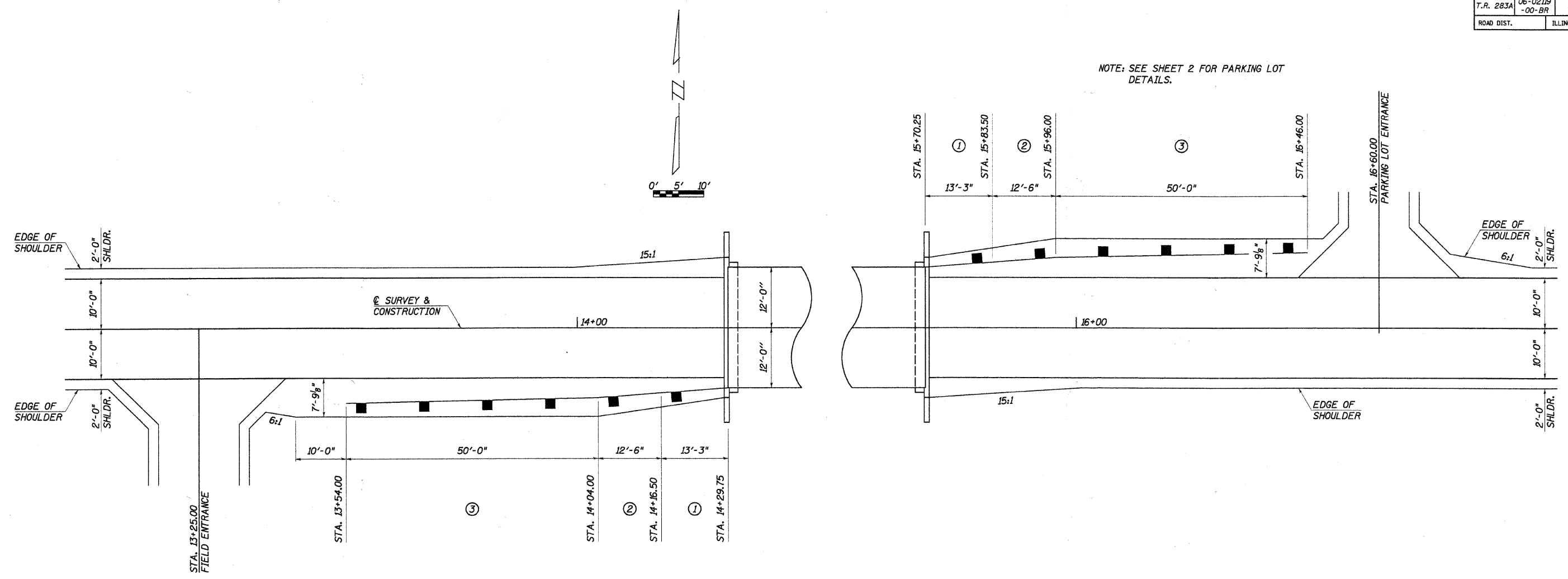

SHOULDER AND GUARDRAIL DETAIL

TRAFFIC BARRIER TERMINAL, TYPE 5A  
 13.03' RT. STA. 14+16.50 TO 12' RT. STA. 14+29.75 = 1 EACH  
 12' LT. STA. 15+70.25 TO 13.03' LT. STA. 15+83.50 = 1 EACH  
 TOTAL = 2 EACH

STEEL PLATE BEAM GUARDRAIL, TYPE A, 9 FOOT POSTS  
 14' RT. STA. 14+04.00 TO 13.03' RT. STA. 14+16.50 = 12.5 FOOT  
 13.03' LT. STA. 15+83.50 TO 14' LT. STA. 15+96.00 = 12.5 FOOT  
 TOTAL = 25.0 FOOT

TRAFFIC BARRIER TERMINAL, TYPE 1, (SPECIAL) TANGENT  
 15' RT. STA. 13+54.00 TO 14' RT. STA. 14+04.00 = 1 EACH  
 14' LT. STA. 15+96.00 TO 15' LT. STA. 16+46.00 = 1 EACH  
 TOTAL = 2 EACH

- LEGEND**
- NOTE: ALL DIMENSIONS REFER TO FRONT FACE OF PROPOSED RAILING.
- ① TRAFFIC BARRIER TERMINAL, TYPE 5A
  - ② STEEL PLATE BEAM GUARDRAIL, TYPE A, 9 FOOT POSTS
  - ③ TRAFFIC BARRIER TERMINAL, TYPE 1, (SPECIAL) TANGENT

**SHOULDER AND GUARDRAIL DETAILS**  
 SECTION 06-02119-00-BR  
 BIG SPRING ROAD DISTRICT  
 SHELBY COUNTY  
 STA. 15+00

4440 ASH GROVE SPRINGFIELD, IL 62711 (217) 793-8600 www.fehr-graham.com	<b>FEHR-GRAHAM &amp; ASSOCIATES, LLC</b> ENGINEERING AND SCIENCE CONSULTANTS FREEPORT, IL. ROCKFORD, IL. ROCKFORD, IL. MONROE, IL. SPRINGFIELD, IL.	DRAWN: S.A.P. DATE: 02/23/07	CHECKED: G.J.C. DATE: 03/16/07	JOB NO.: 46863 FILE: SHLDR.DGN DATE: 04/04/11
--	---	---------------------------------	-----------------------------------	---